

BALDOR® • RELIANCE

Product Information Packet

ZDFRPM25404

40HP, 1750RPM, 3PH, 60HZ, 2586, TEFC, FOOT

| Part Detail | | | | | | | |
|-------------|---------|----------------|-------|-------------|--------|---------------|------------|
| Revision: | - | Status: | PRD/A | Change #: | | Proprietary: | No |
| Type: | AC | Prod. Type: | | Elec. Spec: | L3271A | CD Diagram: | 422927-001 |
| Enclosure: | TEFC | Mfg Plant: | | Mech. Spec: | | Layout: | 617581-001 |
| Frame: | FL2586Z | Mounting: | F3 | Poles: | 04 | Created Date: | 04-10-2015 |
| Base: | | Rotation: | R | Insulation: | H | Eff. Date: | 04-13-2015 |
| Leads: | | | | | | Replaced By: | |
| Literature: | | Elec. Diagram: | | | | | |

| Nameplate 000613006NN | | | | | | | | | | | | | | | | | | | | | | | | | | | | | | | |
|-----------------------|---|-----------|----------|-----------|----------|----------------|------|-------|----|------|----|------|----|-----------|--------------|-------|------|-------------|--------------|--|--|--|--|--|--|--|--|--|--|--|--|
| | <table border="1"> <thead> <tr> <th>DUTY</th> <th>HP</th> <th>RPM</th> <th>AMPS</th> <th>VOLTS</th> <th>HZ</th> </tr> </thead> <tbody> <tr> <td>CONT</td> <td>40</td> <td>1780</td> <td>51</td> <td>460</td> <td>60</td> </tr> <tr> <td>CONT</td> <td>40</td> <td>3560</td> <td>47</td> <td>460</td> <td>120</td> </tr> <tr> <td></td> <td></td> <td></td> <td></td> <td></td> <td></td> </tr> <tr> <td></td> <td></td> <td></td> <td></td> <td></td> <td></td> </tr> </tbody> </table> | DUTY | HP | RPM | AMPS | VOLTS | HZ | CONT | 40 | 1780 | 51 | 460 | 60 | CONT | 40 | 3560 | 47 | 460 | 120 | | | | | | | | | | | | |
| DUTY | HP | RPM | AMPS | VOLTS | HZ | | | | | | | | | | | | | | | | | | | | | | | | | | |
| CONT | 40 | 1780 | 51 | 460 | 60 | | | | | | | | | | | | | | | | | | | | | | | | | | |
| CONT | 40 | 3560 | 47 | 460 | 120 | | | | | | | | | | | | | | | | | | | | | | | | | | |
| | | | | | | | | | | | | | | | | | | | | | | | | | | | | | | | |
| | | | | | | | | | | | | | | | | | | | | | | | | | | | | | | | |
| CAT.NO. | ZDFRPM25404 | | | | | | | | | | | | | | | | | | | | | | | | | | | | | | |
| SER.NO. | | | | | | | | | | | | | | | | | | | | | | | | | | | | | | | |
| PH. | 3 | | | | | | | | | | | | | | | | | | | | | | | | | | | | | | |
| DESIGN NO. | L3271A | | | | | | | | | | | | | | | | | | | | | | | | | | | | | | |
| S.F. | 1.0 | | | | | | | | | | | | | | | | | | | | | | | | | | | | | | |
| ENCL MOD | | | | | | | | | | | | | | | | | | | | | | | | | | | | | | | |
| | <table border="1"> <tbody> <tr> <td>FR</td> <td>FL 2586Z</td> <td>SPEC. NO.</td> <td>P25T0312</td> </tr> <tr> <td>MAX SAFE SPEED</td> <td>5000</td> <td>INSUL</td> <td>H</td> </tr> <tr> <td>TYPE</td> <td></td> <td>AMB.</td> <td>40</td> </tr> <tr> <td>D.E. BRG.</td> <td>65BC03JPP30A</td> <td>ENCL.</td> <td>TEFC</td> </tr> <tr> <td>O.D.E. BRG.</td> <td>50BC03JPP30A</td> <td></td> <td></td> </tr> </tbody> </table> | FR | FL 2586Z | SPEC. NO. | P25T0312 | MAX SAFE SPEED | 5000 | INSUL | H | TYPE | | AMB. | 40 | D.E. BRG. | 65BC03JPP30A | ENCL. | TEFC | O.D.E. BRG. | 50BC03JPP30A | | | | | | | | | | | | |
| FR | FL 2586Z | SPEC. NO. | P25T0312 | | | | | | | | | | | | | | | | | | | | | | | | | | | | |
| MAX SAFE SPEED | 5000 | INSUL | H | | | | | | | | | | | | | | | | | | | | | | | | | | | | |
| TYPE | | AMB. | 40 | | | | | | | | | | | | | | | | | | | | | | | | | | | | |
| D.E. BRG. | 65BC03JPP30A | ENCL. | TEFC | | | | | | | | | | | | | | | | | | | | | | | | | | | | |
| O.D.E. BRG. | 50BC03JPP30A | | | | | | | | | | | | | | | | | | | | | | | | | | | | | | |
| | MIN. AMB. 0 | | | | | | | | | | | | | | | | | | | | | | | | | | | | | | |

| Parts List | | |
|--------------------|----------------------------------|-----------------|
| Part Number | Description | Quantity |
| WS286697 | WS P25T0312 | 1.000 EA |
| RA282905 | RA P25T0312 | 1.000 EA |
| 000613006NN | RPM AC WITH CERTIFIED LOGOS | 1.000 EA |
| 000692000FP | NP, WARNING LIFT INSTRUCTIONS | 1.000 EA |
| 000692000VD | LABEL WARNING | 1.000 EA |
| 036170004EA | ROUND HEAD DRIVE SCREW | 4.000 EA |
| 418018122A | LABEL | 2.000 EA |
| 422927001 | C/D LABEL | 1.000 EA |
| 036100080KA | M10-1.50X 80MM HXSOCHDCS | 3.000 EA |
| 036500010AB | METRIC NUT M10-1.5PLTD400 | 4.000 EA |
| 036500010AB | METRIC NUT M10-1.5PLTD400 | 4.000 EA |
| 036610010AB | MHSLW M10 PLATED | 4.000 EA |
| 400638001H | SPRING WASHER | 1.000 EA |
| 418057491A | LIFTING LUG | 2.000 EA |
| 602018077A | DRAIN | 1.000 EA |
| 602018077A | DRAIN | 1.000 EA |
| 609830005ABP | TBOLT | 4.000 EA |
| 807582003AAA | BRKT,DE,250AC UNFINISHED BRACKET | 1.000 EA |
| 807582004AAB | BRKT,ODE,L250 | 1.000 EA |
| 032018004AK | HHCS 1/4-20X1/2 PLATED | 2.000 EA |
| 034180012FA | KEY 3/8X3/8X1-1/2 L - 360 | 1.000 EA |
| 036000012HB | HHCS M6X12MM LONG PLATED | 3.000 EA |
| 036000020HB | HHCS M6-1.0X20MM PLATED | 4.000 EA |
| 036620008AB | M6 METRIC EXT LOCKWASHER | 1.000 EA |

| Parts List (continued) | | |
|-------------------------------|---|-----------------|
| Part Number | Description | Quantity |
| 065564000B | GASK 250-280 | 1.000 EA |
| 075452000B | C/BOX, PAINTED 210-250 | 1.000 EA |
| 075453000A | CBOXC, PAINTED 250-280 | 1.000 EA |
| 078548001T | FAN 250 | 1.000 EA |
| 406673002C | .75 CAP PLUG | 1.000 EA |
| 415000103A | T/LUG #14AWG-#4AWG W/HOLE FOR .250 BOLT | 1.000 EA |
| 415072001B | CLAMP | 1.000 EA |
| 417733004T | GASKET CONDUIT BOX | 2.000 EA |
| 418018074A | GROUND LABEL G100 METRIC 160 D.C. | 1.000 EA |
| 418057373A | SCREW SHEET METAL | 7.000 EA |
| 422962051B | STUB SHAFT | 1.000 EA |
| 607980163C | TETHER KIT | 1.000 EA |
| 607980163D | TETHER KIT | 1.000 EA |
| 607980192A | RF,BEI,HS35,TWISTLOCK | 1.000 EA |
| 708533003A | PLATE, BTM FAN/BLOWER | 2.000 EA |
| 708534050A | BLOWER SHROUD | 1.000 EA |
| 708534051A | FL250 FAN GRILL | 1.000 EA |
| 000640000P | TAG WINDING THERMOST | 1.000 EA |
| 004824007K | SPECIAL PAINT | 0.100 EA |
| 034180024GA | KEY 1/2X1/2X3 L | 1.000 EA |

| | | | | | | |
|-------------|--------|--------------|------|---------------------------------------|-----------|---|
| REL. S.O. | - | VOLTS | 460 | ENCLOSURE | TEFC | WYE CONN EQ CKT OHMS PER PHASE (AT BASE RATING, 25 °C) |
| FRAME | FL2586 | AMPS | 51 | MAX SAFE RPM | 5000 | |
| HP | 40 | DUTY | CONT | IM (AMPS) | 25 | R1 .0669 X1 .338 |
| BASE SPEED | 1780 | S.F. | 1.0 | P.F.@NL/FL | .049/.804 | R2 .0458 X2 .610 |
| PHASE/HERTZ | 3/60 | AMB °C/INSUL | 40/H | WK ² (LB-FT ²) | 4.9 | XM 10.5 |

RATED FULL LOAD DATA

| | RPM | HP | TORQUE LB-FT | FUND VOLTS | FREQ-HZ | AMPS |
|------------|------|------|-----------------|---------------|---------|------|
| BASE SPEED | 1781 | 40.0 | 118 | 460 | 60 | 50.6 |
| MAX SPEED | 3560 | 40.0 | 59 | 460 | 120 | 46.8 |
| MIN SPEED | 0 | 0 | 118 | 9.71 | .621 | 50.6 |

LOAD PERFORMANCE AT BASE SPEED

| | RPM | HP | TORQUE LB-FT | FUND VOLTS | FREQ-HZ | AMPS |
|-----------|------|------|-----------------|---------------|---------|------|
| NO LOAD | 1800 | 0 | 0 | 460 | 60 | 24.5 |
| 1/4 | 1795 | 10.0 | 29 | 460 | 60 | 27.5 |
| 1/2 | 1791 | 20.0 | 59 | 460 | 60 | 33.4 |
| 3/4 | 1786 | 30.0 | 88 | 460 | 60 | 41.4 |
| FULL LOAD | 1781 | 40.0 | 118 | 460 | 60 | 50.6 |
| O/L | 1760 | 79.1 | 236 | 460 | 60 | 92.0 |

| BLOWER DATA | VOLTS | PH/HZ | FL AMPS | LR AMPS | FRAME | CFM |
|----------------|-------|-------|---------|---------|-------|-----|
| | | | | | | |

REMARKS: TYPICAL DATA
CORRELATED DATA

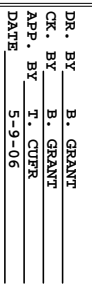
| | | | |
|---|---------|------------------------------------|---|
|  | DR. BY | B. GRANT | A-C MOTOR PERFORMANCE DATA |
| | CK. BY | T. CUER | |
| | APP. BY | 5-9-06 | |
|  | | L3271A ISSUE DATE 5-9-06 | |

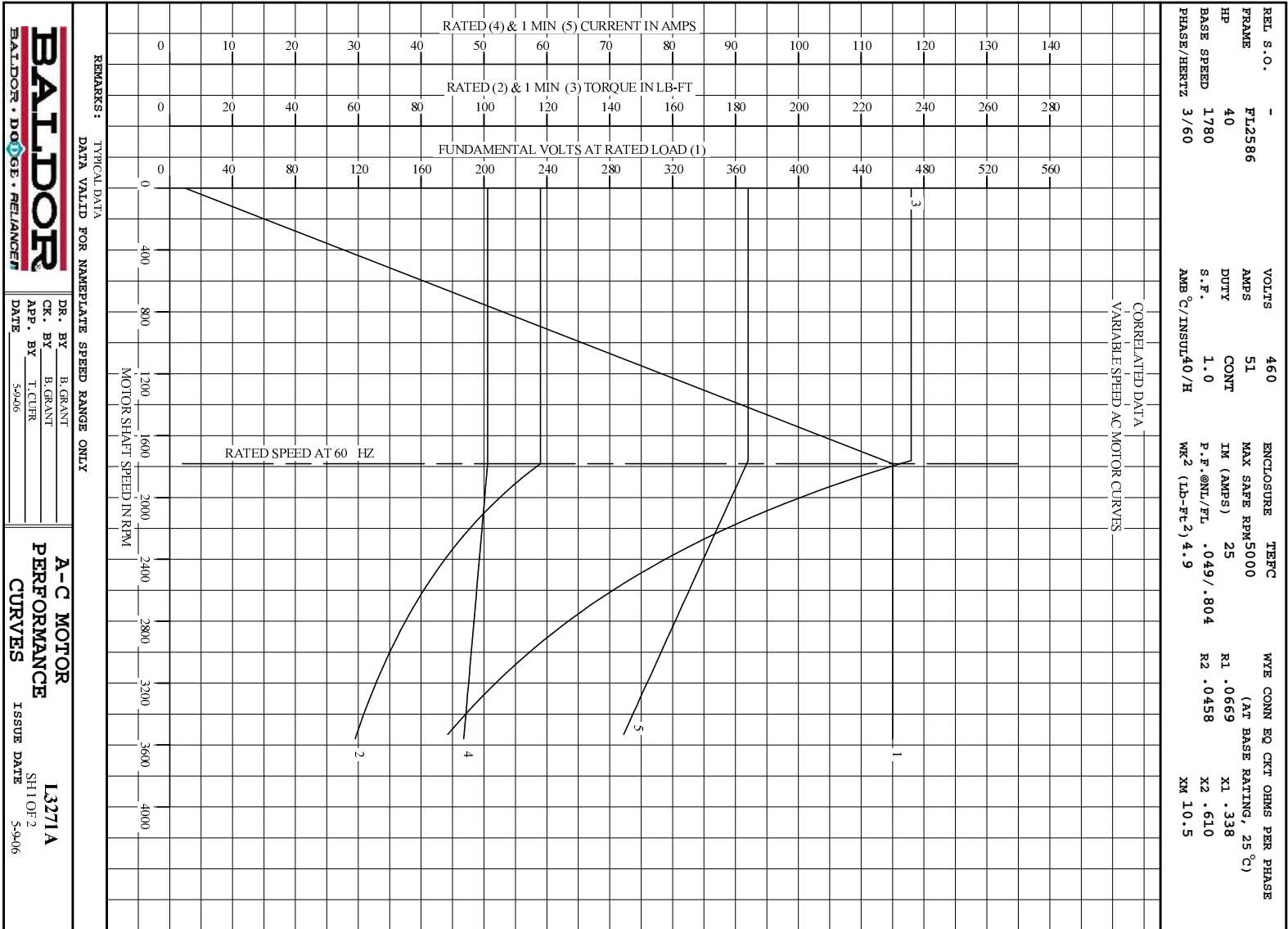

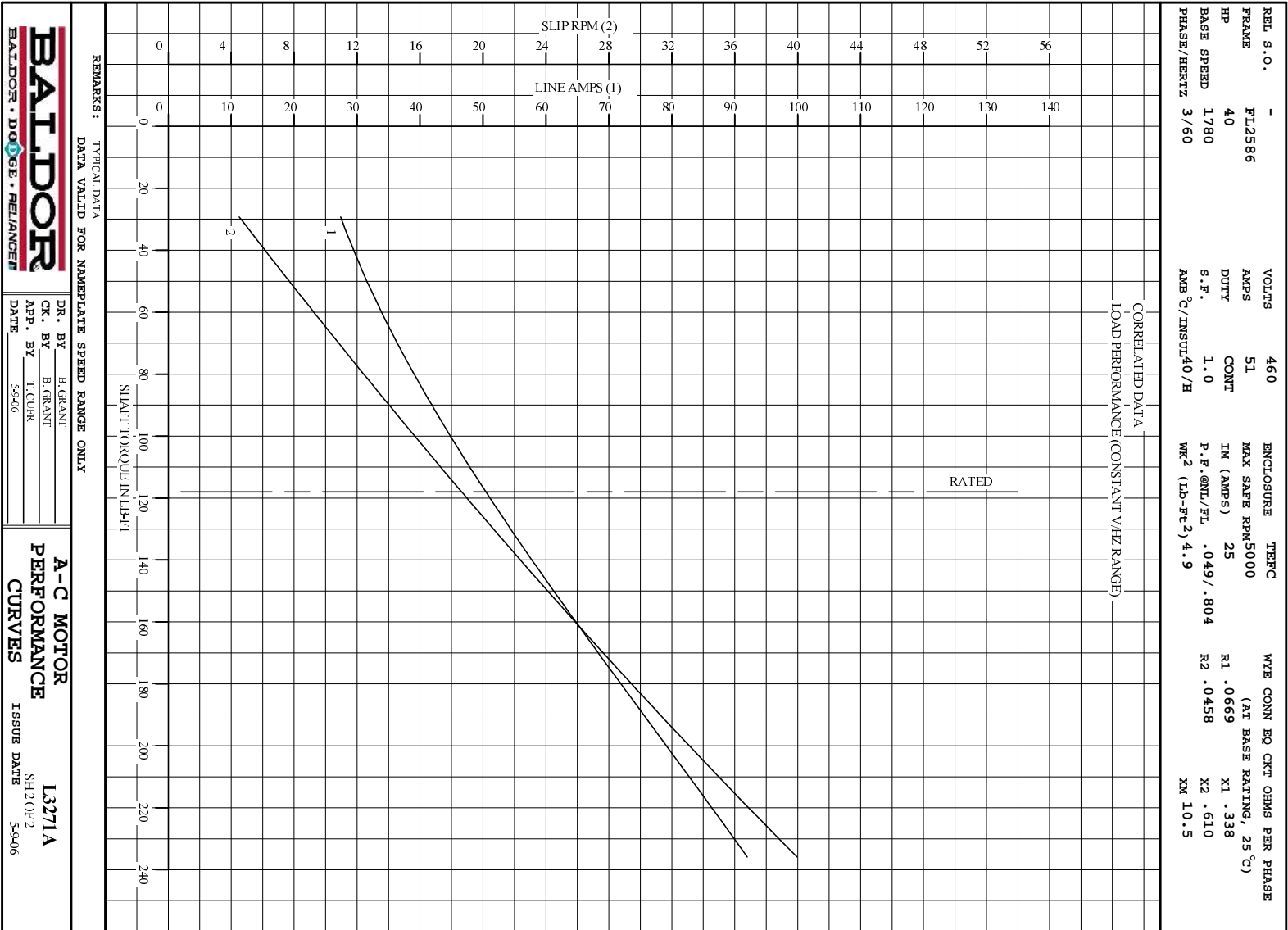

BALDOR
BALDOR • DOUG • RELIANCE

DR. BY B. GRANT
CK. BY B. GRANT
APP. BY T. CURR
DATE 5-9-06

A-C MOTOR
PERFORMANCE
CURVES
ISSUE DATE 5-9-06
L3271A
SH20F2

617581-001

RPM-AC FINNED FRAME VARIABLE SPEED ALTERNATING CURRENT
MOTOR
FL & UFL2586Z

ENCLOSURE: TOTALLY ENCLOSED
MOUNTING: FOOT
DRIVE METHOD: COUPLED OR BELTED

COOLING: BLOWER COOLED or
FAN COOLED
ACCESSORIES: PROVISIONS FOR
TACHOMETER MOUNTING
ONLY WHEN SPECIFIED

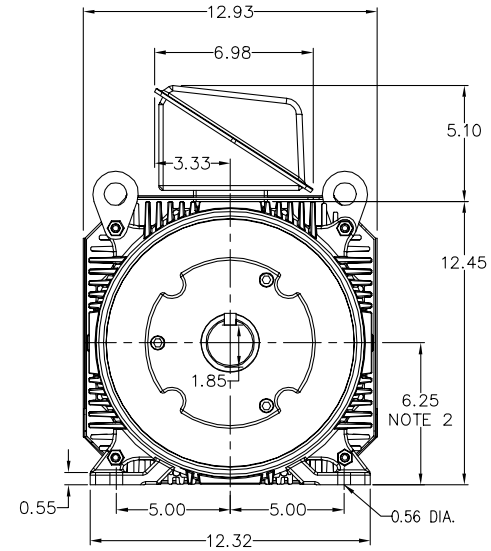
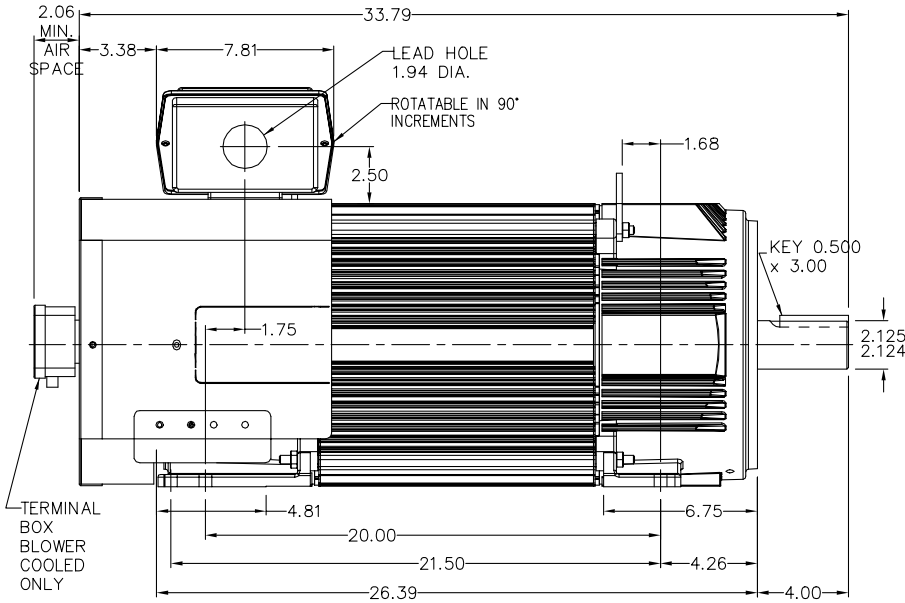

- NOTE 1: C-FACE & TACHOMETER MOUNTING
1/2-13 TAP, 1.00 DEEP, ON A 7.25 DIA. BOLT CIRCLE
FACE RUNOUT AND ECCENTRICITY 0.004 MAX. T.I.R.
- NOTE 2: SHAFT HEIGHT WILL NOT BE EXCEEDED
SHIMS UP TO 0.03 INCHES IN THICKNESS ARE USUALLY
REQUIRED FOR COUPLED OR GREARED MACHINES
- TERMINAL BOX MAY BE LOCATED F1 OR F2 IF SPECIFIED
121 AMP STEEL TERMINAL BOX SHOWN
REFER TO 616779-50 FOR SPECIFIED TERMINAL BOX DIMENSIONS
REFER TO 616779-55 FOR SPECIFIED TACHOMETER DIMENSIONS

MOTOR WEIGHT: 605 LBS. (MAY VARY 15%)
DIMENSIONS ARE IN INCHES SCALE: 1.00

617581-001

CUSTOMER IS RESPONSIBLE FOR DETERMINING THAT BALDOR'S PRODUCT WILL PERFORM SUITABLY IN THE INTENDED APPLICATION.

| | | |
|--------------------------------|------------------------------|-------------------|
| REV. DESC: ASSIGNED TO BUSLOAD | | |
| REV. LTR: - | VERSION: 00 | TDR: 000000475986 |
| FILE: \RGG\00002\904 | REVISED: 15:23:16 09/17/2008 | BY: CONBAT |
| MTL: - | | |

BALDOR • DODGE • RELIANCE
DIM SHT FL & UFL2586Z RPM AC TE BLWR OR FAN COOLED
SH 1 of 1

618779-050

INDUSTRIAL ALTERNATING CURRENT MOTORS

RPM AC

STEEL, CAST IRON, MILL AND TERMINAL BOARD CONDUIT BOX DIMENSIONS
 NEMA FRAMES FL210 thru RL280 and IEC FRAMES RDL132 thru RDL180
 NEMA FRAMES FL180 thru FL280 and IEC FRAMES FDL112 thru FDL180

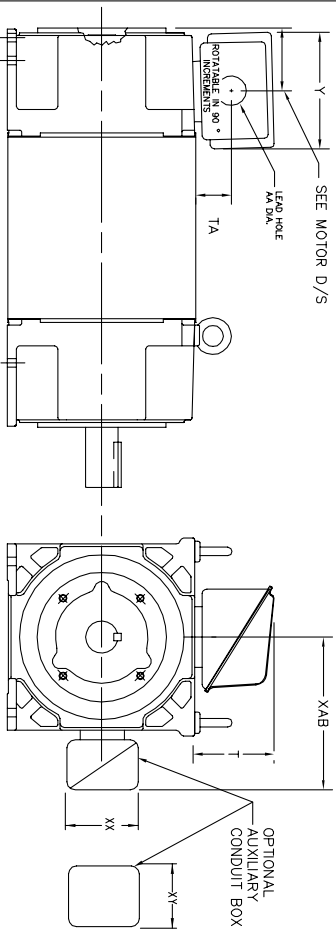

| TERMINAL BOX | Y | TA | T | AA | MAX AMP'S | REMARKS |
|--------------|-------|------|-------|-------------|-----------|----------------------|
| 706310-63B | 14.39 | 7.43 | 12.15 | -- | 400 | TERMINAL STRIP |
| 706310-226R | 9.00 | 3.06 | 5.40 | Pg36 & Pq16 | 160 | TERMINAL STRIP |
| 706310-225R | 7.25 | 2.30 | 4.40 | Pg29 & Pq16 | 100 | TERMINAL STRIP |
| 706310-56B | 9.00 | 3.06 | 5.40 | Pg36 & Pq16 | 160 | TERMINAL STRIP |
| 706310-56A | 7.75 | 2.30 | 4.40 | Pg29 & Pq16 | 100 | TERMINAL STRIP |
| 706320-14D | 15.00 | 7.56 | 12.81 | 5 | 510 | CAST IRON |
| 706320-13A | 10.50 | 4.88 | 9.00 | 4.0 TAP | 210 | CAST IRON |
| 706320-12B | 9.25 | 4.81 | 8.56 | 3 | 140 | CAST IRON |
| 75460-62B | 7.25 | 2.50 | 5.25 | 1.5 TAP | 110 | CAST IRON |
| 706320-4C | 5.75 | 2.38 | 4.38 | 1.0 TAP | 60 | CAST IRON FL180 ONLY |
| 706310-3E | 16.00 | 4.40 | 7.81 | 3 | 590 | MILL |
| 706310-3X | 8.00 | 2.38 | 5.00 | -- | 160 | MILL |
| 702658-1G | 14.62 | 7.56 | 12.70 | 5 | 500 | STEEL |
| 706320-16A | 9.00 | 4.12 | 8.44 | 4.59 | 305 | STEEL |
| 706320-9A | 7.25 | 3.50 | 7.06 | 2.50 | 160 | STEEL |
| 75454-1AJ | 7.69 | 2.38 | 5.25 | 1.94 | 121 | STEEL |
| 75452-B | 6.34 | 2.00 | 4.12 | 1.75 | 61 | STEEL |
| 75452-G | 6.34 | 2.00 | 4.12 | -- | 61 | SPECIAL |
| 706320-5A | 6.12 | 2.38 | 4.38 | 1.75/2.00 | 75 | STEEL FL180 ONLY |
| 706320-3A | 5.00 | 1.62 | 3.00 | 1.12 | 40 | STEEL FL180 ONLY |
| 706320-7A | 7.62 | 2.00 | 7.00 | 2.5/3.0 | 208 | STEEL FL180 ONLY |

| FRAME SIZE | XAB | OPTIMAL AUXILIARY CONDUIT BOX DIMENSIONS (MAXIMUM) | | | | PART NUMBER | | | |
|-------------------------|------|--|------|-------------|-------------------------|-------------|------|------|------------|
| | | XX | XY | XAB | XY | | | | |
| FL210/FL132/RL210/RL132 | 7.38 | 4.25 | 4.25 | 602007-26-A | FL210/FL132/RL210/RL132 | 10.88 | 8.00 | 8.00 | 706310-3-B |
| FL220/FL180/RL220/RL180 | 8.44 | 4.23 | 4.23 | 602007-26-A | FL220/FL180/RL220/RL180 | 11.88 | 8.00 | 8.00 | 706310-3-B |
| FL280/FL180/RL280/RL180 | 9.12 | 4.23 | 4.23 | 602007-26-A | FL280/FL180/RL280/RL180 | 12.62 | 8.00 | 8.00 | 706310-3-B |

- (1) 'AA' CONDUIT
- (2) 'AA' PIPE TAP
- (3) CUSTOMER TO PROVIDE HOLE FOR CONDUIT.
- (4) 'E' ON 'SA' OR 'I' TAP ON '4C'

TERMINAL BOX CAN BE ROTATED FOR LEAD OUTLET AT TOP, SIDES OR BOTTOM.
 TERMINAL BOX LOCATED ON OPPOSITE SIDE WHEN F-2, W-1, W-4, W-5, W-7,
 OR C-1 MOUNTING IS SPECIFIED. BOX LOCATED ON TOP WHEN SPECIFIED.

050-60761919

CUSTOMER IS RESPONSIBLE FOR DETERMINING THAT BALDOR'S PRODUCT WILL PERFORM SUITABLY IN THE INTENDED APPLICATION.

| | |
|--|------------------------------|
| REV. DESC: BOX # 706320-9A, CHANGE AA DIM FROM 2 TO 2.50 | TDR: 000000785386 |
| REV. LTR: C | VERSION: 03 |
| FILE: \RGG\00003\692 | REVISED: 08:40:55 02/11/2013 |
| MTL: - | BY: RGGWT |

BALDOR

DIM SHT NEMA RL210-RL280 FL180-FL280 IEC RDL132-RDL180

SH 1 of 1

RPM AC TACHOMETER DIMENSIONS
 NEMA FRAMES FL180 thru FL440 and IEC FRAMES FDL112 thru FDL280
 DIMENSIONS ARE IN INCHES(mm)

DPFV, DPSV, TEPV, TESV, TENV & TEAO-PB
 IC06, IC17, IC37, IC410, & IC416-PB

| TACH MODEL | XL Inchest(mm) | LBS. |
|---------------------|----------------|------|
| BEI DE DYNAPAR HS35 | 2.88 (74) | 5 |
| DYNAPAR H20 | 7.50 (191)MAX | 10 |
| NORTHSTAR HS35M | 3.31 (84) | 10 |
| NORTHSTAR ST67 | 2.88 (74) | 5 |
| DYNAPAR H56 | 10.56 (268) | 40 |
| AVTRON M3 DR M4 | 3.62 (92) | 10 |
| TAMAGAWA TS5013(17) | 6.00 (152) | 10 |
| NORTHSTAR ST56 | 2.88 (74) | 5 |
| NORTHSTAR ST85 | 2.00 (51) | 5 |
| BEI H38D | 10.17 (259) | 15 |
| TAMAGAWA TS2151 | 2.64 (67) | 5 |
| BEI H23 | 7.50 (191) | 15 |
| DYNAPAR H20 | 2.00 (50.8) | 5 |
| DYNAPAR H25 | 12.88 (327) | 10 |
| STEGMANN SRS25 | 7.25 (184.4) | 10 |
| NORTHSTAR HS135 | 3.00 (76.2) | 10 |
| HEIDENHAIN ERM425 | 2.5 (63.5) | 5 |
| AVTRON HS35M | 4.19 (106.4) | 5 |
| HEIDENHAIN ERN480 | 5.00 (126.2) | 5 |
| DYNAPAR H125 | 7.00 (177.8) | 10 |
| DYNAPAR H22 | 3.62 (92.1) | 5 |
| AVTRON H255 | 2.54 (64.5) | 9 |
| AVTRON AV950 | 2.54 (64.5) | 9 |
| AVTRON AV956 | 4.50 (115) | 15 |
| HS138 | 3.30 (84) | 5 |
| HS125 | 3.30 (84) | 5 |
| NORTHSTAR RT8 | 3.25 (82) | 15 |
| DYNAPAR H4625 | 5.88 (150) | 10 |
| AVTRON AV485 | 5.50 (141) | 18 |

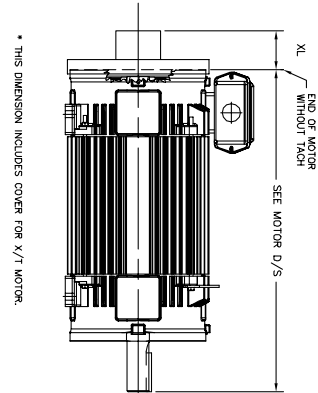

TEAO-BC, IC416-BC

| TACH MODEL | XL Inchest(mm) | LBS. |
|------------------------|----------------|------|
| BEI DE DYNAPAR HS35 | 4.50 (115) | 15 |
| DYNAPAR H20 | 4.50 (115) | 10 |
| AVTRON M3 DR M4 | 4.50 (115) | 10 |
| NORTHSTAR HS35M | 4.50 (115) | 15 |
| NORTHSTAR ST56 | 4.50 (115) | 10 |
| NORTHSTAR ST67 | 4.50 (115) | 10 |
| NORTHSTAR ST85 | 4.50 (115) | 5 |
| TAMAGAWA TS5008 TS5013 | 4.50 (115) | 10 |
| DYNAPAR H20 | 4.50 (115) | 10 |
| STEGMANN SRS25 | 4.50 (115) | 10 |
| STEGMANN SRS25/SH50 | 4.50 (115) | 3 |
| STEGMANN SRS360 | 4.50 (115) | 15 |
| H20 & H2E | 4.50 (115) | 15 |
| AVTRON HS35M | 4.50 (115) | 10 |
| AVTRON AV95 | 4.50 (115) | 5 |
| AVTRON M56 | 4.50 (115) | 10 |
| AVTRON AV67 | 4.50 (115) | 5 |
| HS138 | 4.50 (115) | 5 |
| TS2014 | 4.50 (115) | 10 |
| AVTRON HS45 | 4.50 (115) | 15 |
| DYNAPAR HS138M | 4.50 (115) | 15 |

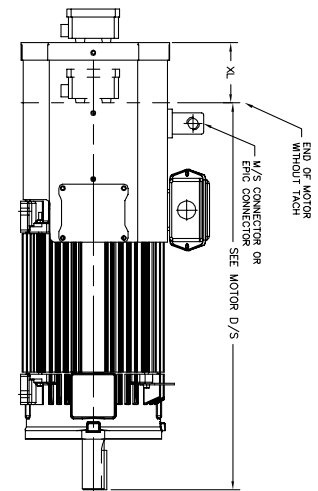

TEFC, IC411

| TACH MODEL | XL Inchest(mm) | LBS. |
|---------------------|----------------|------|
| BEI HS35 | 2.88 (74) | 7 |
| NORTHSTAR HS35M | 3.31 (84) | 10 |
| DYNAPAR H20 | 3.75 (95) | 15 |
| DYNAPAR HS35, HS138 | 2.88 (74) | 7 |
| HEX(X1) | 9.75 (248) | 35 |
| ERM425 | 7.90 (201) | 35 |
| AVTRON HS35M | 4.19 (106) | 2 |
| STEGMANN SRS50 | 3.75 (95) | 1 |
| DYNAPAR H20 | 2.00 (51) | 1 |
| NORTHSTAR HS125 | 2.81 (71) | 2 |
| NORTHSTAR HS138 | 3.30 (84) | 5 |

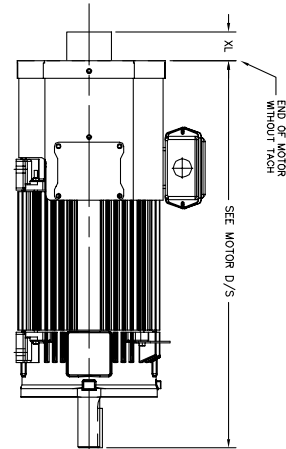

055-66719

616779-055

CUSTOMER IS RESPONSIBLE FOR DETERMINING THAT BALDOR'S PRODUCT WILL PERFORM SUITABLY IN THE INTENDED APPLICATION.

| | |
|---|------------------------------|
| REV. DESC: ADD TAMAGAWA TS5008 (B1248085) | TDR: 000000895710 |
| REV. LTR: U | VERSION: 19 |
| FILE: \RGG\00003\694 | REVISED: 08:00:14 03/06/2015 |
| MTL: - | BY: RGGWT |

BALDOR
 DIM SHT TACH DIM NEMA FL180 - FL440 IEC FDL112 - FDL280
 SH 1 of 1

422927-001

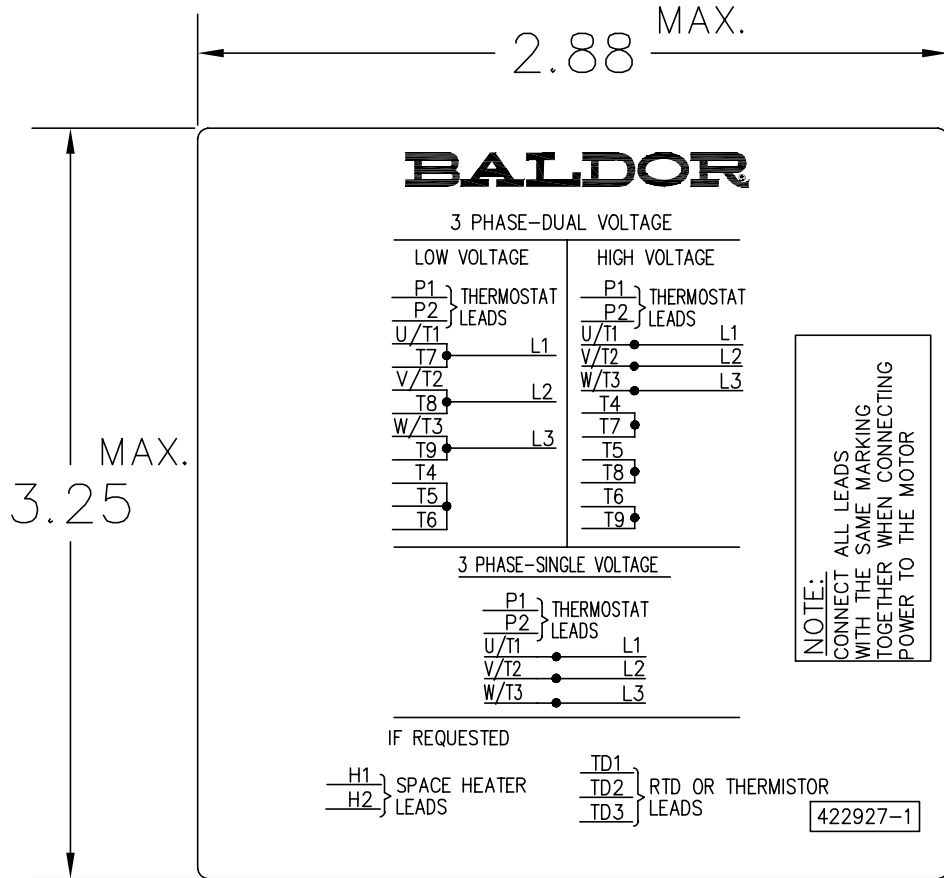

NOTE:
DATA TO BE SIZED
SO THAT IT FITS INTO
MATERIAL DECAL
DIMENSIONS. MAKE
LETTERS & NUMBERS
AS LARGE AS POSSIBLE.

MATERIAL: CERAMATIC DGF-P4
PERMA GRIP ADHESIVE

ALL LETTERS, NUMBERS
AND LINES TO BE BLACK
ON WHITE BACKGROUND.

NOTE:
CONNECT ALL LEADS
WITH THE SAME MARKING
TOGETHER WHEN CONNECTING
POWER TO THE MOTOR

422927-001

| | | |
|---|------------------------------|-------------------|
| REV. DESC: CHANGE BACKGROUND COLOR FROM GOLD TO WHITE | | |
| REV. LTR: B | VERSION: 02 | TDR: 000000788708 |
| FILE: \RGG\00000\203 | REVISED: 08:09:29 03/04/2013 | |
| MTL: - | BY: RGGWT | |

BALDOR

EXTERNAL CONNECTION LABEL

SH 1 of 1

Marketing maintained PDF of MN406:

<http://www.baldor.com/support/Literature/Load.ashx/MN406?ManNumber=MN406>