

# **BALDOR**® • ***RELIANCE***

## **Product Information Packet**

# **WDGF1015BG**

**WDF-915-10-B7-G**

<b>Nameplate NP1756</b>	
<b>INPUT H.P.</b>	1.00
<b>RATIO</b>	10
	<b>R TORQ-INLB</b> 290
	WDF-915-10-B7-G
<b>CAT./SPEC</b>	WDFG1015BG
<b>DATE CODE</b>	GR0268C002

Parts List		
Part Number	Description	Quantity
HG0035A05	915 WMGR HSG-SYMM, SEALED W/NP HOLES	1.000 EA
HA4027A01	SQUARE HEAD PIPE PLUG 1/4" NPTF #304 S.S	1.000 EA
HW5000A94	N5000-206 RETAINER RING	2.000 EA
WM0043B04	915 MTZ WORM ASSY 10:1 RATIO 7/8 BORE	1.000 EA
BG6304A01	6304 OPEN,C3,SLUSH	1.000 EA
918-9SR	5160-75 RET RING 5160-75	1.000 EA
HA3555A04	EXPANSION PLUG 2.053/2.049 X 9/32	1.000 EA
HW4600G25	SEAL 35MM X 52MM X 8MM SGL LIP FT802	1.000 EA
GF0001A01	918-3F56 GEAR FLANGE MACHINING 1.75 CD N	1.000 EA
10XN3118S20	5/16-18 X 1 1/4 HEX HEAD CAP, STAINLESS	4.000 EA
HW1001S31	WASHER, 5/16 SPLT LK, STAINLESS STEEL	4.000 EA
BS0052A02	915 BEARING SUPPORT, OPEN, FOR 3.62 B.C.	1.000 EA
GS0062A01	WORMGEAR GASKET, .003 (GREEN), 2.75 ID X	1.000 EA
GS0062A02	125MGEAR GASKET, .005 (BLUE), 2.75 ID X	2.000 EA
GS0062A03	WORMGEAR GASKET, .010 (BROWN), 2.75 ID X	2.000 EA
HW4600G39	SEAL .750 X 1.499 X .25 DBL LIP FT802	1.000 EA
HW4600B73	V-RING SLINGER 0.750 X 1.300 X .24 VITON	1.000 EA
10XN3118S12	5/16-18 X 3/4 HEX HEAD CAP, STAINLESS ST	4.000 EA
SG0032B23	915 COMP GR SHF ASSY 10:1, SGL O/P, W/SS	1.000 EA
BS0053A04	915 BEARING SUPPORT, CLOSED, FOR 3.62 B.	1.000 EA
GS0062A01	WORMGEAR GASKET, .003 (GREEN), 2.75 ID X	1.000 EA
GS0062A02	125MGEAR GASKET, .005 (BLUE), 2.75 ID X	2.000 EA
GS0062A03	WORMGEAR GASKET, .010 (BROWN), 2.75 ID X	2.000 EA
10XN3118S12	5/16-18 X 3/4 HEX HEAD CAP, STAINLESS ST	4.000 EA

Parts List (continued)		
Part Number	Description	Quantity
HA3557A01	ALLIANCE #I-5/16 MTG HOLE PLUG (YELLOW)	4.000 EA
MJ1000A90	KLUBERSYNTH UH1-6-460 WORMGEAR OIL	0.106 GA
MJ5019A01	ADHESIVE LOCTITE #680 WAS BAD4525	0.001 EA
MJ5004A35	ADHESIVE LOCTITE #243-31 50 ML	0.001 EA
MJ5001A19	LOCTITE #598 ULTRA BLACK, 50 LB PAIL, IT	0.010 LB
MG1500Y09	RAL 1001 WILKOFAS 701.09	0.010 GA
MG1025W01	WILKOFAS, 781.01, SIGNAL WHITE #9003	0.010 GA
LB5042	TOE TAG, OIL PREFILL KLUBERSYN (5000/bx)	1.000 EA
LT0066A08	REDUCER MAINT - KLUBE (1700/bx) 8/09	1.000 EA
NP1756	NAMEPLATE, GEAR REDUCER, KLUBERSYNTH UH1	1.000 EA
LB1242	ADHESIVE PATCH 1.10 X 2.03 X .045 THICK	1.000 EA
85XU0208S03	2 X 3/16 DRIVE PIN S.S. (BMH5033)	2.000 EA
35PA1000	PKG GRP, PRINT PK1008A06	1.000 EA
HW2502D12	KEY, 3/16 SQ X 1.250	1.000 EA
10XN3816S16	3/8-16 X 1 HEX HD CAP SCREW, STAINLE	4.000 EA
HW1001S38	WASHER, 3/8 SPLT LK, STAINLESS STEEL	4.000 EA
MJ1000B01	ANTISEIZE - ALTEMP Q NB 50, 750 GRAM CAN	0.001 EA
MP1009A01	4 X 4 ZIP POLYBAG, 4 MIL	1.000 EA
PK3101	EXPANDED POLYETHYLENE PAD (BSM), 8 X 6	1.000 EA
HA3556A02	WORM BORE PLUG 7/8 BORE, CAPPLUGS WW-11X	1.000 EA

<b>Accessories</b>		
<b>Part Number</b>	<b>Description</b>	<b>Multiplier</b>
WDB15H71	WASHDOWN BASE-HORIZONTAL POS. A/B 915	
133-6FBA	INPUT BUSHING KIT 5/8 TO 7/8	A8

No performance data has been assigned to this product.

GY0268A01

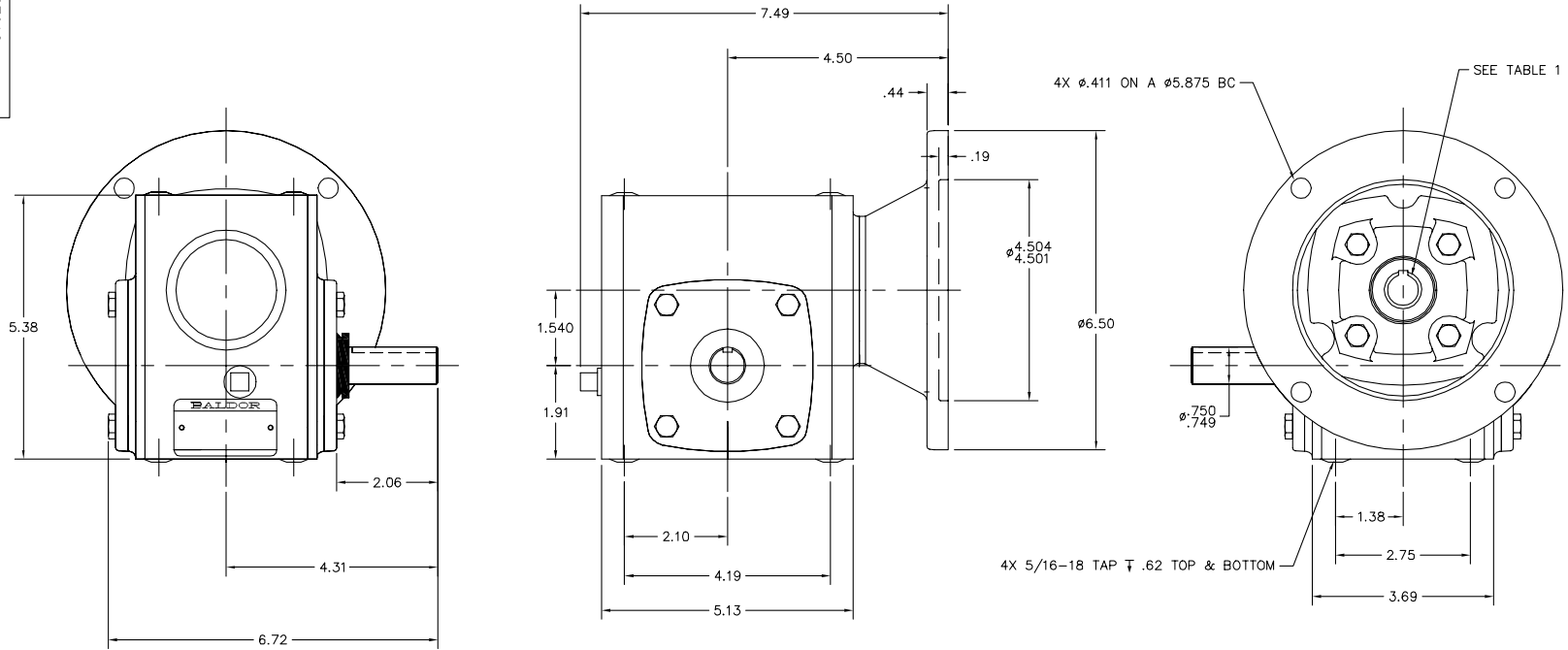

TABLE 1:

	BORE	KEYWAY
B5	.625	.188
B7	.875	.188

GY0268A01

REV. DESC: UPDATE SHAFT DIMENSION		
REV. LTR: C	VERSION: 03	TDR: 000000B56556
FILE: \CKA\00012\410	REVISED: 03:36:52 07/11/2014	BY: CKBRISO
MTL: -		

**BALDOR**  
WDF-915-G STANDARD MOUNTING  
SH 1 of 1