

# S1500 / P60CEM (MSHA)

15 HP (13 HP MSHA) ELECTRICAL SUBMERSIBLE PUMP  
FOR DIFFICULT OPERATING ENVIRONMENTS

- Robust design made from materials for demanding pump applications
- Strong Return On Investment (ROI) via extended product life and maintenance cycles
- Hydraulic options: High Head (HH), Mid Range (MR) and High Volume (HV)
- Available with CSA or MSHA certification
- Made in the USA
- Proven performance in mines, quarries, coffer dams and construction sites



**STANCOR™**

*Pump & Control Solutions*

BUILDING TRADES | CONSTRUCTION | MINING | UTILITIES | WASTEWATER

# PRODUCT FEATURES

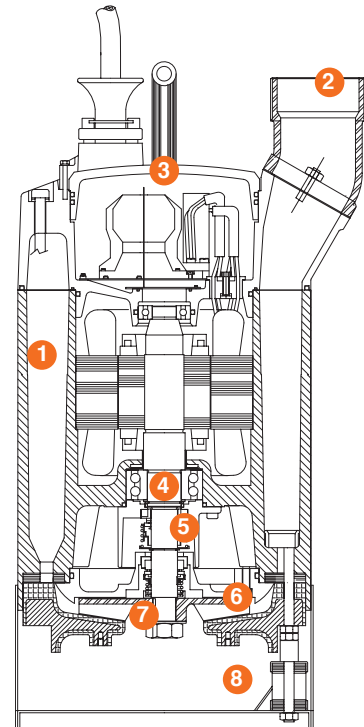
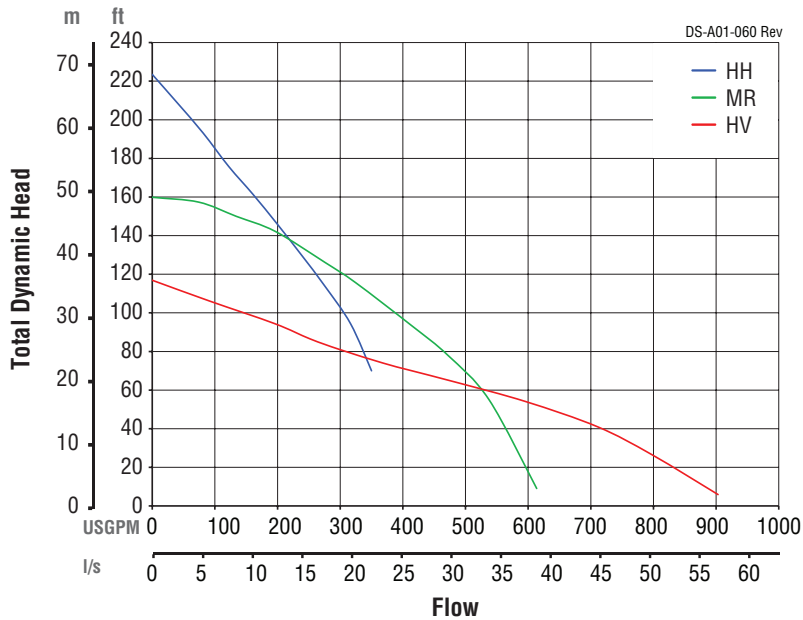

## Pump Construction

Type	Centrifugal, single stage, submersible
Discharge	4" (HH) / 6" (HV/MR) NPT
Weight	244 lbs.
Height	33"
Diameter	16.125"

## Motor Specifications

3 Phase	
Rating	15 HP (13HP MSHA)
Voltage	230/460/575/950
FL Amps	40/20/14/12
RPM	3,450
Rotor shaft	400 series stainless steel
Cable	
230/460/575V	50' 6/3 G-GC
950V	50' 12/3 SHD-GC
MSHA	230/460/575V - 50' 6/3 GGC 950V - 50' 6/3 SHD-GC

- 1 Housing:** heavy duty cast aluminum 356 T6 for durability
- 2 NPT discharge connection:** made from stainless steel to increase life
- 3 Thermal protection:** overloads in the stator provide automatic reset
- 4 Bearings:** sealed and lubricated for life to minimize maintenance
- 5 Mechanical seals:** tandem seal system for maximum leak protection
- 6 Impeller:** stainless steel is standard, upgrade option to high chrome
- 7 Wear plates:** easily adjustable, wear resistant nitrile rubber clad with many upgrades available
- 8 Strainer:** stainless steel with slotted holes to prevent debris entrance



**STANCOR™**  
Pump & Control Solutions

WWW.STANCORPUMPS.COM | 203.268.7513 |

© copyright 2018 Stancor, L.P.

