



TYPE "B" SINGLE STAGE
CENTRIFUGAL PUMP
Bearing Frame Mount

| | |
|--------------------|-----------------|
| Section | FM |
| Page | 230.1 |
| Date | January 1, 2004 |
| Supersedes 12/1/95 | |

CAST IRON IMPELLER

B5ERH

Flanged Case

Packing Construction

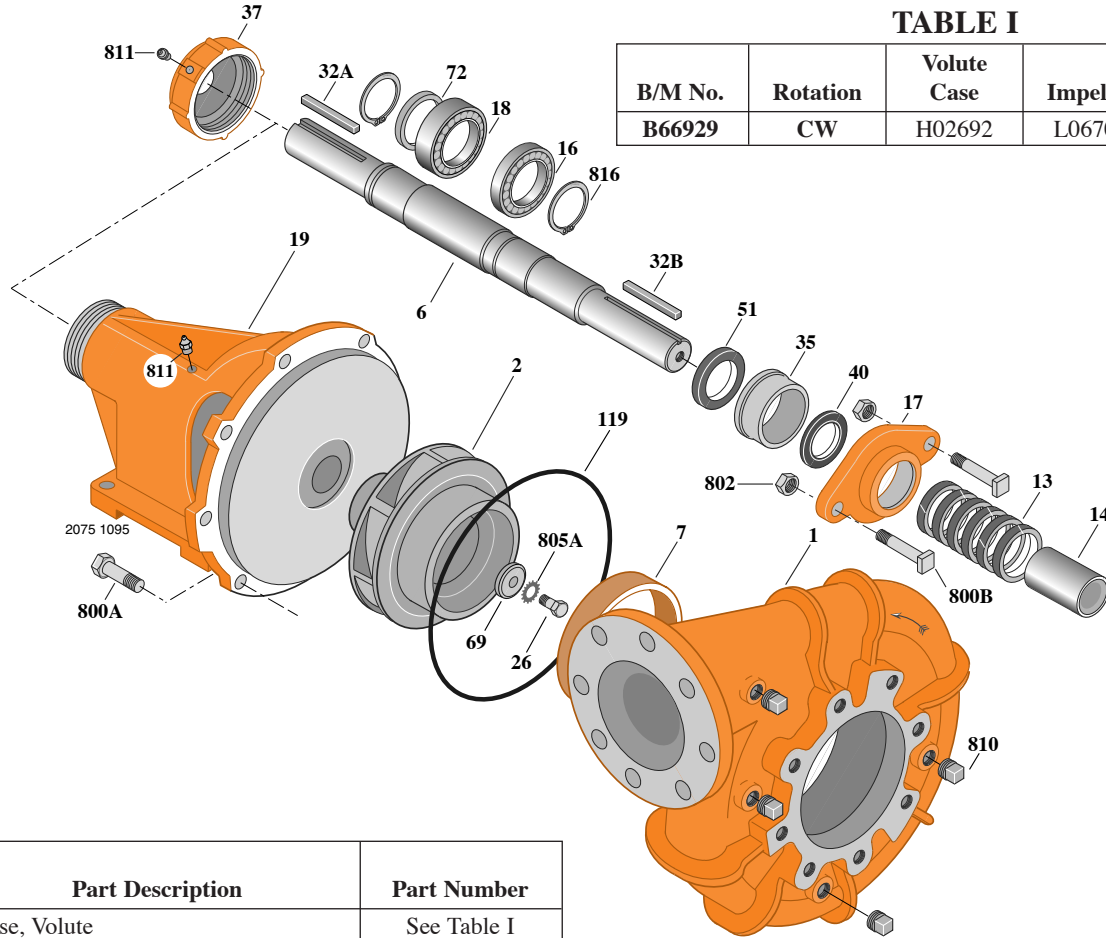

TABLE I

| B/M No. | Rotation | Volute Case | Impeller | Impeller Diameter |
|---------|----------|-------------|----------|-------------------|
| B66929 | CW | H02692 | L06709 | 10.44" |

| Item No. | Part Description | Part Number |
|----------|-----------------------------|-------------|
| 1 | Case, Volute | See Table I |
| 2 | Impeller | See Table I |
| 6 | Shaft (Not sold separately) | See Note 2 |
| 7 | Ring, Wearing | S15630 |
| 13 | Ring, Packing | S14022 |
| 14 | Sleeve, Shaft | S05127 |
| 16 | Bearing, Ball | S29895 |
| 17 | Gland, Packing (See Note 1) | S04948 |
| 18 | Bearing, Ball | S13271 |
| 19 | Frame | H02089 |
| 26 | Screw, Impeller 3/8-16x1" | S23566 |
| 32A | Key, 1/4x2-1/8" | S24255 |
| 32B | Key, 3/16x1-1/2" | S23500 |
| 35 | Inner Bearing Cap | S13214 |
| 37 | Outer Bearing Cap | S29308 |
| 40 | Slinger, Water | M09685 |
| 51 | Seal, Oil | S14763 |
| 69 | Washer, Impeller | S06314 |
| 72 | Ring, Thrust | S29218 |
| 119 | O-Ring | S13760 |

| Item No. | Part Description | Part Number |
|----------|---------------------------------------|-------------|
| 800A | Capscrew, Hex 1/2-13x1-1/4" (8 Req.) | S26914 |
| 800B | Bolt, Sq. Head 3/8-16x2-1/2" (2 Req.) | S23762 |
| 802 | Nut, Hex 3/8-16 (2 Req.) | S23343 |
| 805A | Washer, Lock | S23036 |
| 810 | Plug, Pipe 1/2 NPT (4 Req.) | S23717 |
| 811 | Fitting, Grease (3 Req.) | S23670 |
| 816 | Ring, Retaining | S23010 |

1. A two piece (split) stainless steel packing gland is available for replacement, order part number **B82468**.
2. **Shaft Replacement Kit** available for this model. Berkeley part number **B60633**. Pump Shaft sold in shaft replacement kit only.