



Type "B" Single Stage Centrifugal Pump Electric Motor Drive

| | |
|-------------------|--------------|
| Section | CC |
| Page | 320.5 |
| Date | July 1, 2011 |
| Supersedes 1/1/04 | |

BRONZE IMPELLER

B5EPBMS

Flanged Case

Mechanical Shaft Seal Construction

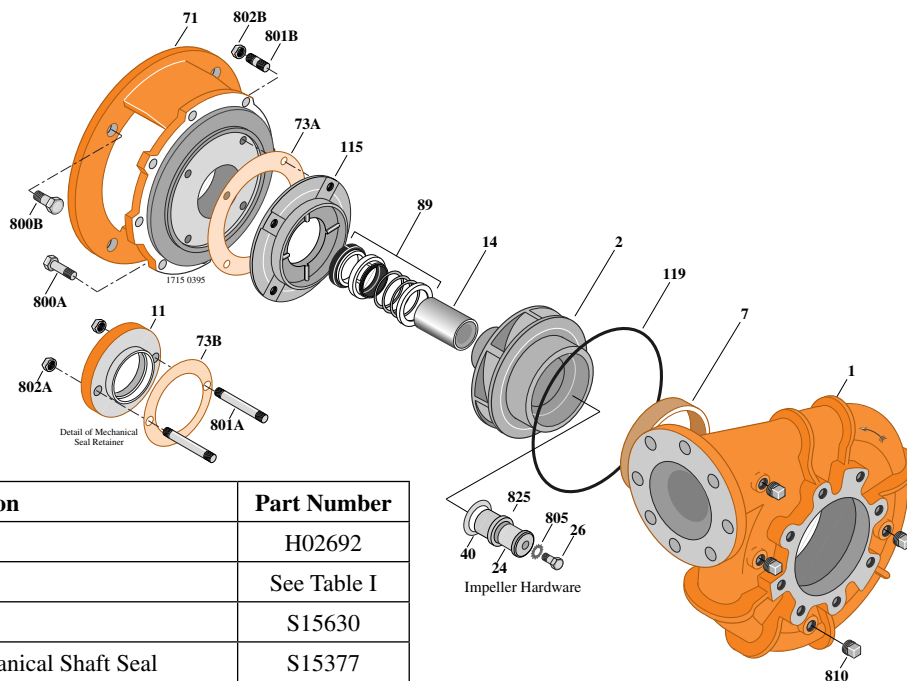

| Item | Part Description | Part Number |
|------|--------------------------------------|--------------|
| 1 | Case, Volute | H02692 |
| 2 | Impeller | See Table I |
| 7 | Ring, Wearing | S15630 |
| 11 | Retainer, Mechanical Shaft Seal | S15377 |
| 14 | Sleeve, Shaft | S07073L |
| 24 | Locknut, Impeller | S19868 |
| 26 | Screw, Impeller 1/2-13x3-1/2" | S23633 |
| 32 | Key, 3/8-2-1/4" (See Note) | S23940 |
| 40 | Deflector | S19864 |
| 71 | Bracket | See Table II |
| 73A | Gasket, Balance Ring | S09943 |
| 73B | Gasket, Seal Retainer | S15078 |
| 89 | Seal, Mechanical Shaft | S32016 |
| 115 | Ring, Balance | S12334 |
| 119 | O-Ring | S13760 |
| 800A | Capscrew, 1/2-13x1-1/4" (8 Req.) | S26914 |
| 800B | Capscrew, 5/8-11x1-3/4" (4 Req.) | S27001 |
| 801A | Stud, 3/8-16x2-1/2" (2 Req.) | S04438 |
| 801B | Stud, 3/8-16x1-1/2" (4 Req.) | S23994 |
| 802A | Nut, Hex 3/8-16 (2 Req.) | S23343 |
| 802B | Nut, Hex 3/8-16 (4 Req.) | S23103 |
| 805 | Washer, Lock | S23038 |
| 810 | Plug, Pipe 1/2 NPT (4 Req.) | S23717 |
| 820 | Connector, Comp. Fitting (2 Req.) | S23013 |
| 822 | Tubing, Copper | S20677 |
| 825 | Sleeve, Impeller Locknut | S19865 |
| • | Plug, Pipe 1/8 NPT (Not Illustrated) | S23714 |

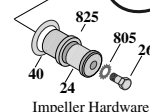

Table I

| B/M No. | HP | PH | RPM | "U" Dim. | Imp. Dia. | Imp. No. |
|---------|-----|----|------|----------|-----------|----------|
| B62093 | 75 | 3 | 3600 | 1-5/8" | 8.06" | L06120 |
| B62093S | 75 | 3 | 3600 | 1-5/8" | 8.06" | H05490 |
| B62094 | 100 | 3 | 3600 | 1-5/8" | 8.81" | L06121 |
| B62094S | 100 | 3 | 3600 | 1-5/8" | 8.81" | H05491 |

Table II

| HP | PH | Bracket No. | "AK" Fit | "U" Dim. | Motor Frame |
|-----|----|-------------|----------|----------|-------------|
| 75 | 3 | L06315 | 12-1/2" | 1-5/8" | 364JP |
| 100 | 3 | L06315 | 12-1/2" | 1-5/8" | 365JP |

NOTE: For an explanation of the tabulated material found on this page and for impeller key location, refer to *Supplement A* located at the beginning of this section.