



MARCH PUMPS

1819 PICKWICK AVE., GLENVIEW, IL 60026-1306, U.S.A
 PHONE: (847) 729-5300 - FAX: (847) 729-7062
 WWW.MARCHPUMP.COM

5C-MD, LC-5C-MD

DESCRIPTION & OPERATION: Series 5 are centrifugal magnetic drive pumps, eliminating the need for a shaft seal. All are serviceable with a screwdriver. The "LC" model is hermetically encapsulated allowing the pump to run fully submerged or in open air for complete moisture protection. Model 5C-MD must be run submerged only. See the parts list for a breakdown of parts. Pumps are not self-priming, lack a suction lift, and thus require a **flooded suction**. Pumps **cannot be run dry** because the impeller requires the liquid being pumped for lubrication. For liquids with a specific gravity greater than water, have a higher viscosity, or for elevated temperatures, a trimmed impeller may be necessary. For application assistance, contact March Pump.

Model Abbreviations: C: Polypropylene, LC: Liquid Cooled		5C-MD				LC-5C-MD			
SPECIFICATIONS									
	Product #	115 V 230 V	0150-0004-0200 0150-0004-0400				0150-0004-0500 0150-0004-0600		
	UNITS	60 Hz		50 Hz		60 Hz		50 Hz	
	Motor Type	SUB				TE/SUB			
	Max Flow	14.5 gpm		54.8 lpm		14.5 gpm		54.8 lpm	
	Max Head	27 ft / 11.7 psi		6 m		27 ft / 11.7 psi		6 m	
	Inlet - Outlet	1" FPT - 1/2" MPT				1" FPT - 1/2" MPT			
	Max Internal Pressure	50 psi / 344 kPa				25 psi / 172 kPa			
	Liquid Temperature	130 °F / 54 °C Max				130 °F / 54 °C Max			
	Packed Weight	17.40 lbs / 7.89 kg				17.70 lbs / 8.02 kg			
	ELECTRICAL 60 Hz	W	A	Hp	Rpm	W	A	Hp	Rpm
	115 V	216	1.6	1/8	3450	216	1.6	1/8	3450
	230 V	207	0.9	1/8	3450	207	0.9	1/8	3450
	ELECTRICAL 50 Hz	W	A	kW	Rpm	W	A	kW	Rpm
	115 V	147	1.2	0.093	2850	147	1.2	0.093	2850
	230 V	145	0.5	0.093	2850	145	0.5	0.093	2850
	Overall Pump Size	Height	Width	Length	Height	Width	Length	Height	Width
		6.90"	5.56"	9.85"	7.14"	5.63"	9.85"	17.5 cm	14.1 cm
		17.5 cm	14.1 cm	25.0 cm	18.1 cm	14.3 cm	25.0 cm		
	Materials in Contact with Solution:	Polypropylene, Ceramic, Buna-N, Ceramic Magnet, Noryl, Stainless, Brass, Epoxy & Cord				Wet End Polypropylene, Ceramic, Buna-N, Ceramic Magnet & Stainless			

All specifications & data are based on pumping water & are intended as a guideline only. Specifications may vary with different motors.

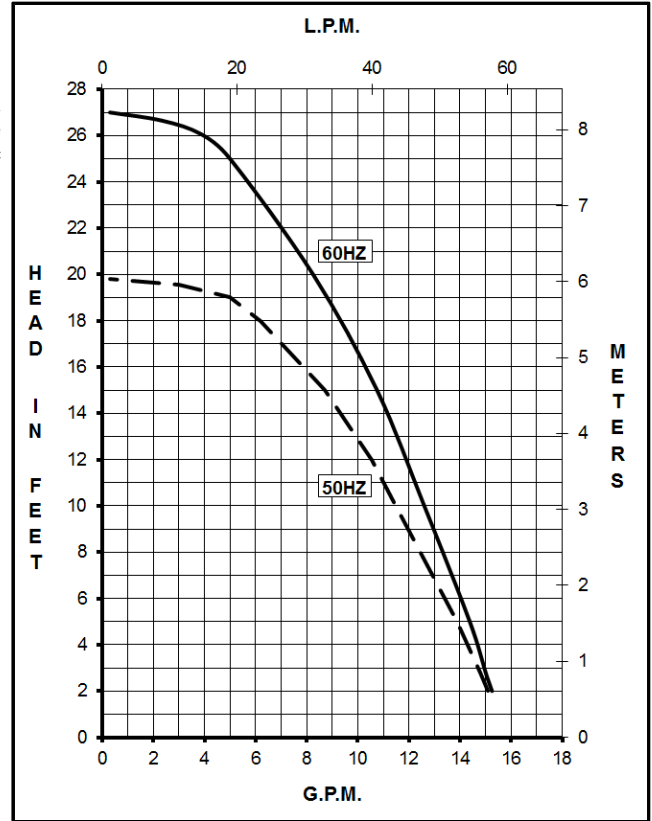

ELECTRICAL:

Motors are available in different electrical configurations such as 115 Volt 50/60 Hz, or 230 Volt 50/60 Hz, 1 phase. 115 Volt motors have a 6 ft. (1.8 m) cord with plug. 230 V motors have a 6 ft. (1.8 m) cord with no plug. The motors are U.L. listed and rated as continuous duty.

LIMITED WARRANTY:

March pumps are guaranteed only against defects in workmanship or materials for a period of one year from date of manufacture pumping water. For the complete warranty and to register online go to www.marchpump.com/warranty-registration

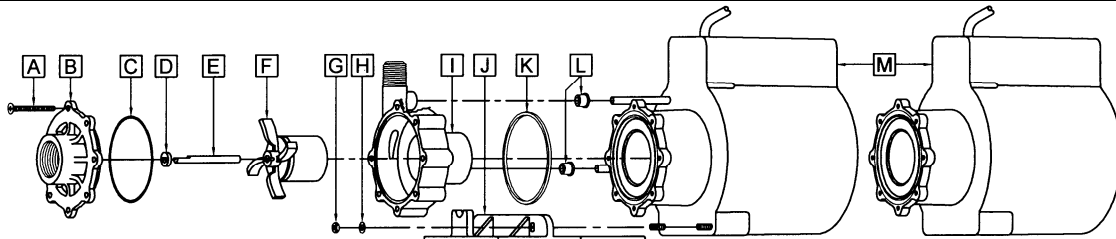

#	DESCRIPTION	5C-MD	LC-5C-MD	SIZE (Inches)	QTY.	5C-MD	LC-5C-MD
A	Screw		Stainless	#8-32 x 1-3/4 Lg.	7	0150-0021-1000	
B	Cover		Polypropylene	1 FPT Inlet	1	0150-0032-1000	
C	"O" Ring		Buna N	0.078 CS x 2.834 ID	1	0750-0987-1000	
D	Thrust Washer		Ceramic		1	0130-0028-1000	
E	Shaft		Ceramic		1	0130-0024-1000	
F	Impeller with Ceramic Magnet		Polypropylene		1	0150-0030-0100	
G	Nut		Stainless	#10-32	2		0802-0008-1000
H	Lock Washer		Stainless	#10	2		0802-0006-1000
I	Rear Housing w/Ceramic Thrust Washer	Polypropylene	Polypropylene & Plug	1/2 MPT	1	0150-0031-0100	0150-0153-0200
J	Mounting Base		Noryl		1		0150-0155-1000
K	Bracket "O" Ring		Buna N	Quad Ring	1	0150-0020-1000	
L	Cooling Tube Seal		Buna N		2		0125-0007-1000
M	Epoxy Motor Assembly	L.C. Epoxy Motor Assembly			n/a	Not Available	Not Available

NOTE: Contact Factory for other materials and/or parts not listed.

0150-0060-1100 R3