

## ELECTRONIC PRICING CATALOG NAVIGATION INSTRUCTIONS



Questions? Call **1-800-810-1053**

### Select by Pump Model:

If you know what pump you are looking for, you can use the 'Bookmarks' tab on the left and select the pump model which you are trying to access. Clicking in the Bookmark will take you to the page you are looking for.

If there are no tabs on the left (bookmarks, signatures, layers, pages), you can use the top menu to make them appear. Goto VIEW > SHOW/HIDE > NAVIGATION PANES > BOOKMARKS and they will appear.

**Sample Pump ID Tag:** See the illustration below for help identifying the location of the Model number and Serial number on the pump ID tag.

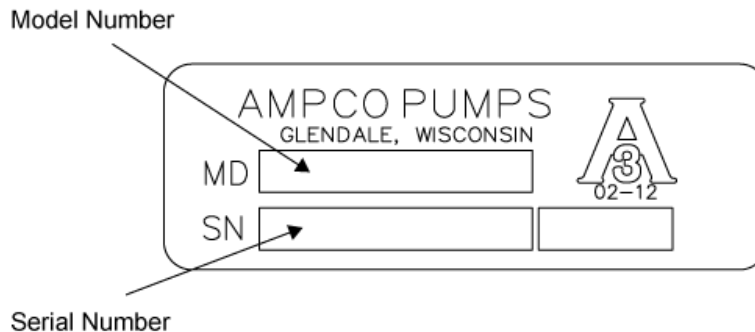

*Please reference your serial number when ordering replacement parts.*

### Select by Part Number:

If you know an exact part number you are looking for, simply hit CONTROL+F and that will bring up the find feature. You may also use the menu, goto EDIT > FIND to bring up the same feature.

Type in your part number and it will show you all instances of that item in the catalog. If you only know some of the part number (i.e. SP328), that will also help and show all occurrences of those numbers together.

Be advised that partials of part number can return a large amount of results.

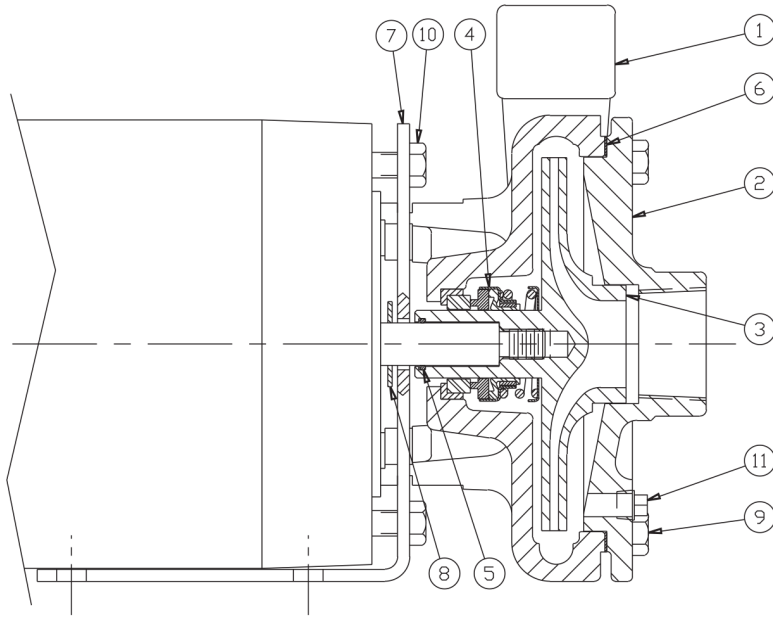

Ref #	Component
1	Casing
2	Cover
3	Impeller
4	Seal Kit
5	O-Ring, Impeller
6	Gasket, Cover
7	Mounting Bracket
8	Slinger
9	Capscrew (Casing/Cover)
10	Capscrew (Motor/Bracket)

**Exploded View**

*Optional Items Shown in ITALICS*

Ref #	Component Item No.	Description	Qty Per
1	BV8401201	CASING,1-1/4X1,BZ KC2	1
2	BC8301671	COVER,1-1/4X1,BZ KC2	1
3	BI8202990	IMPELLER,1-1/4X1,BZ KC2	1
4	GS8104320	KIT,1",T21,CE/CA/BU KC2	1
	<i>GS8104320-316SS</i>	<i>KIT,1",T21,CE/CA/BU,316 SSMET KC2</i>	<i>1</i>
	<i>GS8105990</i>	<i>KIT,1",T21,CE/CA/VI KC2</i>	<i>1</i>
	<i>GS8105990-316SS</i>	<i>KIT,1",T21,CE/CA/VI,316SS MET KC2</i>	<i>1</i>
	<i>GS8107100</i>	<i>KIT,1",T21,CE/CA/EP KC2</i>	<i>1</i>
	<i>GS8105890</i>	<i>KIT,1",T21,NI/CA/BU KC2</i>	<i>1</i>
	<i>GS8105890-316SS</i>	<i>KIT,1",T21,NI/CA/BU,316SS MET KC2</i>	<i>1</i>
	<i>GS8106500</i>	<i>KIT,1",T21,NI/CA/VI KC2</i>	<i>1</i>
	<i>GS8107260</i>	<i>KIT,1",T21,TC/CA/VI KC2</i>	<i>1</i>
	<i>GS8108010</i>	<i>KIT,1",T21,SC/CA/VI KC2</i>	<i>1</i>
	<i>GS8108010-316SS</i>	<i>KIT,1",T21,SC/CA/VI,316SS MET KC2</i>	<i>1</i>
	<i>GS8111150-316SS</i>	<i>KIT,1",T21,TC/SC/BU,316SS MET KC2</i>	<i>1</i>
5	GX5100400	O-RING,IMPLR,BUNA K2 (2-016 BUNA 70)	1
	<i>GX5100402</i>	<i>O-RING,IMPLR,EPDM K2</i>	<i>1</i>
	<i>GX5100401</i>	<i>O-RING,IMPLR,VIT 2-016V884 K2</i>	<i>1</i>
6	GX5039902	GASKET,6-1/8X5-9/16X1/32 ,N-8090	1
7	GX8301591	BRACKET,121/151/175.MOUNTING KC2	1
	<i>SX8301592</i>	<i>BRACKET,MOUNTING,SS KC2</i>	<i>1</i>
8	GX5042200	SLINGER,19/32X1-1/4X1/16 80 DUR	1
9	GX5077100	CAPSCRW,HX,3/8-16X1,18-8SS HX HD	4
10	GX5077100	CAPSCRW,HX,3/8-16X1,18-8SS HX HD	4

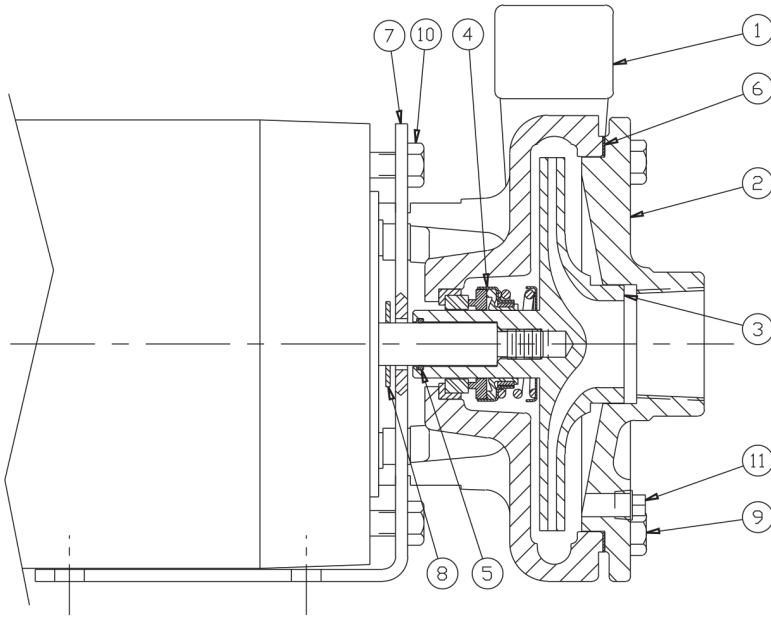

Ref #	Component
1	Casing
2	Cover
3	Impeller
4	Seal Kit
5	O-Ring, Impeller
6	Gasket, Cover
7	Mounting Bracket
8	Slinger
9	Capscrew (Casing/Cover)
10	Capscrew (Motor/Bracket)

**Exploded View**

*Optional Items Shown in ITALICS*

Ref #	Component Item No.	Description	Qty Per
1	BV8401201	CASING,1-1/4X1,BZ KC2	1
2	BC8302341	COVER,1-1/2X1,BZ KC2	1
3	BI8203890	IMPELLER,1-1/2X1,BZ KC2	1
4	GS8104320	KIT,1",T21,CE/CA/BU KC2	1
	<i>GS8104320-316SS</i>	<i>KIT,1",T21,CE/CA/BU,316 SSMET KC2</i>	<i>1</i>
	<i>GS8105990</i>	<i>KIT,1",T21,CE/CA/VI KC2</i>	<i>1</i>
	<i>GS8105990-316SS</i>	<i>KIT,1",T21,CE/CA/VI,316SS MET KC2</i>	<i>1</i>
	<i>GS8107100</i>	<i>KIT,1",T21,CE/CA/EP KC2</i>	<i>1</i>
	<i>GS8105890</i>	<i>KIT,1",T21,NI/CA/BU KC2</i>	<i>1</i>
	<i>GS8105890-316SS</i>	<i>KIT,1",T21,NI/CA/BU,316SS MET KC2</i>	<i>1</i>
	<i>GS8106500</i>	<i>KIT,1",T21,NI/CA/VI KC2</i>	<i>1</i>
	<i>GS8107260</i>	<i>KIT,1",T21,TC/CA/VI KC2</i>	<i>1</i>
	<i>GS8108010</i>	<i>KIT,1",T21,SC/CA/VI KC2</i>	<i>1</i>
	<i>GS8108010-316SS</i>	<i>KIT,1",T21,SC/CA/VI,316SS MET KC2</i>	<i>1</i>
	<i>GS8111150-316SS</i>	<i>KIT,1",T21,TC/SC/BU,316SS MET KC2</i>	<i>1</i>
5	GX5100400	O-RING,IMPLR,BUNA K2 (2-016 BUNA 70)	1
	<i>GX5100402</i>	<i>O-RING,IMPLR,EPDM K2</i>	<i>1</i>
	<i>GX5100401</i>	<i>O-RING,IMPLR,VIT 2-016V884 K2</i>	<i>1</i>
6	GX5039902	GASKET,6-1/8X5-9/16X1/32 ,N-8090	1
7	GX8301591	BRACKET,121/151/175.MOUNTING KC2	1
	<i>SX8301592</i>	<i>BRACKET,MOUNTING,SS KC2</i>	<i>1</i>
8	GX5042200	SLINGER,19/32X1-1/4X1/16 80 DUR	1
9	GX5077100	CAPSCRW,HX,3/8-16X1,18-8SS HX HD	4
10	GX5077100	CAPSCRW,HX,3/8-16X1,18-8SS HX HD	4

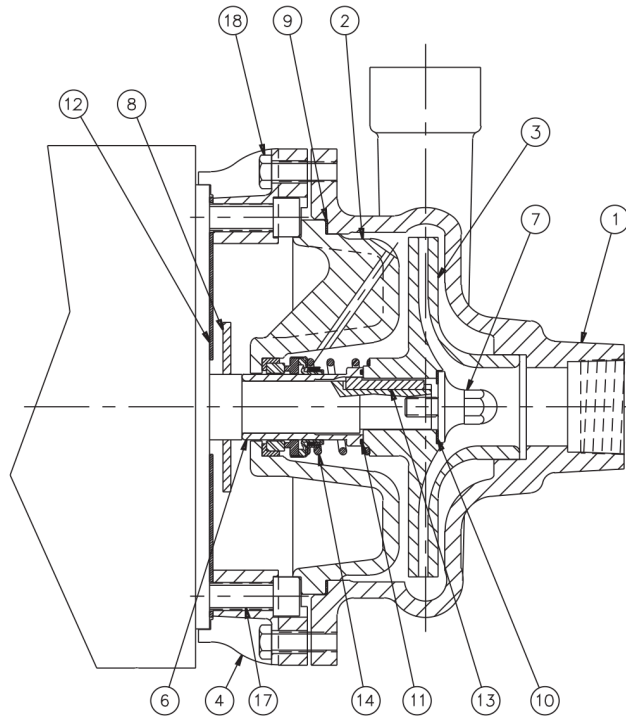

Ref #	Component
1	Casing
2	Cover
3	Impeller
4	Adapter
5	Wear Ring
6	Shaft Sleeve
7	Impeller Screw
8	Slinger
9	Gasket, Impeller Screw
10	Gasket, Casing
11	O-Ring, Shaft Sleeve
12	Splashplate
13	Key, Impeller
14	Seal Kit
17	Capscrew (Motor/Adapter)
18	Capscrew (Casing/Adapter)

**Exploded View**

*Optional Items Shown in ITALICS*

Ref #	Component Item No.	Description	Qty Per
1	BV8402321	CASING,1-1/2X1-1/4,BZ KC2	1
2	BC8301331	COVER,2-1/2X2,BZ ZC2	1
3	BI8200051	IMPELLER,1-1/2X1-1/4,BZ ZC2	1
4	GX8400951	ADAPTER,100 JM FRAME ZC2	1
	<i>SX8400952</i>	<i>ADAPTER,100 JM FRAME,SS ZC2</i>	<i>1</i>
6	BX8103722	SLEEVE,SHFT,BZ ZC2	1
7	BI8101271	SCREW,IMP,BZ EC/ZC2	1
8	GX5042301	SLINGER,1-7/32X3-1/4X5/32 80 DUR (180JM-210JM)	1
	<i>GX5042300</i>	<i>SLINGER,1-1/8X3-1/4X5/32 80 DUR (140JM)</i>	<i>1</i>
9	GX5041000	GASKET,6-5/8X7-5/32X1/32 ,N-8090	1
10	GX5040500	GASKET,IMP SCRW,7/8X1-3/8X1/32	1
11	GX5098300	O-RING,T21,1-1/4,BUNA,SLV	1
	<i>GX5098301</i>	<i>O-RING,T21,1-1/4,EPDM,SLV (1-1/4 X 1-3/8 X 1/16)</i>	<i>1</i>
	<i>GX5098302</i>	<i>O-RING,43/252/325,VIT DC3</i>	<i>1</i>
12	GX5091600	SPLASHPLATE,EC2/KC2/RC2/ZC2,SS FR143-184	1
13	GX5051300	KEY,IMP, .187SQX1.5 EC KC RC ZC	1
14	GS8103410	KIT,1-1/4,T21,CE/CA/BU ZC2	1
	<i>GS8103410-316SS</i>	<i>KIT,1-1/4,T21,CE/CA/BU,316SS MET ZC2</i>	<i>1</i>
	<i>GS8105960</i>	<i>KIT,1-1/4,T21,CE/CA/VI ZC2</i>	<i>1</i>
	<i>GS8105960-316SS</i>	<i>KIT,1-1/4,T21,CE/CA/VI,316SS MET ZC2</i>	<i>1</i>
	<i>GS8106590</i>	<i>KIT,1-1/4,T21,NI/CA/BU ZC2</i>	<i>1</i>
	<i>GS8106590-316SS</i>	<i>KIT,1-1/4,T21,NI/CA/BU,316SS MET ZC2</i>	<i>1</i>
	<i>GS8106620</i>	<i>KIT,1-1/4,T21,CE/CA/EP ZC2</i>	<i>1</i>
	<i>GS8106620-316SS</i>	<i>KIT,1-1/4,T21,CE/CA/EP,316SS MET ZC2</i>	<i>1</i>
	<i>GS8106610</i>	<i>KIT,1-1/4,T21,TC/CA/VI ZC2 1512,215,252,325,43</i>	<i>1</i>
	<i>GS8107830</i>	<i>KIT,1-1/4,T21,SC/CA/VI ZC2</i>	<i>1</i>
	<i>GS8111170-316SS</i>	<i>KIT,1-1/4,T21,TC/SC/BU,316SS MET ZC2 1512,215,252,325,43</i>	<i>1</i>

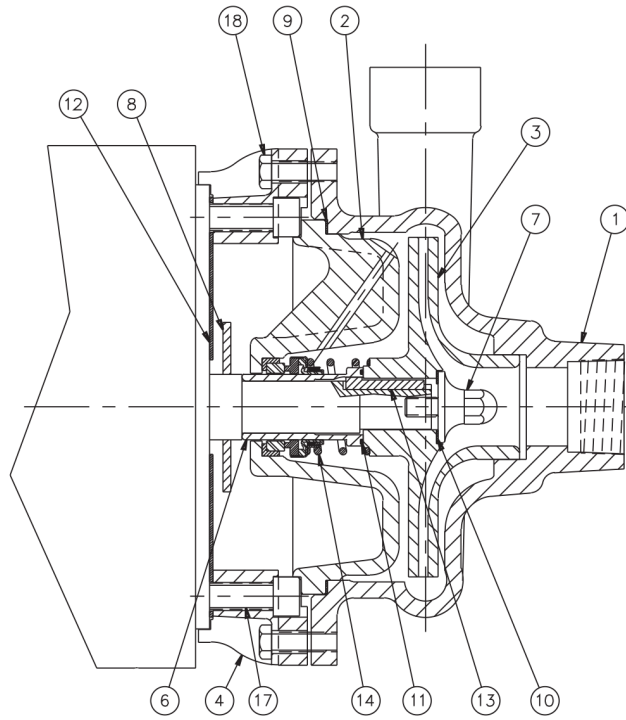

Ref #	Component
1	Casing
2	Cover
3	Impeller
4	Adapter
5	Wear Ring
6	Shaft Sleeve
7	Impeller Screw
8	Slinger
9	Gasket, Impeller Screw
10	Gasket, Casing
11	O-Ring, Shaft Sleeve
12	Splashplate
13	Key, Impeller
14	Seal Kit
17	Capscrew (Motor/Adapter)
18	Capscrew (Casing/Adapter)

**Exploded View**

*Optional Items Shown in ITALICS*

Ref #	Component Item No.	Description	Qty Per
17	<b>GX5077100</b>	<b>CAPSCRW,HX,3/8-16X1,18-8SS HX HD</b>	<b>4</b>
18	<b>GX5077100</b>	<b>CAPSCRW,HX,3/8-16X1,18-8SS HX HD</b>	<b>8</b>

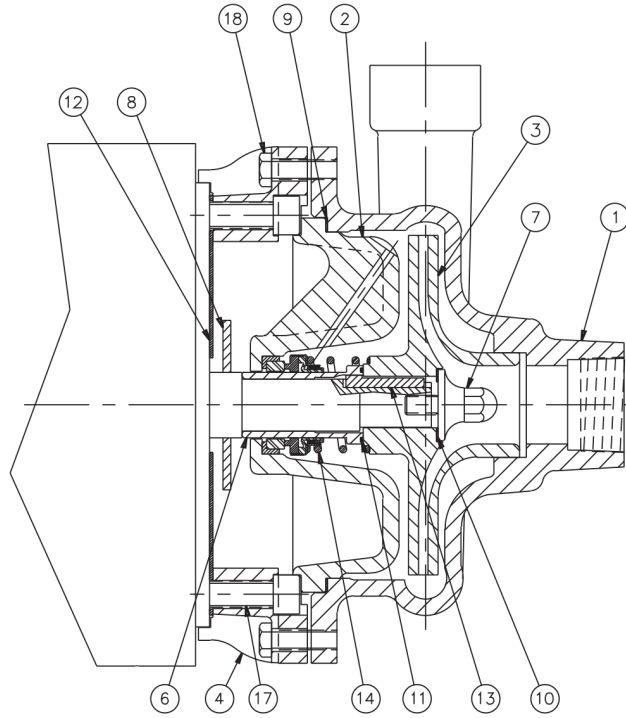

Ref #	Component
1	Casing
2	Cover
3	Impeller
4	Adapter
5	Wear Ring
6	Shaft Sleeve
7	Impeller Screw
8	Slinger
9	Gasket, Impeller Screw
10	Gasket, Casing
11	O-Ring, Shaft Sleeve
12	Splashplate
13	Key, Impeller
14	Seal Kit
17	Capscrew (Motor/Adapter)
18	Capscrew (Casing/Adapter)

**Exploded View**

*Optional Items Shown in ITALICS*

Ref #	Component Item No.	Description	Qty Per
1	BV8402321	CASING,1-1/2X1-1/4,BZ KC2	1
2	BC8301331	COVER,2-1/2X2,BZ ZC2	1
3	BI8200051	IMPELLER,1-1/2X1-1/4,BZ ZC2	1
4	GX8301391	ADAPTER,210 JM FRAME ZC2	1
	<i>SX8301392</i>	<i>ADAPTER,210 JM FRAME,SS ZC2</i>	<i>1</i>
6	BX8103722	SLEEVE,SHFT,BZ ZC2	1
7	BI8101271	SCREW,IMP,BZ EC/ZC2	1
8	GX5042301	SLINGER,1-7/32X3-1/4X5/32 80 DUR (180JM-210JM)	1
9	GX5041000	GASKET,6-5/8X7-5/32X1/32 ,N-8090	1
10	GX5040500	GASKET,IMP SCRW,7/8X1-3/8X1/32	1
11	GX5098300	O-RING,T21,1-1/4,BUNA,SLV	1
	<i>GX5098301</i>	<i>O-RING,T21,1-1/4,EPDM,SLV (1-1/4 X 1-3/8 X 1/16)</i>	<i>1</i>
	<i>GX5098302</i>	<i>O-RING,43/252/325,VIT DC3</i>	<i>1</i>
12	GX5091400	SPLASHPLATE,EC2/KC2/RC2/ZC2,SS FR213-256	1
13	GX5051300	KEY,IMP,.187SQX1.5 EC KC RC ZC	1
14	GS8103410	KIT,1-1/4,T21,CE/CA/BU ZC2	1
	<i>GS8103410-316SS</i>	<i>KIT,1-1/4,T21,CE/CA/BU,316SS MET ZC2</i>	<i>1</i>
	<i>GS8105960</i>	<i>KIT,1-1/4,T21,CE/CA/VI ZC2</i>	<i>1</i>
	<i>GS8105960-316SS</i>	<i>KIT,1-1/4,T21,CE/CA/VI,316SS MET ZC2</i>	<i>1</i>
	<i>GS8106590</i>	<i>KIT,1-1/4,T21,NI/CA/BU ZC2</i>	<i>1</i>
	<i>GS8106590-316SS</i>	<i>KIT,1-1/4,T21,NI/CA/BU,316SS MET ZC2</i>	<i>1</i>
	<i>GS8106620</i>	<i>KIT,1-1/4,T21,CE/CA/EP ZC2</i>	<i>1</i>
	<i>GS8106620-316SS</i>	<i>KIT,1-1/4,T21,CE/CA/EP,316SS MET ZC2</i>	<i>1</i>
	<i>GS8106610</i>	<i>KIT,1-1/4,T21,TC/CA/VI ZC2 1512,215,252,325,43</i>	<i>1</i>
	<i>GS8107830</i>	<i>KIT,1-1/4,T21,SC/CA/VI ZC2</i>	<i>1</i>
	<i>GS8111170-316SS</i>	<i>KIT,1-1/4,T21,TC/SC/BU,316SS MET ZC2 1512,215,252,325,43</i>	<i>1</i>
17	GX5077400	CAPSCRW,SH,1/2-13X1-3/4,BLK OX SCKT HD	4

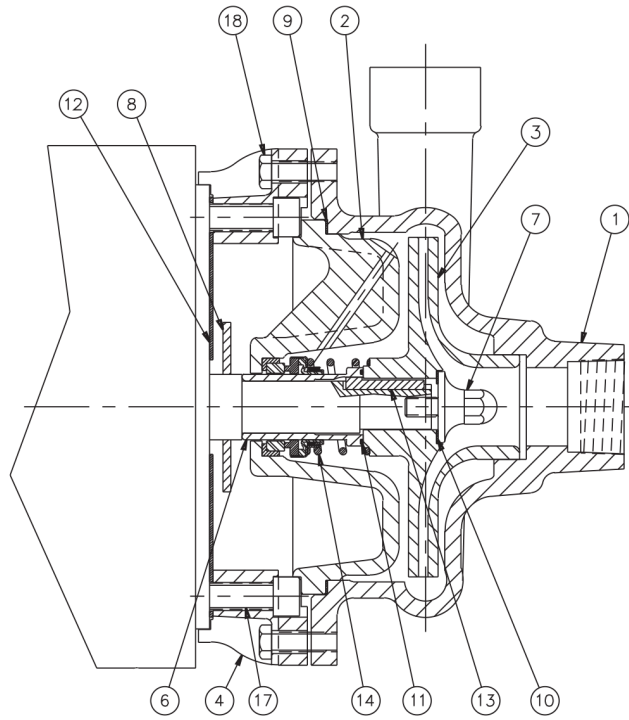

Ref #	Component
1	Casing
2	Cover
3	Impeller
4	Adapter
5	Wear Ring
6	Shaft Sleeve
7	Impeller Screw
8	Slinger
9	Gasket, Impeller Screw
10	Gasket, Casing
11	O-Ring, Shaft Sleeve
12	Splashplate
13	Key, Impeller
14	Seal Kit
17	Capscrew (Motor/Adapter)
18	Capscrew (Casing/Adapter)

**Exploded View**

*Optional Items Shown in ITALICS*

Ref #	Component Item No.	Description	Qty Per
18	<b>GX5077100</b>	<b>CAPSCRW,HX,3/8-16X1,18-8SS HX HD</b>	<b>4</b>
	<i>GX5077200</i>	<i>CAPSCRW,HX,3/8-16X1-1/4,18-8SS HX HD</i>	<i>4</i>

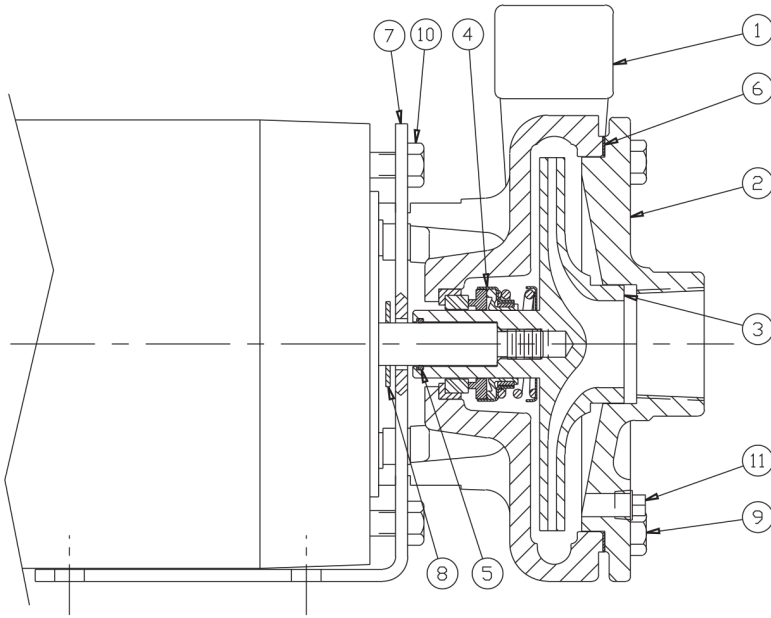

Ref #	Component
1	Casing
2	Cover
3	Impeller
4	Seal Kit
5	O-Ring, Impeller
6	Gasket, Cover
7	Mounting Bracket
8	Slinger
9	Capscrew (Casing/Cover)
10	Capscrew (Motor/Bracket)

**Exploded View**

*Optional Items Shown in ITALICS*

Ref #	Component Item No.	Description	Qty Per
1	BV8401152	CASING,1X3/4,BZ KC2	1
2	BC8301602	COVER,1X3/4,BZ KC2	1
3	BI8202801	IMPELLER,1X3/4,BZ KC2	1
4	GS8104320	KIT,1",T21,CE/CA/BU KC2	1
	<i>GS8104320-316SS</i>	<i>KIT,1",T21,CE/CA/BU,316 SSMET KC2</i>	<i>1</i>
	<i>GS8105990</i>	<i>KIT,1",T21,CE/CA/VI KC2</i>	<i>1</i>
	<i>GS8105990-316SS</i>	<i>KIT,1",T21,CE/CA/VI,316SS MET KC2</i>	<i>1</i>
	<i>GS8107100</i>	<i>KIT,1",T21,CE/CA/EP KC2</i>	<i>1</i>
	<i>GS8105890</i>	<i>KIT,1",T21,NI/CA/BU KC2</i>	<i>1</i>
	<i>GS8105890-316SS</i>	<i>KIT,1",T21,NI/CA/BU,316SS MET KC2</i>	<i>1</i>
	<i>GS8106500</i>	<i>KIT,1",T21,NI/CA/VI KC2</i>	<i>1</i>
	<i>GS8107260</i>	<i>KIT,1",T21,TC/CA/VI KC2</i>	<i>1</i>
	<i>GS8108010</i>	<i>KIT,1",T21,SC/CA/VI KC2</i>	<i>1</i>
	<i>GS8108010-316SS</i>	<i>KIT,1",T21,SC/CA/VI,316SS MET KC2</i>	<i>1</i>
	<i>GS8111150-316SS</i>	<i>KIT,1",T21,TC/SC/BU,316SS MET KC2</i>	<i>1</i>
5	GX5100400	O-RING,IMPLR,BUNA K2 (2-016 BUNA 70)	1
	<i>GX5100402</i>	<i>O-RING,IMPLR,EPDM K2</i>	<i>1</i>
	<i>GX5100401</i>	<i>O-RING,IMPLR,VIT 2-016V884 K2</i>	<i>1</i>
6	GX5039901	GASKET,5-1/16X5-5/8X1/32 ,N-8090	1
7	GX8301591	BRACKET,121/151/175.MOUNTING KC2	1
	<i>SX8301592</i>	<i>BRACKET,MOUNTING,SS KC2</i>	<i>1</i>
8	GX5042200	SLINGER,19/32X1-1/4X1/16 80 DUR	1
9	GX5077100	CAPSCRW,HX,3/8-16X1,18-8SS HX HD	4
10	GX5077100	CAPSCRW,HX,3/8-16X1,18-8SS HX HD	4

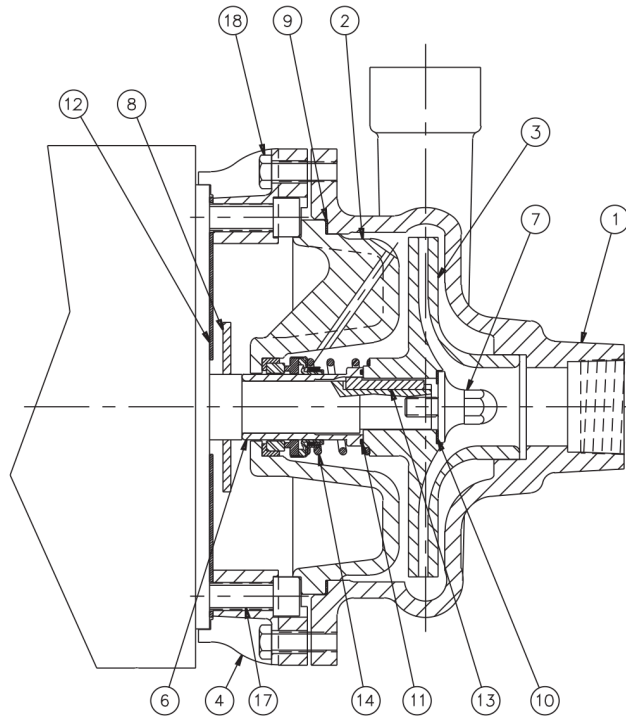

Ref #	Component
1	Casing
2	Cover
3	Impeller
4	Adapter
5	Wear Ring
6	Shaft Sleeve
7	Impeller Screw
8	Slinger
9	Gasket, Impeller Screw
10	Gasket, Casing
11	O-Ring, Shaft Sleeve
12	Splashplate
13	Key, Impeller
14	Seal Kit
17	Capscrew (Motor/Adapter)
18	Capscrew (Casing/Adapter)

**Exploded View**

*Optional Items Shown in ITALICS*

Ref #	Component Item No.	Description	Qty Per
1	BV8402351	CASING,2X1-1/2,BZ KC2	1
2	BC8301331	COVER,2-1/2X2,BZ ZC2	1
3	BI8200061	IMPELLER,2X1-1/2,BZ ZC2	1
4	GX8400951	ADAPTER,100 JM FRAME ZC2	1
	<i>SX8400952</i>	<i>ADAPTER,100 JM FRAME,SS ZC2</i>	<i>1</i>
6	BX8103722	SLEEVE,SHFT,BZ ZC2	1
7	BI8101271	SCREW,IMP,BZ EC/ZC2	1
8	GX5042301	SLINGER,1-7/32X3-1/4X5/32 80 DUR (180JM-210JM)	1
	<i>GX5042300</i>	<i>SLINGER,1-1/8X3-1/4X5/32 80 DUR (140JM)</i>	<i>1</i>
9	GX5041000	GASKET,6-5/8X7-5/32X1/32 ,N-8090	1
10	GX5040500	GASKET,IMP SCRW,7/8X1-3/8X1/32	1
11	GX5098300	O-RING,T21,1-1/4,BUNA,SLV	1
	<i>GX5098301</i>	<i>O-RING,T21,1-1/4,EPDM,SLV (1-1/4 X 1-3/8 X 1/16)</i>	<i>1</i>
	<i>GX5098302</i>	<i>O-RING,43/252/325,VIT DC3</i>	<i>1</i>
12	GX5091600	SPLASHPLATE,EC2/KC2/RC2/ZC2,SS FR143-184	1
13	GX5051300	KEY,IMP, .187SQX1.5 EC KC RC ZC	1
14	GS8103410	KIT,1-1/4,T21,CE/CA/BU ZC2	1
	<i>GS8103410-316SS</i>	<i>KIT,1-1/4,T21,CE/CA/BU,316SS MET ZC2</i>	<i>1</i>
	<i>GS8105960</i>	<i>KIT,1-1/4,T21,CE/CA/VI ZC2</i>	<i>1</i>
	<i>GS8105960-316SS</i>	<i>KIT,1-1/4,T21,CE/CA/VI,316SS MET ZC2</i>	<i>1</i>
	<i>GS8106590</i>	<i>KIT,1-1/4,T21,NI/CA/BU ZC2</i>	<i>1</i>
	<i>GS8106590-316SS</i>	<i>KIT,1-1/4,T21,NI/CA/BU,316SS MET ZC2</i>	<i>1</i>
	<i>GS8106620</i>	<i>KIT,1-1/4,T21,CE/CA/EP ZC2</i>	<i>1</i>
	<i>GS8106620-316SS</i>	<i>KIT,1-1/4,T21,CE/CA/EP,316SS MET ZC2</i>	<i>1</i>
	<i>GS8106610</i>	<i>KIT,1-1/4,T21,TC/CA/VI ZC2 1512,215,252,325,43</i>	<i>1</i>
	<i>GS8107830</i>	<i>KIT,1-1/4,T21,SC/CA/VI ZC2</i>	<i>1</i>
	<i>GS8111170-316SS</i>	<i>KIT,1-1/4,T21,TC/SC/BU,316SS MET ZC2 1512,215,252,325,43</i>	<i>1</i>

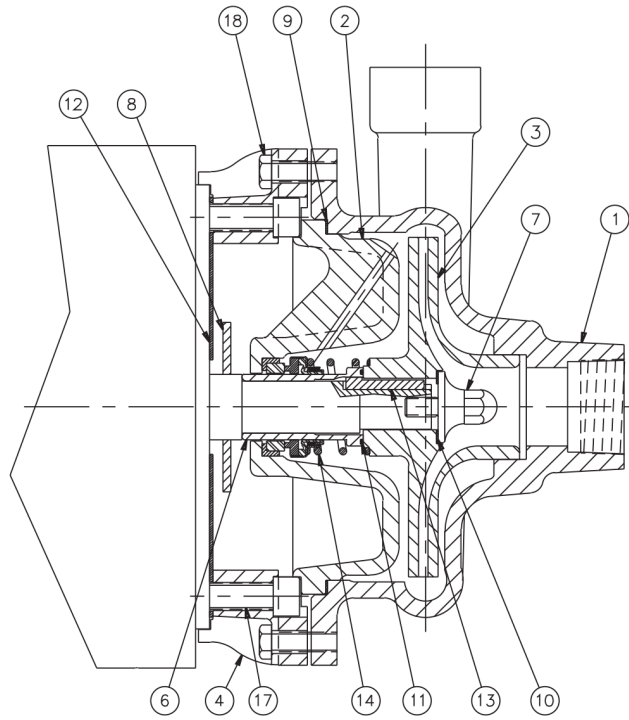

Ref #	Component
1	Casing
2	Cover
3	Impeller
4	Adapter
5	Wear Ring
6	Shaft Sleeve
7	Impeller Screw
8	Slinger
9	Gasket, Impeller Screw
10	Gasket, Casing
11	O-Ring, Shaft Sleeve
12	Splashplate
13	Key, Impeller
14	Seal Kit
17	Capscrew (Motor/Adapter)
18	Capscrew (Casing/Adapter)

**Exploded View**

*Optional Items Shown in ITALICS*

Ref #	Component Item No.	Description	Qty Per
17	<i>GX5077100</i>	<i>CAPSCRW,HX,3/8-16X1,18-8SS HX HD</i>	<i>4</i>
18	<i>GX5077100</i>	<i>CAPSCRW,HX,3/8-16X1,18-8SS HX HD</i>	<i>8</i>

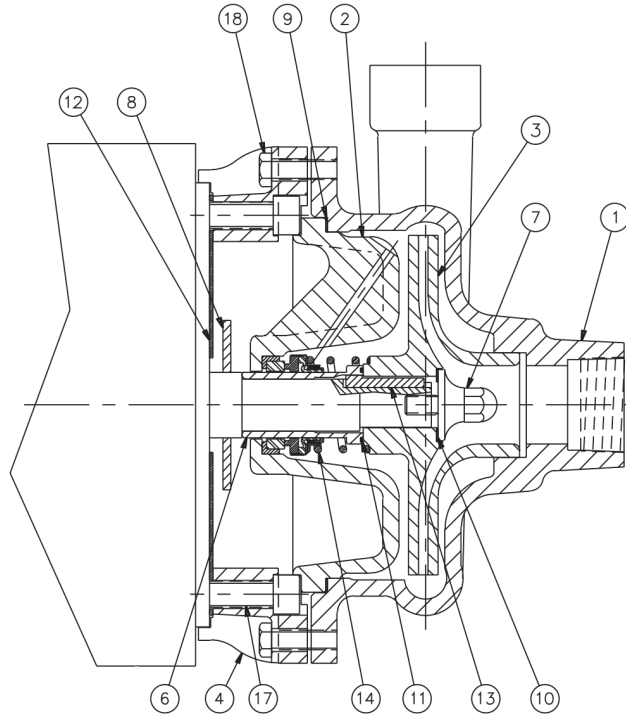

Ref #	Component
1	Casing
2	Cover
3	Impeller
4	Adapter
5	Wear Ring
6	Shaft Sleeve
7	Impeller Screw
8	Slinger
9	Gasket, Impeller Screw
10	Gasket, Casing
11	O-Ring, Shaft Sleeve
12	Splashplate
13	Key, Impeller
14	Seal Kit
17	Capscrew (Motor/Adapter)
18	Capscrew (Casing/Adapter)

**Exploded View**

*Optional Items Shown in ITALICS*

Ref #	Component Item No.	Description	Qty Per
1	BV8402351	CASING,2X1-1/2,BZ KC2	1
2	BC8301331	COVER,2-1/2X2,BZ ZC2	1
3	BI8200061	IMPELLER,2X1-1/2,BZ ZC2	1
4	GX8301391	ADAPTER,210 JM FRAME ZC2	1
	<i>SX8301392</i>	<i>ADAPTER,210 JM FRAME,SS ZC2</i>	<i>1</i>
6	BX8103722	SLEEVE,SHFT,BZ ZC2	1
7	BI8101271	SCREW,IMP,BZ EC/ZC2	1
8	GX5042301	SLINGER,1-7/32X3-1/4X5/32 80 DUR (180JM-210JM)	1
9	GX5041000	GASKET,6-5/8X7-5/32X1/32 ,N-8090	1
10	GX5040500	GASKET,IMP SCRW,7/8X1-3/8X1/32	1
11	GX5098300	O-RING,T21,1-1/4,BUNA,SLV	1
	<i>GX5098301</i>	<i>O-RING,T21,1-1/4,EPDM,SLV (1-1/4 X 1-3/8 X 1/16)</i>	<i>1</i>
	<i>GX5098302</i>	<i>O-RING,43/252/325,VIT DC3</i>	<i>1</i>
12	GX5091400	SPLASHPLATE,EC2/KC2/RC2/ZC2,SS FR213-256	1
13	GX5051300	KEY,IMP,.187SQX1.5 EC KC RC ZC	1
14	GS8103410	KIT,1-1/4,T21,CE/CA/BU ZC2	1
	<i>GS8103410-316SS</i>	<i>KIT,1-1/4,T21,CE/CA/BU,316SS MET ZC2</i>	<i>1</i>
	<i>GS8105960</i>	<i>KIT,1-1/4,T21,CE/CA/VI ZC2</i>	<i>1</i>
	<i>GS8105960-316SS</i>	<i>KIT,1-1/4,T21,CE/CA/VI,316SS MET ZC2</i>	<i>1</i>
	<i>GS8106590</i>	<i>KIT,1-1/4,T21,NI/CA/BU ZC2</i>	<i>1</i>
	<i>GS8106590-316SS</i>	<i>KIT,1-1/4,T21,NI/CA/BU,316SS MET ZC2</i>	<i>1</i>
	<i>GS8106620</i>	<i>KIT,1-1/4,T21,CE/CA/EP ZC2</i>	<i>1</i>
	<i>GS8106620-316SS</i>	<i>KIT,1-1/4,T21,CE/CA/EP,316SS MET ZC2</i>	<i>1</i>
	<i>GS8106610</i>	<i>KIT,1-1/4,T21,TC/CA/VI ZC2 1512,215,252,325,43</i>	<i>1</i>
	<i>GS8107830</i>	<i>KIT,1-1/4,T21,SC/CA/VI ZC2</i>	<i>1</i>
	<i>GS8111170-316SS</i>	<i>KIT,1-1/4,T21,TC/SC/BU,316SS MET ZC2 1512,215,252,325,43</i>	<i>1</i>
17	GX5077400	CAPSCRW,SH,1/2-13X1-3/4,BLK OX SCKT HD	4

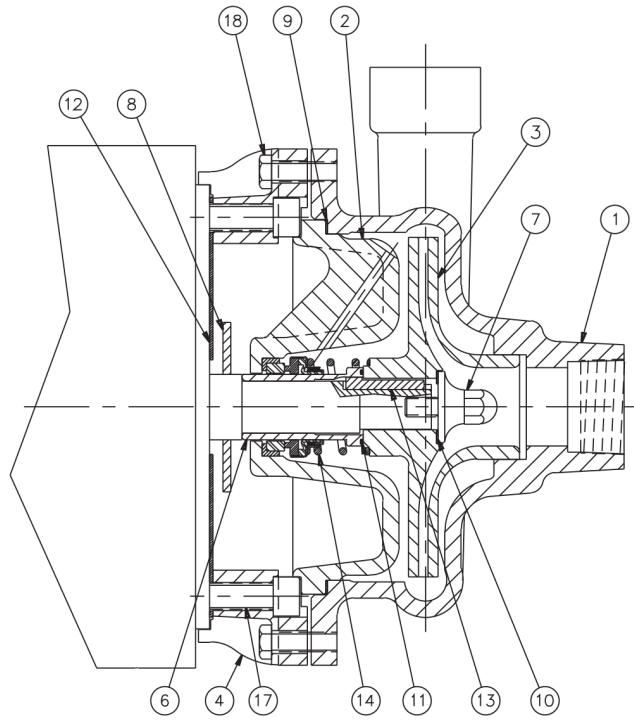

Ref #	Component
1	Casing
2	Cover
3	Impeller
4	Adapter
5	Wear Ring
6	Shaft Sleeve
7	Impeller Screw
8	Slinger
9	Gasket, Impeller Screw
10	Gasket, Casing
11	O-Ring, Shaft Sleeve
12	Splashplate
13	Key, Impeller
14	Seal Kit
17	Capscrew (Motor/Adapter)
18	Capscrew (Casing/Adapter)

**Exploded View**

*Optional Items Shown in ITALICS*

Ref #	Component Item No.	Description	Qty Per
18	<b>GX5077100</b>	<b>CAPSCRW,HX,3/8-16X1,18-8SS HX HD</b>	<b>4</b>
	<i>GX5077200</i>	<i>CAPSCRW,HX,3/8-16X1-1/4,18-8SS HX HD</i>	<i>4</i>

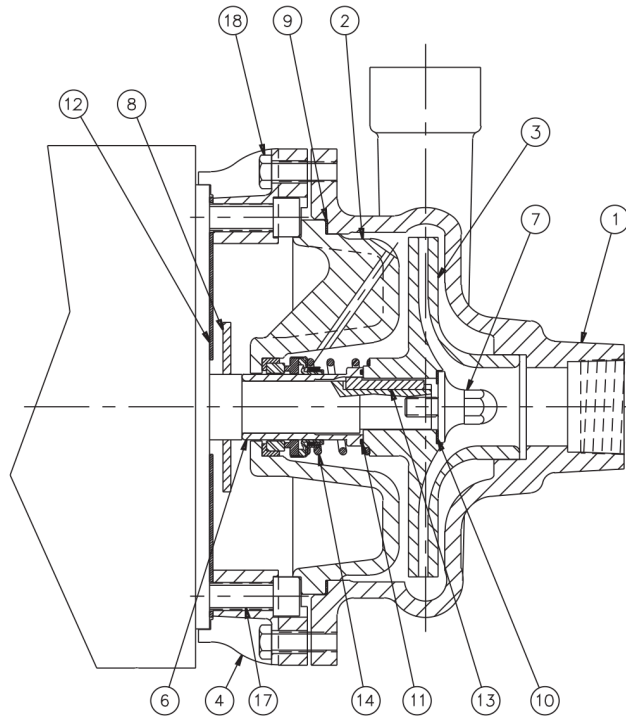

Ref #	Component
1	Casing
2	Cover
3	Impeller
4	Adapter
5	Wear Ring
6	Shaft Sleeve
7	Impeller Screw
8	Slinger
9	Gasket, Impeller Screw
10	Gasket, Casing
11	O-Ring, Shaft Sleeve
12	Splashplate
13	Key, Impeller
14	Seal Kit
17	Capscrew (Motor/Adapter)
18	Capscrew (Casing/Adapter)

**Exploded View**

*Optional Items Shown in ITALICS*

Ref #	Component Item No.	Description	Qty Per
1	BV8402801	CASING,2-1/2X2,BZ KC2	1
2	BC8301331	COVER,2-1/2X2,BZ ZC2	1
3	BI8200011	IMPELLER,2-1/2X2,BZ ZC2	1
4	GX8400951	ADAPTER,100 JM FRAME ZC2	1
	<i>SX8400952</i>	<i>ADAPTER,100 JM FRAME,SS ZC2</i>	<i>1</i>
6	BX8103722	SLEEVE,SHFT,BZ ZC2	1
7	BI8101271	SCREW,IMP,BZ EC/ZC2	1
8	GX5042301	SLINGER,1-7/32X3-1/4X5/32 80 DUR (180JM-210JM)	1
	<i>GX5042300</i>	<i>SLINGER,1-1/8X3-1/4X5/32 80 DUR (140JM)</i>	<i>1</i>
9	GX5041000	GASKET,6-5/8X7-5/32X1/32 ,N-8090	1
10	GX5040500	GASKET,IMP SCRW,7/8X1-3/8X1/32	1
11	GX5098300	O-RING,T21,1-1/4,BUNA,SLV	1
	<i>GX5098301</i>	<i>O-RING,T21,1-1/4,EPDM,SLV (1-1/4 X 1-3/8 X 1/16)</i>	<i>1</i>
	<i>GX5098302</i>	<i>O-RING,43/252/325,VIT DC3</i>	<i>1</i>
12	GX5091600	SPLASHPLATE,EC2/KC2/RC2/ZC2,SS FR143-184	1
13	GX5051300	KEY,IMP, .187SQX1.5 EC KC RC ZC	1
14	GS8103410	KIT,1-1/4,T21,CE/CA/BU ZC2	1
	<i>GS8103410-316SS</i>	<i>KIT,1-1/4,T21,CE/CA/BU,316SS MET ZC2</i>	<i>1</i>
	<i>GS8105960</i>	<i>KIT,1-1/4,T21,CE/CA/VI ZC2</i>	<i>1</i>
	<i>GS8105960-316SS</i>	<i>KIT,1-1/4,T21,CE/CA/VI,316SS MET ZC2</i>	<i>1</i>
	<i>GS8106590</i>	<i>KIT,1-1/4,T21,NI/CA/BU ZC2</i>	<i>1</i>
	<i>GS8106590-316SS</i>	<i>KIT,1-1/4,T21,NI/CA/BU,316SS MET ZC2</i>	<i>1</i>
	<i>GS8106620</i>	<i>KIT,1-1/4,T21,CE/CA/EP ZC2</i>	<i>1</i>
	<i>GS8106620-316SS</i>	<i>KIT,1-1/4,T21,CE/CA/EP,316SS MET ZC2</i>	<i>1</i>
	<i>GS8106610</i>	<i>KIT,1-1/4,T21,TC/CA/VI ZC2 1512,215,252,325,43</i>	<i>1</i>
	<i>GS8107830</i>	<i>KIT,1-1/4,T21,SC/CA/VI ZC2</i>	<i>1</i>
	<i>GS8111170-316SS</i>	<i>KIT,1-1/4,T21,TC/SC/BU,316SS MET ZC2 1512,215,252,325,43</i>	<i>1</i>

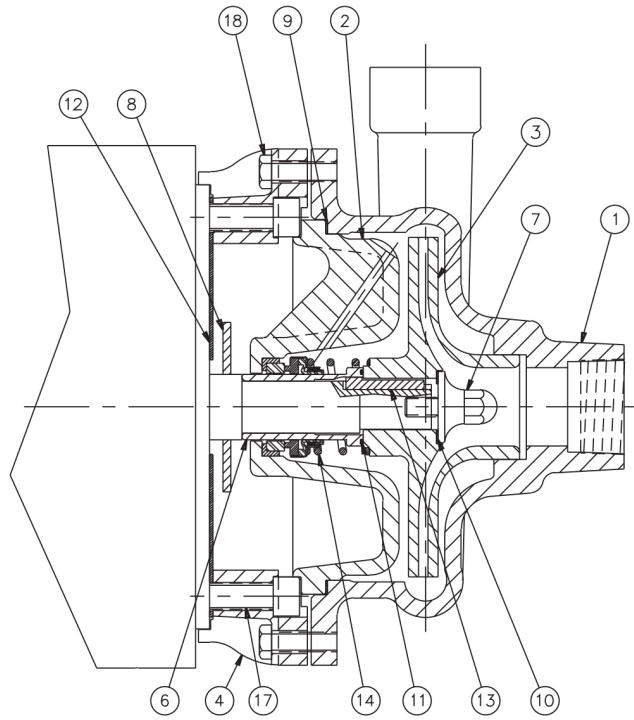

Ref #	Component
1	Casing
2	Cover
3	Impeller
4	Adapter
5	Wear Ring
6	Shaft Sleeve
7	Impeller Screw
8	Slinger
9	Gasket, Impeller Screw
10	Gasket, Casing
11	O-Ring, Shaft Sleeve
12	Splashplate
13	Key, Impeller
14	Seal Kit
17	Capscrew (Motor/Adapter)
18	Capscrew (Casing/Adapter)

**Exploded View**

*Optional Items Shown in ITALICS*

Ref #	Component Item No.	Description	Qty Per
17	<i>GX5077100</i>	<i>CAPSCRW,HX,3/8-16X1,18-8SS HX HD</i>	12
18	<i>GX5077100</i>	<i>CAPSCRW,HX,3/8-16X1,18-8SS HX HD</i>	8

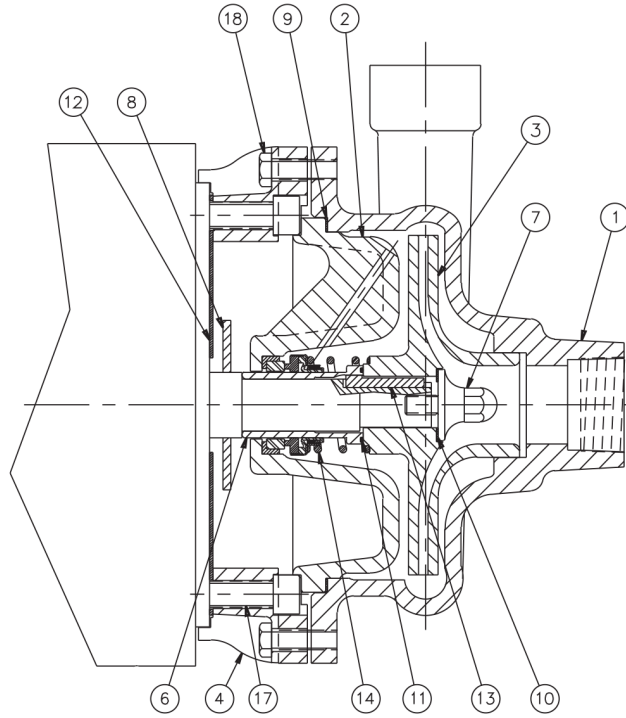

Ref #	Component
1	Casing
2	Cover
3	Impeller
4	Adapter
5	Wear Ring
6	Shaft Sleeve
7	Impeller Screw
8	Slinger
9	Gasket, Impeller Screw
10	Gasket, Casing
11	O-Ring, Shaft Sleeve
12	Splashplate
13	Key, Impeller
14	Seal Kit
17	Capscrew (Motor/Adapter)
18	Capscrew (Casing/Adapter)

**Exploded View**

*Optional Items Shown in ITALICS*

Ref #	Component Item No.	Description	Qty Per
1	BV8402801	CASING,2-1/2X2,BZ KC2	1
2	BC8301331	COVER,2-1/2X2,BZ ZC2	1
3	BI8200011	IMPELLER,2-1/2X2,BZ ZC2	1
4	GX8301391	ADAPTER,210 JM FRAME ZC2	1
	<i>SX8301392</i>	<i>ADAPTER,210 JM FRAME,SS ZC2</i>	<i>1</i>
6	BX8103722	SLEEVE,SHFT,BZ ZC2	1
7	BI8101271	SCREW,IMP,BZ EC/ZC2	1
8	GX5042301	SLINGER,1-7/32X3-1/4X5/32 80 DUR (180JM-210JM)	1
9	GX5041000	GASKET,6-5/8X7-5/32X1/32 ,N-8090	1
10	GX5040500	GASKET,IMP SCRW,7/8X1-3/8X1/32	1
11	GX5098300	O-RING,T21,1-1/4,BUNA,SLV	1
	<i>GX5098301</i>	<i>O-RING,T21,1-1/4,EPDM,SLV (1-1/4 X 1-3/8 X 1/16)</i>	<i>1</i>
	<i>GX5098302</i>	<i>O-RING,43/252/325,VIT DC3</i>	<i>1</i>
12	GX5091400	SPLASHPLATE,EC2/KC2/RC2/ZC2,SS FR213-256	1
13	GX5051300	KEY,IMP,.187SQX1.5 EC KC RC ZC	1
14	GS8103410	KIT,1-1/4,T21,CE/CA/BU ZC2	1
	<i>GS8103410-316SS</i>	<i>KIT,1-1/4,T21,CE/CA/BU,316SS MET ZC2</i>	<i>1</i>
	<i>GS8105960</i>	<i>KIT,1-1/4,T21,CE/CA/VI ZC2</i>	<i>1</i>
	<i>GS8105960-316SS</i>	<i>KIT,1-1/4,T21,CE/CA/VI,316SS MET ZC2</i>	<i>1</i>
	<i>GS8106590</i>	<i>KIT,1-1/4,T21,NI/CA/BU ZC2</i>	<i>1</i>
	<i>GS8106590-316SS</i>	<i>KIT,1-1/4,T21,NI/CA/BU,316SS MET ZC2</i>	<i>1</i>
	<i>GS8106620</i>	<i>KIT,1-1/4,T21,CE/CA/EP ZC2</i>	<i>1</i>
	<i>GS8106620-316SS</i>	<i>KIT,1-1/4,T21,CE/CA/EP,316SS MET ZC2</i>	<i>1</i>
	<i>GS8106610</i>	<i>KIT,1-1/4,T21,TC/CA/VI ZC2 1512,215,252,325,43</i>	<i>1</i>
	<i>GS8107830</i>	<i>KIT,1-1/4,T21,SC/CA/VI ZC2</i>	<i>1</i>
	<i>GS8111170-316SS</i>	<i>KIT,1-1/4,T21,TC/SC/BU,316SS MET ZC2 1512,215,252,325,43</i>	<i>1</i>
17	GX5077100	CAPSCRW,HX,3/8-16X1,18-8SS HX HD	4

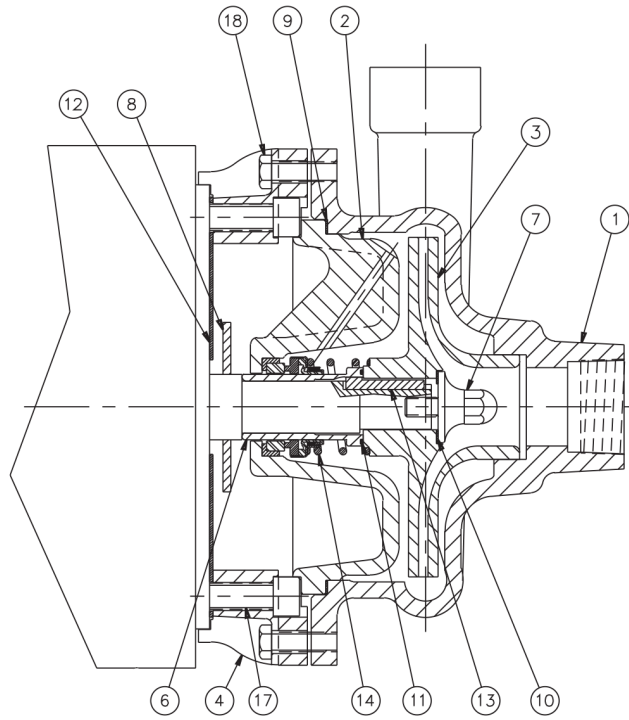

Ref #	Component
1	Casing
2	Cover
3	Impeller
4	Adapter
5	Wear Ring
6	Shaft Sleeve
7	Impeller Screw
8	Slinger
9	Gasket, Impeller Screw
10	Gasket, Casing
11	O-Ring, Shaft Sleeve
12	Splashplate
13	Key, Impeller
14	Seal Kit
17	Capscrew (Motor/Adapter)
18	Capscrew (Casing/Adapter)

**Exploded View**

*Optional Items Shown in ITALICS*

Ref #	Component Item No.	Description	Qty Per
17	<i>GX5077200</i>	<i>CAPSCRW,HX,3/8-16X1-1/4,18-8SS HX HD</i>	4
18	<i>GX5077400</i>	<i>CAPSCRW,SH,1/2-13X1-3/4,BLK OX SCKT HD</i>	4

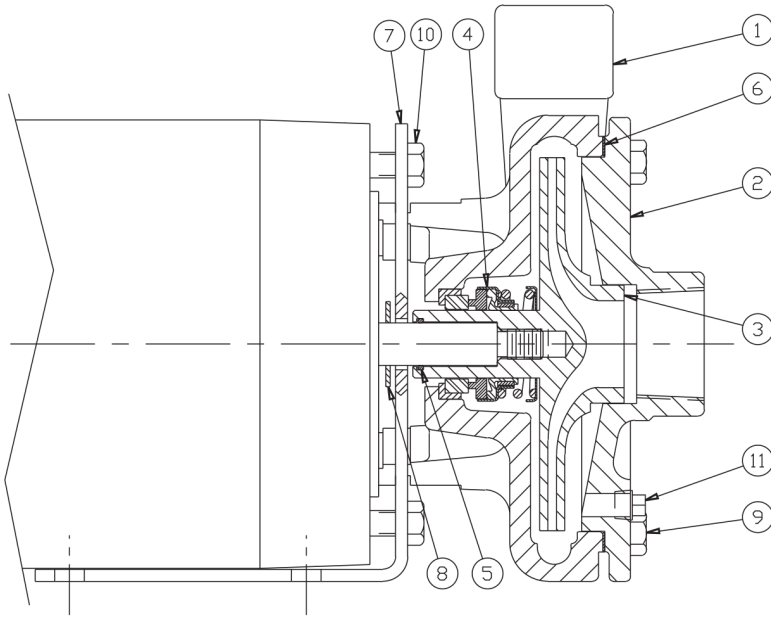

Ref #	Component
1	Casing
2	Cover
3	Impeller
4	Seal Kit
5	O-Ring, Impeller
6	Gasket, Cover
7	Mounting Bracket
8	Slinger
9	Capscrew (Casing/Cover)
10	Capscrew (Motor/Bracket)

**Exploded View**

*Optional Items Shown in ITALICS*

Ref #	Component Item No.	Description	Qty Per
1	SV8401202	CASING,1-1/4X1,SS KC2	1
2	SC8301672	COVER,1-1/4X1,SS KC2	1
3	SI8203560	IMPELLER,1-1/4X1,SS KC2	1
4	GS8104320	KIT,1",T21,CE/CA/BU KC2	1
	<i>GS8104320-316SS</i>	<i>KIT,1",T21,CE/CA/BU,316 SSMET KC2</i>	<i>1</i>
	<i>GS8105990</i>	<i>KIT,1",T21,CE/CA/VI KC2</i>	<i>1</i>
	<i>GS8105990-316SS</i>	<i>KIT,1",T21,CE/CA/VI,316SS MET KC2</i>	<i>1</i>
	<i>GS8107100</i>	<i>KIT,1",T21,CE/CA/EP KC2</i>	<i>1</i>
	<i>GS8105890</i>	<i>KIT,1",T21,NI/CA/BU KC2</i>	<i>1</i>
	<i>GS8105890-316SS</i>	<i>KIT,1",T21,NI/CA/BU,316SS MET KC2</i>	<i>1</i>
	<i>GS8106500</i>	<i>KIT,1",T21,NI/CA/VI KC2</i>	<i>1</i>
	<i>GS8107260</i>	<i>KIT,1",T21,TC/CA/VI KC2</i>	<i>1</i>
	<i>GS8108010</i>	<i>KIT,1",T21,SC/CA/VI KC2</i>	<i>1</i>
	<i>GS8108010-316SS</i>	<i>KIT,1",T21,SC/CA/VI,316SS MET KC2</i>	<i>1</i>
	<i>GS8111150-316SS</i>	<i>KIT,1",T21,TC/SC/BU,316SS MET KC2</i>	<i>1</i>
5	GX5100400	O-RING,IMPLR,BUNA K2 (2-016 BUNA 70)	1
	<i>GX5100402</i>	<i>O-RING,IMPLR,EPDM K2</i>	<i>1</i>
	<i>GX5100401</i>	<i>O-RING,IMPLR,VIT 2-016V884 K2</i>	<i>1</i>
6	GX5039902	GASKET,6-1/8X5-9/16X1/32 ,N-8090	1
7	GX8301591	BRACKET,121/151/175.MOUNTING KC2	1
	<i>SX8301592</i>	<i>BRACKET,MOUNTING,SS KC2</i>	<i>1</i>
8	GX5042200	SLINGER,19/32X1-1/4X1/16 80 DUR	1
9	GX5077100	CAPSCRW,HX,3/8-16X1,18-8SS HX HD	4
10	GX5077100	CAPSCRW,HX,3/8-16X1,18-8SS HX HD	4

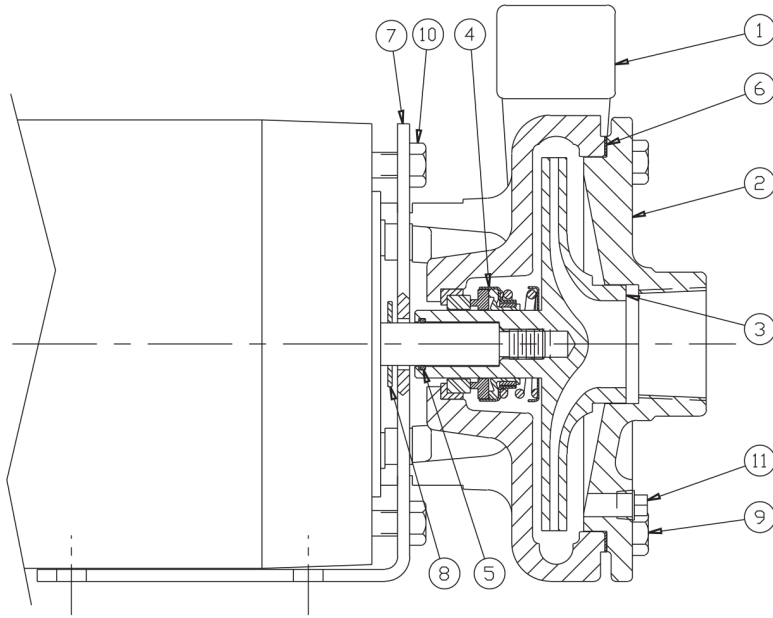

Ref #	Component
1	Casing
2	Cover
3	Impeller
4	Seal Kit
5	O-Ring, Impeller
6	Gasket, Cover
7	Mounting Bracket
8	Slinger
9	Capscrew (Casing/Cover)
10	Capscrew (Motor/Bracket)

**Exploded View**

*Optional Items Shown in ITALICS*

Ref #	Component Item No.	Description	Qty Per
1	SV8401202	CASING,1-1/4X1,SS KC2	1
2	SC8302342	COVER,1-1/2X1,SS KC2	1
3	SI8203900	IMPELLER,1-1/2X1,SS KC2	1
4	GS8104320	KIT,1",T21,CE/CA/BU KC2	1
	<i>GS8104320-316SS</i>	<i>KIT,1",T21,CE/CA/BU,316 SSMET KC2</i>	<i>1</i>
	<i>GS8105990</i>	<i>KIT,1",T21,CE/CA/VI KC2</i>	<i>1</i>
	<i>GS8105990-316SS</i>	<i>KIT,1",T21,CE/CA/VI,316SS MET KC2</i>	<i>1</i>
	<i>GS8107100</i>	<i>KIT,1",T21,CE/CA/EP KC2</i>	<i>1</i>
	<i>GS8105890</i>	<i>KIT,1",T21,NI/CA/BU KC2</i>	<i>1</i>
	<i>GS8105890-316SS</i>	<i>KIT,1",T21,NI/CA/BU,316SS MET KC2</i>	<i>1</i>
	<i>GS8106500</i>	<i>KIT,1",T21,NI/CA/VI KC2</i>	<i>1</i>
	<i>GS8107260</i>	<i>KIT,1",T21,TC/CA/VI KC2</i>	<i>1</i>
	<i>GS8108010</i>	<i>KIT,1",T21,SC/CA/VI KC2</i>	<i>1</i>
	<i>GS8108010-316SS</i>	<i>KIT,1",T21,SC/CA/VI,316SS MET KC2</i>	<i>1</i>
	<i>GS8111150-316SS</i>	<i>KIT,1",T21,TC/SC/BU,316SS MET KC2</i>	<i>1</i>
5	GX5100400	O-RING,IMPLR,BUNA K2 (2-016 BUNA 70)	1
	<i>GX5100402</i>	<i>O-RING,IMPLR,EPDM K2</i>	<i>1</i>
	<i>GX5100401</i>	<i>O-RING,IMPLR,VIT 2-016V884 K2</i>	<i>1</i>
6	GX5039902	GASKET,6-1/8X5-9/16X1/32 ,N-8090	1
7	GX8301591	BRACKET,121/151/175.MOUNTING KC2	1
	<i>SX8301592</i>	<i>BRACKET,MOUNTING,SS KC2</i>	<i>1</i>
8	GX5042200	SLINGER,19/32X1-1/4X1/16 80 DUR	1
9	GX5077100	CAPSCRW,HX,3/8-16X1,18-8SS HX HD	4
10	GX5077100	CAPSCRW,HX,3/8-16X1,18-8SS HX HD	4

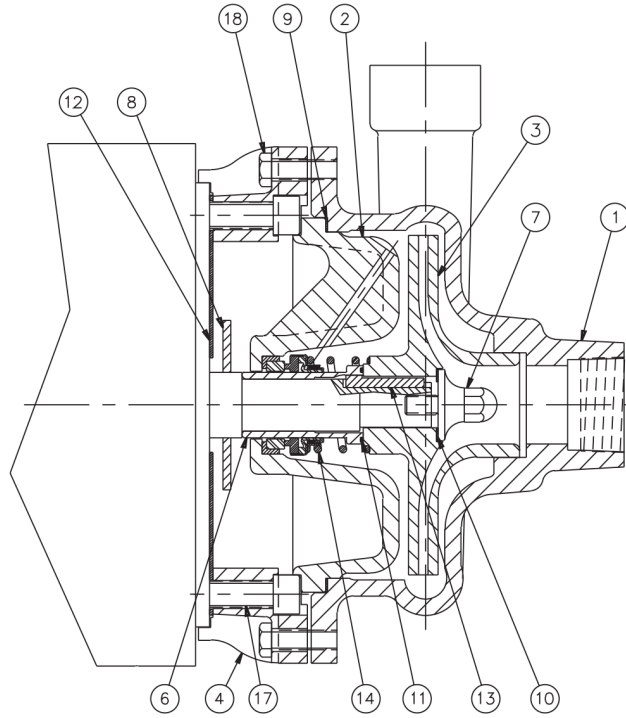

Ref #	Component
1	Casing
2	Cover
3	Impeller
4	Adapter
5	Wear Ring
6	Shaft Sleeve
7	Impeller Screw
8	Slinger
9	Gasket, Impeller Screw
10	Gasket, Casing
11	O-Ring, Shaft Sleeve
12	Splashplate
13	Key, Impeller
14	Seal Kit
17	Capscrew (Motor/Adapter)
18	Capscrew (Casing/Adapter)

**Exploded View**

*Optional Items Shown in ITALICS*

Ref #	Component Item No.	Description	Qty Per
1	SV8402322	CASING,1-1/2X1-1/4,SS KC2	1
2	SC8302471	COVER,2-1/2X2,SS DC2	1
3	SI8201391	IMPELLER,1-1/2X1-1/4,SS ZC2	1
4	GX8400951	ADAPTER,100 JM FRAME ZC2	1
	<i>SX8400952</i>	<i>ADAPTER,100 JM FRAME,SS ZC2</i>	<i>1</i>
6	SX8103721	SLEEVE,SHFT,SS ZC2	1
7	SI8107270	SCREW,IMP,SS DC2 EC2 KC2 MC3 ZC2	1
8	GX5042301	SLINGER,1-7/32X3-1/4X5/32 80 DUR (180JM-210JM)	1
	<i>GX5042300</i>	<i>SLINGER,1-1/8X3-1/4X5/32 80 DUR (140JM)</i>	<i>1</i>
9	GX5041000	GASKET,6-5/8X7-5/32X1/32 ,N-8090	1
10	GX5040500	GASKET,IMP SCRW,7/8X1-3/8X1/32	1
11	GX5098300	O-RING,T21,1-1/4,BUNA,SLV	1
	<i>GX5098301</i>	<i>O-RING,T21,1-1/4,EPDM,SLV (1-1/4 X 1-3/8 X 1/16)</i>	<i>1</i>
	<i>GX5098302</i>	<i>O-RING,43/252/325,VIT DC3</i>	<i>1</i>
12	GX5091600	SPLASHPLATE,EC2 KC2 RC2 ZC2,SS FR143-184	1
13	GX5051300	KEY,IMP,.187SQX1.5 EC KC RC ZC	1
14	GS8103410	KIT,1-1/4,T21,CE/CA/BU ZC2	1
	<i>GS8103410-316SS</i>	<i>KIT,1-1/4,T21,CE/CA/BU,316SS MET ZC2</i>	<i>1</i>
	<i>GS8105960</i>	<i>KIT,1-1/4,T21,CE/CA/VI ZC2</i>	<i>1</i>
	<i>GS8105960-316SS</i>	<i>KIT,1-1/4,T21,CE/CA/VI,316SS MET ZC2</i>	<i>1</i>
	<i>GS8106590</i>	<i>KIT,1-1/4,T21,NI/CA/BU ZC2</i>	<i>1</i>
	<i>GS8106590-316SS</i>	<i>KIT,1-1/4,T21,NI/CA/BU,316SS MET ZC2</i>	<i>1</i>
	<i>GS8106620</i>	<i>KIT,1-1/4,T21,CE/CA/EP ZC2</i>	<i>1</i>
	<i>GS8106620-316SS</i>	<i>KIT,1-1/4,T21,CE/CA/EP,316SS MET ZC2</i>	<i>1</i>
	<i>GS8106610</i>	<i>KIT,1-1/4,T21,TC/CA/VI ZC2 1512,215,252,325,43</i>	<i>1</i>
	<i>GS8107830</i>	<i>KIT,1-1/4,T21,SC/CA/VI ZC2</i>	<i>1</i>
	<i>GS8111170-316SS</i>	<i>KIT,1-1/4,T21,TC/SC/BU,316SS MET ZC2 1512,215,252,325,43</i>	<i>1</i>

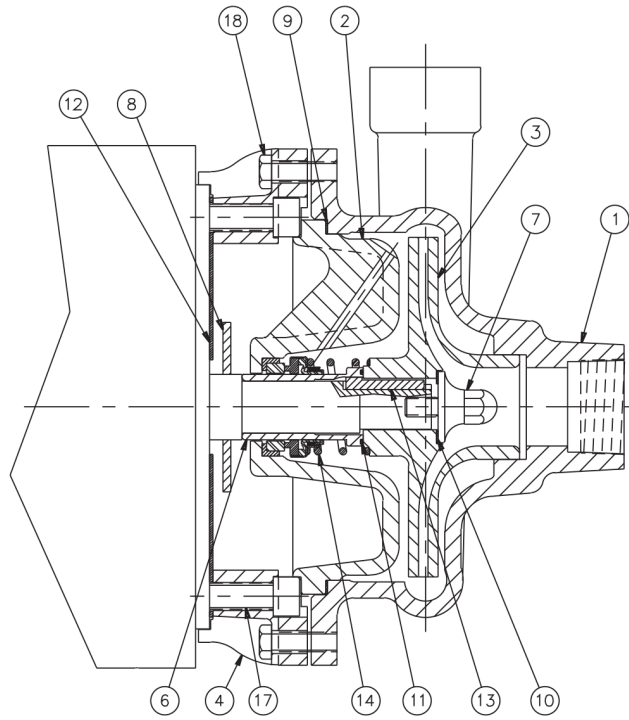

Ref #	Component
1	Casing
2	Cover
3	Impeller
4	Adapter
5	Wear Ring
6	Shaft Sleeve
7	Impeller Screw
8	Slinger
9	Gasket, Impeller Screw
10	Gasket, Casing
11	O-Ring, Shaft Sleeve
12	Splashplate
13	Key, Impeller
14	Seal Kit
17	Capscrew (Motor/Adapter)
18	Capscrew (Casing/Adapter)

**Exploded View**

*Optional Items Shown in ITALICS*

Ref #	Component Item No.	Description	Qty Per
17	<i>GX5077100</i>	<i>CAPSCRW,HX,3/8-16X1,18-8SS HX HD</i>	<i>4</i>
18	<i>GX5077100</i>	<i>CAPSCRW,HX,3/8-16X1,18-8SS HX HD</i>	<i>8</i>

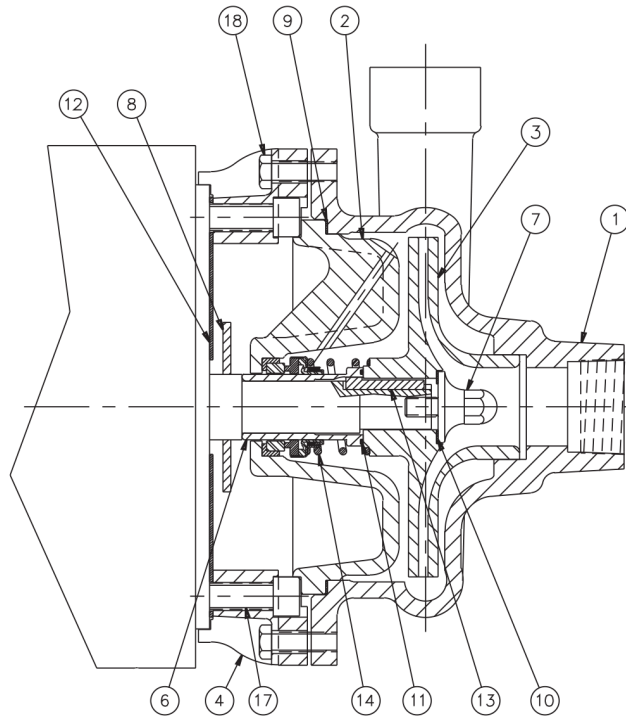

Ref #	Component
1	Casing
2	Cover
3	Impeller
4	Adapter
5	Wear Ring
6	Shaft Sleeve
7	Impeller Screw
8	Slinger
9	Gasket, Impeller Screw
10	Gasket, Casing
11	O-Ring, Shaft Sleeve
12	Splashplate
13	Key, Impeller
14	Seal Kit
17	Capscrew (Motor/Adapter)
18	Capscrew (Casing/Adapter)

**Exploded View**

*Optional Items Shown in ITALICS*

Ref #	Component Item No.	Description	Qty Per
1	SV8402322	CASING,1-1/2X1-1/4,SS KC2	1
2	SC8302471	COVER,2-1/2X2,SS DC2	1
3	SI8201391	IMPELLER,1-1/2X1-1/4,SS ZC2	1
4	GX8301391	ADAPTER,210 JM FRAME ZC2	1
	<i>SX8301392</i>	<i>ADAPTER,210 JM FRAME,SS ZC2</i>	<i>1</i>
6	SX8103721	SLEEVE,SHFT,SS ZC2	1
7	SI8107270	SCREW,IMP,SS DC2 EC2 KC2 MC3 ZC2	1
8	GX5042301	SLINGER,1-7/32X3-1/4X5/32 80 DUR (180JM-210JM)	1
9	GX5041000	GASKET,6-5/8X7-5/32X1/32 ,N-8090	1
10	GX5040500	GASKET,IMP SCRW,7/8X1-3/8X1/32	1
11	GX5098300	O-RING,T21,1-1/4,BUNA,SLV	1
	<i>GX5098301</i>	<i>O-RING,T21,1-1/4,EPDM,SLV (1-1/4 X 1-3/8 X 1/16)</i>	<i>1</i>
	<i>GX5098302</i>	<i>O-RING,43/252/325,VIT DC3</i>	<i>1</i>
12	GX5091400	SPLASHPLATE,EC2 KC2 RC2 ZC2,SS FR213-256	1
13	GX5051300	KEY,IMP,.187SQX1.5 EC KC RC ZC	1
14	GS8103410	KIT,1-1/4,T21,CE/CA/BU ZC2	1
	<i>GS8103410-316SS</i>	<i>KIT,1-1/4,T21,CE/CA/BU,316SS MET ZC2</i>	<i>1</i>
	<i>GS8105960</i>	<i>KIT,1-1/4,T21,CE/CA/VI ZC2</i>	<i>1</i>
	<i>GS8105960-316SS</i>	<i>KIT,1-1/4,T21,CE/CA/VI,316SS MET ZC2</i>	<i>1</i>
	<i>GS8106590</i>	<i>KIT,1-1/4,T21,NI/CA/BU ZC2</i>	<i>1</i>
	<i>GS8106590-316SS</i>	<i>KIT,1-1/4,T21,NI/CA/BU,316SS MET ZC2</i>	<i>1</i>
	<i>GS8106620</i>	<i>KIT,1-1/4,T21,CE/CA/EP ZC2</i>	<i>1</i>
	<i>GS8106620-316SS</i>	<i>KIT,1-1/4,T21,CE/CA/EP,316SS MET ZC2</i>	<i>1</i>
	<i>GS8106610</i>	<i>KIT,1-1/4,T21,TC/CA/VI ZC2 1512,215,252,325,43</i>	<i>1</i>
	<i>GS8107830</i>	<i>KIT,1-1/4,T21,SC/CA/VI ZC2</i>	<i>1</i>
	<i>GS8111170-316SS</i>	<i>KIT,1-1/4,T21,TC/SC/BU,316SS MET ZC2 1512,215,252,325,43</i>	<i>1</i>
17	GX5077400	CAPSCRW,SH,1/2-13X1-3/4,BLK OX SCKT HD	4

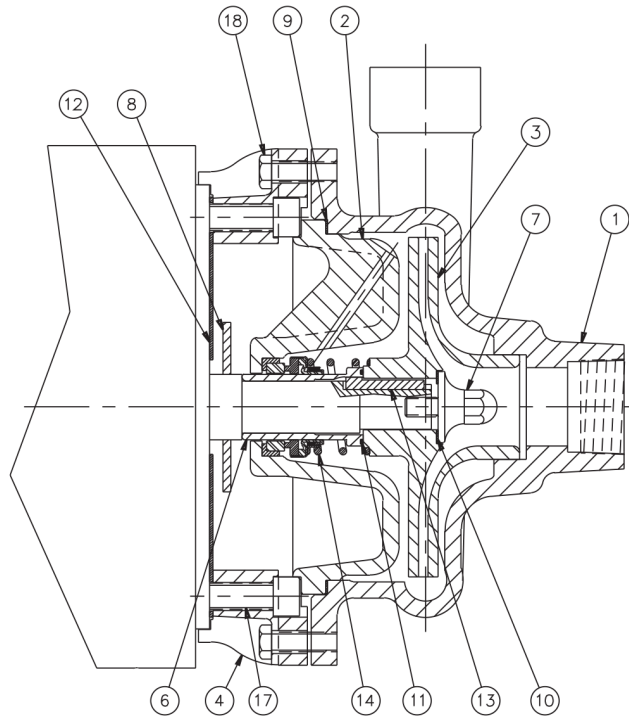

Ref #	Component
1	Casing
2	Cover
3	Impeller
4	Adapter
5	Wear Ring
6	Shaft Sleeve
7	Impeller Screw
8	Slinger
9	Gasket, Impeller Screw
10	Gasket, Casing
11	O-Ring, Shaft Sleeve
12	Splashplate
13	Key, Impeller
14	Seal Kit
17	Capscrew (Motor/Adapter)
18	Capscrew (Casing/Adapter)

**Exploded View**

*Optional Items Shown in ITALICS*

Ref #	Component Item No.	Description	Qty Per
18	<b>GX5077100</b>	<b>CAPSCRW,HX,3/8-16X1,18-8SS HX HD</b>	<b>4</b>
	<i>GX5077200</i>	<i>CAPSCRW,HX,3/8-16X1-1/4,18-8SS HX HD</i>	<i>4</i>

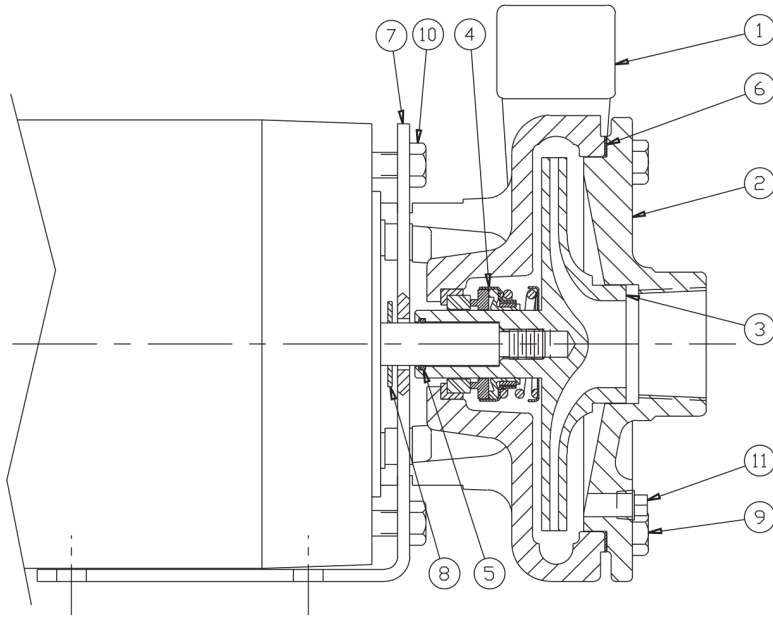

Ref #	Component
1	Casing
2	Cover
3	Impeller
4	Seal Kit
5	O-Ring, Impeller
6	Gasket, Cover
7	Mounting Bracket
8	Slinger
9	Capscrew (Casing/Cover)
10	Capscrew (Motor/Bracket)

**Exploded View**

*Optional Items Shown in ITALICS*

Ref #	Component Item No.	Description	Qty Per
1	SV8401151	<b>CASING,1X3/4,SS KC2</b>	1
2	SC8301601	<b>COVER,1X3/4,SS KC2</b>	1
3	SI8202961	<b>IMPELLER,1X3/4,SS W/GX5101200 KC2</b>	1
4	GS8104320	<b>KIT,1",T21,CE/CA/BU KC2</b>	1
	<i>GS8104320-316SS</i>	<i>KIT,1",T21,CE/CA/BU,316 SSMET KC2</i>	1
	<i>GS8105990</i>	<i>KIT,1",T21,CE/CA/VI KC2</i>	1
	<i>GS8105990-316SS</i>	<i>KIT,1",T21,CE/CA/VI,316SS MET KC2</i>	1
	<i>GS8107100</i>	<i>KIT,1",T21,CE/CA/EP KC2</i>	1
	<i>GS8105890</i>	<i>KIT,1",T21,NI/CA/BU KC2</i>	1
	<i>GS8105890-316SS</i>	<i>KIT,1",T21,NI/CA/BU,316SS MET KC2</i>	1
	<i>GS8106500</i>	<i>KIT,1",T21,NI/CA/VI KC2</i>	1
	<i>GS8107260</i>	<i>KIT,1",T21,TC/CA/VI KC2</i>	1
	<i>GS8108010</i>	<i>KIT,1",T21,SC/CA/VI KC2</i>	1
	<i>GS8108010-316SS</i>	<i>KIT,1",T21,SC/CA/VI,316SS MET KC2</i>	1
	<i>GS8111150-316SS</i>	<i>KIT,1",T21,TC/SC/BU,316SS MET KC2</i>	1
5	GX5100400	<b>O-RING,IMPLR,BUNA K2 (2-016 BUNA 70)</b>	1
	<i>GX5100402</i>	<i>O-RING,IMPLR,EPDM K2</i>	1
	<i>GX5100401</i>	<i>O-RING,IMPLR,VIT 2-016V884 K2</i>	1
6	GX5039901	<b>GASKET,5-1/16X5-5/8X1/32 ,N-8090</b>	1
7	GX8301591	<b>BRACKET,121/151/175.MOUNTING KC2</b>	1
	<i>SX8301592</i>	<i>BRACKET,MOUNTING,SS KC2</i>	1
8	GX5042200	<b>SLINGER,19/32X1-1/4X1/16 80 DUR</b>	1
9	GX5077100	<b>CAPSCRW,HX,3/8-16X1,18-8SS HX HD</b>	4
10	GX5077100	<b>CAPSCRW,HX,3/8-16X1,18-8SS HX HD</b>	4

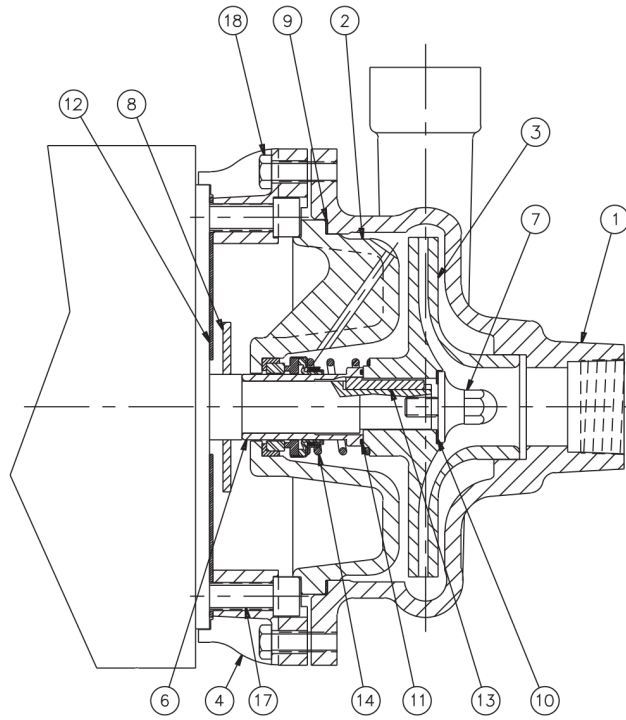

Ref #	Component
1	Casing
2	Cover
3	Impeller
4	Adapter
5	Wear Ring
6	Shaft Sleeve
7	Impeller Screw
8	Slinger
9	Gasket, Impeller Screw
10	Gasket, Casing
11	O-Ring, Shaft Sleeve
12	Splashplate
13	Key, Impeller
14	Seal Kit
17	Capscrew (Motor/Adapter)
18	Capscrew (Casing/Adapter)

**Exploded View**

*Optional Items Shown in ITALICS*

Ref #	Component Item No.	Description	Qty Per
1	SV8402352	CASING,2X1-1/2,SS KC2	1
2	SC8302471	COVER,2-1/2X2,SS DC2	1
3	SI8201441	IMPELLER,2X1-1/2,SS ZC2	1
4	GX8400951	ADAPTER,100 JM FRAME ZC2	1
	<i>SX8400952</i>	<i>ADAPTER,100 JM FRAME,SS ZC2</i>	<i>1</i>
6	SX8103721	SLEEVE,SHFT,SS ZC2	1
7	SI8107270	SCREW,IMP,SS DC2 EC2 KC2 MC3 ZC2	1
8	GX5042301	SLINGER,1-7/32X3-1/4X5/32 80 DUR (180JM-210JM)	1
	<i>GX5042300</i>	<i>SLINGER,1-1/8X3-1/4X5/32 80 DUR (140JM)</i>	<i>1</i>
9	GX5041000	GASKET,6-5/8X7-5/32X1/32 ,N-8090	1
10	GX5040500	GASKET,IMP SCRW,7/8X1-3/8X1/32	1
11	GX5098300	O-RING,T21,1-1/4,BUNA,SLV	1
	<i>GX5098301</i>	<i>O-RING,T21,1-1/4,EPDM,SLV (1-1/4 X 1-3/8 X 1/16)</i>	<i>1</i>
	<i>GX5098302</i>	<i>O-RING,43/252/325,VIT DC3</i>	<i>1</i>
12	GX5091600	SPLASHPLATE,EC2 KC2 RC2 ZC2,SS FR143-184	1
13	GX5051300	KEY,IMP,.187SQX1.5 EC KC RC ZC	1
14	GS8103410	KIT,1-1/4,T21,CE/CA/BU ZC2	1
	<i>GS8103410-316SS</i>	<i>KIT,1-1/4,T21,CE/CA/BU,316SS MET ZC2</i>	<i>1</i>
	<i>GS8105960</i>	<i>KIT,1-1/4,T21,CE/CA/VI ZC2</i>	<i>1</i>
	<i>GS8105960-316SS</i>	<i>KIT,1-1/4,T21,CE/CA/VI,316SS MET ZC2</i>	<i>1</i>
	<i>GS8106590</i>	<i>KIT,1-1/4,T21,NI/CA/BU ZC2</i>	<i>1</i>
	<i>GS8106590-316SS</i>	<i>KIT,1-1/4,T21,NI/CA/BU,316SS MET ZC2</i>	<i>1</i>
	<i>GS8106620</i>	<i>KIT,1-1/4,T21,CE/CA/EP ZC2</i>	<i>1</i>
	<i>GS8106620-316SS</i>	<i>KIT,1-1/4,T21,CE/CA/EP,316SS MET ZC2</i>	<i>1</i>
	<i>GS8106610</i>	<i>KIT,1-1/4,T21,TC/CA/VI ZC2 1512,215,252,325,43</i>	<i>1</i>
	<i>GS8107830</i>	<i>KIT,1-1/4,T21,SC/CA/VI ZC2</i>	<i>1</i>
	<i>GS8111170-316SS</i>	<i>KIT,1-1/4,T21,TC/SC/BU,316SS MET ZC2 1512,215,252,325,43</i>	<i>1</i>

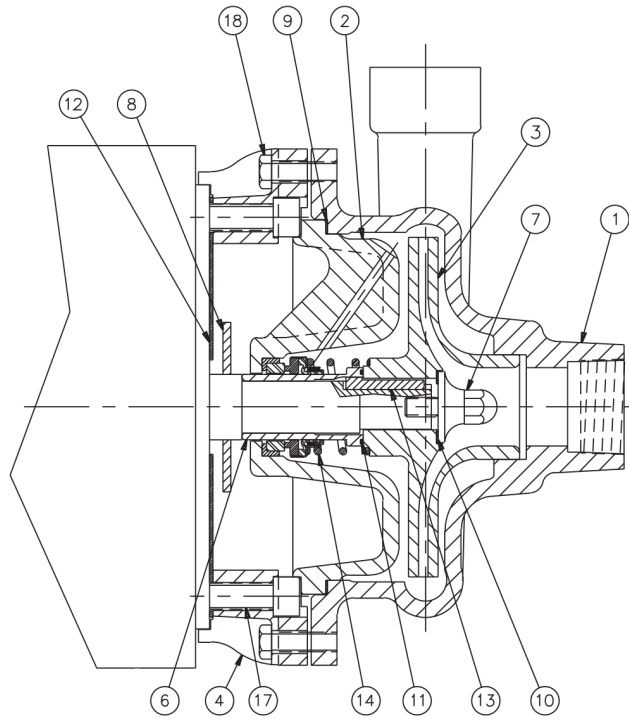

Ref #	Component
1	Casing
2	Cover
3	Impeller
4	Adapter
5	Wear Ring
6	Shaft Sleeve
7	Impeller Screw
8	Slinger
9	Gasket, Impeller Screw
10	Gasket, Casing
11	O-Ring, Shaft Sleeve
12	Splashplate
13	Key, Impeller
14	Seal Kit
17	Capscrew (Motor/Adapter)
18	Capscrew (Casing/Adapter)

**Exploded View**

*Optional Items Shown in ITALICS*

Ref #	Component Item No.	Description	Qty Per
17	<i>GX5077100</i>	<i>CAPSCRW,HX,3/8-16X1,18-8SS HX HD</i>	<i>4</i>
18	<i>GX5077100</i>	<i>CAPSCRW,HX,3/8-16X1,18-8SS HX HD</i>	<i>8</i>

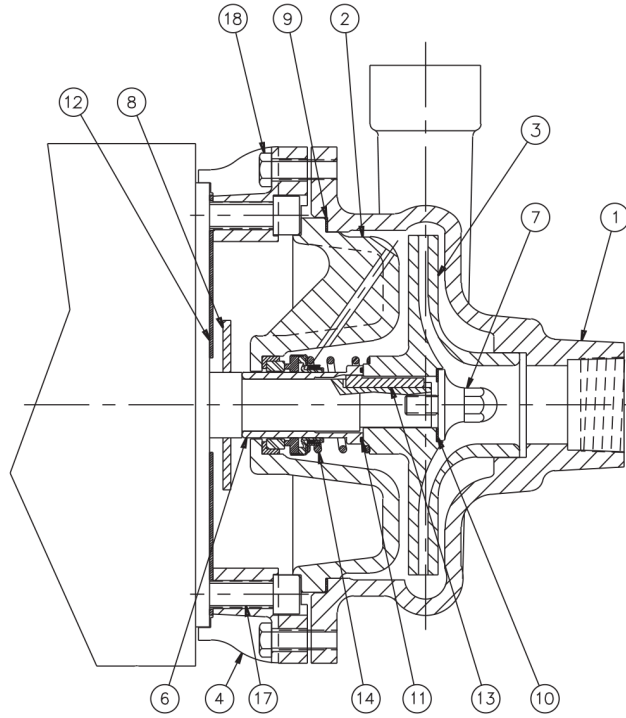

Ref #	Component
1	Casing
2	Cover
3	Impeller
4	Adapter
5	Wear Ring
6	Shaft Sleeve
7	Impeller Screw
8	Slinger
9	Gasket, Impeller Screw
10	Gasket, Casing
11	O-Ring, Shaft Sleeve
12	Splashplate
13	Key, Impeller
14	Seal Kit
17	Capscrew (Motor/Adapter)
18	Capscrew (Casing/Adapter)

**Exploded View**

*Optional Items Shown in ITALICS*

Ref #	Component Item No.	Description	Qty Per
1	SV8402352	CASING,2X1-1/2,SS KC2	1
2	SC8302471	COVER,2-1/2X2,SS DC2	1
3	SI8201441	IMPELLER,2X1-1/2,SS ZC2	1
4	GX8301391	ADAPTER,210 JM FRAME ZC2	1
	<i>SX8301392</i>	<i>ADAPTER,210 JM FRAME,SS ZC2</i>	<i>1</i>
6	SX8103721	SLEEVE,SHFT,SS ZC2	1
7	SI8107270	SCREW,IMP,SS DC2 EC2 KC2 MC3 ZC2	1
8	GX5042301	SLINGER,1-7/32X3-1/4X5/32 80 DUR (180JM-210JM)	1
9	GX5041000	GASKET,6-5/8X7-5/32X1/32 ,N-8090	1
10	GX5040500	GASKET,IMP SCRW,7/8X1-3/8X1/32	1
11	GX5098300	O-RING,T21,1-1/4,BUNA,SLV	1
	<i>GX5098301</i>	<i>O-RING,T21,1-1/4,EPDM,SLV (1-1/4 X 1-3/8 X 1/16)</i>	<i>1</i>
	<i>GX5098302</i>	<i>O-RING,43/252/325,VIT DC3</i>	<i>1</i>
12	GX5091400	SPLASHPLATE,EC2 KC2 RC2 ZC2,SS FR213-256	1
13	GX5051300	KEY,IMP,.187SQX1.5 EC KC RC ZC	1
14	GS8103410	KIT,1-1/4,T21,CE/CA/BU ZC2	1
	<i>GS8103410-316SS</i>	<i>KIT,1-1/4,T21,CE/CA/BU,316SS MET ZC2</i>	<i>1</i>
	<i>GS8105960</i>	<i>KIT,1-1/4,T21,CE/CA/VI ZC2</i>	<i>1</i>
	<i>GS8105960-316SS</i>	<i>KIT,1-1/4,T21,CE/CA/VI,316SS MET ZC2</i>	<i>1</i>
	<i>GS8106590</i>	<i>KIT,1-1/4,T21,NI/CA/BU ZC2</i>	<i>1</i>
	<i>GS8106590-316SS</i>	<i>KIT,1-1/4,T21,NI/CA/BU,316SS MET ZC2</i>	<i>1</i>
	<i>GS8106620</i>	<i>KIT,1-1/4,T21,CE/CA/EP ZC2</i>	<i>1</i>
	<i>GS8106620-316SS</i>	<i>KIT,1-1/4,T21,CE/CA/EP,316SS MET ZC2</i>	<i>1</i>
	<i>GS8106610</i>	<i>KIT,1-1/4,T21,TC/CA/VI ZC2 1512,215,252,325,43</i>	<i>1</i>
	<i>GS8107830</i>	<i>KIT,1-1/4,T21,SC/CA/VI ZC2</i>	<i>1</i>
	<i>GS8111170-316SS</i>	<i>KIT,1-1/4,T21,TC/SC/BU,316SS MET ZC2 1512,215,252,325,43</i>	<i>1</i>
17	GX5077400	CAPSCRW,SH,1/2-13X1-3/4,BLK OX SCKT HD	4

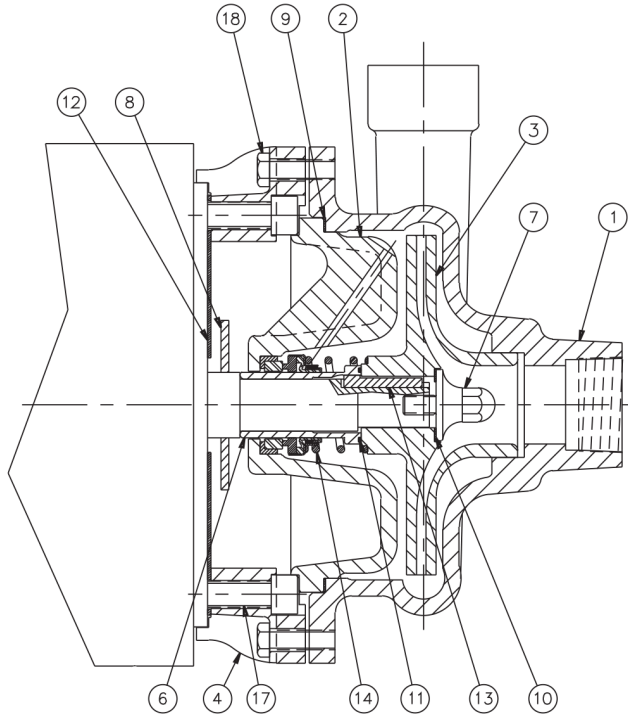

Ref #	Component
1	Casing
2	Cover
3	Impeller
4	Adapter
5	Wear Ring
6	Shaft Sleeve
7	Impeller Screw
8	Slinger
9	Gasket, Impeller Screw
10	Gasket, Casing
11	O-Ring, Shaft Sleeve
12	Splashplate
13	Key, Impeller
14	Seal Kit
17	Capscrew (Motor/Adapter)
18	Capscrew (Casing/Adapter)

**Exploded View**

*Optional Items Shown in ITALICS*

Ref #	Component Item No.	Description	Qty Per
18	<b>GX5077100</b>	<b>CAPSCRW,HX,3/8-16X1,18-8SS HX HD</b>	<b>4</b>
	<i>GX5077200</i>	<i>CAPSCRW,HX,3/8-16X1-1/4,18-8SS HX HD</i>	<i>4</i>

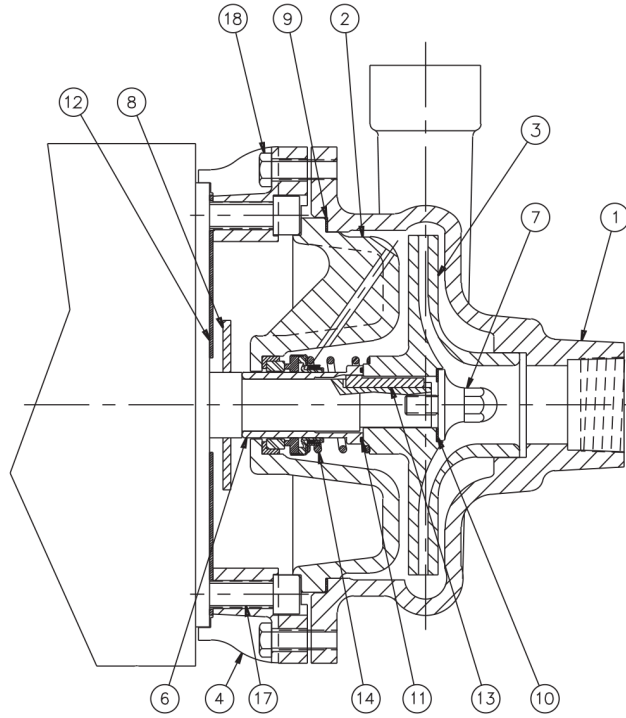

Ref #	Component
1	Casing
2	Cover
3	Impeller
4	Adapter
5	Wear Ring
6	Shaft Sleeve
7	Impeller Screw
8	Slinger
9	Gasket, Impeller Screw
10	Gasket, Casing
11	O-Ring, Shaft Sleeve
12	Splashplate
13	Key, Impeller
14	Seal Kit
17	Capscrew (Motor/Adapter)
18	Capscrew (Casing/Adapter)

**Exploded View**

*Optional Items Shown in ITALICS*

Ref #	Component Item No.	Description	Qty Per
1	SV8402802	CASING,2-1/2X2,SS KC2	1
2	SC8302471	COVER,2-1/2X2,SS DC2	1
3	SI8302491	IMPELLER,2-1/2X2,SS DC2	1
4	GX8400951	ADAPTER,100 JM FRAME ZC2	1
	<i>SX8400952</i>	<i>ADAPTER,100 JM FRAME,SS ZC2</i>	<i>1</i>
6	SX8103721	SLEEVE,SHFT,SS ZC2	1
7	SI8107270	SCREW,IMP,SS DC2 EC2 KC2 MC3 ZC2	1
8	GX5042301	SLINGER,1-7/32X3-1/4X5/32 80 DUR (180JM-210JM)	1
	<i>GX5042300</i>	<i>SLINGER,1-1/8X3-1/4X5/32 80 DUR (140JM)</i>	<i>1</i>
9	GX5041000	GASKET,6-5/8X7-5/32X1/32 ,N-8090	1
10	GX5038500	O-RING,,989X1.29X.070,BUNA 70 DUR, IMP SCRW	1
	<i>GX5038502</i>	<i>O-RING,T21,1-1/4,EPDM (2-022)</i>	<i>1</i>
	<i>GX5038501</i>	<i>O-RING,43/252/325,VIT,FDA CMPL DC3 ZC2</i>	<i>1</i>
11	GX5098300	O-RING,T21,1-1/4,BUNA,SLV	1
	<i>GX5098301</i>	<i>O-RING,T21,1-1/4,EPDM,SLV (1-1/4 X 1-3/8 X 1/16)</i>	<i>1</i>
	<i>GX5098302</i>	<i>O-RING,43/252/325,VIT DC3</i>	<i>1</i>
12	GX5091600	SPLASHPLATE,EC2 KC2 RC2 ZC2,SS FR143-184	1
13	GX5051300	KEY,IMP,,.187SQX1.5 EC KC RC ZC	1
14	GS8103410	KIT,1-1/4,T21,CE/CA/BU ZC2	1
	<i>GS8103410-316SS</i>	<i>KIT,1-1/4,T21,CE/CA/BU,316SS MET ZC2</i>	<i>1</i>
	<i>GS8105960</i>	<i>KIT,1-1/4,T21,CE/CA/VI ZC2</i>	<i>1</i>
	<i>GS8105960-316SS</i>	<i>KIT,1-1/4,T21,CE/CA/VI,316SS MET ZC2</i>	<i>1</i>
	<i>GS8106590</i>	<i>KIT,1-1/4,T21,NI/CA/BU ZC2</i>	<i>1</i>
	<i>GS8106590-316SS</i>	<i>KIT,1-1/4,T21,NI/CA/BU,316SS MET ZC2</i>	<i>1</i>
	<i>GS8106620</i>	<i>KIT,1-1/4,T21,CE/CA/EP ZC2</i>	<i>1</i>
	<i>GS8106620-316SS</i>	<i>KIT,1-1/4,T21,CE/CA/EP,316SS MET ZC2</i>	<i>1</i>
	<i>GS8106610</i>	<i>KIT,1-1/4,T21,TC/CA/VI ZC2 1512,215,252,325,43</i>	<i>1</i>

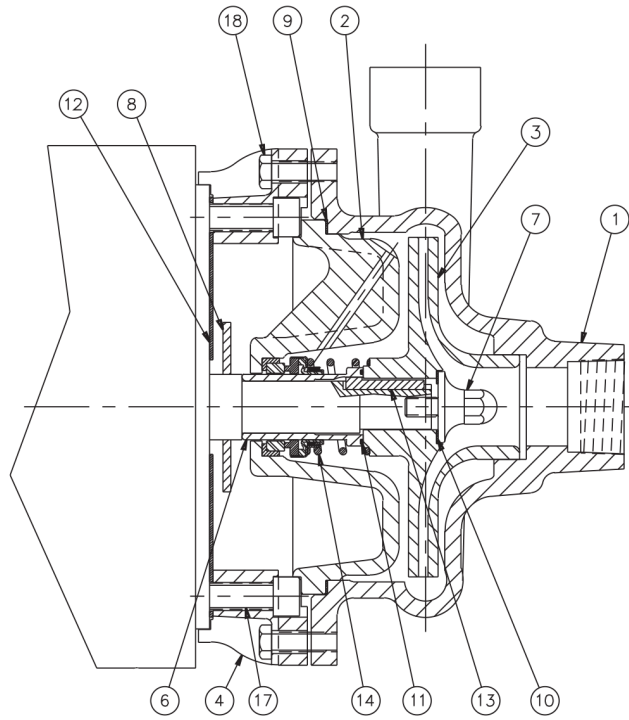

Ref #	Component
1	Casing
2	Cover
3	Impeller
4	Adapter
5	Wear Ring
6	Shaft Sleeve
7	Impeller Screw
8	Slinger
9	Gasket, Impeller Screw
10	Gasket, Casing
11	O-Ring, Shaft Sleeve
12	Splashplate
13	Key, Impeller
14	Seal Kit
17	Capscrew (Motor/Adapter)
18	Capscrew (Casing/Adapter)

**Exploded View**

*Optional Items Shown in ITALICS*

Ref #	Component Item No.	Description	Qty Per
14	<i>GS8107830</i>	<i>KIT, 1-1/4, T21, SC/CA/VI ZC2</i>	1
	<i>GS8111170-316SS</i>	<i>KIT, 1-1/4, T21, TC/SC/BU, 316SS MET ZC2 1512, 215, 252, 325, 43</i>	1
17	<b>GX5077100</b>	<b>CAPSCRW, HX, 3/8-16X1, 18-8SS HX HD</b>	<b>12</b>
18	<b>GX5077100</b>	<b>CAPSCRW, HX, 3/8-16X1, 18-8SS HX HD</b>	<b>8</b>

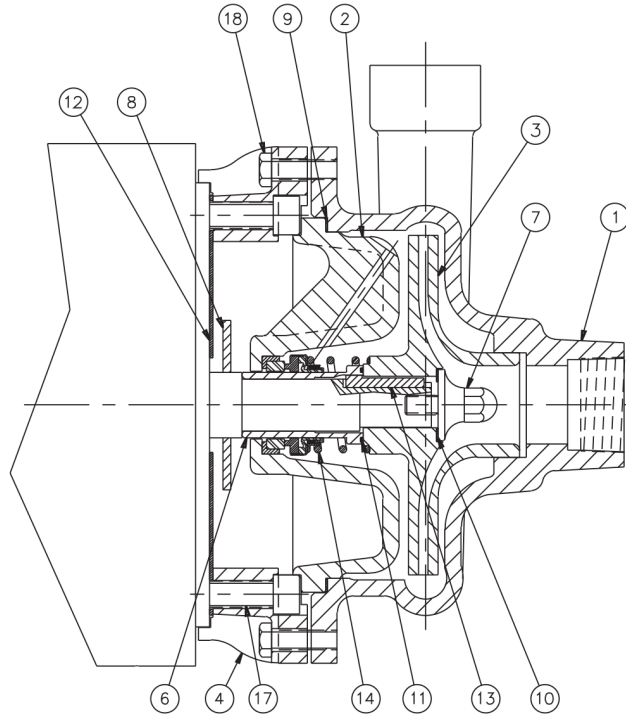

Ref #	Component
1	Casing
2	Cover
3	Impeller
4	Adapter
5	Wear Ring
6	Shaft Sleeve
7	Impeller Screw
8	Slinger
9	Gasket, Impeller Screw
10	Gasket, Casing
11	O-Ring, Shaft Sleeve
12	Splashplate
13	Key, Impeller
14	Seal Kit
17	Capscrew (Motor/Adapter)
18	Capscrew (Casing/Adapter)

**Exploded View**

*Optional Items Shown in ITALICS*

Ref #	Component Item No.	Description	Qty Per
1	SV8402802	CASING,2-1/2X2,SS KC2	1
2	SC8302471	COVER,2-1/2X2,SS DC2	1
3	SI8302491	IMPELLER,2-1/2X2,SS DC2	1
4	GX8301391	ADAPTER,210 JM FRAME ZC2	1
	<i>SX8301392</i>	<i>ADAPTER,210 JM FRAME,SS ZC2</i>	<i>1</i>
6	SX8103721	SLEEVE,SHFT,SS ZC2	1
7	SI8107270	SCREW,IMP,SS DC2 EC2 KC2 MC3 ZC2	1
8	GX5042301	SLINGER,1-7/32X3-1/4X5/32 80 DUR (180JM-210JM)	1
9	GX5041000	GASKET,6-5/8X7-5/32X1/32 ,N-8090	1
10	GX5038500	O-RING,,989X1.29X.070,BUNA 70 DUR, IMP SCRW	1
	<i>GX5038502</i>	<i>O-RING,T21,1-1/4,EPDM (2-022)</i>	<i>1</i>
	<i>GX5038501</i>	<i>O-RING,43/252/325,VIT,FDA CMPL DC3 ZC2</i>	<i>1</i>
11	GX5098300	O-RING,T21,1-1/4,BUNA,SLV	1
	<i>GX5098301</i>	<i>O-RING,T21,1-1/4,EPDM,SLV (1-1/4 X 1-3/8 X 1/16)</i>	<i>1</i>
	<i>GX5098302</i>	<i>O-RING,43/252/325,VIT DC3</i>	<i>1</i>
12	GX5091400	SPLASHPLATE,EC2 KC2 RC2 ZC2,SS FR213-256	1
13	GX5051300	KEY,IMP,,187SQX1.5 EC KC RC ZC	1
14	GS8103410	KIT,1-1/4,T21,CE/CA/BU ZC2	1
	<i>GS8103410-316SS</i>	<i>KIT,1-1/4,T21,CE/CA/BU,316SS MET ZC2</i>	<i>1</i>
	<i>GS8105960</i>	<i>KIT,1-1/4,T21,CE/CA/VI ZC2</i>	<i>1</i>
	<i>GS8105960-316SS</i>	<i>KIT,1-1/4,T21,CE/CA/VI,316SS MET ZC2</i>	<i>1</i>
	<i>GS8106590</i>	<i>KIT,1-1/4,T21,NI/CA/BU ZC2</i>	<i>1</i>
	<i>GS8106590-316SS</i>	<i>KIT,1-1/4,T21,NI/CA/BU,316SS MET ZC2</i>	<i>1</i>
	<i>GS8106620</i>	<i>KIT,1-1/4,T21,CE/CA/EP ZC2</i>	<i>1</i>
	<i>GS8106620-316SS</i>	<i>KIT,1-1/4,T21,CE/CA/EP,316SS MET ZC2</i>	<i>1</i>
	<i>GS8106610</i>	<i>KIT,1-1/4,T21,TC/CA/VI ZC2 1512,215,252,325,43</i>	<i>1</i>
	<i>GS8107830</i>	<i>KIT,1-1/4,T21,SC/CA/VI ZC2</i>	<i>1</i>

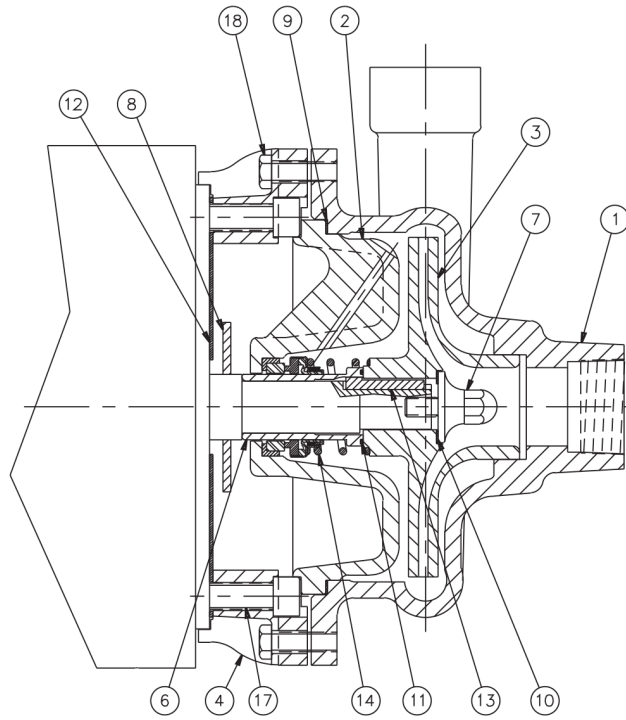

Ref #	Component
1	Casing
2	Cover
3	Impeller
4	Adapter
5	Wear Ring
6	Shaft Sleeve
7	Impeller Screw
8	Slinger
9	Gasket, Impeller Screw
10	Gasket, Casing
11	O-Ring, Shaft Sleeve
12	Splashplate
13	Key, Impeller
14	Seal Kit
17	Capscrew (Motor/Adapter)
18	Capscrew (Casing/Adapter)

**Exploded View**

*Optional Items Shown in ITALICS*

Ref #	Component Item No.	Description	Qty Per
14	<i>GS8111170-316SS</i>	<i>KIT, 1-1/4, T21, TC/SC/BU, 316SS MET ZC2 1512, 215, 252, 325, 43</i>	1
17	<b>GX5077100</b>	<b>CAPSCRW, HX, 3/8-16X1, 18-8SS HX HD</b>	4
	<b>GX5077200</b>	<b>CAPSCRW, HX, 3/8-16X1-1/4, 18-8SS HX HD</b>	4
18	<b>GX5077400</b>	<b>CAPSCRW, SH, 1/2-13X1-3/4, BLK OX SCKT HD</b>	4