

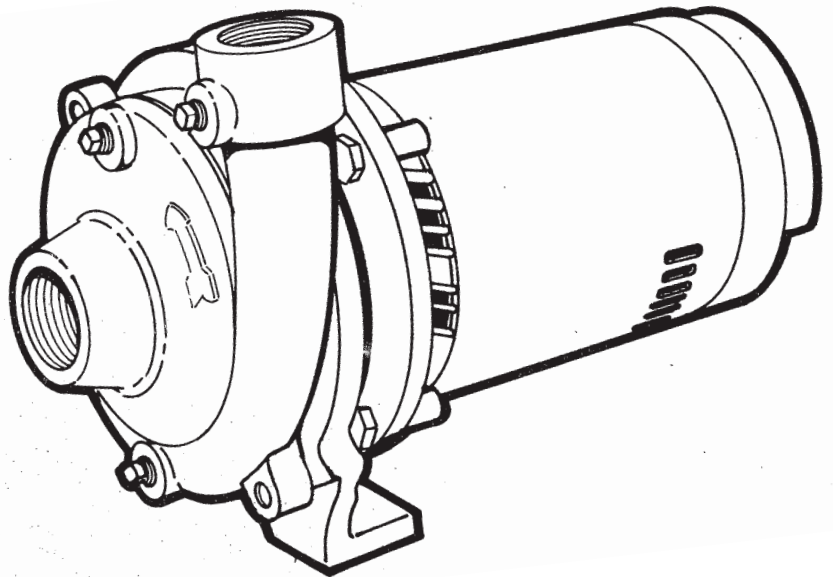

**MYERS®**



MODELS 125M/B,  
150M/B and 200M/B

1½, 2, 3 AND 7½ HP SINGLE AND THREE PHASE

**CENTRI-THRIFT  
CENTRIFUGAL PUMPS**

NOTE! To the installer: Please make sure you provide this manual to the owner of the equipment or to the responsible party who maintains the system.

**WARNING! IMPORTANT SAFETY INSTRUCTIONS!  
READ CAREFULLY BEFORE INSTALLATION**

**CALIFORNIA PROPOSITION 65 WARNING:**

**⚠ WARNING** This product and related accessories contain chemicals known to the State of California to cause cancer, birth defects or other reproductive harm.

**SAFE DRINKING WATER ACT:**

**⚠ WARNING** This product is to be used **EXCLUSIVELY** for non-potable water services. This product is not anticipated to be used for human consumption so is not designed for the low lead levels stated in the Safe Drinking Water Act. It is illegal to use this product for potable water applications for human consumption, such as drinking water, oral hygiene, hand washing, food preparation and dishwashing.

**FAILURE TO FOLLOW THESE INSTRUCTIONS AND COMPLY WITH ALL CODES MAY CAUSE SERIOUS BODILY INJURY AND/OR PROPERTY DAMAGE.**

⚠ 1) Before installing or servicing your pump, **BE CERTAIN THE PUMP POWER SOURCE IS TURNED OFF AND DISCONNECTED.**

⚠ 2) All installation and electrical wiring must adhere to state and local codes. Check with appropriate community agencies or contact your local electrical and pump professionals for help.

⚠ 3) **CALL AN ELECTRICIAN WHEN IN DOUBT.** Pump must be connected to a separate electrical circuit directly from the entrance box. There must be an appropriately sized fuse or circuit breaker in this line. Tying into existing circuits may cause circuit overloading, blown fuses, tripped circuit breakers or a burned-up motor.

⚠ 4) Do not connect pump to a power supply until the pump is grounded. For maximum safety, a ground fault interrupter should be used. **CAUTION: FAILURE TO GROUND THIS UNIT PROPERLY MAY RESULT IN SEVERE ELECTRICAL SHOCK.**

⚠ 5) **WARNING:** Reduced risk of electric shock during operation of this pump requires the provision of acceptable grounding. If the means of connection to the supply-connection box is other than grounded metal conduit, ground the pump back to the service by connecting a copper conductor, at least the size of the circuit conductors supplying the pump, to the grounding screw provided within the wiring compartment.

This pump is provided with a means for grounding. To reduce the risk of electric shock from contact with adjacent metal parts, bond supply box to the pump-motor-grounding means and to all metal parts accessible including metal discharge pipes and the like, by means of a clamp, a weld or both if necessary, secured to the equipment-grounding terminal.

⚠ 6) The voltage and phase of the power supply must match the voltage and phase of the pump.

⚠ 7) Do not use an extension cord. Above ground joints must be made in an approved junction box.

⚠ 8) Do not work on this pump or switch while the power is on.

⚠ 9) Never operate a pump with a frayed or brittle power cord, and always protect it from sharp objects, hot surfaces, oil and chemicals. Avoid kinking the cord.

⚠ 10) Never service a motor or power cord with wet hands or while standing in or near water or damp ground.

⚠ 11) The three phase units must be wired by a qualified electrician, using an approved starter box and switching device.

⚠ 12) Do not use this pump in or near a swimming pool.

⚠ 13) Single phase motors are equipped with automatic resetting thermal protectors. The motor may restart unexpectedly, causing the leads to energize or pump to turn on. Three phase motors should be protected by proper thermal and amperage protection. (Check local codes.)

⚠ 14) Check for nicks in the wire and pump insulation by using an ohmmeter and checking resistance to ground before installing the pump and after installing the pump. If in doubt on the proper procedure, check with a qualified electrician.

⚠ 15) Do not pump gasoline, chemicals, corrosives or flammable liquids; they could ignite, explode or damage the pump, causing injury and voiding the warranty.

⚠ 16) Do not run this pump with discharge completely closed. This will create superheated water, which could damage the seal and shorten the life of the motor. This superheated water could also cause severe burns. Always use a pressure relief valve, set below the rating of the tank system.

⚠ 17) Do not run the pump dry, fail to protect the pump from below freezing temperatures, run the pump with the discharge completely closed or pump chemicals or corrosive liquids.

⚠ 18) Never work on the pump or system without relieving the internal pressure.

⚠ 19) Do not pump water above 120° Fahrenheit.

⚠ 20) Never exceed the pressure rating of any system component.

**INSTALLATION**

**PACKAGE CONTENTS**

1. Each pump is carefully tested and packaged at the factory.

2. The catalog lists all parts included with package. A packing list packed with pump, also lists contents.
3. Be sure all parts have been furnished and that nothing has been damaged in shipment.
4. OPEN PACKAGES AND MAKE THIS CHECK BEFORE GOING ON JOB.

## PIPING

Pipes must line up and not be forced into position by unions. **Piping should be independently supported near the pump so that no strain will be placed on the pump casing.** Where any noise is objectionable, pump should be insulated from the piping with rubber connections. Always keep pipe size as large as possible and use a minimum of fittings to reduce friction losses.

## SUCTION PIPING

Suction pipe should be direct and as short as possible. It should be at least one size larger than suction inlet tapping and should have a minimum of elbows and fittings. The piping should be laid out so that it slopes upward to pump without dips or high points so that air pockets are eliminated. The highest point in the suction piping should be the pump inlet except where liquid flows to the pump inlet under pressure. A foot valve must be used to keep pump primed. Where liquid flows to the pump, it may be desirable to use a check valve in the suction line or discharge line to keep pump primed.

To prevent air from being drawn into suction pipe due to a suction whirlpool, the foot valve should be submerged at least three feet below the low water level. The suction pipe must be tight and free of air leaks or pump will not operate properly.

## DISCHARGE PIPING

Discharge piping should never be smaller than pump tapping and should preferably be one size larger. A gate valve should always be installed in discharge line to serve as a shut-off for throttling if capacity is not correct. To protect the pump and foot valve from water hammer and to prevent back flow, a check valve should be installed in the discharge line between the pump and gate valve.

## ELECTRICAL CONNECTIONS

Be sure motor wiring is connected for voltage being used. Unit should be connected to a separate circuit, direct from main switch. A fused disconnect switch or circuit breaker must be used in this circuit. Wire of sufficient size should be used to keep voltage drop to a maximum of 5%. All motors, unless provided with built-in overload protection, must be protected with an overload switch, either manual or magnetic. Three phase motors require overload protection. Single phase motors are equipped with built-in overload protection. **Never install a pump without proper overload protection.** A flexible metallic conduit should be used to protect the motor leads.

## PRIMING

The pump must be primed before starting. The pump casing and suction piping must be filled with water before starting motor. Remove vent plug in top of casing while pouring in priming water. A hand pump or ejector can be used for priming when desired. When water is

poured into pump to prime, use care to remove all air before starting motor. If pump does not start immediately, stop and reprime.

## STARTING

It is good practice to close the discharge valve when starting the pump as it puts less starting load on the motor. When the pump is up to operating speed, open the discharge valve to obtain desired capacity or pressure. Do not allow the pump to run for long periods with the discharge valve tightly closed. If the pump runs for an extended period of time without liquid being discharged, the liquid in the pump case can get extremely hot.

## ROTATION

The pump must run in direction of arrow on pump case. All single phase motors are single rotation and leave factory with proper rotation. Three phase motors may run either direction. If rotation is wrong when first starting motor, interchange any two line leads to change rotation.

## STOPPING

Before stopping pump, close the discharge valve. This will prevent water hammer and is especially important on high head pumps.

## FREEZING

Care should be taken to prevent the pump from freezing during cold weather. It may be necessary, when there is any possibility of this, to drain the pump casing when not in operation. Drain by removing the pipe plug in the bottom of the casing.

## ROTARY SEAL

Centrifugal pumps are fitted only with rotary seal. This seal is recommended for water free from abrasives. If liquid contains abrasives, the centrifugal pump should not be used.

## BEARINGS

Lubricate motor bearings in accordance with motor manufacturer's instructions.

Single seal ball bearings are used on 125B, 150B and 200B bearing bracket units. Proper amount of grease has been provided in the bracket cavity between the bearings. This should be sufficient grease for 4000 hour operation. After this usage the old grease should be cleaned out and new grease added. Use only best grade ball bearing greases.

## **DISASSEMBLY INSTRUCTIONS**

All pumping parts can be removed from case without disturbing the piping.

### **POWER SUPPLY**

Open the power supply switch contacts and remove fuses. Disconnect the electrical wiring from the motor.

### **VOLUTE CASE**

Drain pump case by removing drain plugs.

Remove the bolts securing volute case to pump bracket. Pry components apart.

### **IMPELLER**

Remove impeller.

### **SEAL**

Always replace both rotating assembly and stationary ceramic seat. **DO NOT USE OLD STATIONARY SEAT WITH NEW ROTATING SEAL ASSEMBLY.**

Pry out rotating assembly of shaft seal.

Remove ceramic ring from housing.

A new shaft seal should always be used when rebuilding a pump. All pump parts should be cleaned thoroughly before being reassembled.

### **MOTOR**

Remove four bolts holding bracket to motor and remove motor.

Remove set screw in stub shaft coupling to disconnect motor pump shaft.

## **ASSEMBLY INSTRUCTIONS**

### **MOTOR**

Place rubber deflector over motor shaft, slide shaft extension into position and tighten set screws.

Assemble motor and shaft onto bracket.

### **SEAL INSTALLATION**

Insert seal seat in position by using finger pressure to press firmly and squarely until it bottoms. The use of light oil on the rubber element will facilitate assembly. Care must be taken to keep oil, grease and dirt off face areas of seal. Be sure the seal faces are not damaged during assembly or the seal will leak during operation.

Check dimension from face of ceramic seat to shaft shoulder. This distance should be within a tolerance of  $\pm 1/64$ .

Install rotating element of seal on shaft. Be sure the lapped sealing surface is toward seal seat and assemble impeller. Check diameter of impeller against motor horsepower rating to ensure proper performance.

### **IMPELLER**

Secure impeller using key, impeller retainer washer, 5/16 stainless steel helical spring lockwasher and socket head cap screw, 1" long.

### **VOLUTE CASE**

Worn volute case will cause excessive leakage with a new impeller, thereby reducing the amount of service obtained from a new impeller.

Assemble gasket and volute case.

Rotate pump shaft with fingers, being sure that there is no tight spot or binding assembly. A uniform drag of the seal faces will be present.

# Centri-Thrift Centrifugal Pump Parts List

Single and Three Phase –Rotary Seal or Stuffing Box

Catalog Numbers 125M–1-1/2, 125M–2, 125M–3

1-1/2" Suction –1-1/4" Discharge

Pump Nameplate Catalog Number Horsepower			125M–1-1/2 1-1/2	125M–2 2	125M–3 3
Ref. No.	Description	No. Req.	Part No.	Part No.	Part No.
1	Motor – See Chart Below.	1			
2	Pump Shaft Assembly – See Chart Below with corresponding Motor and Bracket.	1			
3	Bracket – See Chart Below with corresponding Motor and Pump Shaft Assembly.	1			
–	Set Screw for Shaft Assembly, Single Phase Motor	2	05013A015	05013A015	06024A001
–	Set Screw for Shaft Assembly, Three Phase Motor	2	05013A015	05013A015	05013A015
4	Cap Screw – Bracket to Motor, 3/8"-16NC x 1-1/8"	4	19101A016	19101A016	19101A016
	Cap Screw – Bracket to Motor, 1/2"-13NC x 1-1/4"	4	–	–	19103A004
	Cap Screw – Bracket to Motor, 3/8"-16 NC x 1"	4	–	–	19101A013
5	Cap Screw – Bracket to Case, 3/8"-16NC x 1-1/8"	8	19101A016	19101A016	19101A016
6	Lockwasher – 3/8"	12	05454A007	05454A007	05454A007
	Lockwasher – 1/2"	4	–	–	05454A004
7	Shaft Seal	1	11716A001K	11716A001K	11716A001K
–	Nut for Studs	2	19109A021	19109A021	19109A021
8	Impeller	1	11725B001	11725B002	11725B003
–	Key for Impeller	1	05818A025	05818A025	05818A025
9	Washer – Special	1	11718A000	11718A000	11718A000
–	Lockwasher – 5/16"	1	05454A014	05454A014	05454A014
10	Cap Screw – Stainless Steel	1	19100A004	19100A004	19100A004
11	Gasket – Case to Bracket	1	05863A013	05863A013	05863A013
12	Volute Case	1	11726D001	11726D001	11726D001
13	Pipe Plug – 1/8"	4	05022A004	05022A004	05022A004
	Pipe PLug – 1/4"	1	05022A009	05022A009	05022A009
14	Deflector – Rubber, for 5/8" Shaft	1	05059A318	05059A318	05059A318
	Deflector – Rubber, for 7/8" Shaft	1	–	05059A320	05059A320
	Deflector – Rubber, for 1-1/8" Shaft	1	–	–	05059A321

Motor Horsepower	1-1/2	1-1/2	2	2	2	2	3	3	3	3	3
Pump Serial Number	654	654	654	654	756	756	654	654	157	974	974
Motor Number	11708A000	RTF	–	–	13229A000	20051A000	RTF	–	RTF	21206A000	21207A000
Voltage	115/230	220/440	115/230	220/440	115/230	220/440	115/230	220/440	220/440	115/230	230/460
Phase	Single	Three	Single	Three	Single	Three	Single	Three	Three	Single	Three
Motor Bolt Circle	5-7/8"	5-7/8"	5-7/8"	5-7/8"	5-7/8"	5-7/8"	7-1/4"	7-1/4"	5-7/8"	5-7/8"	5-7/8"
Motor Shaft Diameter	5/8"	5/8"	7/8"	7/8"	5/8"	5/8"	1-1/8"	7/8"	7/8"	5/8"	5/8"
Shaft – Rotary Seal	11714B001	11714B001	11723B001	11723B001	11714B001	11714B001	11914B001	RTF	RTF	11714B001	11714B001
Bracket – Rotary Seal	11715D000	11715D000	11715D000	11715D000	11715D000	11715D000	11912D000	11912D000	11715D000	11715D000	11715D000

# Centri-Thrift Centrifugal Pump Parts List

Single and Three Phase –Rotary Seal

Catalog Numbers 125M–1-1/2, 125M–2, 125M–3

1-1/2" Suction –1-1/4" Discharge

Pump Nameplate Catalog Number Horsepower			125M–1-1/2 1-1/2	125M–2 2	125M–3 3
Ref. No.	Description	No. Req.	Part No.	Part No.	Part No.
1	Motor – See Chart Below.	1			
–	Pump Shaft Assembly – See Chart Below.	1			
–	Bracket – See Chart Below.	1			
–	Set Screw for Shaft Assembly, Single Phase Motor	2	05013A015	05013A015	06024A001
–	Set Screw for Shaft Assembly, Three Phase Motor	2	05013A015	05013A015	05013A015
–	Cap Screw – Bracket to Motor, 3/8"-16NC x 1-1/8"	4	19101A016	19101A016	19101A016
	Cap Screw – Bracket to Motor, 1/2"-13NC x 1-1/4"	4	–	–	19103A004
	Cap Screw – Bracket to Motor, 3/8"-16NC x 1"	4	–	–	19101A013
–	Cap Screw – Bracket to Case, 3/8"-16NC x 1-1/8"	8	19101A016	19101A016	19101A016
–	Lockwasher – 3/8"	12	05454A007	05454A007	05454A007
	Lockwasher – 1/2"	4	–	–	05454A004
–	Impeller	1	11725B001	11725B002	11725B003
–	Key for Impeller	1	05818A025	05818A025	05818A025
–	Washer – Special	1	11718A000	11718A000	11718A000
–	Lockwasher – 5/16"	1	05454A014	05454A014	05454A014
–	Cap Screw – Stainless Steel	1	19100A004	19100A004	19100A004
2	Gasket – Case to Bracket	1	05863A013	05863A013	05863A013
3	Volute Case	1	11726D001	11726D001	11726D001
4	Pipe Plug – 1/8"	4	05022A004	05022A004	05022A004
	Pipe PLug – 1/4"	1	05022A009	05022A009	05022A009
5	Deflector – Rubber, for 5/8" Shaft	1	05059A318	05059A318	05059A318
	Deflector – Rubber, for 7/8" Shaft	1	05059A320	05059A320	05059A320
	Deflector – Rubber, for 1-1/8" Shaft	1	–	–	05059A321

Motor Horsepower	2	2	2	2	3	3	3	3	3
Pump Serial Number	654	654	756	756	654	654	157	974	974
Motor Number	–	–	13229A000	20051A000	RTF	–	RTF	21206A000	21207A000
Voltage	115/230	220/440	115/230	220/440	115/230	220/440	220/440	115/230	230/460
Phase	Single	Three	Single	Three	Single	Three	Three	Single	Three
Motor Bolt Circle	5-7/8"	5-7/8"	5-7/8"	5-7/8"	7-1/4"	7-1/4"	5-7/8"	5-7/8"	5-7/8"
Motor Shaft Diameter	7/8"	7/8"	5/8"	5/8"	1-1/8"	7/8"	7/8"	5/8"	5/8"
Shaft – Rotary Seal	11723B001	11723B001	11714B001	11714B001	11914B001	RTF	RTF	11714B001	11714B001
Bracket – Rotary Seal	11715D000	11715D000	11715D000	11715D000	11912D000	11912D000	11715D000	11715D000	11715D000

# Centri-Thrift Centrifugal Pump Parts List

Single and Three Phase –Rotary Seal or Stuffing Box

Catalog Numbers 150M–2, 150M–3, 150M–5

2" Suction –1-1/2" Discharge

Pump Nameplate Catalog Number Horsepower			150M–2 2	150M–3 3	150M–5 5
Ref. No.	Name of Part	No. Req.	Part No.	Part No.	Part No.
1	Motor – See Chart Below.	1			
2	Pump Shaft Assembly – See Chart Below with corresponding Motor and Bracket.	1			
3	Bracket – See Chart Below with corresponding Motor and Pump Shaft Assembly.	1			
–	Set Screw for Shaft Assembly, Single Phase Motor	2	05013A015	06024A001	06024A001
–	Set Screw for Shaft Assembly, Three Phase Motor	2	05013A015	05013A015	06024A001
4	Cap Screw – Bracket to Motor, 3/8"-16NC x 1-1/8"	4	19101A016	19101A016	–
	Cap Screw – Bracket to Motor, 1/2"-13NC x 1-1/4"	4	–	–	19103A004
	Cap Screw – Bracket to Motor, 3/8"-16NC x 1"	4	–	19101A013	–
5	Cap Screw – Bracket to Case, 3/8"-16NC x 1-1/8"	8	19101A016	19101A016	19101A016
6	Lockwasher – 3/8"	12	05454A007	05454A007	–
	Lockwasher – 3/8"	8	–	–	05454A007
	Lockwasher – 1/2"	4	–	05454A004	05454A004
7	Shaft Seal	1	RTF	RTF	RTF
–	Nut for Studs	2	19109A021	19109A021	19109A021
8	Impeller	1	12935B003	12935B001	12935B003
–	Key for Impeller	1	05818A025	05818A025	05818A025
9	Washer – Special	1	12933A000	12933A000	12933A000
–	Lockwasher – 5/16"	1	05454A014	05454A014	05454A014
10	Cap Screw – Stainless Steel	1	06106A008	06106A008	06106A008
11	Gasket – Case to Bracket	1	–	–	–
12	Volute Case	1	12937D001	12937D001	12937D001
	Wearing Ring – For Units w/Wearing Ring	1	12934A000	12934A000	12934A000
13	Pipe Plug – 1/8"	4	05022A004	05022A004	05022A004
	Pipe PLug – 1/4"	1	05022A009	05022A009	05022A009
14	Deflector – Rubber, for 5/8" Shaft	1	05059A318	–	–
	Deflector – Rubber, for 7/8" Shaft	1	–	05059A320	–
	Deflector – Rubber, for 1-1/8" Shaft	1	–	05059A321	05059A321

Motor Horsepower	2	2	3	3	3	3	3	5	5
Pump Serial Number	1056	1056	1056	1056	157	974	974	1056	1056
Motor Number	13229A000	20051A000	RTF	–	RTF	21206A000	21207A000	18939A000	18941A000
Voltage	115/230	220/440	115/230	220/440	220/440	115/230	230/460	115/230	220/440
Phase	Single	Three	Single	Three	Three	Single	Three	Single	Three
Motor Bolt Circle	5-7/8"	5-7/8"	7-1/4"	7-1/4"	5-7/8"	5-7/8"	5-7/8"	7-1/4"	7-1/4"
Motor Shaft Diameter	5/8"	5/8"	1-1/8"	7/8"	7/8"	5/8"	5/8"	1-1/8"	1-1/8"
Shaft – Rotary Seal	11714B001	11714B001	11914B001	RTF	RTF	11714B001	11714B001	11914B001	11914B001
Bracket – Rotary Seal	11715D000	11715D000	11912D000	11912D000	RTF	11715D000	11715D000	11912D000	11912D000

# Centri-Thrift Centrifugal Pump Parts List

Single and Three Phase –Rotary Seal

Catalog Numbers 200M–3, 200M–5, 200M–7-1/2

2-1/2" Suction –2" Discharge

Pump Nameplate Catalog Number Horsepower			200M–3 3	200M–5 5	200M–7-1/2 7-1/2
Ref. No.	Name of Part	No. Req.	Part No.	Part No.	Part No.
1	Motor – See Chart Below.	1			
–	Pump Shaft Assembly – See Chart Below.	1			
–	Bracket – See Chart Below.	1			
–	Set Screw for Shaft Assembly, Single Phase Motor	2	06024A001	06024A001	06024A001
–	Set Screw for Shaft Assembly, Three Phase Motor	2	05013A015	06024A001	06024A001
–	Cap Screw – Bracket to Motor, 3/8"-16NC x 1-1/8"	4	19101A016	–	–
	Cap Screw – Bracket to Motor, 1/2"-13NC x 1-1/4"	4	19103A004	19103A004	19103A004
	Cap Screw – Bracket to Motor, 3/8"-16NC x 1"	4	19101A003	–	–
–	Cap Screw – Bracket to Case, 3/8"-16NC x 1-1/8"	8	19101A016	19101A016	19101A016
–	Lockwasher – 3/8"	12	05454A007	–	–
	Lockwasher – 3/8"	8	–	05454A007	05454A007
	Lockwasher – 1/2"	4	05454A004	05454A004	05454A004
–	Impeller	1	12936B002	12936B001	12936B003
–	Key for Impeller	1	05818A025	05818A025	05818A025
–	Washer – Special	1	12933A000	12933A000	12933A000
–	Lockwasher – 5/16"	1	05454A014	05454A014	05454A014
–	Tap Bolt – Stainless Steel	1	06106A008	06106A008	06106A008
2	Gasket – Case to Bracket	1	05863A013	05863A013	05863A013
3	Volute Case	1	12938D001	12938D001	12938D001
4	Pipe Plug – 1/8"	4	05022A004	05022A004	05022A004
	Pipe PLug – 1/4"	1	05022A009	05022A009	05022A009
5	Deflector – Rubber, for 5/8" Shaft	1	05059A318	–	–
	Deflector – Rubber, for 7/8" Shaft	1	05059A320	–	–
	Deflector – Rubber, for 1-1/8" Shaft	1	05059A321	05059A321	05059A321
6	Wearing Ring – For Units w/Wearing Ring	1	12934A000	12934A000	12934A000

Motor Horsepower	3	3	3	3	3	5	5	7-1/2
Pump Serial Number	974	974	1056	1056	157	1056	1056	1056
Motor Number	21206A000	21207A000	RTF	–	RTF	18939A000	18941A000	18944A000
Voltage	115/230	230/460	115/230	220/440	220/440	115/230	220/440	220/440
Phase	Single	Three	Single	Three	Three	Single	Three	Three
Motor Bolt Circle	5-7/8"	5-7/8"	7-1/4"	7-1/4"	5-7/8"	7-1/4"	7-1/4"	7-1/4"
Motor Shaft Diameter	5/8"	5/8"	1-1/8"	7/8"	7/8"	1-1/8"	1-1/8"	1-1/8"
Shaft – Rotary Seal	11714B001	11714B001	11914B001	RTF	RTF	11914B001	11914B001	11914B001
Bracket – Rotary Seal	11715D000	11715D000	11912D000	11912D000	RTF	11912D000	11912D000	11912D000



# Centri-Thrift Centrifugal Pump Parts List

## Belt Driven

Pump Name and Plate Catalog Number			125B	125B	150B	200B
Pump Nameplate Serial Number			654 Plus Year Made	856 Plus Year Made	1056 Plus Year Made	1056 Plus Year Made
Suction			1-1/2"	1-1/2"	2"	2-1/2"
Discharge			1-1/4"	1-1/4"	1-1/2"	2"
Ref. No.	Name of Part	No. Req.	Part No.		Part No.	Part No.
1	Bearing Housing Only	1	11727C000	11727C000	11727C000	11727C000
2	Shaft for Belt Driven Head	1	RTF	11728B001	11728B001	11728B001
3	Bearing for Housing – Belt Driven Head	2	11729A001	11729A001	11729A001	11729A001
4	Snap Ring – Belt Driven Head	1	10848A003	10848A003	10848A003	10848A003
5	Snap Ring – Belt Driven Head	2	10848A004	10848A004	10848A004	10848A004
6	Pipe Plug – 1/4", Belt Driven Head	3	05022A060	05022A060	05022A060	05022A060
7	Deflector – Rubber, for 7/8" Shaft	1	05059A320	05059A320	05059A320	05059A320
8	Set Screw – 5/16"-18NC, 5/8" Long, Headless	2	05013A007	05013A007	05013A007	05013A007
–	Key for Pulley – 3/16" x 3/16" x 1-3/4" Long	1	–	05818A015	05818A015	05818A015
9	Pump Shaft Assembly – Rotary Seal	1	11723B001	11723B001	11723B001	11723B001
–	Set Screw for Shaft Assembly– 5/16"-18NC, 5/16" Long	2	05013A015	05013A015	05013A015	05013A015
10	Bracket for Use with Rotary Seal	1	11715D000	11715D000	11715D000	11715D000
11	Cap Screw – 3/8"-16NC, 1-1/8" Long, Bracket to Bearing Housing	4	19101A016	19101A016	19101A016	19101A016
12	Cap Screw – 3/8"-16NC, 1-1/8" Long, Bracket to Case	8	19101A016	19101A016	19101A016	19101A016
13	Lockwasher – 3/8"	12	05454A007	05454A007	05454A007	05454A007
14	Shaft Seal	1	RTF	RTF	RTF	RTF
15	Gasket – Case to Bracket	1	05863A013	05863A013	05863A013	05863A013
16	Volute Case with Wearing Ring	1	11726D001	11726D001	12937D001	12938D001
17	Wearing Ring Only	1	RTF	RTF	12934A000	12934A000
18	Pipe Plug – 1/8"	4	05022A004	05022A004	05022A004	05022A004
19	Nut for Studs	2	19109A021	19109A021	19109A021	19109A021
20	Impeller	1	11725B003	11725B003	12935B003	12936B003
21	Key for Impeller – 3/16" x 3/16" x 3/4" Long	1	05818A025	05818A025	05818A025	05818A025
22	Washer – Special	1	11718A000	11718A000	12933A000	12933A000
23	Lockwasher – 5/16"	1	05454A014	05454A014	05454A014	05454A014
24	Cap Screw – Stainless Steel	1	19100A004	19100A004	06106A008	06106A008
–	Pipe Plug – 1/4"	1	05022A009	05022A009	05022A009	05022A009

# Centri-Thrift Field Assembly Kits Parts List

125M-FA Series  
150M-FA Series  
200M-FA Series

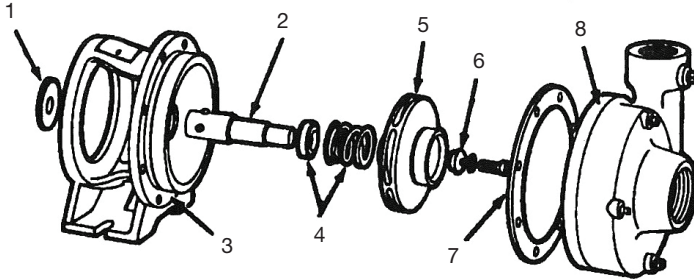

Ref. No.	Part Number	Description	Qty.
-	16837A002	Kit – Cat. No. 125M-2FA	-
	16837A014	Kit – Cat. No. 125M-3FA	-
	16837A005	Kit – Cat. No. 150M-2FA	-
	16837A015	Kit – Cat. No. 150M-3FA	-
	16837A008	Kit – Cat. No. 150M-5FA	-
	16837A016	Kit – Cat. No. 200M-3FA	-
	16837A011	Kit – Cat. No. 200M-5FA	-
	16837A012	Kit – Cat. No. 200M-7-1/2FA	-
		- Kits consist of all listed	
1	05059A318	Rubber Deflector – All units except 150M-5FA, 200M-5FA, 200M-7-1/2FA	1
	05059A321	Rubber Deflector – 150M-5FA, 200M-5FA, 200M-7-1/2FA	1
2	11714B001	Shaft w/Set Screws – 125M-2FA, 125M-3FA, 150M-2FA, 150M-3FA, 200M-3FA	1
	11914B001	Shaft w/Set Screws – 150M-5FA, 200M-FA, 200M-7-1/2FA	1
	05013A015	Screw – Set 5/16-18UNC x 5/16" Long – All units except 150M-5FA, 200M-5FA, 200M-7-1/2FA	2
	06024A001	Screw – Set 5/16-18UNC x 5/16" Long – 150M-5FA, 200M-5FA, 200M-7-1/2FA	2
3	11715D000	Bracket – All 125M units, 150M-2FA, 150M-3FA, 200-3FA	1
	11912D000	Bracket – 150M-5FA, 200M-5FA, 200M-7-1/2FA	1
	19101A016	Screw – Cap 3/8-16UNC x 1-1/8" – All units except 150M-5FA, 200M-5FA, 200M-7-1/2FA	4
	19103A004	Screw – Cap 1/2-13UNC x 1-1/4" – 150M-5FA, 200M-5FA, 200M-7-1/2FA	4
4	RTF	Seal – All units	1

Ref. No.	Part Number	Description	Qty.
5	11725B002	Impeller – 125M-2FA	1
	11725B003	Impeller – 125M-3FA	1
	12935B002	Impeller – 150M-2FA	1
	12935B001	Impeller – 150M-3FA	1
	12935B003	Impeller – 150M-5FA	1
	12936B002	Impeller – 200M-3FA	1
	12936B001	Impeller – 200M-5FA	1
	12936B003	Impeller – 200M-7-1/2FA	1
	05818A025	Key – 3/16 Sq. x 21/32" Long – All units	1
6	11718A000	Washer – All 125M units	1
	12933A000	Washer – All 150M, 200M units	1
	19100A004	Screw – Cap SST 5/16-18UNC x 3/4" – All 125M units	1
	06106A008	Screw – Socket Head SST 5/16-18UNC x 1" Long – All 150M, 200M units	1
	05454A014	Lockwasher – 5/16 SST – All units	1
7	05863A013	Gasket – 125M, 150M, 200M units	1
8	11726D001	Case – Volute – All 125M units	1
	12937D001	Case – Volute – All 150M units	1
	12938D001	Case – Volute – All 200M units	1
	12934A000	Ring – Wearing – For 150M, 200M units w/wearing ring	1
	19101A016	Screw – Cap 3/8-16UNC x 1-18" – All units	8
	05022A004	Plug - Pipe 1/8" NPT – All units	4
	05022A009	Plug – Pipe 1/4" NPT – All units	1

## **STANDARD LIMITED WARRANTY CENTRIFUGAL & RECIPROCATING PUMPS**

Pentair Myers® warrants its products against defects in material and workmanship for a period of 12 months from the date of shipment from Pentair Myers or 18 months from the manufacturing date, whichever occurs first – provided that such products are used in compliance with the requirements of the Pentair Myers catalog and technical manuals.

During the warranty period and subject to the conditions set forth, Pentair Myers, at its discretion, will repair or replace to the original user, the parts that prove defective in materials and workmanship. Pentair Myers reserves the right to change or improve its products or any portions thereof without being obligated to provide such a change or improvement for prior sold and/or shipped units.

Seals, piston cups, packing, plungers, liners and valves used for handling clear, fresh, nonaerated water at a temperature not exceeding 120°F are warranted for ninety days from date of shipment. All other applications are subject to a thirty day warranty. Accessories such as motors, engines and auxiliary equipment are warranted by the respective manufacturer and are excluded in this standard warranty. Under no circumstance will Pentair Myers be responsible for the cost of field labor, travel expenses, rented equipment, removal/reinstallation costs or freight expenses to and from the factory or an authorized Pentair Myers service facility.

This limited warranty will not apply: (a) to defects or malfunctions resulting from failure to properly install, operate or maintain the unit in accordance with the printed instructions provided; (b) to failures resulting from abuse, accident or negligence; (c) to normal maintenance services and parts used in connection with such service; (d) to units that are not installed in accordance with applicable local codes, ordinances and good trade practices; (e) if the unit is moved from its original installation location; (f) if unit is used for purposes other than for what it is designed and manufactured; (g) to any unit that has been repaired or altered by anyone other than Pentair Myers or an authorized Pentair Myers service provider; (h) to any unit that has been repaired using non factory specified/OEM parts.

Warranty Exclusions: PENTAIR MYERS MAKES NO EXPRESS OR IMPLIED WARRANTIES THAT EXTEND BEYOND THE DESCRIPTION ON THE FACE HEREOF. PENTAIR MYERS SPECIFICALLY DISCLAIMS THE IMPLIED WARRANTIES OF MERCHANTABILITY AND FITNESS FOR ANY PARTICULAR PURPOSE.

Liability Limitation: IN NO EVENT SHALL PENTAIR MYERS BE LIABLE OR RESPONSIBLE FOR CONSEQUENTIAL, INCIDENTAL OR SPECIAL DAMAGES RESULTING FROM OR RELATED IN ANY MANNER TO ANY PENTAIR MYERS PRODUCT OR PARTS THEREOF. PERSONAL INJURY AND/OR PROPERTY DAMAGE MAY RESULT FROM IMPROPER INSTALLATION. PENTAIR MYERS DISCLAIMS ALL LIABILITY, INCLUDING LIABILITY UNDER THIS WARRANTY, FOR IMPROPER INSTALLATION. PENTAIR MYERS RECOMMENDS INSTALLATION BY PROFESSIONALS.

Some states do not permit some or all of the above warranty limitations or the exclusion or limitation of incidental or consequential damages and therefore such limitations may not apply to you. No warranties or representations at any time made by any representatives of Pentair Myers shall vary or expand the provision hereof.



**MYERS®**

1101 MYERS PARKWAY  
ASHLAND, OHIO, USA 44805  
419-289-1144

[WWW.FEMYERS.COM](http://WWW.FEMYERS.COM)

Warranty Rev. 12/13