

xylem

Let's Solve Water

REPAIR PARTS

ReSHSMGR R2

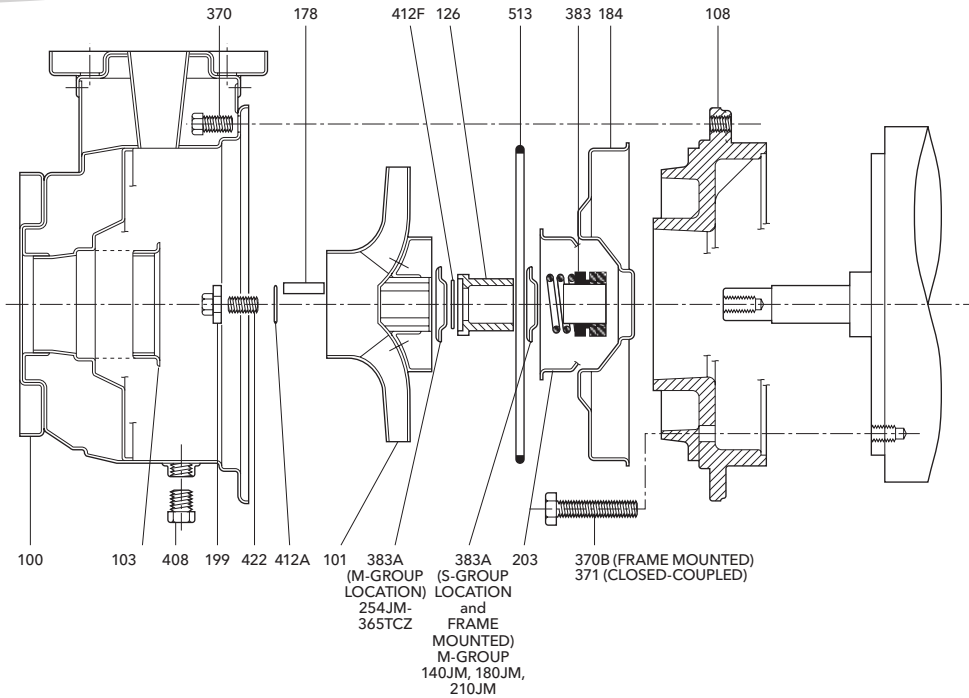

e-SH Repair Parts

316SS END SUCTION CENTRIFUGAL PUMP (60 Hz)

e-SH S-GROUP

| Item No. | Part Description | Material | 1x2-6 | | 1½x2½-6 | | 2x2½-6 | | 2½x3-6 | | 1x2-8 | | 1½x2½-8 | | 2x2½-8 | | 1x2-10 | | Max. Wt. (lb) | |
|-------------|---|-------------------|---|-------|---------------------------------|-------|---------------------------------|-------|---------------------------------|-------|---------------------------------|-------|---------------------------------|-------|--------------------------------|-------|---------------------------------|-------|---------------|--|
| | | | 01SH06 | | 15SH06 | | 02SH06 | | 25SH06 | | 01SH08 | | 15SH08 | | 02SH08 | | 01SH10 | | | |
| 100 | Casing with wear ring | | 1L450 | | 1L453 | | 1L924 | | 1L459 | | 1L451 | | 1L454 | | 1L457 | | 1L452 | | 17 | |
| 101 | Impeller | AISI Type 316SS | 6 ¹ / ₁₆ | 2L978 | 6¾ | 2L876 | 6 ⁹ / ₁₆ | 2L945 | 7 ⁵ / ₃₂ | 2L961 | 8 ³ / ₁₆ | 2L972 | 8¼ | 2L879 | 8¼ | 2L985 | 9 ⁴¹ / ₆₄ | 2L965 | 7 | |
| | | | 5 ²⁹ / ₃₂ | 2L979 | 6 ³ / ₈ | 2L874 | 6 ³ / ₁₆ | 2L946 | 6 ²⁷ / ₃₂ | 2L962 | 7 ⁴³ / ₆₄ | 2L973 | 7 ¹³ / ₁₆ | 2L878 | 7¾ | 2L986 | 8 ¹³ / ₁₆ | 2L966 | | |
| | | | 5 ³⁵ / ₆₄ | 2L980 | 6 ¹ / ₁₆ | 2L872 | 5 ¹³ / ₁₆ | 2L947 | 6½ | 2L983 | 7 ²¹ / ₆₄ | 2L974 | 7 | 2L877 | 7½ | 2L987 | 8 ²¹ / ₃₂ | 2L967 | | |
| | | | 5 ²³ / ₆₄ | 2L981 | 5 ⁵ / ₈ | 2L871 | 5½ | 2L948 | 6 ¹⁹ / ₆₄ | 2L963 | 7 | 2L975 | 6¾ | 2L876 | 7 ³ / ₁₆ | 2L988 | 8 ³ / ₁₆ | 2L968 | | |
| | | | 4 ⁶¹ / ₆₄ | 2L982 | 5 ⁵ / ₁₆ | 2L870 | 5 ¹ / ₈ | 2L949 | 5¾ | 2L984 | 6 ¹¹ / ₁₆ | 2L976 | 6 ⁷ / ₁₆ | 2L875 | 6 ⁷ / ₈ | 2L989 | 8 | 2L969 | | |
| | | | | | 4 ¹¹ / ₁₆ | 2L869 | 4 ¹³ / ₁₆ | 2L950 | 5½ | 2L964 | 6¼ | 2L977 | 6 ¹ / ₈ | 2L873 | 6 ³ / ₁₆ | 2L990 | 7¾ | 2L970 | | |
| | | | | | 4 ³ / ₈ | 2L868 | 4 ⁷ / ₁₆ | 2L951 | | | | | | | | | 7 ¹³ / ₆₄ | 2L971 | | |
| 103 | Wear ring, casing | | 4L465 | | 4L466 | | 4L467 | | 4L468 | | 4L465 | | 4L466 | | 4L467 | | 4L465 | | 1 | |
| 184 | Seal housing with ring | | 1L465 | | | | 1L925 | | 1L472 | | 1L466 | | | | 1L470 | | 1L467 | | 3 | |
| 203 | Wear ring, seal housing | | See Item 100 | | | | | | 4L464 | | See Item 100 | | | | | | | | | |
| 126 | Shaft sleeve | 316SS | 4L473 | | 4L456 | | | | 4L473 | | 4L456 | | | | 4L473 | | | | | |
| 178 | Key, impeller | Steel | 4K11 | | | | | | 4K555 | | 4K11 | | | | 4K555 | | 1 | | | |
| 422 | Stud, impeller | | 13K217 | | | | | | | | | | | | | | | | | |
| 199 | Washer, impeller | 316SS | 4L458 | | | | | | | | | | | | | | | | | |
| 108 | Motor adapter, 143-184JM and S-group brg. frame | CI ASTM A48 CL 20 | 1L554 | | 1L50 | | | | 1L99 | | 1L560 | | 1L52 | | 1L99 | | 1L562 | | 25 | |
| | Motor adapter, 213-256JM | | 1L555 | | 1L51 | | | | 1L98 | | 1L561 | | 1L53 | | 1L98 | | 1L563 | | 29 | |
| 370 | Bolt, casing | 300SS | 13L38 | | | | | | 13L89 | | 13L38 | | | | 13L89 | | | | - | |
| 371 or 370B | Bolt, adapter, 143-184JM and S-Group brg. frame | Steel SAE 1200 | 13K360 | | 13L43 | | | | 13K360 | | 13L43 | | | | 13K360 | | 25 | | | |
| | Bolt, adapter, 213-256JM | | 13K379 | | 13L41 | | | | 13K245 | | 13K361 | | 13L40 | | 13K245 | | 13K361 | | 29 | |
| 383 | Mech. seal - standard | Type 21 | 10K27 - Carbon/Silicon-Carbide/Viton | | | | | | | | | | | | | | | | | |
| | Mech. seal - high temp. | | 10K19 - Carbon/Silicon-Carbide/EPR | | | | | | | | | | | | | | | | | |
| | Mech. seal - severe duty | | 10K64 - Silicon-Carbide/Silicon-Carbide/Viton | | | | | | | | | | | | | | | | | |
| 383A | Retainer, seal spring | 316SS | 4K517 | | | | | | | | | | | | | | | | | |
| 408 | Plug, vent and drain | | 6L60 | | | | | | | | | | | | | | | | | |
| 412A | O-ring, impeller washer | Viton | 5K320 standard (5K195 EPR option) | | | | | | | | | | | | | | | | | |
| 412F | O-ring, shaft sleeve | | 5K307 standard (5K306 EPR option) | | | | | | | | | | | | | | | | | |
| 513 | O-ring, casing - standard | | 5K407 | | | | 5L70 | | 5K408 | | | | 5L70 | | 5L71 | | | | 1 | |
| | O-ring, casing - optional | EPR | 5K393 | | | | 5K317 | | 5K394 | | | | 5K317 | | 5L110 | | | | | |

e-SH M-GROUP (254JM-365TCZ)

| Item No. | Part Description | Material | 1½x2½ -10 | | 2x2½-10 | | 2½x3-8 | | 2½x3-10 | | 3x4-8 | | 3x4-10 | | Max. Wt. (lb) |
|-------------|--|-------------------|---|-------|---------------------------------|-----------------|---------------------------------|--------|---------------------------------|-------|---------------------------------|-----------------|---------------------------------|-------|---------------|
| | | | 15SH10 | | 02SH10 | | 25SH08 | | 25SH10 | | 03SH08 | | 03SH10 | | |
| 100 | Casing with wear ring | | 1L455 | | 1L458 | | 1L460 | | 1L461 | | 1L463 | | 1L464 | | 17 |
| 101 | Impeller | AISI Type 316SS | 9 ⁷ / ₈ | 2L778 | 9 ⁷ / ₈ | 2L790 | 9 ¹ / ₁₆ | 2L952 | 10 ³ / ₈ | 2L804 | 9 ¹ / ₁₆ | 2L825 | 10 ⁵ / ₈ | 2L836 | 8 |
| | | | 9½ | 2L779 | 9½ | 2L791 | 8¾ | 2L953 | 9 ¹⁵ / ₁₆ | 2L805 | 8 ¹¹ / ₁₆ | 2L826 | 10¼ | 2L837 | |
| | | | 9 ³ / ₁₆ | 2L780 | 9 ¹ / ₈ | 2L792 | 8½ | 2L954 | 9 ⁹ / ₁₆ | 2L806 | 8 ⁷ / ₁₆ | 2L827 | 9 ¹³ / ₁₆ | 2L838 | |
| | | | 8 ⁷ / ₈ | 2L781 | 8 ¹³ / ₁₆ | 2L793 | 8¼ | 2L955 | 9¼ | 2L807 | 8 ¹ / ₁₆ | 2L828 | 9 ⁷ / ₁₆ | 2L839 | |
| | | | 8 ⁹ / ₁₆ | 2L782 | 8 ³ / ₁₆ | 2L794 | 7 ⁷ / ₈ | 2L956 | 8¾ | 2L809 | 7 ¹¹ / ₁₆ | 2L829 | 9 ¹ / ₁₆ | 2L825 | |
| | | | 8¼ | 2L783 | 7 ¹⁵ / ₁₆ | 2L795 | 7½ | 2L957 | | | 7½ | 2L830 | 8 ¹¹ / ₁₆ | 2L826 | |
| | | | | | 7 ¹¹ / ₁₆ | 2L796 | 7 ¹ / ₈ | 2L958 | | | 7 ¹ / ₈ | 2L831 | | | |
| | | | | | | | 6 ¹¹ / ₁₆ | 2L959 | | | 6 ⁷ / ₈ | 2L832 | | | |
| | | | | | | | 6½ | 2L960 | | | 6½ | 2L833 | | | |
| | | | | | | | | | | | 6 | 2L834 | | | |
| | | | | | | | | 5½ | 2L835 | | | | | | |
| 103 | Wear ring, casing | | 4L467 | | | 4L468 | | | 4L469 | | | 1 | | | |
| 184 | Seal housing with ring | | 1L468 | | | 1L473 | | 1L475 | | | 1L478 | | 3 | | |
| 203 | Wear ring, seal housing | | 4L201 | | | 4L464 | | | | | | | | | |
| 126 | Shaft sleeve | 316SS | 4L457 | | | | | | | | | | | | 1 |
| 178 | Key, impeller | Steel | 4K261 | | | | | | | | | | | | |
| 422 | Stud, impeller | | 13K301 | | | | | | | | | | | | |
| 199 | Washer, impeller | 316SS | 4L463 | | | | | | | | | | | | |
| 108 | Motor adapter, 254-256JM and M-group bearing frame | CI ASTM A48 CL 20 | 1L91 | | | 1L89 | | | 1L93 | | | 1L94 | | | 31 |
| | Motor adapter, 280JM-365TCZ | | 1L90 | | | 1L88 | | | 1L92 | | | 1L95 | | | 44 |
| 370 | Bolt, casing | 300SS | 13L86 (6 req'd) | | | 13L89 (8 req'd) | | | 13L86 (8 req'd) | | | 13K45 (8 req'd) | | | - |
| 371 or 370B | Bolt, adapter, 254-256JM and S-Group bearing frame | Steel SAE 1200 | 13L88 | | | | | 13L116 | | | | | - | | |
| | Bolt, adapter, 280JM-365TCZ | | 13L87 | | | | | 13L115 | | | | | - | | |
| 383 | Mech. seal - standard | Type 21 | 10K45 - carbon/silicon-carbide/viton | | | | | | | | | | | | 1 |
| | Mech. seal - high temp. | | 10K20 - Carbon/silicon-carbide/EPR | | | | | | | | | | | | |
| | Mech. seal - severe duty | | 10K65 - Silicon-carbide/silicon-carbide/viton | | | | | | | | | | | | |
| 383A | Retainer, seal spring | 316SS | 4K500 | | | | | | | | | | | | 2 |
| 408 | Plug, vent and drain | | 6L60 | | | | | | | | | | | | |
| 412A | O-ring, impeller washer | Viton | 5K309 standard (5K308 EPR option) | | | | | | | | | | | | 1 |
| 412F | O-ring, shaft sleeve | | 5K309 standard (5K308 EPR option) | | | | | | | | | | | | |
| 513 | O-ring, casing - standard | | EPR | 5L71 | | | 5L70 | | | 5L71 | | | 5L72 | | |
| | O-ring, casing - optional | 5L110 | | | 5K317 | | | 5L110 | | | 5L116 | | | | |

e-SH M-GROUP (140JM, 180JM & 210JM)

| Item No. | Part Description | Material | 1½x2½-10 | | 2x2½-10 | | 2½x3-8 | | 2½x3-10 | | 3x4-8 | | Max. Wt. (lb) |
|-------------|--|-------------------|-----------------------------------|-------|---------------------------------|-----------------|---------------------------------|-----------------|---------------------------------|-------|---------------------------------|-------|---------------|
| | | | 15SH10 | | 02SH10 | | 25SH08 | | 25SH10 | | 03SH08 | | |
| 100 | Casing with wear ring | AISI Type 316SS | 1L455 | | 1L458 | | 1L460 | | 1L461 | | 1L463 | | 17 |
| 101 | Impeller | | 9 ⁷ / ₈ | 2L784 | 9 ⁷ / ₈ | 2L797 | 9 ¹ / ₁₆ | 2L991 | 9 ¹⁵ / ₁₆ | 2L817 | 9 ¹ / ₁₆ | 2L840 | 8 |
| | | | 9 ¹ / ₂ | 2L785 | 9 ¹ / ₂ | 2L798 | 8 ¹ / ₂ | 2L992 | 9 ⁹ / ₁₆ | 2L818 | 8 ⁷ / ₁₆ | 2L841 | |
| | | | 9 ³ / ₁₆ | 2L786 | 9 ¹ / ₈ | 2L799 | 8 ¹ / ₄ | 2L993 | 9 ¹ / ₄ | 2L819 | 8 ¹ / ₁₆ | 2L842 | |
| | | | 8 ⁷ / ₈ | 2L787 | 8 ¹³ / ₁₆ | 2L800 | 7 ⁷ / ₈ | 2L994 | 8 ³ / ₄ | 2L821 | 7 ¹¹ / ₁₆ | 2L843 | |
| | | | 8 ⁹ / ₁₆ | 2L788 | 8 ³ / ₁₆ | 2L801 | 7 ¹ / ₈ | 2L995 | | | 7 ¹ / ₈ | 2L844 | |
| | | | 8 ¹ / ₄ | 2L789 | 7 ¹⁵ / ₁₆ | 2L802 | 6 ¹¹ / ₁₆ | 2L996 | | | 6 ¹ / ₂ | 2L845 | |
| | | | | | 7 ¹¹ / ₁₆ | 2L803 | | | | | 6 | 2L846 | |
| 103 | Wear ring, casing | | | 4L467 | | | 4L468 | | | 4L469 | | | 1 |
| 184 | Seal housing with ring | | | 1L468 | | | 1L473 | | 1L474 | | | | 3 |
| 203 | Wear ring, seal housing | | 4L201 | | | 4L464 | | | | | | 1 | |
| 126 | Shaft sleeve | 316SS | 4K501 | | | 4L456 | | | | | | | |
| 178 | Key, impeller | Steel | 4K11 | | | | | | | | | | |
| 422 | Stud, impeller | | 13K217 | | | | | | | | | 1 | |
| 199 | Washer, impeller | 316SS | 4L458 | | | | | | | | | | |
| 108 | Motor adapter, 143-184JM and S-group bearing frame | CI ASTM A48 CL 20 | 1L97 | | | 1L99 | | 1L123 | | | | 25 | |
| | Motor adapter, 213 | | 1L96 | | | 1L98 | | 1L100 | | | | 29 | |
| 370 | Bolt, casing | 300SS | 13L86 (6 req'd) | | | 13L89 (8 req'd) | | 13L86 (8 req'd) | | | | - | |
| 371 or 370B | Bolt, adapter, 143-184JM and S-Group bearing frame | Steel SAE 1200 | 13L43 | | | | | N/A | 13L117 | | | | - |
| | Bolt, adapter, 213-256JM | | 13K245 | | | | | | 13K44 | | | | - |
| 383 | Mech. seal - standard | Type 21 | 10K27 | | | | | | | | | 1 | |
| | Mech. seal - high temp. | | 10K19 | | | | | | | | | | |
| | Mech. seal - severe duty | | 10K64 | | | | | | | | | | |
| 383A | Retainer, seal spring | 316SS | 4K517 | | | | | | | | | 2 | |
| 408 | Plug, vent and drain | | 6L60 | | | | | | | | | | |
| 412A | O-ring, impeller washer | Viton | 5K320 standard (5K195 EPR option) | | | | | | | | | 1 | |
| 412F | O-ring, shaft sleeve | | 5K320 standard (5K195 EPR) | | | | 5K307 (5K306 EPR option) | | | | | | |
| 513 | O-ring, casing - standard | | 5L71 | | | 5L70 | | 5L71 | | | | | |
| | O-ring, casing - optional | EPR | 5L110 | | | 5K317 | | 5L110 | | | | | |



Xylem Inc.
 Phone: (866) 673-0428
 Fax: (888) 322-5877
www.xylem.com/goulds

Goulds is a registered trademark of Goulds Pumps, Inc. and is used under license.
 © 2021 Xylem Inc. ReSHSMGR R2 February 2021



Questions? Call 1-800-810-1053