

## ELECTRONIC PRICING CATALOG NAVIGATION INSTRUCTIONS



**Questions? Call 1-800-810-1053**

### Select by Pump Model:

If you know what pump you are looking for, you can use the 'Bookmarks' tab on the left and select the pump model which you are trying to access. Clicking in the Bookmark will take you to the page you are looking for.

If there are no tabs on the left (bookmarks, signatures, layers, pages), you can use the top menu to make them appear. Goto VIEW > SHOW/HIDE > NAVIGATION PANES > BOOKMARKS and they will appear.

**Sample Pump ID Tag:** See the illustration below for help identifying the location of the Model number and Serial number on the pump ID tag.

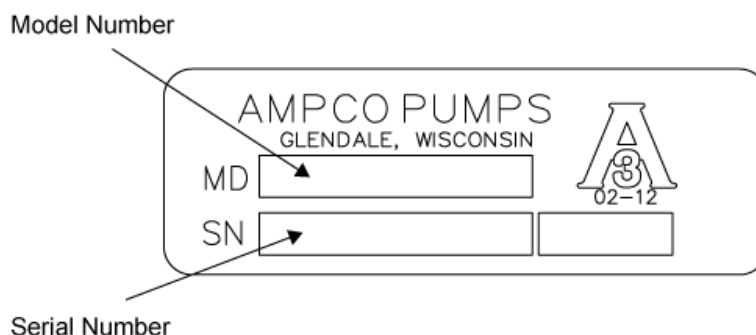

*Please reference your serial number when ordering replacement parts.*

### Select by Part Number:

If you know an exact part number you are looking for, simply hit CONTROL+F and that will bring up the find feature. You may also use the menu, goto EDIT > FIND to bring up the same feature.

Type in your part number and it will show you all instances of that item in the catalog. If you only know some of the part number (i.e. SP328), that will also help and show all occurrences of those numbers together.

Be advised that partials of part number can return a large amount of results.

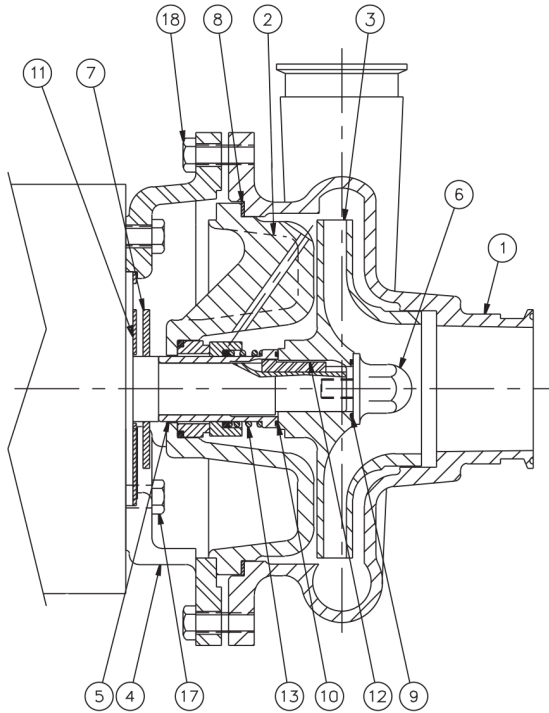

Ref #	Component
1	Casing
2	Cover
3	Impeller
4	Adapter
5	Shaft Sleeve
6	Impeller Screw
7	Slinger
8	Gasket, Casing
9	O-Ring, Impeller Screw
10	O-Ring, Shaft Sleeve (Sleeve/Impeller)
11	Splashplate
12	Key, Impeller
13	Seal Kit
17	Capscrew (Motor/Adapter)
18	Capscrew (Casing/Adapter)
20*	O-Ring, Shaft Sleeve (Shaft/Sleeve)

\* Not Shown in Drawing

**Exploded View**

*Optional Items Shown in ITALICS*

Ref #	Component Item No.	Description	Qty Per
1	SV8401751	CASING,2-1/2X2,SS DC2	1
2	SC8302471	COVER,2-1/2X2,SS DC2	1
3	SI8302491	IMPELLER,2-1/2X2,SS DC2	1
4	GX8400951	ADAPTER,100 JM FRAME ZC2	1
	<i>SX8400952</i>	<i>ADAPTER,100 JM FRAME,SS ZC2</i>	<i>1</i>
5	SX8103721	SLEEVE,SHFT,SS ZC2	1
6	SI8107270	SCREW,IMP,SS DC2 EC2 KC2 MC3 ZC2	1
7	GX5042301	SLINGER,1-7/32X3-1/4X5/32 80 DUR (180JM-210JM)	1
	<i>GX5042301</i>	<i>SLINGER,1-7/32X3-1/4X5/32 80 DUR (180JM-210JM)</i>	<i>1</i>
8	GX5040600	GASKET,6-5/8X7-11/64X1/16,NEO	1
9	GX5038500	O-RING,,989X1.29X.070,BUNA 70 DUR, IMP SCRW	1
10	GX5098300	O-RING,T21,1-1/4,BUNA,SLV	1
11	GX5091600	SPLASHPLATE,EC2/KC2/RC2/ZC2,SS FR143-184	1
12	GX5051300	KEY,IMP,,187SQX1.5 EC KC RC ZC	1
13	GS8106850	KIT,1-1/4,252,T21,CE/CA/BU DC2	1
17	GX5077100	CAPSCRW,HX,3/8-16X1,18-8SS HX HD	4
18	GX5077100	CAPSCRW,HX,3/8-16X1,18-8SS HX HD	8

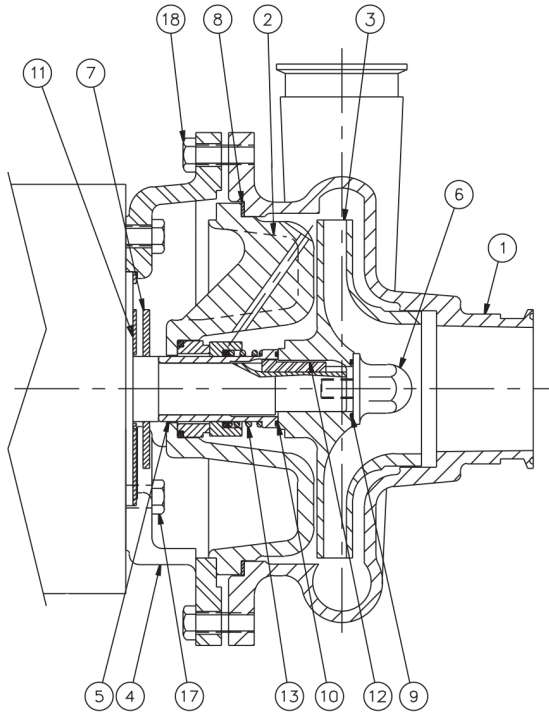

Ref #	Component
1	Casing
2	Cover
3	Impeller
4	Adapter
5	Shaft Sleeve
6	Impeller Screw
7	Slinger
8	Gasket, Casing
9	O-Ring, Impeller Screw
10	O-Ring, Shaft Sleeve (Sleeve/Impeller)
11	Splashplate
12	Key, Impeller
13	Seal Kit
17	Capscrew (Motor/Adapter)
18	Capscrew (Casing/Adapter)
20*	O-Ring, Shaft Sleeve (Shaft/Sleeve)

\* Not Shown in Drawing

**Exploded View**

*Optional Items Shown in ITALICS*

Ref #	Component Item No.	Description	Qty Per
1	SV8401751	CASING,2-1/2X2,SS DC2	1
2	SC8302471	COVER,2-1/2X2,SS DC2	1
3	SI8302491	IMPELLER,2-1/2X2,SS DC2	1
4	GX8301391	ADAPTER,210 JM FRAME ZC2	1
	<i>SX8301392</i>	<i>ADAPTER,210 JM FRAME,SS ZC2</i>	<i>1</i>
5	SX8103721	SLEEVE,SHFT,SS ZC2	1
6	SI8107270	SCREW,IMP,SS DC2 EC2 KC2 MC3 ZC2	1
7	GX5042301	SLINGER,1-7/32X3-1/4X5/32 80 DUR (180JM-210JM)	1
	<i>GX5042301</i>	<i>SLINGER,1-7/32X3-1/4X5/32 80 DUR (180JM-210JM)</i>	<i>1</i>
8	GX5040600	GASKET,6-5/8X7-11/64X1/16,NEO	1
9	GX5038500	O-RING,,989X1.29X.070,BUNA 70 DUR, IMP SCRW	1
10	GX5098300	O-RING,T21,1-1/4,BUNA,SLV	1
11	GX5091400	SPLASHPLATE,EC2 KC2 RC2 ZC2,SS FR213-256	1
12	GX5051300	KEY,IMP,,187SQX1.5 EC KC RC ZC	1
13	GS8106850	KIT,1-1/4,252,T21,CE/CA/BU DC2	1
17	GX5077400	CAPSCRW,SH,1/2-13X1-3/4,BLK OX SCKT HD	4
18	GX5077100	CAPSCRW,HX,3/8-16X1,18-8SS HX HD	4
	GX5077200	CAPSCRW,HX,3/8-16X1-1/4,18-8SS HX HD	4

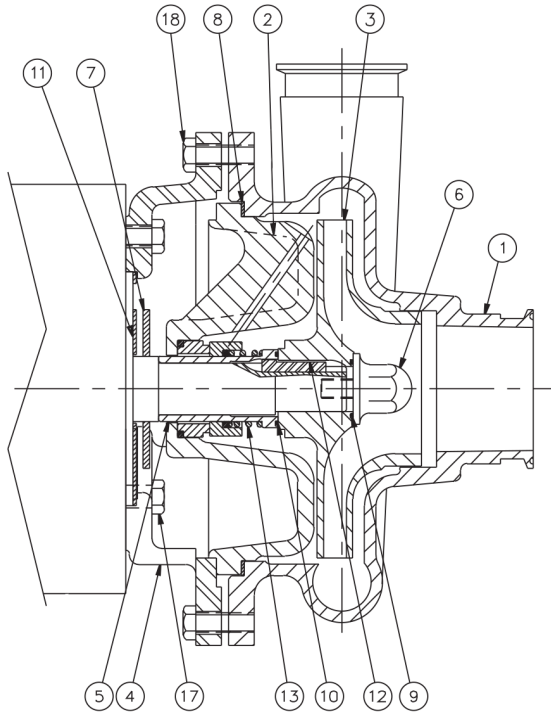

Ref #	Component
1	Casing
2	Cover
3	Impeller
4	Adapter
5	Shaft Sleeve
6	Impeller Screw
7	Slinger
8	Gasket, Casing
9	O-Ring, Impeller Screw
10	O-Ring, Shaft Sleeve (Sleeve/Impeller)
11	Splashplate
12	Key, Impeller
13	Seal Kit
17	Capscrew (Motor/Adapter)
18	Capscrew (Casing/Adapter)
20*	O-Ring, Shaft Sleeve (Shaft/Sleeve)

\* Not Shown in Drawing

**Exploded View**

*Optional Items Shown in ITALICS*

Ref #	Component Item No.	Description	Qty Per
1	SV8401771	CASING,3X2-1/2,SS DC2	1
2	SC8302511	COVER,3X2-1/2,SS DC2	1
3	SI8302601	IMPELLER,3X2-1/2,SS DC2	1
4	GX8400951	ADAPTER,100 JM FRAME ZC2	1
	<i>SX8400952</i>	<i>ADAPTER,100 JM FRAME,SS ZC2</i>	<i>1</i>
5	SX8103721	SLEEVE,SHFT,SS ZC2	1
6	SI8107270	SCREW,IMP,SS DC2 EC2 KC2 MC3 ZC2	1
7	GX5042301	SLINGER,1-7/32X3-1/4X5/32 80 DUR (180JM-210JM)	1
	<i>GX5042301</i>	<i>SLINGER,1-7/32X3-1/4X5/32 80 DUR (180JM-210JM)</i>	<i>1</i>
8	GX5040800	GASKET,7-47/64X7-1/8X1/16,NEO	1
9	GX5038500	O-RING,,989X1.29X.070,BUNA 70 DUR, IMP SCRW	1
10	GX5098300	O-RING,T21,1-1/4,BUNA,SLV	1
11	GX5091600	SPLASHPLATE,EC2/KC2/RC2/ZC2,SS FR143-184	1
12	GX5051300	KEY,IMP,,187SQX1.5 EC KC RC ZC	1
13	GS8106880	KIT,1-1/4,325,T21,CE/CA/BU DC2	1
17	GX5077100	CAPSCRW,HX,3/8-16X1,18-8SS HX HD	4
18	GX5077100	CAPSCRW,HX,3/8-16X1,18-8SS HX HD	8

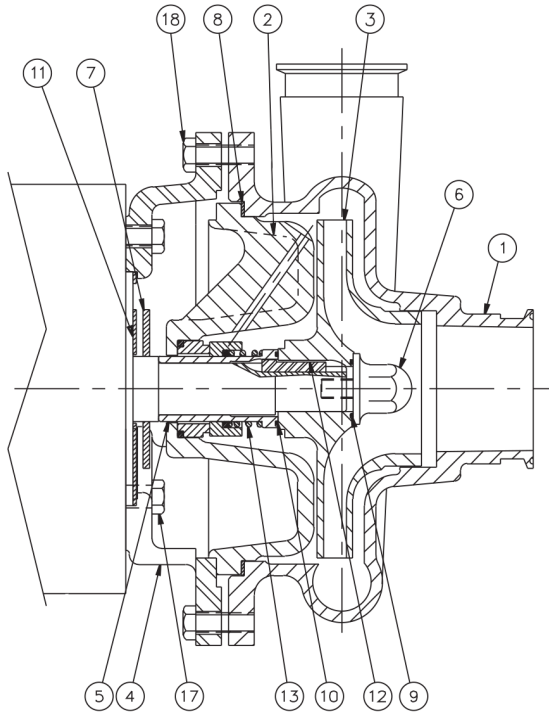

Ref #	Component
1	Casing
2	Cover
3	Impeller
4	Adapter
5	Shaft Sleeve
6	Impeller Screw
7	Slinger
8	Gasket, Casing
9	O-Ring, Impeller Screw
10	O-Ring, Shaft Sleeve (Sleeve/Impeller)
11	Splashplate
12	Key, Impeller
13	Seal Kit
17	Capscrew (Motor/Adapter)
18	Capscrew (Casing/Adapter)
20*	O-Ring, Shaft Sleeve (Shaft/Sleeve)

\* Not Shown in Drawing

**Exploded View**

*Optional Items Shown in ITALICS*

Ref #	Component Item No.	Description	Qty Per
1	SV8401771	CASING,3X2-1/2,SS DC2	1
2	SC8302511	COVER,3X2-1/2,SS DC2	1
3	SI8302601	IMPELLER,3X2-1/2,SS DC2	1
4	GX8301391	ADAPTER,210 JM FRAME ZC2	1
	<i>SX8301392</i>	<i>ADAPTER,210 JM FRAME,SS ZC2</i>	<i>1</i>
5	SX8103721	SLEEVE,SHFT,SS ZC2	1
6	SI8107270	SCREW,IMP,SS DC2 EC2 KC2 MC3 ZC2	1
7	GX5042301	SLINGER,1-7/32X3-1/4X5/32 80 DUR (180JM-210JM)	1
	<i>GX5042301</i>	<i>SLINGER,1-7/32X3-1/4X5/32 80 DUR (180JM-210JM)</i>	<i>1</i>
8	GX5040800	GASKET,7-47/64X7-1/8X1/16,NEO	1
9	GX5038500	O-RING,,989X1.29X.070,BUNA 70 DUR, IMP SCRW	1
10	GX5098300	O-RING,T21,1-1/4,BUNA,SLV	1
11	GX5091400	SPLASHPLATE,EC2 KC2 RC2 ZC2,SS FR213-256	1
12	GX5051300	KEY,IMP, .187SQX1.5 EC KC RC ZC	1
13	GS8106880	KIT,1-1/4,325,T21,CE/CA/BU DC2	1
17	GX5077400	CAPSCRW,SH,1/2-13X1-3/4,BLK OX SCKT HD	4
18	GX5077100	CAPSCRW,HX,3/8-16X1,18-8SS HX HD	4
	GX5077200	CAPSCRW,HX,3/8-16X1-1/4,18-8SS HX HD	4

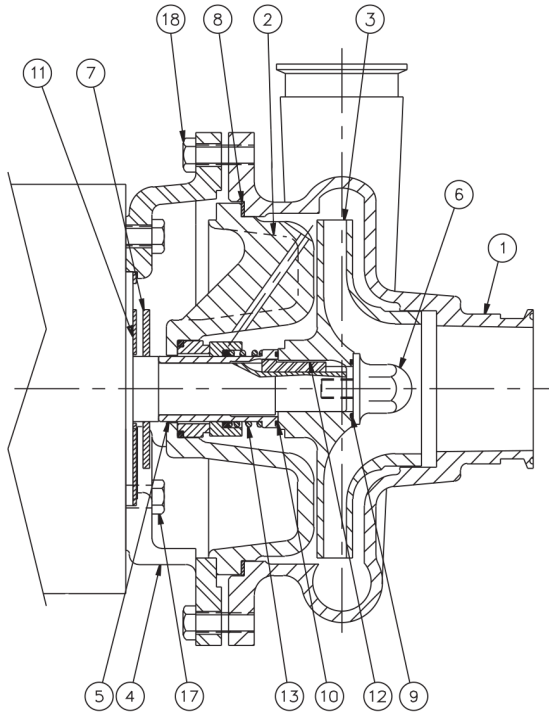

Ref #	Component
1	Casing
2	Cover
3	Impeller
4	Adapter
5	Shaft Sleeve
6	Impeller Screw
7	Slinger
8	Gasket, Casing
9	O-Ring, Impeller Screw
10	O-Ring, Shaft Sleeve (Sleeve/Impeller)
11	Splashplate
12	Key, Impeller
13	Seal Kit
17	Capscrew (Motor/Adapter)
18	Capscrew (Casing/Adapter)
20*	O-Ring, Shaft Sleeve (Shaft/Sleeve)

\* Not Shown in Drawing

**Exploded View**

*Optional Items Shown in ITALICS*

Ref #	Component Item No.	Description	Qty Per
1	SV8401811	CASING,4X3,SS DC2	1
2	SC8302621	COVER,4X3,SS DC2	1
3	SI8302651	IMPELLER,4X3,SS DC2	1
4	GX8400951	ADAPTER,100 JM FRAME ZC2	1
	<i>SX8400952</i>	<i>ADAPTER,100 JM FRAME,SS ZC2</i>	<i>1</i>
5	SX8103721	SLEEVE,SHFT,SS ZC2	1
6	SI8107270	SCREW,IMP,SS DC2 EC2 KC2 MC3 ZC2	1
7	GX5042301	SLINGER,1-7/32X3-1/4X5/32 80 DUR (180JM-210JM)	1
	<i>GX5042301</i>	<i>SLINGER,1-7/32X3-1/4X5/32 80 DUR (180JM-210JM)</i>	<i>1</i>
8	GX5040200	GASKET,7-39/64X7-1/8X1/16,BUNA	1
9	GX5038500	O-RING,,989X1.29X.070,BUNA 70 DUR, IMP SCRW	1
10	GX5098300	O-RING,T21,1-1/4,BUNA,SLV	1
11	GX5091600	SPLASHPLATE,EC2/KC2/RC2/ZC2,SS FR143-184	1
12	GX5051300	KEY,IMP,,187SQX1.5 EC KC RC ZC	1
13	GS8107080	KIT,1-1/4,43,T21,CE/CA/BU DC2	1
17	GX5077100	CAPSCRW,HX,3/8-16X1,18-8SS HX HD	4
18	GX5077100	CAPSCRW,HX,3/8-16X1,18-8SS HX HD	8

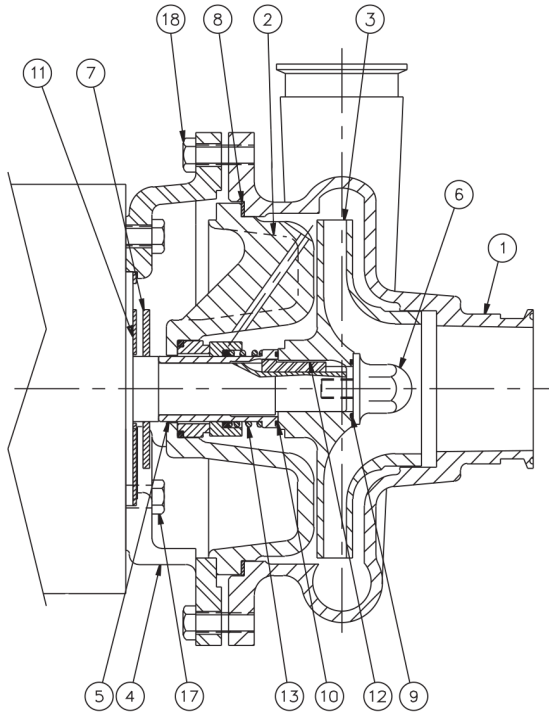

Ref #	Component
1	Casing
2	Cover
3	Impeller
4	Adapter
5	Shaft Sleeve
6	Impeller Screw
7	Slinger
8	Gasket, Casing
9	O-Ring, Impeller Screw
10	O-Ring, Shaft Sleeve (Sleeve/Impeller)
11	Splashplate
12	Key, Impeller
13	Seal Kit
17	Capscrew (Motor/Adapter)
18	Capscrew (Casing/Adapter)
20*	O-Ring, Shaft Sleeve (Shaft/Sleeve)

\* Not Shown in Drawing

**Exploded View**

*Optional Items Shown in ITALICS*

Ref #	Component Item No.	Description	Qty Per
1	SV8401811	CASING,4X3,SS DC2	1
2	SC8302621	COVER,4X3,SS DC2	1
3	SI8302651	IMPELLER,4X3,SS DC2	1
4	GX8301391	ADAPTER,210 JM FRAME ZC2	1
	<i>SX8301392</i>	<i>ADAPTER,210 JM FRAME,SS ZC2</i>	<i>1</i>
5	SX8103721	SLEEVE,SHFT,SS ZC2	1
6	SI8107270	SCREW,IMP,SS DC2 EC2 KC2 MC3 ZC2	1
7	GX5042301	SLINGER,1-7/32X3-1/4X5/32 80 DUR (180JM-210JM)	1
	<i>GX5042301</i>	<i>SLINGER,1-7/32X3-1/4X5/32 80 DUR (180JM-210JM)</i>	<i>1</i>
8	GX5040200	GASKET,7-39/64X7-1/8X1/16,BUNA	1
9	GX5038500	O-RING,,989X1.29X.070,BUNA 70 DUR, IMP SCRW	1
10	GX5098300	O-RING,T21,1-1/4,BUNA,SLV	1
11	GX5091400	SPLASHPLATE,EC2 KC2 RC2 ZC2,SS FR213-256	1
12	GX5051300	KEY,IMP,,187SQX1.5 EC KC RC ZC	1
13	GS8107080	KIT,1-1/4,43,T21,CE/CA/BU DC2	1
17	GX5077400	CAPSCRW,SH,1/2-13X1-3/4,BLK OX SCKT HD	4
18	GX5077100	CAPSCRW,HX,3/8-16X1,18-8SS HX HD	4
	GX5077200	CAPSCRW,HX,3/8-16X1-1/4,18-8SS HX HD	4

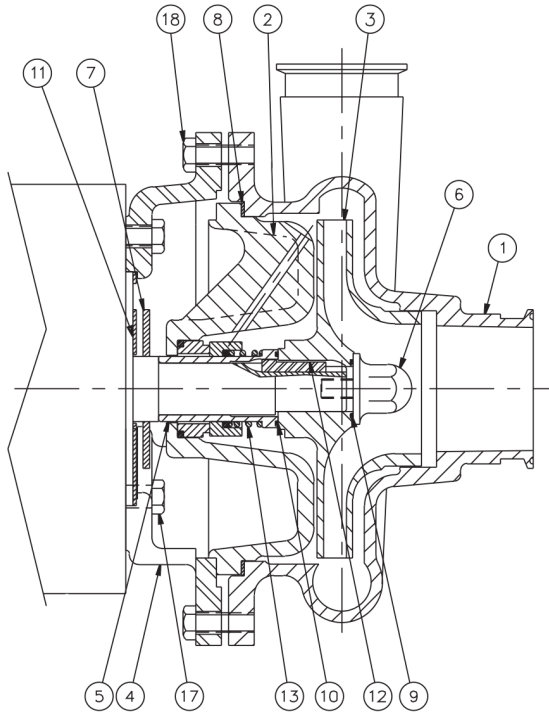

Ref #	Component
1	Casing
2	Cover
3	Impeller
4	Adapter
5	Shaft Sleeve
6	Impeller Screw
7	Slinger
8	Gasket, Casing
9	O-Ring, Impeller Screw
10	O-Ring, Shaft Sleeve (Sleeve/Impeller)
11	Splashplate
12	Key, Impeller
13	Seal Kit
17	Capscrew (Motor/Adapter)
18	Capscrew (Casing/Adapter)
20*	O-Ring, Shaft Sleeve (Shaft/Sleeve)

\* Not Shown in Drawing

**Exploded View**

*Optional Items Shown in ITALICS*

Ref #	Component Item No.	Description	Qty Per
1	SV8401751	CASING,2-1/2X2,SS DC2	1
2	SC8302471	COVER,2-1/2X2,SS DC2	1
3	SI8302491	IMPELLER,2-1/2X2,SS DC2	1
4	GX8400951	ADAPTER,100 JM FRAME ZC2	1
	<i>SX8400952</i>	<i>ADAPTER,100 JM FRAME,SS ZC2</i>	<i>1</i>
5	SX8103721	SLEEVE,SHFT,SS ZC2	1
6	SI8107270	SCREW,IMP,SS DC2 EC2 KC2 MC3 ZC2	1
7	GX5042301	SLINGER,1-7/32X3-1/4X5/32 80 DUR (180JM-210JM)	1
	<i>GX5042301</i>	<i>SLINGER,1-7/32X3-1/4X5/32 80 DUR (180JM-210JM)</i>	<i>1</i>
8	GX5040601	GASKET,6-5/8X7-11/64,VIT	1
9	GX5038501	O-RING,43/252/325,VIT,FDA CMPL DC3 ZC2	1
10	GX5098302	O-RING,43/252/325,VIT DC3	1
11	GX5091600	SPLASHPLATE,EC2 KC2 RC2 ZC2,SS FR143-184	1
12	GX5051300	KEY,IMP,.187SQX1.5 EC KC RC ZC	1
13	GS8109550	KIT,1-1/4,252,ROPLAN,SC/CA/VI DC3	1
17	GX5077100	CAPSCRW,HX,3/8-16X1,18-8SS HX HD	4
18	GX5077100	CAPSCRW,HX,3/8-16X1,18-8SS HX HD	8

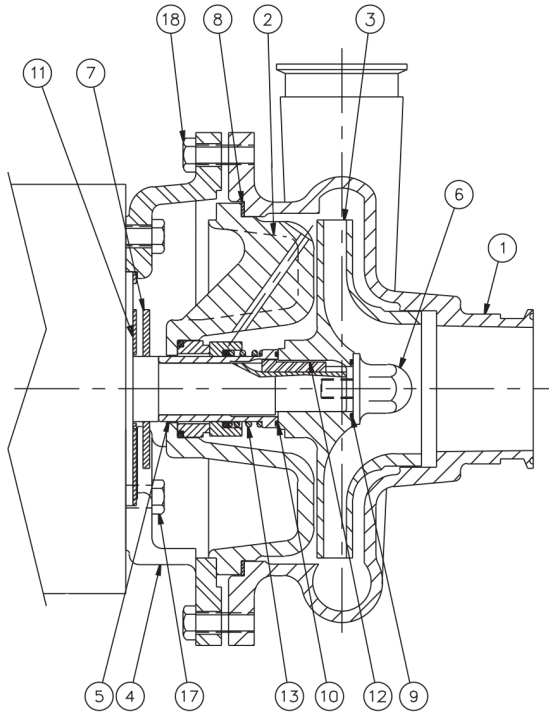

Ref #	Component
1	Casing
2	Cover
3	Impeller
4	Adapter
5	Shaft Sleeve
6	Impeller Screw
7	Slinger
8	Gasket, Casing
9	O-Ring, Impeller Screw
10	O-Ring, Shaft Sleeve (Sleeve/Impeller)
11	Splashplate
12	Key, Impeller
13	Seal Kit
17	Capscrew (Motor/Adapter)
18	Capscrew (Casing/Adapter)
20*	O-Ring, Shaft Sleeve (Shaft/Sleeve)

\* Not Shown in Drawing

**Exploded View**

*Optional Items Shown in ITALICS*

Ref #	Component Item No.	Description	Qty Per
1	SV8401751	CASING,2-1/2X2,SS DC2	1
2	SC8302471	COVER,2-1/2X2,SS DC2	1
3	SI8302491	IMPELLER,2-1/2X2,SS DC2	1
4	GX8301391	ADAPTER,210 JM FRAME ZC2	1
	<i>SX8301392</i>	<i>ADAPTER,210 JM FRAME,SS ZC2</i>	<i>1</i>
5	SX8103721	SLEEVE,SHFT,SS ZC2	1
6	SI8107270	SCREW,IMP,SS DC2 EC2 KC2 MC3 ZC2	1
7	GX5042301	SLINGER,1-7/32X3-1/4X5/32 80 DUR (180JM-210JM)	1
	<i>GX5042301</i>	<i>SLINGER,1-7/32X3-1/4X5/32 80 DUR (180JM-210JM)</i>	<i>1</i>
8	GX5040601	GASKET,6-5/8X7-11/64,VIT	1
9	GX5038501	O-RING,43/252/325,VIT,FDA CMPL DC3 ZC2	1
10	GX5098302	O-RING,43/252/325,VIT DC3	1
11	GX5091400	SPLASHPLATE,EC2 KC2 RC2 ZC2,SS FR213-256	1
12	GX5051300	KEY,IMP,.187SQX1.5 EC KC RC ZC	1
13	GS8109550	KIT,1-1/4,252,ROPLAN,SC/CA/VI DC3	1
17	GX5077400	CAPSCRW,SH,1/2-13X1-3/4,BLK OX SCKT HD	4
18	GX5077100	CAPSCRW,HX,3/8-16X1,18-8SS HX HD	4
	GX5077200	CAPSCRW,HX,3/8-16X1-1/4,18-8SS HX HD	4

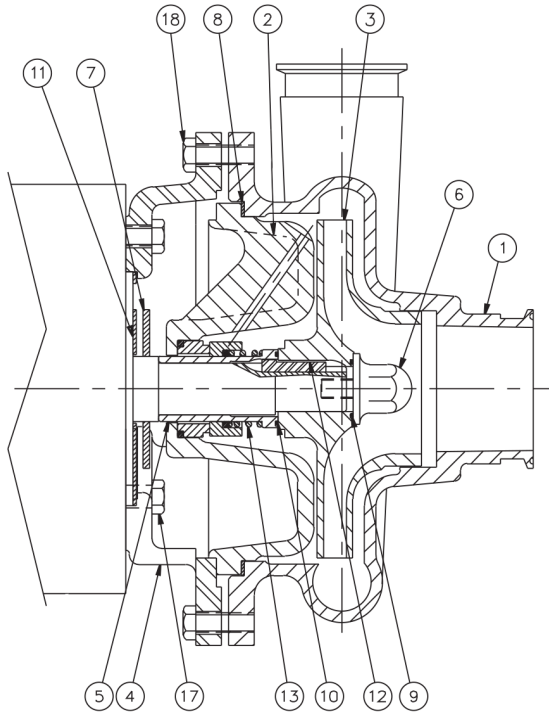

Ref #	Component
1	Casing
2	Cover
3	Impeller
4	Adapter
5	Shaft Sleeve
6	Impeller Screw
7	Slinger
8	Gasket, Casing
9	O-Ring, Impeller Screw
10	O-Ring, Shaft Sleeve (Sleeve/Impeller)
11	Splashplate
12	Key, Impeller
13	Seal Kit
17	Capscrew (Motor/Adapter)
18	Capscrew (Casing/Adapter)
20*	O-Ring, Shaft Sleeve (Shaft/Sleeve)

\* Not Shown in Drawing

**Exploded View**

*Optional Items Shown in ITALICS*

Ref #	Component Item No.	Description	Qty Per
1	SV8401771	CASING,3X2-1/2,SS DC2	1
2	SC8302511	COVER,3X2-1/2,SS DC2	1
3	SI8302601	IMPELLER,3X2-1/2,SS DC2	1
4	GX8400951	ADAPTER,100 JM FRAME ZC2	1
	<i>SX8400952</i>	<i>ADAPTER,100 JM FRAME,SS ZC2</i>	<i>1</i>
5	SX8103721	SLEEVE,SHFT,SS ZC2	1
6	SI8107270	SCREW,IMP,SS DC2 EC2 KC2 MC3 ZC2	1
7	GX5042301	SLINGER,1-7/32X3-1/4X5/32 80 DUR (180JM-210JM)	1
	<i>GX5042301</i>	<i>SLINGER,1-7/32X3-1/4X5/32 80 DUR (180JM-210JM)</i>	<i>1</i>
8	GX5040801	GASKET,CASNG,VIT ,7-47/67-1/8X1/16)!!90 DUR!!	1
9	GX5038501	O-RING,43/252/325,VIT,FDA CMPL DC3 ZC2	1
10	GX5098302	O-RING,43/252/325,VIT DC3	1
11	GX5091600	SPLASHPLATE,EC2 KC2 RC2 ZC2,SS FR143-184	1
12	GX5051300	KEY,IMP, .187SQX1.5 EC KC RC ZC	1
13	GS8109560	KIT,1-1/4,325,ROPLAN,SC/CA/VI DC3	1
17	GX5077100	CAPSCRW,HX,3/8-16X1,18-8SS HX HD	4
18	GX5077100	CAPSCRW,HX,3/8-16X1,18-8SS HX HD	8

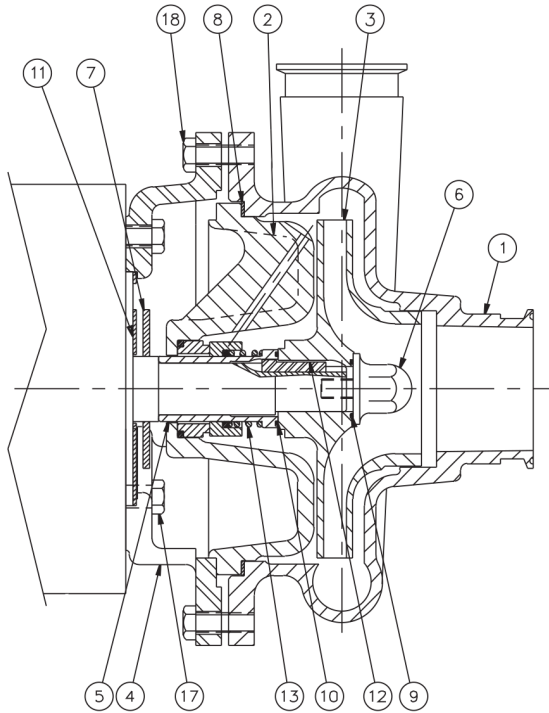

Ref #	Component
1	Casing
2	Cover
3	Impeller
4	Adapter
5	Shaft Sleeve
6	Impeller Screw
7	Slinger
8	Gasket, Casing
9	O-Ring, Impeller Screw
10	O-Ring, Shaft Sleeve (Sleeve/Impeller)
11	Splashplate
12	Key, Impeller
13	Seal Kit
17	Capscrew (Motor/Adapter)
18	Capscrew (Casing/Adapter)
20*	O-Ring, Shaft Sleeve (Shaft/Sleeve)

\* Not Shown in Drawing

**Exploded View**

*Optional Items Shown in ITALICS*

Ref #	Component Item No.	Description	Qty Per
1	SV8401771	CASING,3X2-1/2,SS DC2	1
2	SC8302511	COVER,3X2-1/2,SS DC2	1
3	SI8302601	IMPELLER,3X2-1/2,SS DC2	1
4	GX8301391	ADAPTER,210 JM FRAME ZC2	1
	<i>SX8301392</i>	<i>ADAPTER,210 JM FRAME,SS ZC2</i>	<i>1</i>
5	SX8103721	SLEEVE,SHFT,SS ZC2	1
6	SI8107270	SCREW,IMP,SS DC2 EC2 KC2 MC3 ZC2	1
7	GX5042301	SLINGER,1-7/32X3-1/4X5/32 80 DUR (180JM-210JM)	1
	<i>GX5042301</i>	<i>SLINGER,1-7/32X3-1/4X5/32 80 DUR (180JM-210JM)</i>	<i>1</i>
8	GX5040801	GASKET,CASNG,VIT ,7-47/67-1/8X1/16)!!90 DUR!!	1
9	GX5038501	O-RING,43/252/325,VIT,FDA CMPL DC3 ZC2	1
10	GX5098302	O-RING,43/252/325,VIT DC3	1
11	GX5091400	SPLASHPLATE,EC2 KC2 RC2 ZC2,SS FR213-256	1
12	GX5051300	KEY,IMP, .187SQX1.5 EC KC RC ZC	1
13	GS8109560	KIT,1-1/4,325,ROPLAN,SC/CA/VI DC3	1
17	GX5077400	CAPSCRW,SH,1/2-13X1-3/4,BLK OX SCKT HD	4
18	GX5077100	CAPSCRW,HX,3/8-16X1,18-8SS HX HD	4
	GX5077200	CAPSCRW,HX,3/8-16X1-1/4,18-8SS HX HD	4

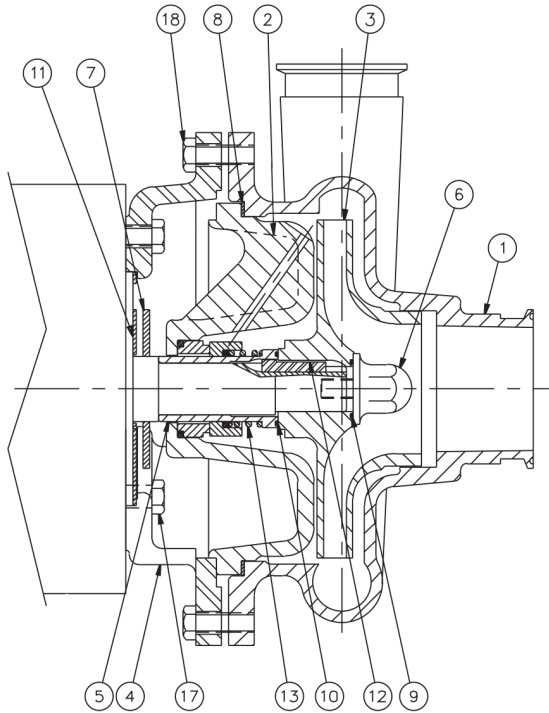

Ref #	Component
1	Casing
2	Cover
3	Impeller
4	Adapter
5	Shaft Sleeve
6	Impeller Screw
7	Slinger
8	Gasket, Casing
9	O-Ring, Impeller Screw
10	O-Ring, Shaft Sleeve (Sleeve/Impeller)
11	Splashplate
12	Key, Impeller
13	Seal Kit
17	Capscrew (Motor/Adapter)
18	Capscrew (Casing/Adapter)
20*	O-Ring, Shaft Sleeve (Shaft/Sleeve)

\* Not Shown in Drawing

**Exploded View**

*Optional Items Shown in ITALICS*

Ref #	Component Item No.	Description	Qty Per
1	SV8401811	CASING,4X3,SS DC2	1
2	SC8302621	COVER,4X3,SS DC2	1
3	SI8302651	IMPELLER,4X3,SS DC2	1
4	GX8400951	ADAPTER,100 JM FRAME ZC2	1
	<i>SX8400952</i>	<i>ADAPTER,100 JM FRAME,SS ZC2</i>	<i>1</i>
5	SX8103721	SLEEVE,SHFT,SS ZC2	1
6	SI8107270	SCREW,IMP,SS DC2 EC2 KC2 MC3 ZC2	1
7	GX5042301	SLINGER,1-7/32X3-1/4X5/32 80 DUR (180JM-210JM)	1
	<i>GX5042301</i>	<i>SLINGER,1-7/32X3-1/4X5/32 80 DUR (180JM-210JM)</i>	<i>1</i>
8	GX5040201	GASKET,7-39/64X7-1/8X1/16,VIT	1
9	GX5038501	O-RING,43/252/325,VIT,FDA CMPL DC3 ZC2	1
10	GX5098302	O-RING,43/252/325,VIT DC3	1
11	GX5091600	SPLASHPLATE,EC2 KC2 RC2 ZC2,SS FR143-184	1
12	GX5051300	KEY,IMP, .187SQX1.5 EC KC RC ZC	1
13	GS8109570	KIT,1-1/4,43,ROPLAN,SC/CA/VI DC3	1
17	GX5077100	CAPSCRW,HX,3/8-16X1,18-8SS HX HD	4
18	GX5077100	CAPSCRW,HX,3/8-16X1,18-8SS HX HD	8

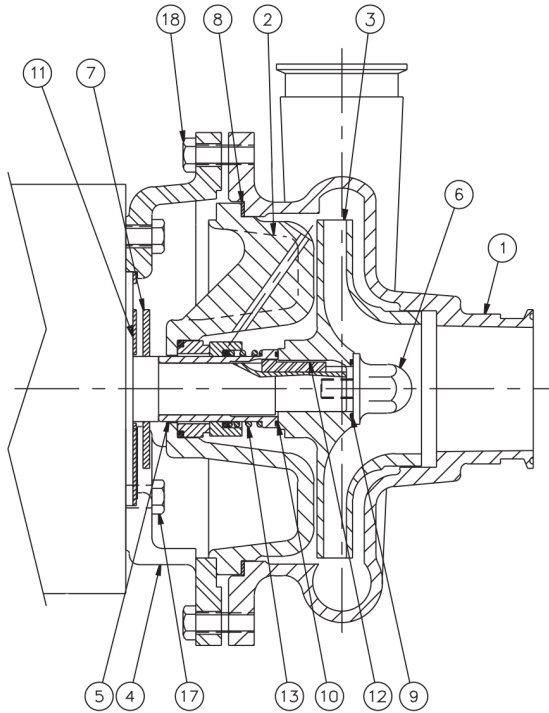

Ref #	Component
1	Casing
2	Cover
3	Impeller
4	Adapter
5	Shaft Sleeve
6	Impeller Screw
7	Slinger
8	Gasket, Casing
9	O-Ring, Impeller Screw
10	O-Ring, Shaft Sleeve (Sleeve/Impeller)
11	Splashplate
12	Key, Impeller
13	Seal Kit
17	Capscrew (Motor/Adapter)
18	Capscrew (Casing/Adapter)
20*	O-Ring, Shaft Sleeve (Shaft/Sleeve)

\* Not Shown in Drawing

**Exploded View**

*Optional Items Shown in ITALICS*

Ref #	Component Item No.	Description	Qty Per
1	SV8401771	CASING,3X2-1/2,SS DC2	1
2	SC8302581	COVER,3X2-1/2,SS DCH2	1
3	SI8302591	IMPELLER,3X2-1/2,SS (SEE NOTES) DCH2,ZCH2	1
4	GX8401251	ADAPTER,250 JM FRAME ZCH2	1
	<i>SX8401252</i>	<i>ADAPTER,250 JM FRAME,SS/NS ZCH2</i>	<i>1</i>
5	SX8104421	SLEEVE,SHFT,SS ZCH2	1
6	SI8102722	SCREW,IMP,SS DCH2 RCH2 ZCH2	1
7	GX5098700	SLINGER,1-23/32X3-3/4X 3/16 ZCH2	1
8	GX5040800	GASKET,7-47/64X7-1/8X1/16,NEO	1
9	GX5099300	O-RING,1-3/8X1-1/2X1/16,BUNA SLEEVE	1
10	GX5099800	O-RING,1-5/8X1-3/4X1/16,BUNA SLEEVE	1
11	GX5091400	SPLASHPLATE,EC2/KC2/RC2/ZC2,SS FR213-256	1
12	GX5051200	KEY,IMPLR/SLV,2.0X.25X.25 304-SS	1
13	GS8106890	KIT,1-5/8,325,T21,CE/CA/BU DCH2	1
17	GX5077500	CAPSCRW,SH,1/2-13X3,BLK OX SCKT HD	4
18	GX5077200	CAPSCRW,HX,3/8-16X1-1/4,18-8SS HX HD	8
20	GX5099300	O-RING,1-3/8X1-1/2X1/16,BUNA SLEEVE	1

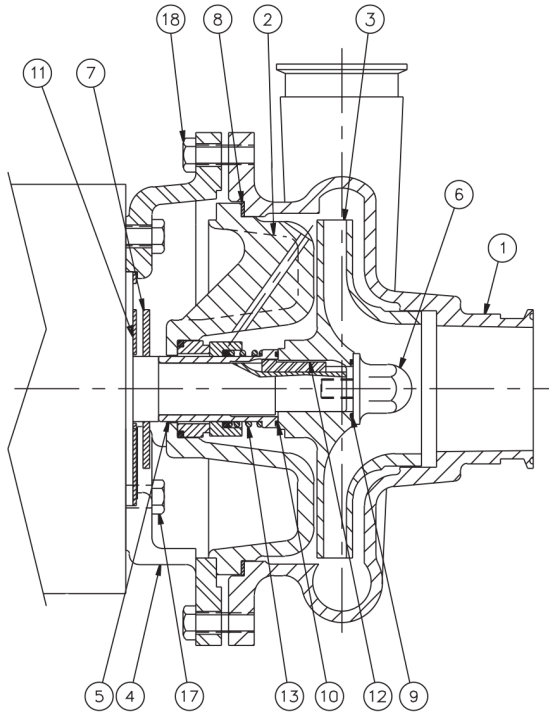

Ref #	Component
1	Casing
2	Cover
3	Impeller
4	Adapter
5	Shaft Sleeve
6	Impeller Screw
7	Slinger
8	Gasket, Casing
9	O-Ring, Impeller Screw
10	O-Ring, Shaft Sleeve (Sleeve/Impeller)
11	Splashplate
12	Key, Impeller
13	Seal Kit
17	Capscrew (Motor/Adapter)
18	Capscrew (Casing/Adapter)
20*	O-Ring, Shaft Sleeve (Shaft/Sleeve)

\* Not Shown in Drawing

**Exploded View**

*Optional Items Shown in ITALICS*

Ref #	Component Item No.	Description	Qty Per
1	SV8401831	CASING,3X3,SS DC2	1
2	SC8302701	COVER,3X3,SS DCH2	1
3	SI8302681	IMPELLER,3X3,SS DCH2	1
4	GX8401851	ADAPTER,250,JM,3X3 DCH2	1
5	SX8104421	SLEEVE,SHFT,SS ZCH2	1
6	SI8102722	SCREW,IMP,SS DCH2 RCH2 ZCH2	1
7	GX5098700	SLINGER,1-23/32X3-3/4X 3/16 ZCH2	1
8	GX5040400	GASKET,9-39/64X 9X1/16,BUNA	1
9	GX5099300	O-RING,1-3/8X1-1/2X1/16,BUNA SLEEVE	1
10	GX5099800	O-RING,1-5/8X1-3/4X1/16,BUNA SLEEVE	1
11	GX5091400	SPLASHPLATE,EC2/KC2/RC2/ZC2,SS FR213-256	1
12	GX5051200	KEY,IMPLR/SLV,2.0X.25X.25 304-SS	1
13	GS8107200	KIT,1-5/8,33,T21,CE/CA/BU DCH2	1
17	GX5077500	CAPSCRW,SH,1/2-13X3,BLK OX SCKT HD	4
18	GX5077200	CAPSCRW,HX,3/8-16X1-1/4,18-8SS HX HD	8
20	GX5099300	O-RING,1-3/8X1-1/2X1/16,BUNA SLEEVE	1

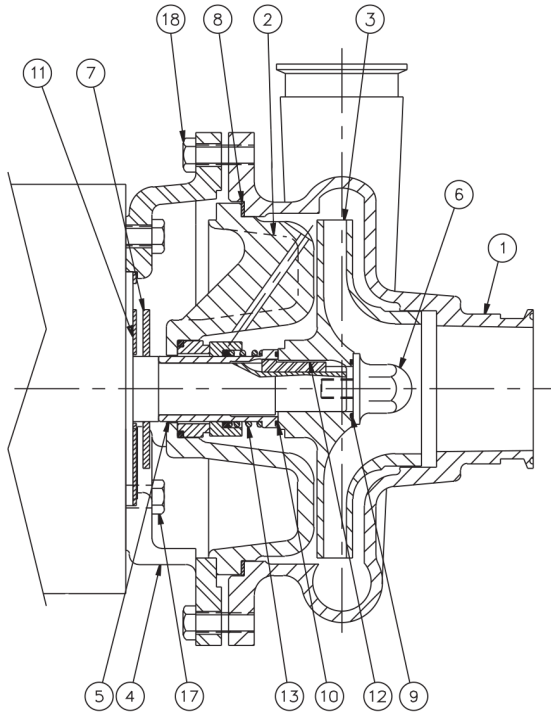

Ref #	Component
1	Casing
2	Cover
3	Impeller
4	Adapter
5	Shaft Sleeve
6	Impeller Screw
7	Slinger
8	Gasket, Casing
9	O-Ring, Impeller Screw
10	O-Ring, Shaft Sleeve (Sleeve/Impeller)
11	Splashplate
12	Key, Impeller
13	Seal Kit
17	Capscrew (Motor/Adapter)
18	Capscrew (Casing/Adapter)
20*	O-Ring, Shaft Sleeve (Shaft/Sleeve)

\* Not Shown in Drawing

**Exploded View**

*Optional Items Shown in ITALICS*

Ref #	Component Item No.	Description	Qty Per
1	SV8401831	CASING,3X3,SS DC2	1
2	SC8302701	COVER,3X3,SS DCH2	1
3	SI8302681	IMPELLER,3X3,SS DCH2	1
4	GX8401891	ADAPTER,280JM FRAME,3X3 MCH2/DCH2	1
5	SX8104421	SLEEVE,SHFT,SS ZCH2	1
6	SI8102722	SCREW,IMP,SS DCH2 RCH2 ZCH2	1
7	GX5098700	SLINGER,1-23/32X3-3/4X 3/16 ZCH2	1
8	GX5040400	GASKET,9-39/64X 9X1/16,BUNA	1
9	GX5099300	O-RING,1-3/8X1-1/2X1/16,BUNA SLEEVE	1
10	GX5099800	O-RING,1-5/8X1-3/4X1/16,BUNA SLEEVE	1
11	SX8101072	SPLASHPLATE,280JM FRM ZCH2	1
12	GX5051200	KEY,IMPLR/SLV,2.0X.25X.25 304-SS	1
13	GS8107200	KIT,1-5/8,33,T21,CE/CA/BU DCH2	1
17	GX5076700	CAPSCRW,HX,5/8-11X1-1/2,18-8SS HX HD	4
	GX5077200	CAPSCRW,HX,3/8-16X1-1/4,18-8SS HX HD	4
18	GX5077200	CAPSCRW,HX,3/8-16X1-1/4,18-8SS HX HD	8
20	GX5099300	O-RING,1-3/8X1-1/2X1/16,BUNA SLEEVE	1

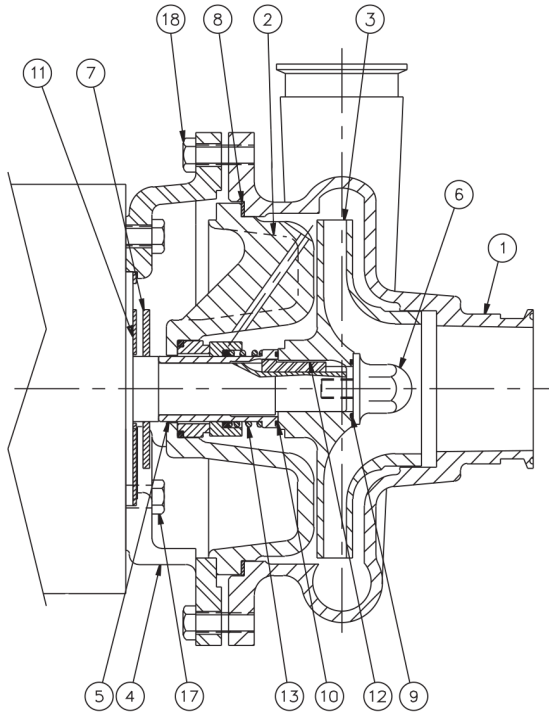

Ref #	Component
1	Casing
2	Cover
3	Impeller
4	Adapter
5	Shaft Sleeve
6	Impeller Screw
7	Slinger
8	Gasket, Casing
9	O-Ring, Impeller Screw
10	O-Ring, Shaft Sleeve (Sleeve/Impeller)
11	Splashplate
12	Key, Impeller
13	Seal Kit
17	Capscrew (Motor/Adapter)
18	Capscrew (Casing/Adapter)
20*	O-Ring, Shaft Sleeve (Shaft/Sleeve)

\* Not Shown in Drawing

**Exploded View**

*Optional Items Shown in ITALICS*

Ref #	Component Item No.	Description	Qty Per
1	SV8401811	CASING,4X3,SS DC2	1
2	SC8302631	COVER,4X3,SS DCH2	1
3	SI8302661	IMPELLER,4X3,SS DCH2	1
4	GX8401251	ADAPTER,250 JM FRAME ZCH2	1
	<i>SX8401252</i>	<i>ADAPTER,250 JM FRAME,SS/INS ZCH2</i>	<i>1</i>
5	SX8104421	SLEEVE,SHFT,SS ZCH2	1
6	SI8102722	SCREW,IMP,SS DCH2 RCH2 ZCH2	1
7	GX5098700	SLINGER,1-23/32X3-3/4X 3/16 ZCH2	1
8	GX5040200	GASKET,7-39/64X7-1/8X1/16,BUNA	1
9	GX5099300	O-RING,1-3/8X1-1/2X1/16,BUNA SLEEVE	1
10	GX5099800	O-RING,1-5/8X1-3/4X1/16,BUNA SLEEVE	1
11	GX5091400	SPLASHPLATE,EC2/KC2/RC2/ZC2,SS FR213-256	1
12	GX5051200	KEY,IMPLR/SLV,2.0X.25X.25 304-SS	1
13	GS8107060	KIT,1-5/8,43,T21,CE/CA/BU DCH2	1
17	GX5077500	CAPSCRW,SH,1/2-13X3,BLK OX SCKT HD	4
18	GX5077200	CAPSCRW,HX,3/8-16X1-1/4,18-8SS HX HD	8
20	GX5099300	O-RING,1-3/8X1-1/2X1/16,BUNA SLEEVE	1

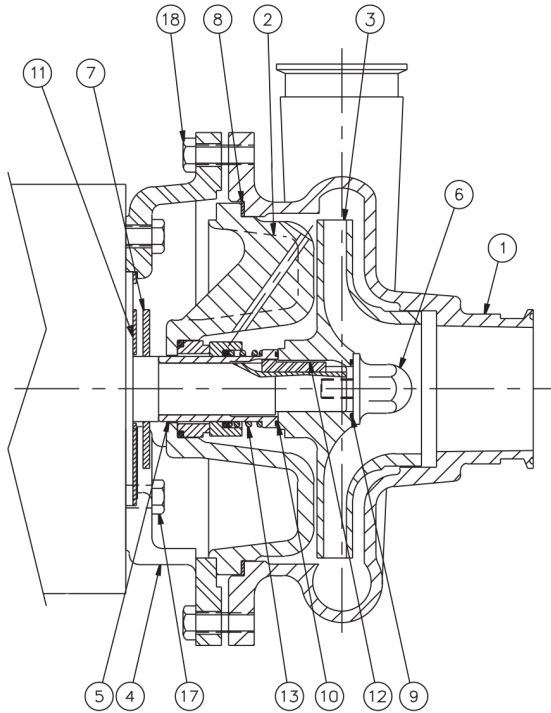

Ref #	Component
1	Casing
2	Cover
3	Impeller
4	Adapter
5	Shaft Sleeve
6	Impeller Screw
7	Slinger
8	Gasket, Casing
9	O-Ring, Impeller Screw
10	O-Ring, Shaft Sleeve (Sleeve/Impeller)
11	Splashplate
12	Key, Impeller
13	Seal Kit
17	Capscrew (Motor/Adapter)
18	Capscrew (Casing/Adapter)
20*	O-Ring, Shaft Sleeve (Shaft/Sleeve)

\* Not Shown in Drawing

**Exploded View**

*Optional Items Shown in ITALICS*

Ref #	Component Item No.	Description	Qty Per
1	SV8401811	CASING,4X3,SS DC2	1
2	SC8302631	COVER,4X3,SS DCH2	1
3	SI8302661	IMPELLER,4X3,SS DCH2	1
4	GX8401361	ADAPTER,280 JM FRAME ZCH2	1
5	SX8104421	SLEEVE,SHFT,SS ZCH2	1
6	SI8102722	SCREW,IMP,SS DCH2 RCH2 ZCH2	1
7	GX5098700	SLINGER,1-23/32X3-3/4X 3/16 ZCH2	1
8	GX5040200	GASKET,7-39/64X7-1/8X1/16,BUNA	1
9	GX5099300	O-RING,1-3/8X1-1/2X1/16,BUNA SLEEVE	1
10	GX5099800	O-RING,1-5/8X1-3/4X1/16,BUNA SLEEVE	1
11	SX8101072	SPLASHPLATE,280JM FRM ZCH2	1
12	GX5051200	KEY,IMPLR/SLV,2.0X.25X.25 304-SS	1
13	GS8107060	KIT,1-5/8,43,T21,CE/CA/BU DCH2	1
17	GX5076700	CAPSCRW,HX,5/8-11X1-1/2,18-8SS HX HD	4
	GX5077200	CAPSCRW,HX,3/8-16X1-1/4,18-8SS HX HD	4
18	GX5077200	CAPSCRW,HX,3/8-16X1-1/4,18-8SS HX HD	8
20	GX5099300	O-RING,1-3/8X1-1/2X1/16,BUNA SLEEVE	1

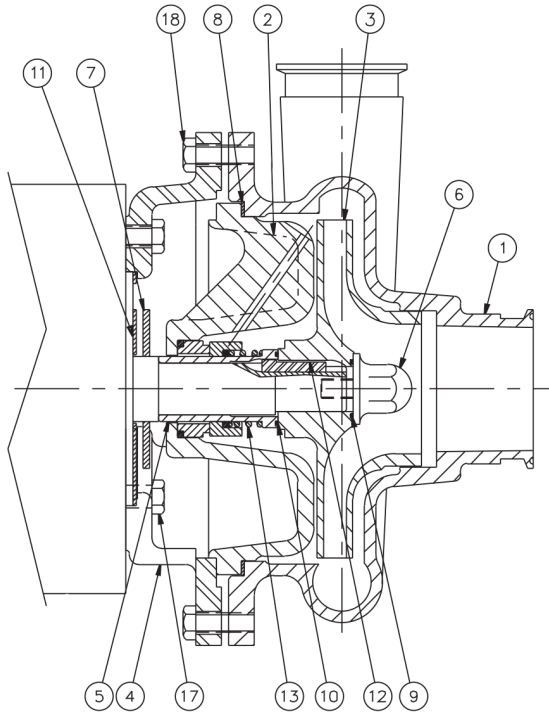

Ref #	Component
1	Casing
2	Cover
3	Impeller
4	Adapter
5	Shaft Sleeve
6	Impeller Screw
7	Slinger
8	Gasket, Casing
9	O-Ring, Impeller Screw
10	O-Ring, Shaft Sleeve (Sleeve/Impeller)
11	Splashplate
12	Key, Impeller
13	Seal Kit
17	Capscrew (Motor/Adapter)
18	Capscrew (Casing/Adapter)
20*	O-Ring, Shaft Sleeve (Shaft/Sleeve)

\* Not Shown in Drawing

**Exploded View**

*Optional Items Shown in ITALICS*

Ref #	Component Item No.	Description	Qty Per
1	SV8401831	CASING,3X3,SS DC2	1
2	SC8303330	COVER,3X3,SS,CRO SEAL DCH3	1
3	SI8302681	IMPELLER,3X3,SS DCH2	1
4	GX8401851	ADAPTER,250,JM,3X3 DCH2	1
5	SX8104421	SLEEVE,SHFT,SS ZCH2	1
6	SI8102722	SCREW,IMP,SS DCH2 RCH2 ZCH2	1
7	GX5098700	SLINGER,1-23/32X3-3/4X 3/16 ZCH2	1
8	GX5040401	GASKET,9-39/64X9X1/16,VIT	1
9	GX5099302	O-RING,33/43,VIT,FDA COMPL DCH3	1
10	GX5099801	O-RING,33/43,VIT,FDA COMPL DCH3	1
11	GX5091400	SPLASHPLATE,EC2/KC2/RC2/ZC2,SS FR213-256	1
12	GX5051200	KEY,IMPLR/SLV,2.0X.25X.25 304-SS	1
13	GS8109590	KIT,1-5/8,33,ROPLAN,SC/CA/VI DCH3	1
17	GX5077500	CAPSCRW,SH,1/2-13X3,BLK OX SCKT HD	4
18	GX5077200	CAPSCRW,HX,3/8-16X1-1/4,18-8SS HX HD	8
20	GX5099302	O-RING,33/43,VIT,FDA COMPL DCH3	1

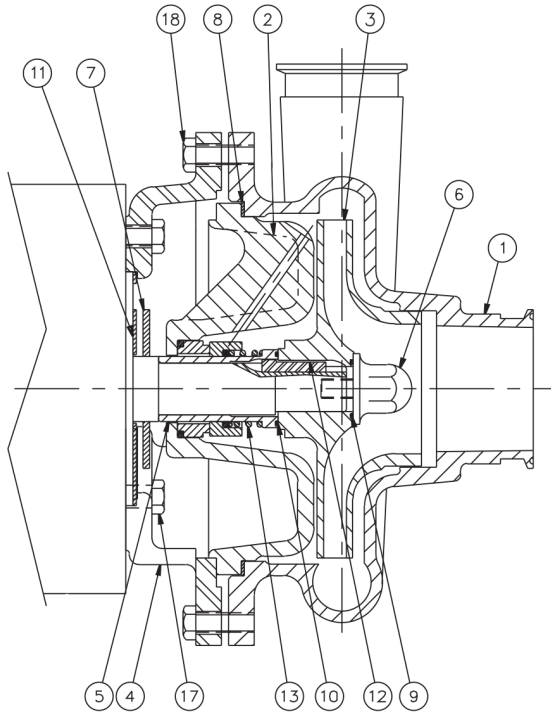

Ref #	Component
1	Casing
2	Cover
3	Impeller
4	Adapter
5	Shaft Sleeve
6	Impeller Screw
7	Slinger
8	Gasket, Casing
9	O-Ring, Impeller Screw
10	O-Ring, Shaft Sleeve (Sleeve/Impeller)
11	Splashplate
12	Key, Impeller
13	Seal Kit
17	Capscrew (Motor/Adapter)
18	Capscrew (Casing/Adapter)
20*	O-Ring, Shaft Sleeve (Shaft/Sleeve)

\* Not Shown in Drawing

**Exploded View**

*Optional Items Shown in ITALICS*

Ref #	Component Item No.	Description	Qty Per
1	SV8401831	CASING,3X3,SS DC2	1
2	SC8303330	COVER,3X3,SS,CRO SEAL DCH3	1
3	SI8302681	IMPELLER,3X3,SS DCH2	1
4	GX8401891	ADAPTER,280JM FRAME,3X3 MCH2/DCH2	1
5	SX8104421	SLEEVE,SHFT,SS ZCH2	1
6	SI8102722	SCREW,IMP,SS DCH2 RCH2 ZCH2	1
7	GX5098700	SLINGER,1-23/32X3-3/4X 3/16 ZCH2	1
8	GX5040401	GASKET,9-39/64X9X1/16,VIT	1
9	GX5099302	O-RING,33/43,VIT,FDA COMPL DCH3	1
10	GX5099801	O-RING,33/43,VIT,FDA COMPL DCH3	1
11	SX8101072	SPLASHPLATE,280JM FRM ZCH2	1
12	GX5051200	KEY,IMPLR/SLV,2.0X.25X.25 304-SS	1
13	GS8109590	KIT,1-5/8,33,ROPLAN,SC/CA/VI DCH3	1
17	GX5076700	CAPSCRW,HX,5/8-11X1-1/2,18-8SS HX HD	4
	GX5077200	CAPSCRW,HX,3/8-16X1-1/4,18-8SS HX HD	4
18	GX5077200	CAPSCRW,HX,3/8-16X1-1/4,18-8SS HX HD	8
20	GX5099302	O-RING,33/43,VIT,FDA COMPL DCH3	1

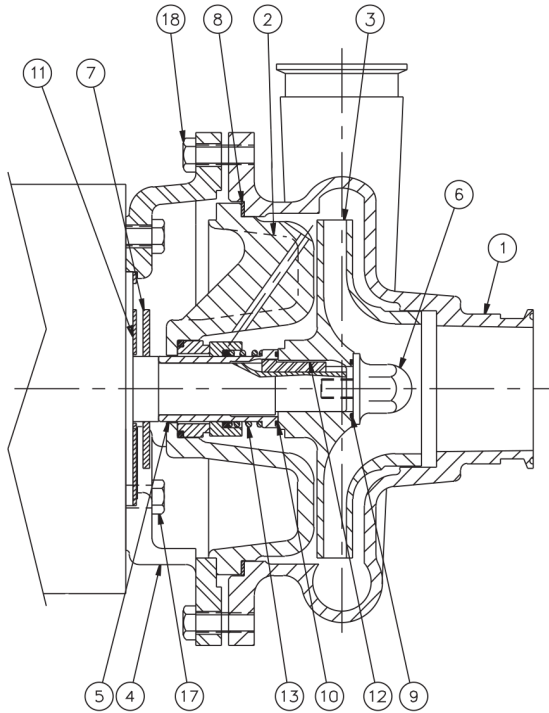

Ref #	Component
1	Casing
2	Cover
3	Impeller
4	Adapter
5	Shaft Sleeve
6	Impeller Screw
7	Slinger
8	Gasket, Casing
9	O-Ring, Impeller Screw
10	O-Ring, Shaft Sleeve (Sleeve/Impeller)
11	Splashplate
12	Key, Impeller
13	Seal Kit
17	Capscrew (Motor/Adapter)
18	Capscrew (Casing/Adapter)
20*	O-Ring, Shaft Sleeve (Shaft/Sleeve)

\* Not Shown in Drawing

**Exploded View**

*Optional Items Shown in ITALICS*

Ref #	Component Item No.	Description	Qty Per
1	SV8401811	CASING,4X3,SS DC2	1
2	SC8303370	COVER,4X3,SS CRO SEAL DCH2	1
3	SI8302661	IMPELLER,4X3,SS DCH2	1
4	GX8401251	ADAPTER,250 JM FRAME ZCH2	1
	<i>SX8401252</i>	<i>ADAPTER,250 JM FRAME,SS NS ZCH2</i>	<i>1</i>
5	SX8104421	SLEEVE,SHFT,SS ZCH2	1
6	SI8102722	SCREW,IMP,SS DCH2 RCH2 ZCH2	1
8	GX5040201	GASKET,7-39/64X7-1/8X1/16,VIT	1
9	GX5099302	O-RING,33/43,VIT,FDA COMPL DCH3	1
10	GX5099801	O-RING,33/43,VIT,FDA COMPL DCH3	1
11	GX5091400	SPLASHPLATE,EC2/KC2/RC2/ZC2,SS FR213-256	1
13	GS8109600	KIT,1-5/8,43,ROPLAN,SC/CA/VI DCH3	1
17	GX5077500	CAPSCRW,SH,1/2-13X3,BLK OX SCKT HD	4
18	GX5077200	CAPSCRW,HX,3/8-16X1-1/4,18-8SS HX HD	8
20	GX5099302	O-RING,33/43,VIT,FDA COMPL DCH3	1