

# **BALDOR**® • ***RELIANCE***

## **Product Information Packet**

# **EM2555T-8**

**100HP,1780RPM,3PH,60HZ,404T,4476M,OPSB,F**

Part Detail							
Revision:	J	Status:	PRD/A	Change #:		Proprietary:	No
Type:	AC	Prod. Type:	4476M	Elec. Spec:	44WGW087	CD Diagram:	CD0695
Enclosure:	OPSB	Mfg Plant:		Mech. Spec:	44E193	Layout:	44LYE193
Frame:	404T	Mounting:	F1	Poles:	04	Created Date:	08-07-2009
Base:	RG	Rotation:	R	Insulation:	F	Eff. Date:	12-07-2016
Leads:	6#2					Replaced By:	
Literature:		Elec. Diagram:					

<b>Nameplate NP2138L</b>												
<b>CAT.NO.</b>	EM2555T-8			<b>P/N</b>				<b>ENCLOSURE</b>	OPSB			
<b>SPEC.</b>	44E193W087G1		<b>CC</b>	010A		<b>FRAME</b>	404T		<b>S/N</b>			
<b>HP</b>	100			<b>CLASS</b>	F		<b>HZ</b>	60				
<b>RPM</b>	1780			<b>PH</b>	3		<b>DES</b>	B				
<b>VOLT</b>	200			<b>KVA-CODE</b>	G			<b>ODE BRG</b>	6312		<b>DE BRG</b>	6316
<b>AMP</b>	263			<b>USABLE AT 208V</b>	264							
<b>RATING</b>	40C AMB-CONT			<b>GREASE</b>	POLYREX EM							
<b>NEMA-NOM-EFF</b>	95.4	<b>PF</b>	85	<b>SER.F.</b>	1.15							
<b>HTR-VOLTS</b>				<b>HTR-AMPS</b>				<b>MAX. SPACE HEATER TEMP.</b>				

Parts List		
Part Number	Description	Quantity
SA184594	SA 44E193W087G1	1.000 EA
RA172426	RA 44E193W087G1	1.000 EA
S/P107-000-004	SUPER-E(284 FR. & UP)-CL PLANT,POLYREX E	1.000 EA
HA6731	LIFTING LUG FOR 44 FRAME MOTORS.	2.000 EA
HA6648A01	CAST ADAPTER, 44 FRAME - NEMA 404-5 - MA	1.000 EA
19XW3816A16	.38-16 X 1.00 HEX WASHER HEAD TAPTITE II	2.000 EA
HW1001A38	LOCKWASHER 3/8, ZINC PLT .688 OD, .382 I	2.000 EA
16CB1000A01	CONDUIT BOX, MACH	1.000 EA
19XW3118A16	.31-18 HEX WASHER HEAD TAPTITE II 1.00 L	4.000 EA
HW1001A31	LOCKWASHER 5/16, ZINC PLT.591 OD, .319 I	4.000 EA
WD1000B25	GND LUG, BURNDY L125HP OR T&B L125HP-BB	1.000 EA
10XN3118K16	5/16-18 X 1' GRADE #5, STL, ZINC PLATE	1.000 EA
HW1001A31	LOCKWASHER 5/16, ZINC PLT.591 OD, .319 I	1.000 EA
44EP1203A02	FREP, MACH	1.000 EA
HW5100A15	W4997-050 WVY WSHR (WB)	1.000 EA
10XN3816K48	3/8-16 X 3 HEX HD CAP SCREW,Z/P	4.000 EA
HW1001A38	LOCKWASHER 3/8, ZINC PLT .688 OD, .382 I	4.000 EA
44EP1202A01	PU ENDPLATE, MACH.	1.000 EA
XY5013A12	NUT,1/2-13,HEX,STEEL,ZINCPLATED	8.000 EA
16CB1500A01	CONDUIT BOX LID, MACH.	1.000 EA
10XN3118K16	5/16-18 X 1' GRADE #5, STL, ZINC PLATE	4.000 EA
HW1001A31	LOCKWASHER 5/16, ZINC PLT.591 OD, .319 I	4.000 EA
HW2501K66	KEY, 3/4 SQ X 5.625	1.000 EA
LB1115N	LABEL,LIFTING DEVICE (ON ROLLS)	1.000 EA

<b>Parts List (continued)</b>		
<b>Part Number</b>	<b>Description</b>	<b>Quantity</b>
MN416A01	TAG-INSTAL-MAINT no wire (1000/bx) 11/14	1.000 EA
HW4500A03	GREASE FITTING, .125 NPT 1610(ALEMITE) 8	1.000 EA
HW4500A20	1/8NPT SL PIPE PLUG	1.000 EA
HA4051A00	PLASTIC CAP FOR GREASE FITTING	1.000 EA
MJ1000A02	GREASE, POLYREX EM EXXON (USe 4824-15A)	0.030 LB
HW4500A03	GREASE FITTING, .125 NPT 1610(ALEMITE) 8	1.000 EA
HW4500A20	1/8NPT SL PIPE PLUG	1.000 EA
HA4051A00	PLASTIC CAP FOR GREASE FITTING	1.000 EA
MG1000Y03	MUNSELL 2.53Y 6.70/ 4.60, GLOSS 20,	0.080 GA
85XU0407S04	4X1/4 U DRIVE PIN STAINLESS	4.000 EA
44AD2001A02	BAFFLE 44 OPEN,"X"=1.50, SLOTTED BAND MT	1.000 EA
44AD2001A02	BAFFLE 44 OPEN,"X"=1.50, SLOTTED BAND MT	1.000 EA
HA3175A04	THRUBOLT STUD 1/2-13 X 26.000 - GRADE 2	4.000 EA
LB1119N	WARNING LABEL	1.000 EA
LC0695	CONNECTION LABEL	1.000 EA
NP2138L	ALUM SUPER-E UL CSA-EEV PREM CC (300	1.000 EA
44PA1000	PK GP COMB PRINT 39-3/8X31X23-7/8	1.000 EA

<b>Accessories</b>		
<b>Part Number</b>	<b>Description</b>	<b>Multiplier</b>
44-1402	C FACE KIT 44/404-5UC TC 6316 BRG	A8

**AC Induction Motor Performance Data**

Record # 13915 - Typical performance - not guaranteed values

<b>Winding:</b> 44WGW087-R001	<b>Type:</b> 4476M	<b>Enclosure:</b> OPSB
-------------------------------	--------------------	------------------------

Nameplate Data				200 V, 60 Hz: Single Voltage Motor	
Rated Output (HP)	100			Full Load Torque	295 LB-FT
Volts	200			Start Configuration	direct on line
Full Load Amps	263			Breakdown Torque	843 LB-FT
R.P.M.	1780			Pull-up Torque	409 LB-FT
Hz	60	Phase	3	Locked-rotor Torque	500 LB-FT
NEMA Design Code	B	KVA Code	G	Starting Current	1745 A
Service Factor (S.F.)	1.15			No-load Current	93.5 A
NEMA Nom. Eff.	95.4	Power Factor	85	Line-line Res. @ 25°C	0.0091 Ω
Rating - Duty	40C AMB-CONT			Temp. Rise @ Rated Load	40°C
S.F. Amps				Temp. Rise @ S.F. Load	53°C
				Locked-rotor Power Factor	25
				Rotor inertia	14.4 LB-FT <sup>2</sup>

Load Characteristics 200 V, 60 Hz, 100 HP

% of Rated Load	25	50	75	100	125	150	S.F.
Power Factor	46	69	79	86	86	86	86
Efficiency	93.1	95.4	95.8	95.6	95.2	94.5	95.4
Speed	1796	1791	1786	1781	1775	1769	1777
Line amperes	126	164	214	263	329	393	302.6

Performance Graph at 200V, 60Hz, 100.0HP Typical performance - Not guaranteed values

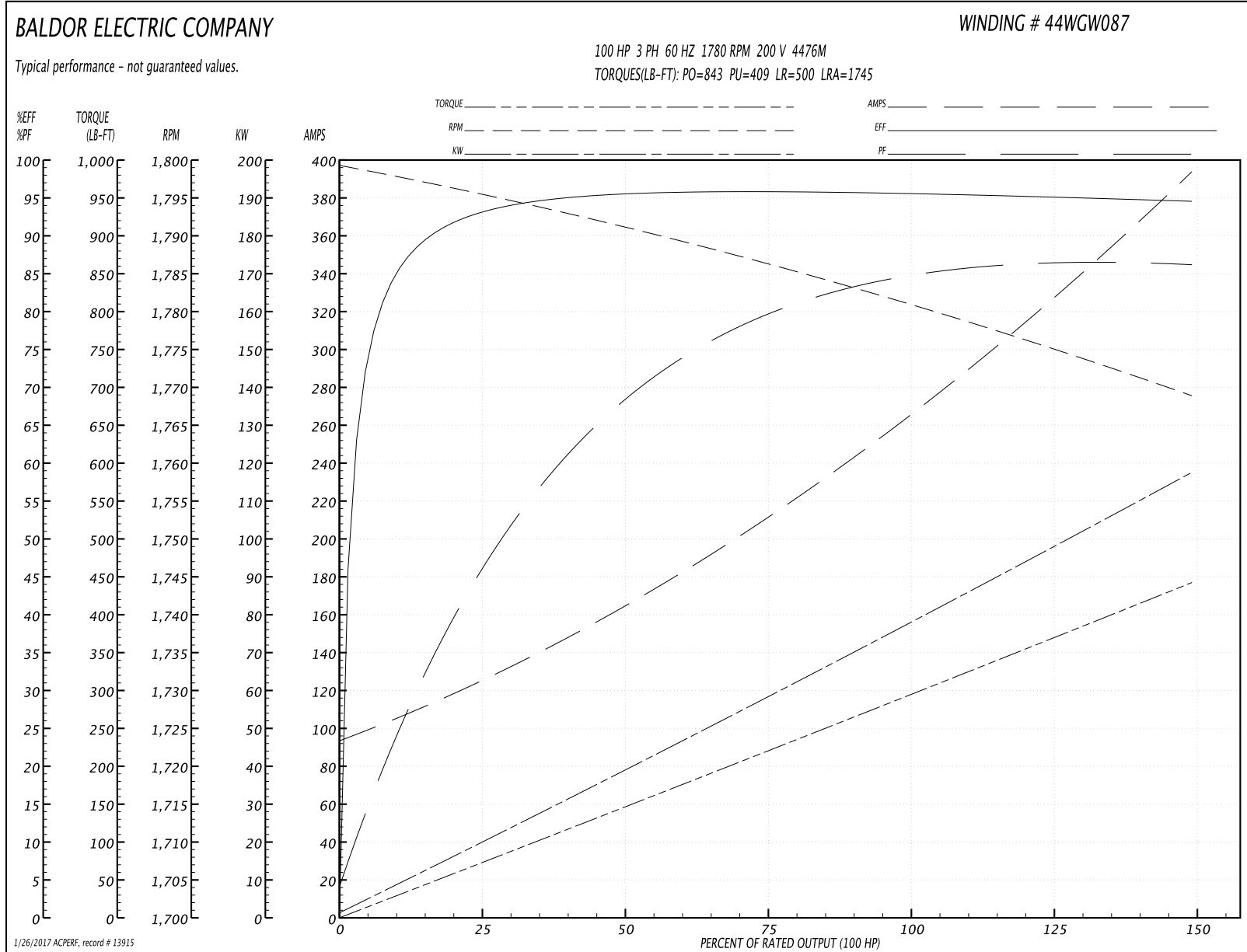

44LYE193

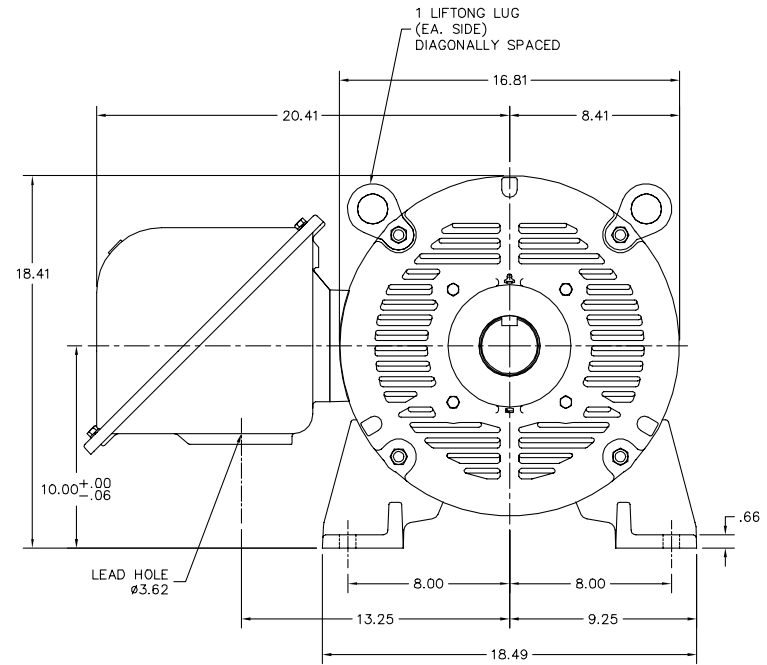
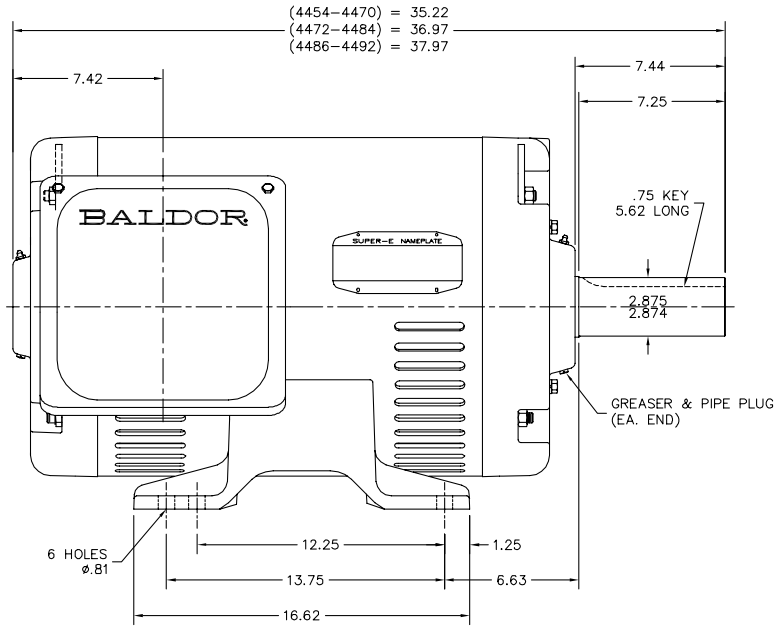

44LYE193

CUSTOMER IS RESPONSIBLE FOR DETERMINING THAT BALDOR'S PRODUCT WILL PERFORM SUITABLY IN THE INTENDED APPLICATION.

REV. DESC: NEW	VERSION: 00	TDR: 000000505124
REV. LTR: -	REVISED: 07:22:25 07/10/2009	BY: ENGAMG0
FILE: \AAA\00164\043		
MTL: -		

**BALDOR • DODGE • RELIANCE**  
 HORZ OPSB 404-5T,SUPER-E  
 SH 1 of 1

CD0695

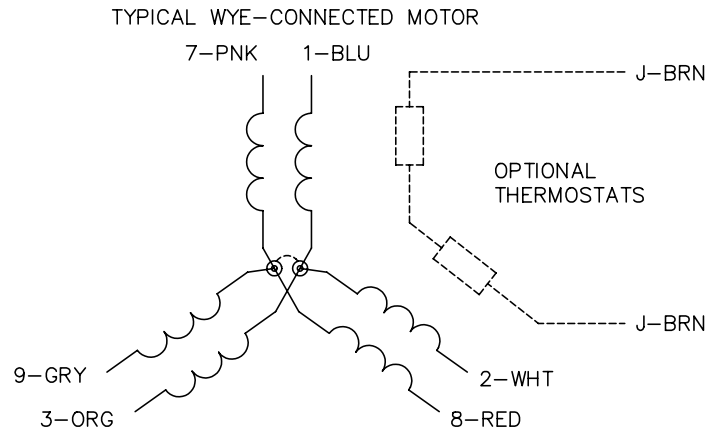

START CONNECTION

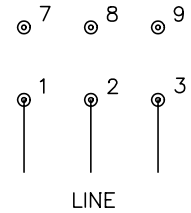

RUN CONNECTION

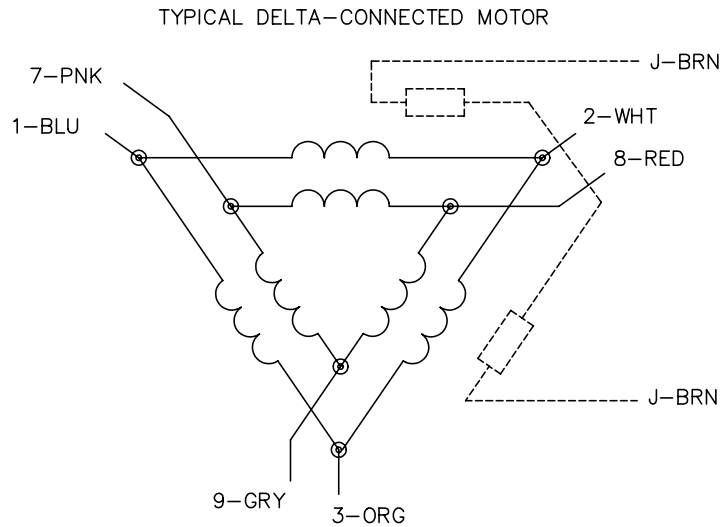
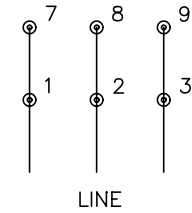

NOTES:

1. MOTOR MAY BE WYE CONNECTED OR DELTA CONNECTED.
2. INTERCHANGE ANY TWO LINE LEADS TO REVERSE ROTATION.
3. OPTIONAL THERMOSTATS ARE PROVIDED WHEN SPECIFIED.
4. ACTUAL NUMBER OF INTERNAL PARALLEL CIRCUITS MAY VARY.
5. LEAD COLORS ARE OPTIONAL. LEADS MUST ALWAYS BE NUMBERED AS SHOWN.

REV. DESC: REVISE TO SHOW OPTIONAL COLORS

REV. LTR: C BY: JLP

REVISED: 01/21/99 3:19

TDR: 0171435

9690D0

FILE: AAA00005151

MDL: -

MTL: -

**BALDOR ELECTRIC Co.**

3PH, SV, 6 LEADS, PART WINDING START

CD0695