

# **BALDOR**® • ***RELIANCE***

## **Product Information Packet**

# **EM7590T-I**

**100HP, 1780RPM, 3PH, 60HZ, X405T, A40072M, TEF**

Part Detail							
Revision:	M	Status:	PRD/A	Change #:		Proprietary:	No
Type:	AC	Prod. Type:	A40072M	Elec. Spec:	A40WG1233	CD Diagram:	416820-036
Enclosure:	TEFC	Mfg Plant:		Mech. Spec:		Layout:	611742-001-SH1
Frame:	X405T	Mounting:	F1	Poles:	04	Created Date:	11-18-2010
Base:		Rotation:	R	Insulation:	F	Eff. Date:	11-11-2015
Leads:	3#2					Replaced By:	
Literature:		Elec. Diagram:					

Nameplate 000613006PC

CLASS I GROUP	D X X
CLASS II GROUP	E F G
OPERATING TEMP CODE	T3C

Nameplate 000692000FX

Nameplate NP2383L									
CAT.NO.	EM7590T-I			SPEC NO.	P40G4864				
HP	100	AMPS	112	VOLTS	460	DESIGN	B		
FRAME	X405T	RPM	1780	HZ	60	AMB	40	SF	1.15
DRIVE END BEARING	80BC03J30X		PHASE	3	DUTY	CONT		INSUL.CLASS	F
OPP D.E. BEARING	80BC03J30X		TYPE	P	ENCL	TEFC	CODE	G	
SER.NO.				POWER FACTOR	87.5	NEMA-NOM-EFFICIENCY	95.4		
NEMA NOM/CSA QUOTED EFF				MAX CORR KVAR	17.0	GUARANTEED EFFICIENCY	94.5		
				MOTOR WEIGHT	1375				

Parts List		
Part Number	Description	Quantity
SA211817	SA P40G4864	1.000 EA
RA199046	RA P40G4864	1.000 EA
000613006PC	N/P U/L (REL QTY 500)	1.000 EA
000692000FX	UL LISTED LOGO LABEL 2.53 X 0.75 X .018	1.000 EA
LB1073	ALUM XP CAUTION LABEL	1.000 EA
000692000VD	LABEL WARNING	1.000 EA
NP2383L	SUPER-E ,SS, CC, CSA-C US, CSA EEV	1.000 EA
MG1025G05	WILKOFASST, 789.227, MED. GRAY CHAR. MET.	0.250 GA
004824015A	GREASE POLYREX EM	1.000 LB
032018004AM	HHCS 1/4-20X1/2PLTD GREN	1.000 EA
032018010CK	HHCS 3/8-16X1-1/4 PLTD.	4.000 EA
032018014DK	HHCS 1/2-13X1-3/4 PLTD	4.000 EA
032018032CK	HHCS 3/8-16X4 PLATED	3.000 EA
032018032CK	HHCS 3/8-16X4 PLATED	3.000 EA
032130020EB	SHSCS 5/8-11X2-1/2PLTD.	4.000 EA
032130020EB	SHSCS 5/8-11X2-1/2PLTD.	4.000 EA
032620016KB	SHSS; 1/4X1/2	1.000 EA
032620016KB	SHSS; 1/4X1/2	1.000 EA
033775004EA	DRSCR #6-1/4 304 S.S.	8.000 EA
034000014AB	WSH ID.406 OD.812 TH.065	4.000 EA
034017014AB	LCKW 3/8 STD. PLATED	3.000 EA
034017014AB	LCKW 3/8 STD. PLATED	3.000 EA
034017014AB	LCKW 3/8 STD. PLATED	4.000 EA
034017016AB	LCKW 1/2" PLATED	4.000 EA

Parts List (continued)		
Part Number	Description	Quantity
034017018AB	LCKW 5/8"	4.000 EA
034017018AB	LCKW 5/8"	4.000 EA
034036012AB	LCKW EXTERNAL TOOTH 1/4"	1.000 EA
034180012DA	KEY 1X4X1/4X1-1/2 L	1.000 EA
034180044JA	KEY 3/4X3/4X5-1/2 L	1.000 EA
034530024AB	PNIPL 1/8X3L PLATED	1.000 EA
034530058AB	P/NIP 1/8X7-1/4 PLATED	1.000 EA
035000001A	ALFTG 1/8" 1610-BL	1.000 EA
035000001A	ALFTG 1/8" 1610-BL	1.000 EA
034690002AB	"unbulked" PPLG 1/4" PLTD.	1.000 EA
034690002AB	"unbulked" PPLG 1/4" PLTD.	1.000 EA
063916001S	+P/NIP 3X3 DIMPL-400	1.000 EA
064069000A	C/BC320/360 X 064069000B	1.000 EA
073646000E	C/B 320 WA073646000	1.000 EA
078548001R	FAN KB 234/150 (84) 400	1.000 EA
083198036A	FANCV BLKT 400	1.000 EA
089416056DA	BRKT 400 089416052WCB	1.000 EA
089416056F	BRKT 400 089416052WCB	1.000 EA
406055001D	GRFTG	1.000 EA
406055001D	GRFTG	1.000 EA
406099000A	PLUG - FAN COVER 320-440	1.000 EA
410700000DA	WAVY SPRING WASHER	1.000 EA
415000103D	T/LUG #4AWG-1/0AWG W/HOLE FOR .250 BOLT	1.000 EA
415030003AX	BUSH - 400	1.000 EA

Product Information Packet: EM7590T-I - 100HP,1780RPM,3PH,60HZ,X405T,A40072M,TEF

415030003AX	BUSH - 400	1.000 EA
415044001AX	SLGR - 400	1.000 EA
415044001AX	SLGR - 400	1.000 EA
415072001B	CLAMP	1.000 EA
415096002A	CPLG 1/8 HEX TYPE	1.000 EA
415096002A	CPLG 1/8 HEX TYPE	1.000 EA
PK5004A02	WOOD BASE 40X32 STACK 2X4 RUNNER	1.000 EA
402558000DDA	BRDRN	1.000 EA



611742-001-SH1

# DUTY MASTER ALTERNATING CURRENT MOTORS

ENCLOSURE: TOTALLY ENCLOSED SQUIRREL-CAGE INDUCTION  
 UNDERWRITERS LISTED MOTOR  
 MOUNTING: FOOT  
 FRAMES 250T THRU 440T  
 COOLING: FAN COOLED

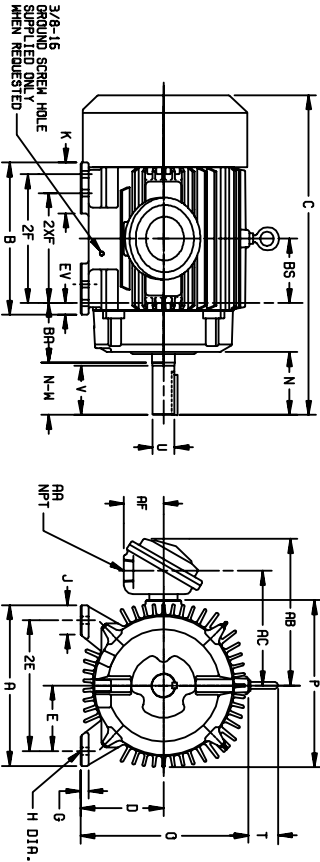

DIMENSIONS ARE IN INCHES: SEE SHEET 2 FOR DIMENSIONS IN MILLIMETERS

FRAME	A	DC2)	E	G	H	J	K	O	P	T	AA	AB	AC	AD	AE	BA	EV
254T-258T	13.50	6.25	5.00	.75	.56	2.50	---	13.25	13.25	2.44	1-1/4	12.38	8.89	3.38	4.25	1.00	
254T-268T	13.75	7.00	5.50	.75	.56	2.50	---	14.75	14.88	2.44	1-1/2	13.25	10.38	3.38	4.75	1.00	
284T	27.44	5.50	13.00	---	---	---	9.50	4.89	4.82	1.875	4.38	.500	3.25	4.95			
284T	27.44	5.50	13.00	---	---	---	9.50	3.31	3.25	1.825	3.00	.375	1.88	4.95			
284T	27.44	5.50	13.00	---	---	---	9.50	4.89	4.82	1.875	4.38	.500	3.25	5.10			
288T	28.06	5.50	13.00	---	---	---	10.50	5.82	5.25	2.125	3.00	.375	1.88	5.10			
324T	30.44	6.00	14.75	---	---	---	10.50	5.82	5.25	2.125	3.50	.500	3.88	6.10			
324T	30.44	6.00	14.75	---	---	---	10.50	5.82	5.25	2.125	3.50	.500	3.88	6.10			
328T	30.44	6.00	14.75	---	---	---	11.25	6.00	5.88	2.375	3.50	.500	2.00	6.50			
328T	28.94	6.00	14.75	---	---	---	11.25	6.00	5.88	2.375	3.50	.500	2.00	6.50			
364T	33.44	6.12	15.00	---	---	---	11.25	6.00	5.88	2.375	3.50	.500	2.00	9.04			
364T	31.31	6.12	15.00	---	---	---	11.25	3.88	3.75	1.875	3.50	.500	2.00	9.04			
365T	33.44	6.12	15.00	---	---	---	6.00	5.88	2.375	5.62	.625	4.25	2.00	9.44			
365T	31.31	6.12	15.00	---	---	---	6.00	3.88	3.75	1.875	3.50	.500	2.00	9.44			
404T	36.31	6.88	16.00	---	---	---	12.25	7.50	7.25	2.875	7.00	.750	5.82	13.00			
404T	36.31	6.88	16.00	---	---	---	12.25	4.50	4.25	2.125	4.00	.500	2.75	12.91			
405T	36.31	6.88	16.00	---	---	---	7.50	7.25	2.875	7.00	.750	5.62	13.26				
405T	35.31	6.88	16.00	---	---	---	4.50	4.25	2.125	4.00	.500	2.75	13.26				
444T	44.62	8.25	19.00	---	---	---	14.50	8.94	8.50	3.375	8.25	.875	6.88	17.70			
444T	40.88	8.25	19.00	---	---	---	14.50	5.19	4.75	2.375	4.50	.625	6.88	17.54			
445T	44.62	8.25	19.00	---	---	---	8.94	8.50	3.375	8.25	.875	6.88	18.88	19.44			
445T	40.88	8.25	19.00	---	---	---	8.94	4.75	2.375	4.50	.625	6.88	19.44				

FRAME	C	BS	B	ZF	(4)	N	SHAFT AND KEY				WEIGHT LBS. (5)	
							N-W(6)	U(3)	V	SQ.		LGTH.
254T	24.56	5.00	12.00	---	---	4.06	4.00	1.625	3.75	.375	2.88	3.35
254T	24.56	5.00	12.00	10.00	---	4.06	4.00	1.625	3.75	.375	2.88	3.45
284T	27.44	5.50	13.00	---	---	4.89	4.82	1.875	4.38	.500	3.25	4.95
284T	27.44	5.50	13.00	---	---	4.89	4.82	1.875	4.38	.500	3.25	4.95
288T	28.06	5.50	13.00	---	---	5.31	5.25	1.825	3.00	.375	1.88	5.10
288T	27.44	5.50	13.00	---	---	5.31	4.82	1.875	4.38	.500	3.25	5.10
324T	30.44	6.00	14.75	---	---	6.12	6.00	2.125	5.00	.500	3.88	6.10
324T	30.44	6.00	14.75	---	---	6.12	5.82	2.125	5.00	.500	3.88	6.10
328T	30.44	6.00	14.75	12.00	---	6.12	6.00	2.125	5.00	.500	3.88	6.50
328T	28.94	6.00	14.75	12.00	---	6.12	6.00	2.125	5.00	.500	3.88	6.50
364T	33.44	6.12	15.00	---	---	7.25	7.25	2.375	5.62	.625	4.25	9.10
364T	31.31	6.12	15.00	---	---	7.25	7.25	2.375	5.62	.625	4.25	9.10
365T	33.44	6.12	15.00	---	---	8.94	8.94	2.875	7.00	.750	5.82	13.00
365T	31.31	6.12	15.00	---	---	8.94	8.94	2.875	7.00	.750	5.82	13.00
404T	36.31	6.88	16.00	---	---	12.25	12.25	3.375	8.25	.875	6.88	17.70
404T	36.31	6.88	16.00	---	---	12.25	12.25	3.375	8.25	.875	6.88	17.70
405T	36.31	6.88	16.00	---	---	12.25	12.25	3.375	8.25	.875	6.88	17.70
405T	35.31	6.88	16.00	---	---	12.25	12.25	3.375	8.25	.875	6.88	17.70
444T	44.62	8.25	19.00	---	---	14.50	14.50	3.375	8.25	.875	6.88	19.44
444T	40.88	8.25	19.00	---	---	14.50	14.50	3.375	8.25	.875	6.88	19.44
445T	44.62	8.25	19.00	---	---	14.50	14.50	3.375	8.25	.875	6.88	19.44
445T	40.88	8.25	19.00	---	---	14.50	14.50	3.375	8.25	.875	6.88	19.44

- (1) SPECIAL DIMENSIONS APPLYING TO THIS ORDER ON THIS LINE.  
 CONDUIT BOX LOCATED ON OPPOSITE SIDE WHEN F-2-W-1,  
 W-4-W-5-W-7, OR C-1 MOUNTING IS SPECIFIED.
- (2) "D" VARIES  $\begin{cases} 259T - 320T +.00, -.03. \\ 360T - 440T +.00, -.06. \end{cases}$   
 IF MOUNTING CLEARANCE DETAILS ARE REQUIRED, CONSULT  
 FACTORY.
- (3) "U" VARIES  $\begin{cases} 1.625 \text{ AND LARGER} +.000, -.0005 \\ 1.625 \text{ AND LARGER} +.000, -.001. \end{cases}$   
 MAXIMUM PERMISSIBLE SHAFT RUNOUT WHEN MEASURED  
 AT END OF STD. SHAFT EXTENSION IS .002 T.I.R. UP TO  
 AND INCLUDING 1.625 DIA. AND .003 T.I.R. 1.625 DIA.  
 TO 5 INCH DIA.
- (4) ALL FRAMES HAVE EIGHT MOUNTING HOLES FOR DUAL MOUNTING.
- (5) MOTOR WEIGHTS MAY VARY BY 15% DEPENDING UPON RATING.
- (6) "N-W" VARIES +.00, -.25.

FRAME \_\_\_\_\_ TYPE \_\_\_\_\_ CERTIFIED FOR \_\_\_\_\_  
 ORDER \_\_\_\_\_ ITEM \_\_\_\_\_ HP \_\_\_\_\_ RPM \_\_\_\_\_ PH \_\_\_\_\_ HZ \_\_\_\_\_ VOLTS \_\_\_\_\_  
 SALES ORDER \_\_\_\_\_ APPROVED BY \_\_\_\_\_ DATE \_\_\_\_\_  
 LHS-100-2471119

CUSTOMER IS RESPONSIBLE FOR DETERMINING THAT BALDOR'S PRODUCT WILL PERFORM SUITABLY IN THE INTENDED APPLICATION.

REV. DESC: UPDATE DIM.FOR COLUMN P (FRAMES 324-326)	VERSION: 02	TDR: 000000895497
REV. LTR: B	REVISED: 01:00:58 03/05/2015	BY: RGGWT
FILE: \RAG\00006\851		
MTL: -		

**BALDOR**  
 DIM SHT FCXP FT 250-440T  
 SH 1 of 1

611742-001-SH2

# DUTY MASTER ALTERNATING CURRENT MOTORS

ENCLOSURE: TOTALLY ENCLOSED SQUIRREL-CAGE INDUCTION COOLING: FAN COOLED  
 UNDERWRITERS LISTED MOTOR  
 MOUNTING: FOOT  
 FRAMES 250T THRU 440T

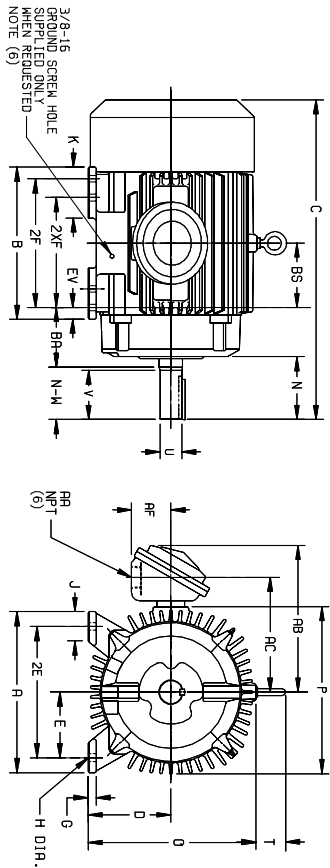

3/8-16 SCREW HOLE SUPPLIED ONLY WHEN REQUESTED NOTE (6)

DIMENSIONS ARE IN MILLIMETERS; SEE SHEET 1 FOR DIMENSIONS IN INCHES

FRAME	A	D(2)	E	G	H	J	K	O	P	T	AA(6)	AB	AC	AF	BA	EV
254T-256T	317.5	158.7	102.0	19.0	14.2	63.5	---	336.5	336.5	82.0	1-1/4	314.5	246.1	85.9	108.0	25.4
284T-286T	340.2	177.8	139.7	19.0	14.2	63.5	---	374.6	377.9	82.0	1-1/4	335.5	268.2	85.9	120.7	25.4
324T-326T	393.7	204.2	158.7	22.4	17.3	69.3	114.3	423.9	426.4	82.0	2	423.9	317.5	108.0	132.4	35.1
354T-356T	431.8	226.6	177.8	22.4	17.3	69.3	101.6	469.9	493.3	74.7	3	477.8	361.9	108.0	149.4	35.1
404T-406T	482.6	254.0	203.2	28.4	20.6	82.5	117.3	541.3	571.3	74.7	3	520.7	403.4	108.0	166.1	26.7
444T-446T	533.4	279.4	228.6	28.4	20.6	82.5	133.3	593.9	641.3	82.5	3	666.7	517.7	152.4	190.5	31.7

FRAME	C	BS	B	ZF	(4)	N	N-W(7)	SHAFT AND KEY				WEIGHT KGS. (5)
								U(3)	V	SO.	LGTH.	
254T	623.8	127.0	304.8	---	209.6	103.1	101.6	41.28	95.3	9.53	73.2	152
256T	623.8	127.0	304.8	254.0	---	103.1	101.6	41.28	95.3	9.53	73.2	156
284T	697.0	139.7	330.2	---	241.3	119.1	117.3	47.63	111.3	12.70	82.6	225
284T	697.0	139.7	330.2	---	241.3	84.1	82.6	41.28	76.2	9.53	47.8	225
286T	697.0	139.7	330.2	279.4	---	119.1	117.3	47.63	111.3	12.70	82.6	231
286T	697.0	139.7	330.2	279.4	---	84.1	82.6	41.28	76.2	9.53	47.8	231
324T	773.2	152.4	374.7	---	266.7	142.7	133.4	53.98	127.0	12.70	98.6	277
324T	773.2	152.4	374.7	---	266.7	104.6	95.3	47.63	88.9	12.70	50.8	295
326T	773.2	152.4	374.7	304.8	---	104.6	95.3	47.63	88.9	12.70	50.8	295
326T	773.2	152.4	374.7	304.8	---	104.6	95.3	47.63	88.9	12.70	50.8	295
364T	849.4	155.4	381.0	---	285.7	152.4	149.4	60.33	142.7	15.88	108.0	410
364T	849.4	155.4	381.0	---	285.7	98.6	95.3	47.63	88.9	12.70	50.8	410
365T	849.4	155.4	381.0	311.1	---	152.4	149.4	60.33	142.7	15.88	108.0	430
365T	849.4	155.4	381.0	311.1	---	98.6	95.3	47.63	88.9	12.70	50.8	428
404T	973.1	174.8	406.4	---	311.1	190.5	184.1	73.02	177.8	19.05	142.7	589
404T	973.1	174.8	406.4	---	311.1	114.3	108.0	53.97	101.6	12.70	69.9	585
405T	973.1	174.8	406.4	349.2	---	190.5	184.1	73.02	177.8	19.05	142.7	605
405T	973.1	174.8	406.4	349.2	---	114.3	108.0	53.97	101.6	12.70	69.9	601
444T	1133.3	209.6	482.6	---	368.3	227.1	215.9	85.72	209.6	22.22	174.8	802
444T	1133.3	209.6	482.6	---	368.3	131.8	120.7	60.33	114.3	15.88	76.2	795
445T	1133.3	209.6	482.6	419.1	---	227.1	215.9	85.72	209.6	22.22	174.8	889
445T	1133.3	209.6	482.6	419.1	---	131.8	120.7	60.33	114.3	15.88	76.2	881

- (1) SPECIAL DIMENSIONS APPLYING TO THIS ORDER ON THIS LINE.
- (2) "D" VARIES  $\begin{cases} 250T - 440T +0.0, -1.8 \\ 360T - 440T +0.0, -1.5 \end{cases}$  CONDUIT BOX LOCATED ON OPPOSITE SIDE WHEN F-2,W-1, W-4,W-5,W-7, OR C-1 MOUNTING IS SPECIFIED.
- (3) "U" VARIES  $\begin{cases} 41.27 \text{ AND LARGER} +0.0, -0.3 \\ \text{UP TO } 41.27 \text{ DIA.} +0.000, -0.013 \end{cases}$  IF MOUNTING CLEARANCE DETAILS ARE REQUIRED, CONSULT FACTORY.
- (4) ALL FRAMES HAVE EIGHT MOUNTING HOLES FOR DUAL MOUNTING. MAXIMUM PERMISSIBLE SHAFT RUNOUT WHEN MEASURED AT END OF STD. SHAFT EXTENSION IS .05 T.I.R. UP TO AND INCLUDING 41.27 DIA. AND .08 T.I.R. 41.27 DIA. TO 127 MILL. DIA.
- (5) MOTOR WEIGHTS MAY VARY BY 15% DEPENDING UPON RATING.
- (6) DIMENSIONS ARE IN INCHES.
- (7) "N-W" VARIES +0.0, -6.4

FRAME \_\_\_\_\_ TYPE \_\_\_\_\_ CERTIFIED FOR \_\_\_\_\_  
 ORDER \_\_\_\_\_ ITEM \_\_\_\_\_ HP \_\_\_\_\_ RPM \_\_\_\_\_ APPROVED BY \_\_\_\_\_ PH \_\_\_\_\_ HZ \_\_\_\_\_ VOLTS \_\_\_\_\_  
 SALES ORDER \_\_\_\_\_ DATE \_\_\_\_\_

ZHS-100-274119

CUSTOMER IS RESPONSIBLE FOR DETERMINING THAT BALDOR'S PRODUCT WILL PERFORM SUITABLY IN THE INTENDED APPLICATION.

REV. DESC: UPDATE DIM.FOR COLUMN P (FRAMES 324-326)	VERSION: 02	TDR: 000000895497
REV. LTR: B	REVISED: 01:04:25 03/05/2015	BY: RGGWT
FILE: \RAG\00006\852		
MTL: -		

**BALDOR**  
 DIM SHT FCXP FT 250-440T  
 SH 1 of 1

**DUTY MASTER ALTERNATING CURRENT MOTORS**  
 ENCLOSURE: TOTALLY ENCLOSED SQUIRREL-CAGE INDUCTION  
 UNDERWRITERS LISTED MOTOR  
 MOUNTING: FOOT  
 COOLING: FAN COOLED

611742-001-SH2

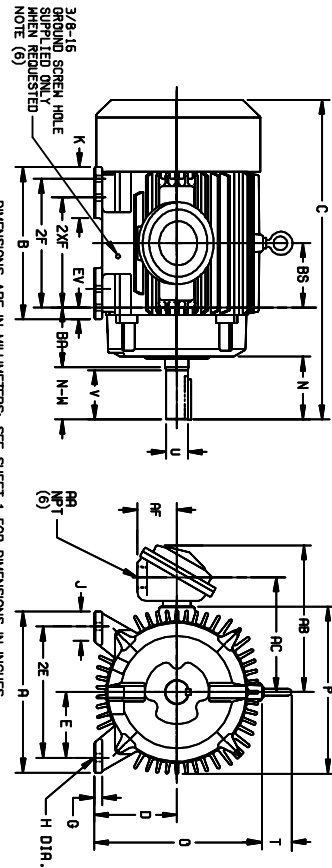

DIMENSIONS ARE IN MILLIMETERS; SEE SHEET 1 FOR DIMENSIONS IN INCHES

FRAME	A	D(2)	E	G	H	J	K	O	P	T	AA(3)	AB	AC	AF	BA	EV
254T-256T	317.5	156.7	127.0	18.0	14.2	63.5	---	336.5	336.5	82.0	1-1/4	314.5	246.1	65.9	108.0	25.4
254T-256T	340.2	177.8	139.7	18.0	14.2	63.5	---	374.8	377.2	82.0	1-1/4	336.5	268.2	65.9	120.7	25.4
254T-256T	393.7	203.2	156.7	22.4	17.3	68.8	114.3	423.8	438.2	92.0	2	433.9	317.5	108.0	132.4	35.1
254T-256T	431.8	226.6	177.8	22.4	17.3	68.8	114.3	459.9	485.3	92.0	2	477.8	351.9	108.0	149.4	35.1
404T-405T	482.6	254.0	203.2	28.4	20.9	82.5	117.3	541.3	571.3	107.3	3	520.7	403.4	108.0	166.1	28.7
444T-445T	533.4	279.4	228.6	28.4	20.9	82.5	133.3	593.9	641.3	121.3	3	606.7	457.7	152.4	190.5	31.7

FRAME	C	BS	B	ZF	(4)	N	N-W(7)	U(3)	V	SO	LGTH.	WEIGHT
SIZE											KGS. (5)	
254T	623.8	127.0	304.8	---	209.6	103.1	101.6	41.28	95.3	9.53	73.2	152
256T	623.8	127.0	304.8	254.0	---	103.1	101.6	41.28	95.3	9.53	73.2	156
284T	697.0	139.7	330.2	---	241.3	119.1	117.3	47.63	111.3	12.70	82.6	225
284T	697.0	139.7	330.2	---	241.3	84.1	82.6	41.28	76.2	9.53	47.8	225
296T	697.0	139.7	330.2	279.4	---	119.1	117.3	47.63	111.3	12.70	82.6	231
296T	697.0	139.7	330.2	279.4	---	84.1	82.6	41.28	76.2	9.53	47.8	231
324T	773.2	152.4	374.7	---	268.7	142.7	133.4	53.98	127.0	12.70	98.6	277
324T	773.2	152.4	374.7	---	268.7	104.6	95.3	47.63	88.9	12.70	98.6	277
326T	773.2	152.4	374.7	304.8	---	142.7	133.4	53.98	127.0	12.70	98.6	285
326T	773.2	152.4	374.7	304.8	---	104.6	95.3	47.63	88.9	12.70	98.6	285
364T	849.4	155.4	381.0	---	285.7	152.4	149.4	60.33	142.7	15.88	108.0	412
364T	849.4	155.4	381.0	---	285.7	98.6	95.3	47.63	88.9	12.70	50.8	410
364T	849.4	155.4	381.0	---	285.7	152.4	149.4	60.33	142.7	15.88	108.0	412
364T	849.4	155.4	381.0	---	285.7	98.6	95.3	47.63	88.9	12.70	50.8	410
385T	925.4	165.4	391.0	---	311.1	---	---	---	---	---	---	---
385T	925.4	165.4	391.0	---	311.1	190.5	184.1	73.02	177.8	19.05	142.7	589
404T	973.1	174.8	406.4	---	311.1	114.3	108.0	53.97	101.6	12.70	69.9	585
404T	973.1	174.8	406.4	---	311.1	180.5	184.1	73.02	177.8	19.05	142.7	605
405T	973.1	174.8	406.4	348.2	---	114.3	108.0	53.97	101.6	12.70	69.9	601
405T	973.1	174.8	406.4	348.2	---	180.5	184.1	73.02	177.8	19.05	142.7	605
444T	1133.3	209.6	482.6	---	368.3	227.1	215.9	85.72	209.6	22.22	174.8	802
444T	1133.3	209.6	482.6	---	368.3	131.8	120.7	60.33	114.3	15.88	76.2	795
445T	1133.3	209.6	482.6	419.1	---	227.1	215.9	85.72	209.6	22.22	174.8	809
445T	1133.3	209.6	482.6	419.1	---	131.8	120.7	60.33	114.3	15.88	76.2	801

- (1) SPECIAL DIMENSIONS APPLYING TO THIS ORDER ON THIS LINE.
- (2) "D" VARIES — 250T - 440T +0.0, -0.8  
 — 360T - 440T +0.0, -1.5  
 UP TO 41.27 DIA. +0.00, -0.013
- (3) "U" VARIES — 41.27 AND LARGER +.00, -.03
- (4) ALL FRAMES HAVE EIGHT MOUNTING HOLES FOR DUAL MOUNTING.
- (5) MOTOR WEIGHTS MAY VARY BY 15% DEPENDING UPON RATING.
- (6) DIMENSIONS ARE IN INCHES.
- (7) "N-W" VARIES +0.0, -6.4

CONDUIT BOX LOCATED ON OPPOSITE SIDE WHEN F-2-W-1,  
 W-4-W-5-M-7, OR C-1 MOUNTING IS SPECIFIED.  
 IF MOUNTING CLEARANCE DETAILS ARE REQUIRED, CONSULT  
 FACTORY.

MAXIMUM PERMISSIBLE SHAFT RUNOUT WHEN MEASURED  
 AT END OF STD. SHAFT EXTENSION IS .05 T.I.R. UP TO  
 AND INCLUDING 41.27 DIA. AND .08 T.I.R. 41.27 DIA.  
 TO 127 MILL. DIA.

FRAME \_\_\_\_\_ TYPE \_\_\_\_\_ CERTIFIED FOR \_\_\_\_\_  
 ORDER \_\_\_\_\_ ITEM \_\_\_\_\_ HP \_\_\_\_\_ RPM \_\_\_\_\_ APPROVED BY \_\_\_\_\_ PH \_\_\_\_\_ HZ \_\_\_\_\_ VOLTS \_\_\_\_\_  
 SALES ORDER \_\_\_\_\_ DATE \_\_\_\_\_

ZHS-100-2741119

CUSTOMER IS RESPONSIBLE FOR DETERMINING THAT BALDOR'S PRODUCT WILL PERFORM SUITABLY IN THE INTENDED APPLICATION.

REV. DESC: UPDATE DIM.FOR COLUMN P (FRAMES 324-326)	VERSION: 02	TDR: 000000895497
REV. LTR: B	REVISED: 01:04:25 03/05/2015	BY: RGGWT
FILE: \RAG\00006\852		
MTL: -		

**BALDOR**  
 DIM SHT FCXP FT 250-440T  
 SH 1 of 1

416820-036

A-C MOTOR  
CONNECTION DIAGRAM  
STANDARD 3 LEAD CONNECTED

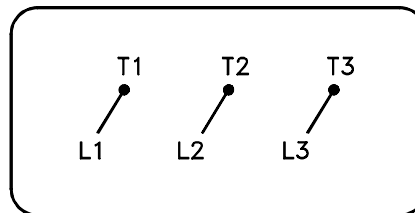

(N.P. 1575-BA)

416820-036

REV. DESC: LOADED TO BUS, C/R 335225		
REV. LTR: -	VERSION: 00	TDR: 000000538207
FILE: \MGA\00000\682	REVISED: 11:54:06 04/30/2010	
MTL: -	BY: RAGRA	

**BALDOR**

CONN DIAG - STANDARD 3 LEAD

SH 1 of 1