

# BERKELEY® B2EQHH

## Cast Iron Impeller

Threaded Case (NPT), Packing Construction

### SAE ENGINE MOUNT

Section	SAE
Page	40.1
Date	March 4, 2013
Supersedes 01/01/04	

**Table I**

B/M No.	SAE Mtg. Size	Bracket No.	Shaft No.	Shaft Spline No.	Shaft Ext.
<b>B71849</b>	4	H05550	H05546	1-3/8-10T	3"
<b>B71850</b>	5	H05552	H05544	1-3/8-10T	2-1/2"

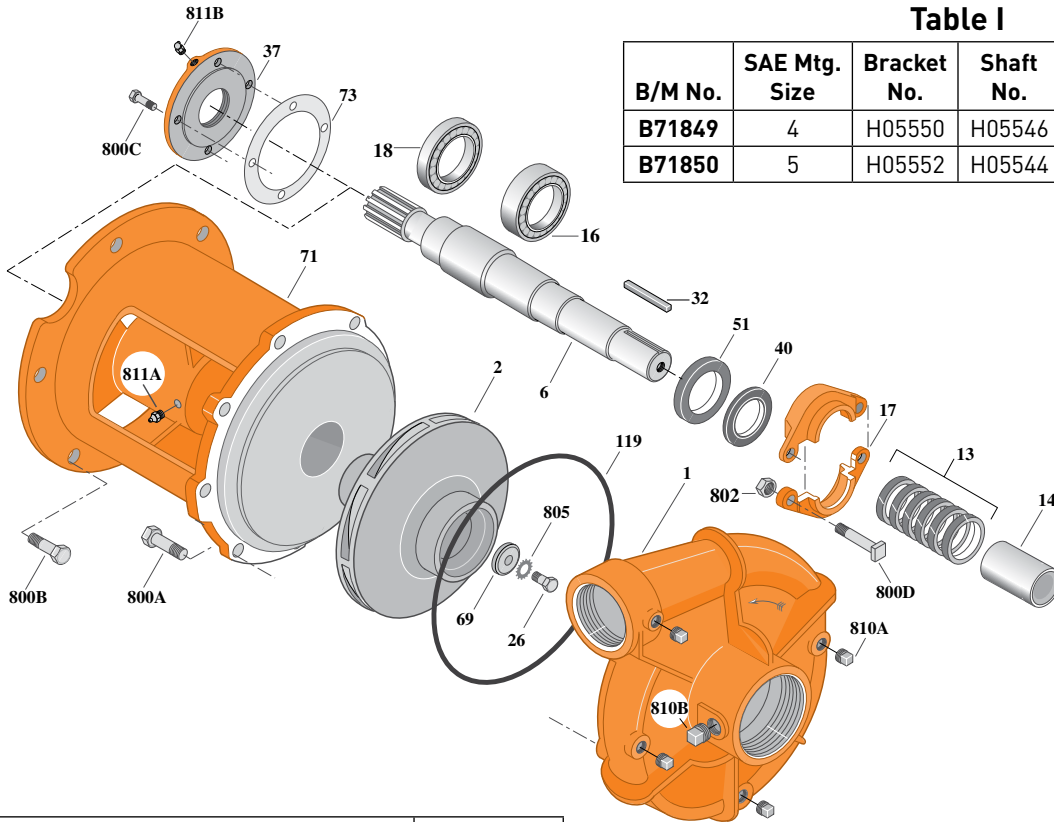

Item No.	Part Description	Part Number
1	Case, Volute	L03482
2	Impeller	M06915
6	Shaft	See Table I
13	Ring, Packing [Set of 6]	S14023
14	Sleeve, Shaft	S05974
16	Bearing, Ball	S13396
17	Gland, Packing	B82472
18	Bearing, Ball	S13395
26	Screw, Impeller 1/2-13x1"	S23619
32	Key, 1/4 x 2-1/4"	S23677
37	Bearing Cap, Outer	M10979
40	Slinger, Water	S10964
51	Seal, Oil	S14765
69	Washer, Impeller	S06319
71	Bracket	See Table I
73	Gasket	S18055

Item No.	Part Description	Part Number
119	O-Ring	S13760
800A	Capscrew, Hex 1-1/2-13x1-1/4" [8 Req.]	S26914
800B	Capscrew, Hex 3/8-16x1" [12 Req. - SAE 4]	S26914
800B	Capscrew, Hex 3/8-16x1-1/2" [7 Req. - SAE 5]	S26830
800C	Capscrew, Hex 1/4-20x3/4" [4 Req.]	S23119
800D	Bolt, Sq. Head 1/2-13x2-1/2" [2 Req.]	S23793
802	Nut, Hex 1/2-13x7/16" [2 Req.]	S23347
805	Washer, Lock	S23038
810A	Plug, Pipe 1/4 NPT [4 Req.]	S23715
810B	Plug, Pipe 1/2 NPT	S23717
811A	Fitting, Grease	S23670
811B	Fitting, Grease	S23702
•	Plug, Pipe 1/8 NPT	S13883

• Not illustrated.

