



FINISH THOMPSON INC.

MSDB SERIES

ASSEMBLY, INSTALLATION AND OPERATION

MANUAL

P/N 110989 R1

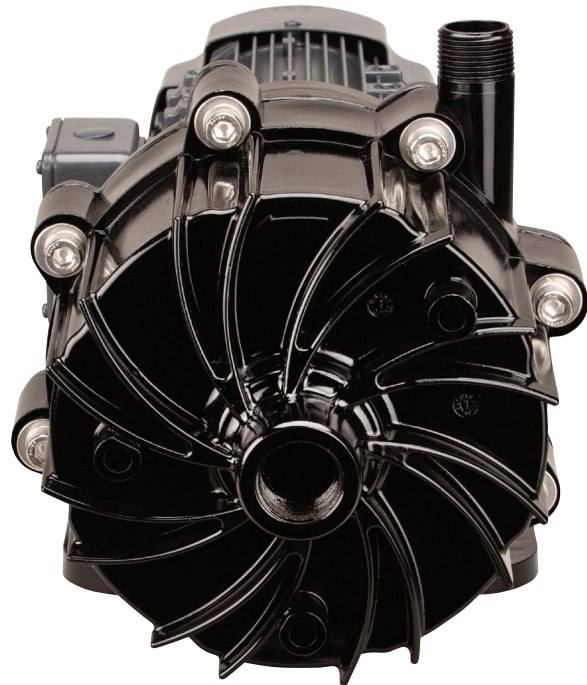



EU Declaration of Conformity



Finish Thompson Inc. hereby declares that the following machine(s) fully comply with the applicable health and safety requirements as specified by the EU Directives listed. The product may not be taken into service until it has been established that the drive motor for the centrifugal pump complies with the provisions of all relevant EU Directives. The complete product complies with the provisions of the EC Directive on machinery safety provided motors carry CE marking.

This declaration is valid provided that the devices are fully assembled and no modifications are made to these devices.

Type of Device:
 Centrifugal Pumps

Models:

AC/AK/AV - 400/500/600/800	GP-11/22/32	VKC-5.5/6/6H/7/8/10
DB-3/4/5/5.5/6/6H/7/8/9/10/11/15/22	MSKC	SP-10/11/15/22
KC-3/4/5/5.5/6/6H/8/10/11/22/32	MSVKC	MSDB

EU Directives:

Machinery Safety (2006/42/EC)

Applied Harmonized Standards:

EN ISO 12100
 EN 809

Manufacturer: Finish Thompson Inc.
 921 Greengarden Road
 Erie, Pennsylvania 16501-1591 U.S.A

Signed,

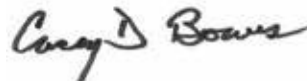

 President

1 July 2020

Person(s) Authorized to Compile Technical File: Finish Thompson GmbH
 Otto-Hahn-Strasse 16
 Maintal, D-63477 DEU
 Telephone: 49 (0)6181-90878-0

EU Declaration of Conformity

Manufactured by:

Finish Thompson, Inc.
 921 Greengarden Road
 Erie, Pennsylvania 16501 U.S.A.
 Phone: 1-(814)-455-4478
 Fax: 1-(814)-455-8518
 Email: fti@finishthompson.com
 Web: www.finishthompson.com



II 2GD

**Ex h IIC T6...T4 Gb
 Ex h IIIC T6...T4 Db
 FTZU 20 ATEX A674-20**

Finish Thompson declares under our sole responsibility that the product listed below conforms to the relevant provisions of EU directive **2014/34/EU of 26 February 2014** for equipment and protective systems intended for use in potentially explosive atmospheres, and is certified for safe use in **Atmosphere Group IIC/IIIC category 2** areas.

This declaration applies to Finish Thompson, Inc **ATEX MSDB Series** pumps only manufactured out of carbon fiber filled PVDF with a conductive motor adapter and non-sparking ring designated by the letter "V" and "A" in the model number. Pumps and their model number may also contain many different combinations of bushings, shafts, o-rings, port connections, impellers, magnet sets, motor adapters and other options.

Models: MSDB2V-A; MSDB3V-A.

This product has used the following harmonized standards to verify conformance:

Non-electrical equipment for potentially explosive atmospheres: **EN ISO 80079-36:2016**
 Basic Methods and Requirements.

Non-electrical equipment intended for use in potentially explosive atmospheres: **EN ISO 80079-37:2016**
 Protection by construction safety "ch" and control of ignition source "bh"

This product must not be used in areas other than specified above. If in doubt consult an authorized distributor, or refer to the manufacturer Finish Thompson.

Approved by:



Date: 7/1/2020

TABLE OF CONTENTS

Description	Page Number
Important Information.....	5
Chemical Reaction Disclaimer	5
Safety Precautions	5
Installation/Operation Precautions	6
ATEX Safety Precautions.....	6-7
MSDB Capabilities	7
MSDB OIM Section I - Assembly	8
MSDB OIM Section II – Installation.....	9
MSDB OIM Section III - Start-up and Operation	10
MSDB OIM Section IV - Maintenance	13
MSDB OIM Section V - Disassembly.....	13-16
MSDB OIM Section VI - Reassembly.....	17-20
MSDB OIM Exploded View - Parts Drawing.....	21
MSDB OIM Parts Table.....	22-29
MSDB OIM Section VII - Troubleshooting.....	30
MSDB OIM Section VIII - Warranty.....	30

IMPORTANT INFORMATION - READ ME FIRST!**Model Number and Serial Number**

Record the model number and serial number below for future reference. This is important information when ordering replacement parts or when technical assistance is required. The numbers are found on a label located on the motor adapter.

MODEL NUMBER =

SERIAL NUMBER =

IMPORTANT NOTICE

U.S. Export Administration Regulations, pursuant to ECCN 2B350, prohibit the export or reexport to certain enumerated countries of sealless centrifugal pumps in which all wetted materials are constructed from fluoropolymers without first applying for and obtaining a license from the U.S. Bureau of Industry and Security (BIS). This affects all Finish Thompson magnetic-drive pumps constructed from PVDF or lined with ETFE. Please contact the BIS (www.bis.doc.gov) or Finish Thompson with questions regarding the Regulations or a list of the countries to which they apply.

Chemical Reaction Disclaimer

The user must exercise primary responsibility in selecting the product's materials of construction, which are compatible with the fluid(s) that come(s) in contact with the product. The user may consult Finish Thompson, Inc. (manufacturer) and a manufacturer's representative/distributor agent to seek a recommendation of the product's material of construction that offers the optimum available chemical compatibility.

However neither manufacturer nor agent shall be liable for product damage or failure, injuries, or any other damage or loss arising out of a reaction, interaction or any chemical effect that occurs between the materials of the product's construction and fluids that come into contact with the product's components.

Safety Precautions

⚠ WARNING: READ THIS MANUAL COMPLETELY BEFORE INSTALLING AND OPERATING THIS UNIT. FAILURE TO FOLLOW THESE PRECAUTIONS CAN RESULT IN SERIOUS INJURY OR DEATH.

⚠ WARNING: Magnetic field hazard: This pump contains powerful magnets. Exposed magnets (pump not connected to motor) produce powerful magnetic fields. Individuals with cardiac pacemakers, implanted defibrillators, other electronic medical devices, metallic prosthetic heart valves, internal wound clips (from surgery), metallic prosthetic devices or sickle cell anemia must not handle or be in the proximity of the magnets contained inside the pump. Consult a health care provider for specific recommendations before working with this pump.

⚠ WARNING: Magnetic force hazard. This pump should only be disassembled and assembled using the recommended procedures. The magnetic attraction is powerful enough to rapidly pull the motor end and the wet end together. Do not place fingers between the mating surfaces of the motor and wet ends to avoid injuries. Keep the drive magnet and impeller assembly away from metal chips or particles, items with magnetic stripes like credit cards and magnetic computer media such as floppy discs and hard drives.

⚠ WARNING: When pumping flammable or combustible liquids with a MSDB Series pump it is important to only pump liquids that are water soluble (miscible) and to follow these guidelines:

1. You must use a PVDF pump. PVDF has conductive carbon fibers added which allow it to be grounded when installed in a properly grounded piping system or when a properly installed grounding strap is attached to a housing bolt. If PVDF is not compatible with the liquid being pumped, you should consider an ETFE lined UC Series magnetic drive pump.
2. You must select the non-sparking (Ns) bronze bump ring option. The non-sparking ring is pressed into the clamp ring or motor adapter and prevents sparking should the motor bearings fail and the outer mag drive assembly runs out of round.

3. You must select an explosion-proof FTI motor or provide your own explosion-proof motor.

When pumping non-flammable or non-combustible liquids in a hazardous area using a MSDB Series pump, it is important to take these guidelines:

1. You must select the non-sparking (Ns) bronze bump ring option. The non-sparking ring is pressed into the clamp ring or motor adapter and prevents sparking should the motor bearings fail and the outer mag drive assembly runs out of round.
2. You must select an explosion-proof FTI motor or provide your own explosion-proof motor.

⚠ WARNING: Hot surfaces. This pump is capable of handling liquids with temperatures as high as 220° F (104° C). This may cause the outer areas of the pump to become hot as well and could cause burns.

⚠ WARNING: Rotating Parts. This pump has components that rotate while in operation. Follow local safety standards for locking out the motor from the power supply during maintenance or service.

⚠ WARNING: Chemical Hazard. This pump is used for transferring many types of potentially dangerous chemicals. Always wear protective clothing, eye protection and follow standard safety procedures when handling corrosive or personally harmful materials. Proper procedures should be followed for draining and decontaminating the pump before disassembly and inspection of the pump. There may be small quantities of chemicals present during inspection.

⚠ WARNING: The pump and associated components are heavy. Failure to properly support the pump during lifting and movement could result in serious injury or damage to the pump and components.

⚠ WARNING: Never run pump at less than minimum flow or with the discharge valve closed. This could lead to pump failure.

Installation/Operation Precautions

⚠ CAUTION: This pump should never be operated without liquid in the casing. It is recommended that run dry protection be used. Optional electronic power monitors are available to help protect against run dry. If the pump has a PTFE, ceramic or silicon carbide bushing, IT CANNOT BE RUN DRY WITHOUT CAUSING DAMAGE TO THE PUMP. However, the pump can operate without liquid in the casing if the pump has a carbon bushing. The exact length of time the pump can operate dry with a carbon bushing varies with operating conditions and the environment.

⚠ CAUTION: Never start or operate with a closed suction valve. Never operate with a closed discharge valve.

⚠ CAUTION: Always provide adequate NPSHa (net positive suction head available). It is recommended to provide at least 2 feet (61 cm) above the NPSHr (net positive suction head required).

⚠ CAUTION: If pump is used on variable speed drive, do not exceed the frequency for which the pump was designed (for example, if the pump is a 50 Hz model, do not exceed 50 Hz).

ADDITIONAL SAFETY PRECAUTIONS FOR ATEX COMPLIANT PUMPS

MSDB Series:

The pump is designed for



II 2GD
Ex h IIC T6...T4 Gb
1026 Ex h IIIC T6...T4 Db

⚠ Protection Control

A power monitor, flow switch, pressure switch or similar device must be used to protect against dry running, closed discharge valve or decoupling. Any of these conditions could lead to a rise in surface temperature of the pump.

⚠ Construction Materials

Pump must be manufactured from PVDF with a PVDF motor adapter and bronze bump ring and have the designation “-A” in the pump part number. The PVDF contains conductive carbon which allows it to be grounded when installed in a properly grounded piping system or when a properly installed grounding strap is attached to a housing bolt. The bronze bump ring is pressed into the clamp ring or motor adapter and prevents sparking should the motor bearings fail and the outer drive magnet runs out of round.

⚠ Grounding

Static sparking can cause an explosion. When operating in a hazardous area or pumping a hazardous fluid the entire pump system must be grounded to prevent static discharge. Before operating the pump, ensure the electrical continuity throughout the pumping system and earth ground is 1 Ohm or less. If greater than 1 Ohm, re-check all grounding connections.

⚠ Elastomer Selection

Proper o-ring material must be chosen for the fluid being pumped. Improper material selection could lead to swelling and be a possible source of leaks. This is the responsibility of the end user.

⚠ Leaks

The pump must be checked for leaks on a regular basis. If leaks are noticed, the pump must be repaired or replaced immediately.

⚠ WARNING: Risk of explosion. When using an MSDB in an ATEX application, the following methods must be applied:

- Fluid being pumped must be conductive (soluble in water)
- DO NOT use to self-prime
- DO NOT run the pump dry

⚠ Temperature Classification

The surface temperature of the DB Series pumps depends upon the temperature of the fluid that is being pumped. The following chart lists different fluid temperatures and the corresponding pump surface temperature.

Fluid Temperature	Maximum Surface Temperature	Temperature Class	Maximum Allowable Surface Temperature
21°C (70°F)	51°C (123°F)	T6	85°C
77°C (140°F)	77°C (171°F)	T5	100°C
104°C (220°F)	99°C (211°F)	T4	135°C

⚠ Cleaning

The pump must be cleaned on a regular basis to avoid dust build up greater than 5 mm. Clean the pump’s exterior only using a damp non-static cloth.

⚠ Motor Rotation Test

Pump must be full of liquid with no trapped air in the suction and discharge lines before the rotation of the motor is checked. Do not operate pump until it is full of liquid.

⚠ Start up

The pump must be filled from a flooded suction tank (gravity) or primed with liquid from an outside source. Open the inlet (suction) and discharge valves completely and allow the pump to fill with liquid. Close the discharge valve. Turn the pump on and slowly open the discharge valve. Adjust the flow rate and pressure by regulating the discharge valve. Do not attempt to adjust the flow with the suction valve.

⚠ Maintenance

The recommended maintenance schedule depends upon the nature of the fluid being pumped and the specific application. If the pump is used on a clean fluid, it is recommended that the pump be removed from service and

examined after six months of operation or after 2,000 hours of operation. If the pump is used on fluids with solids, high temperatures or other items that could cause accelerated wear, then this initial examination should be sooner.

After the initial examination of the internal components and wear items are measured, a specific maintenance schedule can be determined. For best results, it is recommended that the pump be removed from service annually for examination.

MSDB Capabilities

Maximum Working Pressure: 135 psi (9.3 bar)
Maximum Viscosity: 150 cP
Maximum Temperature: Polypropylene -180° F (82° C); PVDF – 220° F (104°C) Note: Maximum temperature is application dependent. Consult a chemical resistance guide or the chemical manufacturer for chemical compatibility and temperature limits.

Maximum Noise Level: 78 dBA (pump only)

Solids: Maximum particle size is 100 microns for slurries and 1/64" (.4 mm) for infrequent particles. Maximum hardness is 80 HS. Maximum concentration is 10% by weight. If solids are being pumped, it is recommended that the pump have either ceramic or for best results, silicon carbide components. Pumping solids may lead to increased wear.

Minimum Allowable Flow rate:

Do not allow the flow rate to drop below the minimum flow rate listed in the chart below:

Model	3450 rpm	1725 rpm	2900 rpm	1450 rpm
MSDB	1.0 gpm (0.23 m3/hr)	1.0 gpm (0.23 m3/hr)	.23 m3/hr (1.0 gpm)	.23 m3/hr (1.0 gpm)

Maximum Allowable Motor Power:

Do not exceed the maximum power rating for the pump coupling.
 Standard coupling for the MSDB is 10-pole

6-pole coupling = 2 horsepower (1.5 kW)
 8-pole coupling = 3 horsepower (2.2 kW)
 10-pole coupling = 7.5 horsepower (5.5 kW)

MSDB ASSEMBLY, INSTALLATION & OPERATION

Unpacking and Inspection

Unpack the pump and examine for any signs of shipping damage. If damage is detected, save the packaging and notify the carrier immediately.

Section I – Assembly

Pumps with Motors

Proceed to “Installation” Section.

Pumps without Motors

NOTE: 184TC and 100/112 frame motors must have feet.

Tools Required - Metric socket or wrench set, 9/16” socket or wrench and 3/16” Allen Wrench (NEMA motors only).

The NEMA 182-184TC and IEC 80, 90, 100/112 B14 flange models will require a 1/4” drive ratchet and 9/16” socket to install (items 36, 37, 38) motor adapter bolt, lock washer, and flat washer between the foot.

1. Remove the pump, drive magnet assembly and hardware package from the carton. Do not remove the shipping plug until after the pump has been installed on the motor.

⚠ CAUTION: Keep away from metallic particles, tools, and electronics. Drive magnets MUST be free of metal chips.

⚠ WARNING: Keep the drive magnet away from the open end of the motor adapter and barrier. Strong magnetic attraction could allow the drive hub to enter the motor adapter resulting in injury or damage.

2. Place motor on the fan end. For 56C/145TC and B5 frame motors go to step 4. See figure 1.

3. For 184 NEMA and IEC motors only - install the motor adapter flange (item 10) on the motor face using bolts, lock washers and flat washers (items 36, 37, 38). See figure 2.

4. Torque bolts to the following:
 80 frame (M6) = 90 in-lb (10.2 N-m)
 90/100/112 frame (M8) = 130 in-lb (14.4 N-m)
 184 NEMA (1/2”) = 300 in-lb (33.9 N-m)
 Note: Apply anti-seize compound on threads of the bolts.

5. Coat the motor shaft with anti-seize compound. Insert key supplied with motor into keyway on motor shaft. See figure 3.

NOTE: Make sure the motor shaft is clean and free of burrs.

The outer drive is precision machined and has a bore tolerance of +.0005/-0 inch.



Figure 1



Figure 2



Figure 3

- Slide the outer drive magnet assembly (item 13) onto the motor shaft until the motor shaft contacts the snap ring in the bore of the drive. Figures 4 and 5.



Figure 4



Figure 5

- Secure the drive on the motor shaft.

⚠ WARNING: Be careful, magnets will try to attract tools.

Metric Motors: Secure the drive to the motor shaft using bolt, lock washer and flat washer (items 39, 40, 41). Thread the bolt into the end of the motor shaft (while holding the outer drive to prevent it from turning). See figure 6.

Tighten the bolt to the following:

- 80 frame (M6) = 90 in-lb (10.2 N-m)
- 90 frame (M8) = 130 in-lb (14.7 N-m)
- 100/112 frame (M10) = 240 in-lb (27.1 N-m)

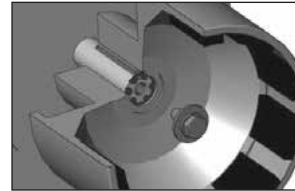

Figure 6 - IEC Drive

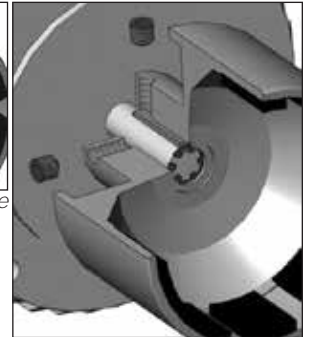

Figure 7 - NEMA Drive

NEMA Motors: Install set screws (item 13A) into threaded holes on the side of the outer drive magnet assembly. Using a 3/16" Allen wrench, tighten & torque to 228 in-lbs. (25.8 N-m). See figure 7.

- For NEMA 56C and 145TC frame motors:
Install o-ring (item 19) in the groove on the back of the motor adapter (item 11). Use petroleum jelly to hold the o-ring in place during installation.
Note: 184TC and metric adapters do not use this o-ring. Install the pump end on the motor/drive magnet assembly. With the motor facing upright, align the pump feet so that the motor feet and pump feet are on the same side.

Tip the pump end at an angle (discharge is approximately 45°) so that it is just touching the edge of the outer drive magnet assembly. See figure 8.



Figure 8

Carefully lower the pump onto the drive magnet assembly by tipping discharge forward to 90° and dropping straight down. The last 3-4 inches (8-10 cm) before the pump reaches the motor will have STRONG magnetic attraction between the pump and outer drive magnet assembly.

- Secure the pump to the motor with (4) 3/8" bolts, lock washers and flat washers (items 33, 34, 35). See figures 9A and 9B.
NOTE: Apply anti-seize compound on threads of bolts.

NOTE: B5 flange motors will require customer supplied hardware.
B5 pumps with 100/112 frame do not include a pump foot.

- Proceed to Installation Section



Figure 9A



Figure 9B

Section II - Installation

Mounting

Pump foot should be securely fastened to a solid foundation. If the pump was received with plastic shipping shims, these shims may be used as additional support for the motor feet (though not required).

Piping

CAUTION: The NPSH available to the pump must be greater than the NPSH required. Filters, strainers and any other fittings in the suction line will lower the NPSH available and should be calculated into the application.

- Install the pump as close to the suction source as possible.
- Support the piping independently near the pump to eliminate any strain on the pump casing. Also, the piping should be aligned to avoid placing stress on the pump casing.
- The suction side of the pump should be as straight and short as possible to minimize pipe friction.
- Keep bends and valves at least ten pipe diameters away from the suction and discharge.
- The suction line should be at least as large as the suction inlet port or one pipe size larger so that it does not affect the NPSHa. Do not reduce the suction line size.
- The suction line should not have any high spots. This can create air pockets. The suction piping should be level or slope slightly upward to the pump.
- A check valve and control valve (if used) should be installed on the discharge line. The control valve is used for regulating flow. An isolation valves on the suction and discharge are used to make the pump accessible for maintenance. The check valve helps prevent the pump against damage from water hammer. This is particularly important when the static discharge head is high.
- If flexible hose is preferred, use a reinforced hose rated for the proper temperature, pressure and chemical resistance against the fluid being pumped.
- The suction valve must be completely open to avoid restricting the suction flow.
- FTI advises installing a flush system in the piping to allow the pump to be flushed before it is removed from service.

NOTE: The pump is provided with a provision for a customer installed ¼" drain in the impeller housing. See the Drain Installation Section for details.

- For units in a suction lift system, install appropriate piping in the discharge to allow priming of the pump (MSDB models are not self-priming).
- When installing pumps with flanges, we recommend use of low seating stress gaskets such as Gore-Tex® or Gylon® (expanded PTFE).

Motor/Electrical

Only qualified personnel trained in the safe installation and operation of this equipment should install the motor. Install the motor according to National Electric Code, NEMA MG-2, IEC standards requirements and/or applicable local electrical codes. The voltage and frequency variations of the power supply should never exceed the limits established in the applicable standard. Prior to connecting to the power line, check nameplate voltage, rotation connection and ensure proper grounding. Sufficient ventilation area should be provided to insure proper operation and cooling of the motor. The motor must be installed with a suitable overload protection circuit. For three phase motors it is recommended to install a phase failure protection device. Download the motor manual from the specific motor manufactures' website for additional information concerning motor installation, safety and maintenance instructions.

Wire the motor for clockwise rotation when facing the fan end of the motor.

⚠ CAUTION: Do not operate the pump to check rotation until the pump is full of liquid or damage may occur even if the motor is “bumped” to check motor rotation direction.

Check all electrical connections with the wiring diagram on the motor. Make sure the voltage, frequency, phase and amp draw comply with the supply circuit.

If utilized, verify that power monitors or variable frequency drives have been properly installed according to the manufacturer’s instructions

To verify correct rotation of the motor:

1. Install the pump into the system.
2. Fully open the suction and discharge valves.
3. Allow fluid to flow into the pump. Do not allow the pump to run dry (ceramic, PTFE and silicon carbide bushings can’t be run dry without damage to pump components).
4. Jog the motor (allow it to run for 1-2 seconds) and observe the rotation of the motor fan. Refer to the directional arrow molded into the pump casing if necessary.

NOTE: A pump running backwards will pump but at a greatly reduced flow and pressure.

Section III - Start-up and Operation

1. This pump must be filled from a flooded suction tank (gravity) or primed with liquid from an outside source. The MSDB is not self-priming.
2. Open the inlet (suction) and discharge valves completely and allow the pump to fill with liquid.
3. Close the discharge valve.
4. Turn the pump on. Slowly open the discharge valve. Adjust the flow rate and pressure by regulating the discharge valve. Do not attempt to adjust the flow with the suction valve.
5. Use of a power monitor is strongly recommended for pumps with ceramic, PTFE or silicon carbide bushings. The power monitor will stop the pump and help prevent damage if the pump should run dry. ATEX certified pumps MUST use a power monitor.

Shutdown

Use the following procedure to shut down the pump.

1. Slowly close the discharge valve.
2. Turn off the motor.
3. Close the suction valve.

Flush Systems

⚠ CAUTION: Some fluids react with water; use compatible flushing fluid.

1. Turn off the pump.
2. Completely close the suction and discharge valves.
3. Connect flushing fluid supply to flush inlet valve.
4. Connect flushing fluid drain to flush drain valve.
5. Open flushing inlet and outlet valves. Flush system until the pump is clean.

Optional Drain Installation

1. Remove the impeller housing from the pump assembly.
2. Clamp the impeller housing to a drill press table.
3. Using a 7/16” drill and the molded boss as a guide, drill completely through the molded boss into the interior of the impeller housing. De-burr the hole on the inside of the impeller housing.

⚠ CAUTION - Do not tap too deep or the impeller housing may be damaged.

4. Using a 1/4” NPT tap, tap the hole in the molded boss to the appropriate depth.
5. Install the drain plug or valve, being careful not to overtighten.

Section IV - Maintenance

Recommended maintenance schedule

The recommended maintenance schedule depends upon the nature of the fluid being pumped and the specific application. If the pump is used on a clean fluid, it is recommended that the pump be removed from service and examined after six months of operation or after 2,000 hours of operation. If the pump is used on fluids with solids, high temperatures or other items that could cause accelerated wear, then this initial examination should be sooner.

After the initial examination of the internal components and wear items are measured, a specific maintenance schedule can be determined. For best results, it is recommended that the pump be removed from service annually for examination.

Section V - Disassembly

⚠ WARNING: Rotating Parts. This pump has components that rotate while in operation. Follow local safety standards for locking out the motor from the power supply during maintenance or service.

⚠ WARNING: Chemical Hazard. This pump is used for transferring many types of potentially dangerous chemicals. Always wear protective clothing, eye protection and follow standard safety procedures when handling corrosive or personally harmful materials. Proper procedures should be followed for draining and decontaminating the pump before disassembly and inspection of the pump. There may be small quantities of chemicals present during inspection.

⚠ WARNING: Magnetic force hazard. This pump should only be disassembled and assembled using the recommended procedures. The magnetic attraction is powerful enough to rapidly pull the motor end and the wet end together. Do not place fingers between the mating surfaces of the motor and wet ends to avoid injuries. Keep the drive magnet and impeller assembly away from metal chips or particles.

Stop the pump, lock out the motor starter, close all the valves that are connected to the pump, and drain/decontaminate the pump.

⚠ WARNING: The pump must be thoroughly flushed of any hazardous materials and all internal pressure relieved prior to opening the pump. Allow the pump to reach ambient temperatures prior to performing maintenance.

1. For pumps with motors 2 horsepower (1.5 kW) or smaller, securely clamp the pump feet to the bench. Remove the (4) bolts, lock washers and flat washers (items 35, 36,37) securing the pump to the motor. See figure 10.



Figure 10

2. Firmly grab the motor and pull straight back to disengage the motor and pump. See figure 11.



Figure 11

3. For pumps with motors 3 HP (2.2 kW) or larger, place the pump and motor on the floor. Remove the (4) bolts, lock washers and flat washers (items 35, 36, 37) securing the pump to the motor. See figure 9. Make sure the motor is on the fan end with the pump facing up. Pull straight up to remove the pump from the motor. See figure 12.
4. Place pump on bench with housing facing up. Remove (8) 10 mm housing bolts, lock washers and flat washers (items 19, 20, 21). See figure 13.



Figure 12



Figure 13

5. Pull housing (item 1) straight up to remove. Inspect housing for signs of wear or damage. Look for signs of rubbing, cracking on thrust ring, or damage to front shaft support and shaft. See figure 14.



Figure 14

6. Remove first stage impeller (item 2). Grip the impeller by hand or the use of small pry bars may be necessary. Impeller is pressed on to the end of the drive shaft and can be simply pulled straight off. Gently pry off the impeller followed by the diffuser assembly (item 3). See figures 15 & 16.



Figure 15



Figure 16

7. Remove the middle housing (item 4) and 2nd stage impeller (item 5). Impeller is pressed on to the end of the drive shaft and can be simply pulled straight off. The use of small pry bars may be necessary to remove the impeller. Gently pry impeller off and remove the 2nd stage diffuser (item 3). See figures 17 thru 21.



Figure 17



Figure 18



Figure 19



Figure 20



Figure 21

8. Remove inner volute (item 6). See figures 22 & 23.



Figure 22



Figure 23

9. Remove drive shaft/ drive impeller/inner drive assembly (item 7). Inspect impeller and drive for signs of rubbing replace as necessary. See figures 24-26.

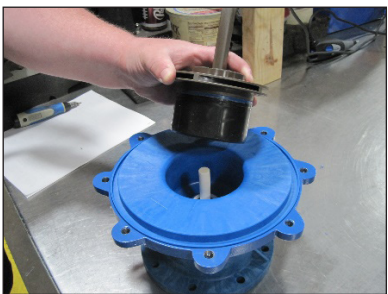

Figure 24

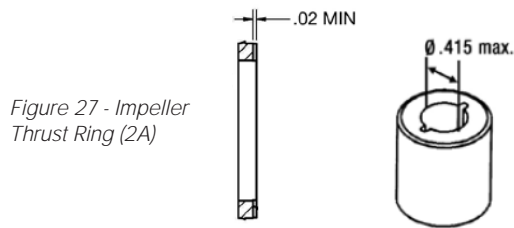

Figure 25



Figure 26

10. Check the impeller thrust rings and bushing for wear. See Figures 27 & 28.



11. Remove the barrier (item 9) from the clamp ring (item 11). Pry the barrier out with your hand. See figure 29.
12. Check the impeller shaft for signs of cracking, chipping, scoring or wear. The shaft is molded into the barrier and cannot be removed.
13. Inspect the inside and outside of the barrier for signs of rubbing.
14. Remove the o-ring (item 8) from the barrier and inspect for chemical attack, swelling, brittleness, cuts, etc.
15. Visually inspect the outer drive (item 15) for rubbing, damage, corrosion or loose magnets.



Figure 29

Thrust Ring Replacement

1. Thrust ring (item 2A) is held in-place with a snap fit with a ridge. Using a razor knife or side cutters, cut a notch out of the thrust ring. Pull ring up and out of the holder. See figures 30-31.
2. If thrust ring is made of SiC, ring cannot be replaced & new impeller assembly (item 2) must be ordered.
3. To reinstall, align the two flats on the thrust ring with the flats in the bore of the impeller. Using a piece of wood, press into place using an arbor press until the thrust ring is completely seated in the impeller.

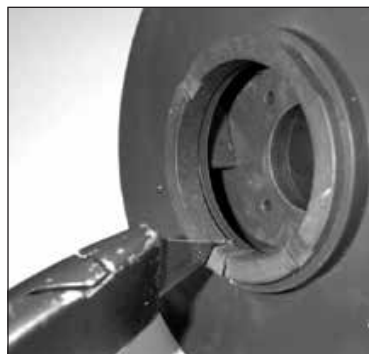

Figure 30

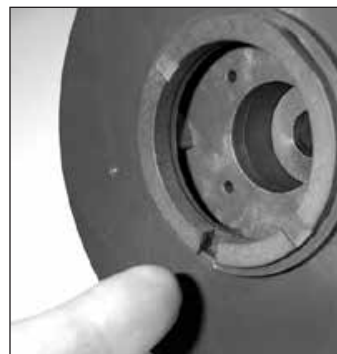

Figure 31

Outer Drive Replacement

1. Remove the setscrews (item 15B) from the side of the drive (NEMA motors) or the bolt, lock washer and flat washer (items 32, 33 & 34) from the center of the drive (metric motors).
- ⚠ WARNING:** Be careful, tools will want to be attracted to the magnets.
2. Remove the drive magnet from the motor shaft by gently prying up from the bottom of the drive. See figure 32.
 3. To reinstall the drive or a new drive follow the instructions from Section I - Assembly, Pumps without Motors, steps 4-6.



Figure 32

Section VI - Clamp Ring Replacement & Reassembly

1. Inspect the clamp ring. If clamp ring requires replacement, it is recommended to remove the plastic foot (Item 14) first. Note: 100/112 frame B5 adapters do not use the foot. See figures 33 & 34. Remove the 4-M6 bolts (items 25 thru 31).



Figure 33

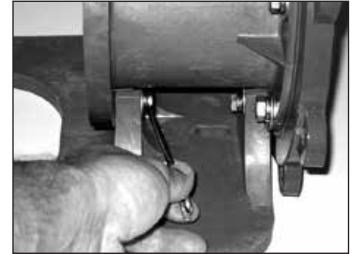

Figure 34

2. Remove the (5) M8 bolts, lock washers & flat washers (items 22, 23, & 24) from the clamp ring (item 11). See figure 35. Remove the clamp ring from the motor adapter. There is a snug fit between the clamp ring & motor adapter due to the vapor protection o-ring (item 12). Carefully pull the two parts apart. See figure 36.



Figure 35



Figure 36

3. Inspect the motor adapter o-ring (item 12). If damaged, replace. If reusable, lubricate it with a chemically compatible lubricant. See figure 37.



Figure 37

4. Install the new clamp ring. Place the clamp ring on a flat surface. See figure 38. Align the bolt holes (5 motor adapter and 2 foot bolt holes) on the clamp ring with the bolt holes on the motor adapter. Push the motor adapter straight down onto the clamp ring to seat the o-ring. See figure 39. Install (5) M8 bolts, lock washers and flat washers (items 22, 23 & 24), and tighten & torque in a star pattern to 130 in-lb (14.7 N-m). See figure 40.



Figure 38



Figure 39



Figure 40

For 56C, 145TC and 80 frame B14, re-install the plastic foot (item 14) to the motor adapter (item 13). Use the longer M6 bolts, lock washers and flat washers (items 25, 26 and 27) for the front bolt holes towards the clamp ring. See figure 41. Use the shorter M6 bolts, lock washers and flat washers (items 28, 29, 30 & 31) for the rear bolt holes towards the motor face.

Make sure the nuts are still in place. See figure 42. Tighten & torque bolts to **5 ft-lbs. (6.7 N-m)**. For 184 frame, IEC 90, 100/112 frame B14 and 80/90 frame B5, leave the foot off until the motor adapter is installed on the motor. This will allow easier access to the bottom bolt hole in the motor adapter.

5. Position the motor adapter assembly on a flat surface. If the foot is installed, allow the feet to hang over the edge. See figure 43.
6. Install the o-ring (item 17) into the groove on the clamp ring. Lubricate the o-ring with a compatible lubricant. See figure 44. Install the barrier (item 9) into the clamp ring motor adapter assembly.
7. Push the barrier straight down until it seats in the clamp ring. See figure 45.



Figure 41



Figure 42



Figure 43



Figure 44



Figure 45

Reassembly

1. Install o-ring (item 8). See figure 46.
2. Carefully install the driven impeller / drive shaft/inner drive assembly (item 7) by sliding it over the impeller shaft in the barrier. It is normal for the impeller / inner drive to pop up a slight amount due to magnetic forces. See figures 47 & 48.

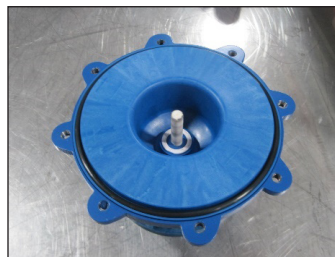

Figure 46

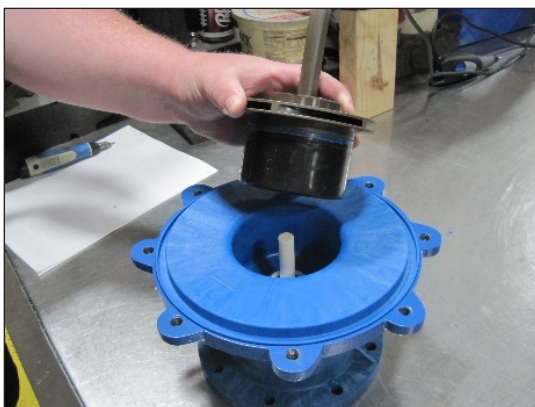

Figure 47

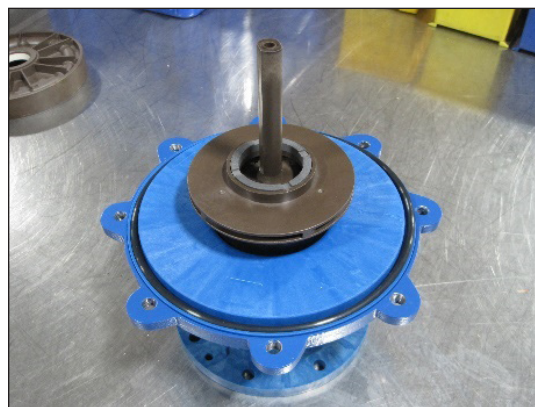

Figure 48

3. Install the inner volute (6) over the drive shaft. See figures 49 & 50.



Figure 49



Figure 50

4. Slide one diffuser assembly (item 3) over the drive shaft. Align the cutout in the diffuser with the volute shape in the inner volute. The two parts should nest together and the diffuser should sit flat. See figures 51 thru 54.



Figure 51

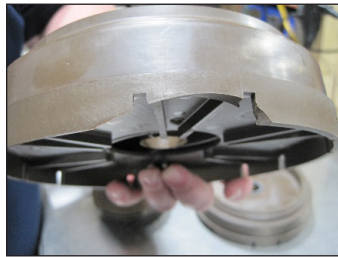

Figure 52

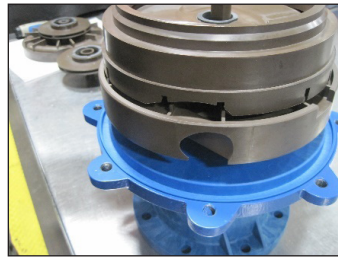

Figure 53



Figure 54

5. Place the 2nd stage impeller (item 5) into position. Align the flats on the drive shaft with the flats in the impeller shaft. These two parts fit snugly and some pressure may be required to push the impeller straight down into position. See figures 55 & 56.



Figure 55



Figure 56

6. Place the middle housing (item 4) into position. See figures 57 & 58.



Figure 57



Figure 58

7. Slide the 1st stage diffuser assembly (item 3) into position. Align the cutout in the diffuser with the volute shape in the middle housing (item 4). The two parts should nest together and the diffuser should sit flat. See figures 59 thru 61.



Figure 59



Figure 60



Figure 61

8. Place the 1st stage impeller (item 2) into position. Align the flats on the drive shaft with the flats in the impeller shaft. These two parts fit snugly and some pressure may be required to put the impeller into position. See figures 62 & 63.



Figure 62



Figure 63

9. Install the impeller housing (item 1). Align the alignment boss in the housing with the notch in the inner volute assembly (item 6). To get the housing to seat properly in may be necessary to move the housing back & forth. If housing will not seat remove the housing & align the notch. Note: due to magnetic attraction the pump assembly may want to pop up. Simply push it back down. Make sure the discharge is in the correct orientation in relation to pump foot. Rotate the housing until the discharge is in the correct position. Holding the impeller housing with one hand, install and finger-tighten two bolts, lock washers and flat washers (items 19, 20 & 21) in opposite locations. See figures 64 thru 65.



Figure 64



Figure 65

10. Install the remaining bolts, lock washers and flat washers finger tight.
11. Tighten all the bolts evenly using a star pattern. Tighten to **20 foot-lbs (27 N-m)**.
12. Reinstall the pump on the motor/drive magnet following instructions found in "Assembly, Pumps Without Motors," steps 7-10.

MSDB Exploded View - Parts Diagram

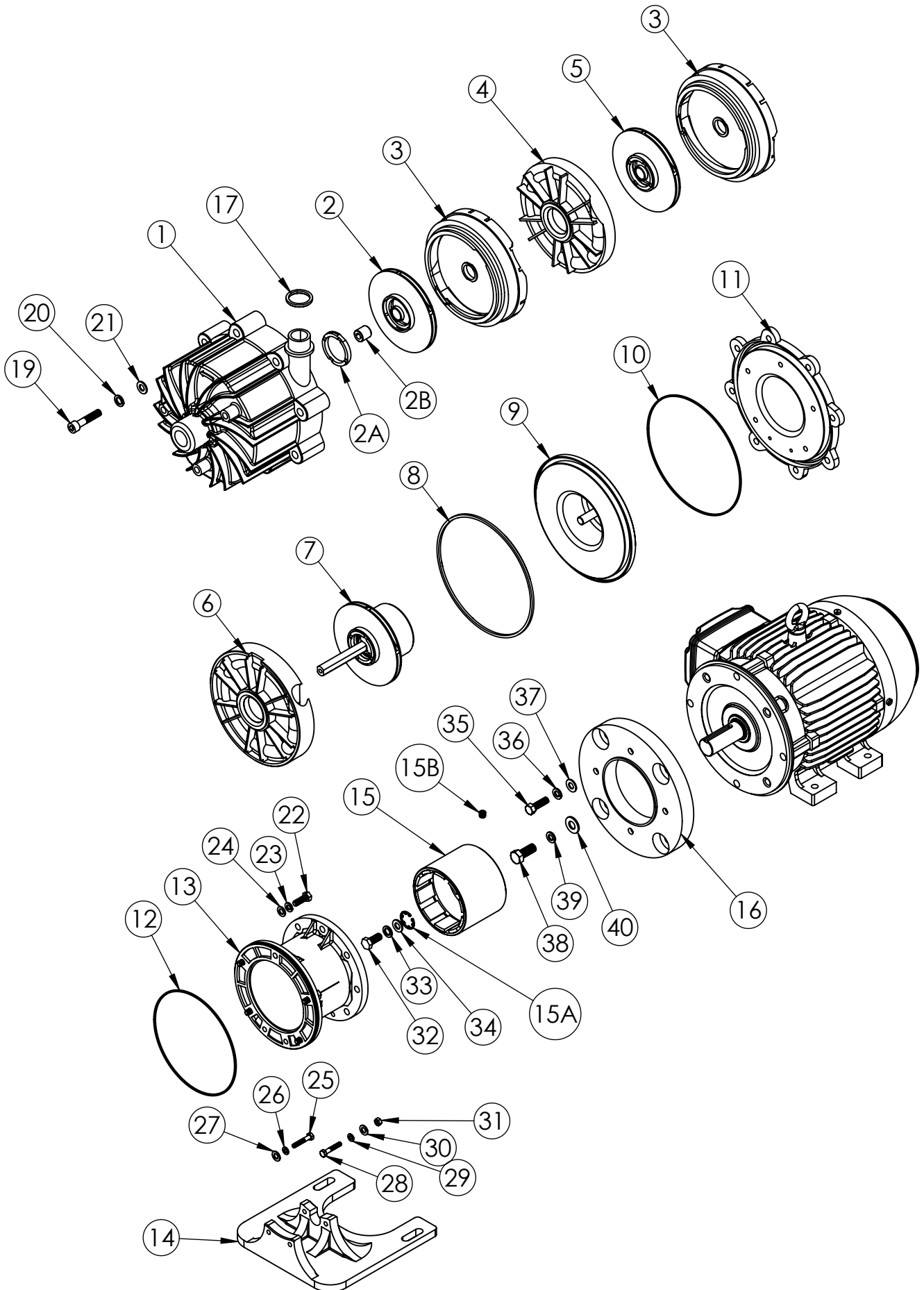

MSDB Spare Parts List					
Item	Qty	Description	Pump Material		
			Polypro	PVDF	
1	1	Standard Housing with Ring & Shaft			
		NPT Threads w/ alumina ring & shaft	105860	105860-2	
		BSP Threads w/ alumina ring & shaft	105860-1	105860-3	
		NPT Thread w/ SiC ring & shaft	105860-4	105860-6	
		BSP Thread w/ SiC ring & shaft	105860-5	105860-7	
		Steel flanges w/ Alumina Ring & shaft - ANSI150/PN20/40	105929	105929-2	
		FRP flanges w/ Alumina ring & shaft - ANSI150/PN20/40	105929-1	105929-3	
		Steel flanges w/ SiC Ring & shaft - ANSI150/PN20/40	105929-4	105929-6	
		FRP flanges w/ SiC ring & shaft - ANSI150/PN20/40	105929-5	105929-7	
		FRP flanges w/ Alumina ring & shaft - JIS10K	105929-8	105929-9	
		FRP flanges w/ SiC ring & shaft -JIS10K	105929-10	105929-11	
2	1 or 2	1st Stage Impeller Assy (includes bushing, impeller thrust ring, & rear thrust ring)			
		<i>See MSDB Impeller Assemblies Table</i>			
2A	3	Impeller Thrust Ring Only			
		Filled PTFE (Standard)	106257		
		SiC (Optional)	N/A		
2B	1	Impeller Bushing Only			
		Carbon (standard)	J102387		
		Filled PTFE (Optional)	J102790		
		SiC (Optional)	J103617-1		
		Ceramic (Optional)	J103617		
3	2	Diffuser Assembly			
		40% Glass-Filled PPS w/ PTFE Ring (Standard)	111050		
4	1	Middle Housing Assembly			
		40% Glass-Filled PPS w/ Alumina Ring (Standard)	105832		
		40% Glass-Filled PPS w/ SiC Ring (Optional)	105832-1		
5	1	2nd Stage Impeller Assy (includes impeller thrust ring) (used in 3-stage pumps only)			
		<i>See MSDB Impeller Assemblies Table</i>			
6	1	Inner Volute Assembly			
		40% Glass-Filled PPS w/ PTFE Ring (Standard)	105831		
		40% Glass-Filled PPS w/ SiC Ring (Optional)	105831-1		
7	1	3rd Stage Drive Impeller Assembly with Thrust Ring, Bushing, Drive Shaft, & Imp Drive. Also used as the 2nd Stage Drive Impeller in a 2 stage pump.			
		<i>See MSDB Impeller Assemblies Table</i>			
8	1	Housing O-Ring			
		EPDM (Optional)	105717		
		FKM (Standard)	105716		
		Kalrez (Optional)	105718		
		Simriz (Optional)	105719		
9	1	Barrier			
		w/ alumina ceramic shaft	105689-5	105689-6	
		w/ SiC shaft	105689-7	105689-8	

10	1	Barrier O-Ring		
		Buna	107281	
11	1	Clamp Ring		
		Painted Cast Iron (Standard)	107228	107228-1
		Painted cast iron with non-sparking ring	107321	107321-1
		Painted cast iron (ATEX)	N/A	107321-1
		Stainless Steel	108600	108600
		Stainless Steel with non-sparking ring	108600-1	108600-1
		Stainless steel (ATEX)	N/A	108600-1
12	1	Clamp Ring/Motor O-Ring		
		Buna	107282	
13	1	Motor Adapter Column		
		Standard	106890	106890-1
		ATEX	N/A	106890-2
14	1	Pump Foot		
		All Frame Sizes Except 100/112	105691-1	105691-4
		100 frame with B14 flange only	105691-3	105694-6
		112 frame with B14 flange only	105691-2	105694-5
15	1	Drive Magnet Assembly with Retaining Ring		
		6-pole 56C frame (includes set screws)	105878	
		8-pole 56C frame (includes set screws)	105878-1	
		6-pole 143/145TC frame (includes set screws)	105878-3	
		8-pole 143/145TC frame (includes set screws)	105878-4	
		10-pole 182/184TC frame (includes set screws)	105730-9	
		6-pole 80 frame	105882	
		8-pole 80 frame	105882-1	
		6-pole 90 frame	105882-3	
		8-pole 90 frame	105882-4	
		10-pole 100/112 frame	105730-18	
15A	1	Retaining Ring Only		
		182/184TC frame	105710	
		143/145TC frame	105709	
		56C frame	105708	
		100/112 frame	105710	
		90 frame	105712	
		80 frame	105711	
15B	2	Set Screws		
		NEMA motor frames Only	J101084	

16	1	Motor Adapter Flange		
		182/184TC frame	105751-1	105751-2
		80 frame B14	105724-1	105724-2
		90 frame B14	105725-1	105725-2
		100/112 frame B14	105726-1	105726-2
		80/90 frame B5	106274	106274-1
		100/112 frame B5	107315	107315-1
		80 frame B14 ATEX	N/A	105724-3
		90 frame B14 ATEX	N/A	105725-3
		100/112 frame B14 ATEX	N/A	105726-3
		80/90 frame B5 ATEX	N/A	106274-2
100/112 frame B5 ATEX	N/A	107315-1		
17	1	Discharge O-Ring (BSP Threaded Housings Only)		
		EPDM (Optional)		106304
		FKM (Standard)		106303
		Kalrez (Optional)		106305
		Simriz (Optional)		106306
18	1	Motor Adapter Column/Motor O-Ring (not shown)		
		Buna		106549

MSDB HARDWARE			
Item	qty	Description	Stainless Steel
19	8	Housing Bolt	
			110990
20	8	Housing Lockwasher	
			105757
21	8	Housing Flat Washer	
			105722
22	5	Clamp Ring Bolt	
			J103662
23	5	Clamp Ring Lockwasher	
			J102282
24	5	Clamp Ring Flat Washer	
			J101293
25	2	Front Foot Bolt	
			107289
26	2	Front Foot Lockwasher	
			J100672
27	2	Front Foot Flat Washer	
			J100113
28	2	Rear Foot Bolt	
			J103968
29	2	Rear Foot Lockwasher	
			J100672
30	2	Rear Foot Flat Washer	
			J100113

31	2	Rear Foot Nut	
			107286
32	1	Drive Bolt (IEC Motors Only)	
		80 Frame	105765
		90 Frame	105770
		100/112 Frame	105774
33	1	Drive Lockwasher (IEC Motors Only)	
		80 Frame	J100672
		90 Frame	J102282
		100/112 Frame	J100115
34	1	Drive Flat Washer (IEC Motors Only)	
		80 Frame	105767
		90 Frame	105722
		100/112 Frame	J103160
35	4	Motor Adapter bolt	
		All frames except 100/112 B5	J103118
		100/112 B5 frames only	J100114
36	4	Motor Adapter Lockwasher	
		All Frames	J100115
37	4	Motor Adapter Flat Washer	
		All Frames	J100128
38*	4	Motor Adapter Flange Bolts	
		182/184TC frame	J103782
		80 frame with B14 flange	105765
		90 frame with B14 flange	105770
		100/112 frame with B14 flange	105770
39*	4	Motor Adapter Flange Lockwasher	
		182/184TC frame	J101023
		80 frame with B14 flange	J100672
		90 frame with B14 flange	J102282
		100/112 frame with B14 flange	J102282
40*	4	Motor Adapter Flange Flat Washer	
		182/184TC frame	J103851
		80 frame with B14 flange	J100113
		90 frame with B14 flange	J101293
		100/112 frame with B14 flange	J101293

*For IEC B5 frame pumps: Hardware is to be supplied by customer due to variations in B5 frame motors.

1ST STAGE IMPELLER ASSEMBLY	
(INCLUDES CARBON BSHG, PTFE FRONT THRUST RING, ALUMINA CERAMIC REAR THRUST RING)	
IMP #	PART #
#1	105935
#2	105935-24
#3	105935-32
#4	105935-40
#5	105935-48
#6	105935-56

1ST STAGE IMPELLER ASSEMBLY	
(INCLUDES PTFE BSHG, PTFE FRONT THRUST RING, ALUMINA CERAMIC REAR THRUST RING)	
IMP #	PART #
#1	105935-2
#2	105935-25
#3	105935-33
#4	105935-41
#5	105935-49
#6	105935-57

1ST STAGE IMPELLER ASSEMBLY	
(INCLUDES ALUMINA CERAMIC BSHG, PTFE FRONT THRUST RING, ALUMINA CERAMIC REAR THRUST RING)	
IMP #	PART #
#1	105935-60
#2	105935-61
#3	105935-62
#4	105935-63
#5	105935-64
#6	105935-65

1ST STAGE IMPELLER ASSEMBLY	
(INCLUDES SiC BSHG, PTFE FRONT THRUST RING, ALUMINA CERAMIC REAR THRUST RING)	
IMP #	PART #
#1	105935-15
#2	105935-27
#3	105935-35
#4	105935-43
#5	105935-51
#6	105935-59

1ST STAGE IMPELLER ASSEMBLY	
(INCLUDES SiC BSHG, SiC FRONT THRUST RING, ALUMINA CERAMIC REAR THRUST RING)	
IMP #	PART #
#1	111310
#2	111310-1
#3	111310-2
#4	111310-3
#5	111310-4
#6	111310-5

2ND STAGE IMPELLER ASSEMBLY	
(INCLUDES PTFE FRONT THRUST RING, ALUMINA CERAMIC REAR THRUST RING)	
IMP #	PART #
#1	111088
#2	111088-6
#3	111088-10
#4	111088-14
#5	111088-18
#6	111088-22

2ND STAGE IMPELLER ASSEMBLY	
(INCLUDES SiC FRONT THRUST RING, ALUMINA CERAMIC REAR THRUST RING)	
IMP #	PART #
#1	111311
#2	111311-1
#3	111311-2
#4	111311-3
#5	111311-4
#6	111311-5

3RD STAGE IMPELLER ASSEMBLY ASSY		
(INCLUDES PTFE FRONT THRUST RING, CARBON BUSHING)		
IMP #	POLYPRO	PVDF
#1	PART #	PART #
6-POLE	105932-12	105932-66
8-POLE	105932-6	105932-60
10-POLE	105932	105932-54
#2		
6-POLE	105932-13	105932-67
8-POLE	105932-7	105932-61
10-POLE	105932-1	105932-55
#3		
6-POLE	105932-14	105932-68
8-POLE	105932-8	105932-62
10-POLE	105932-2	105932-56
#4		
6-POLE	105932-15	105932-69
8-POLE	105932-9	105932-63
10-POLE	105932-3	105932-57
#5		
6-POLE	105932-16	105932-70
8-POLE	105932-10	105932-64
10-POLE	105932-4	105932-58
#6		
6-POLE	105932-17	105932-71
8-POLE	105932-11	105932-65
10-POLE	105932-5	105932-59

3RD STAGE IMPELLER ASSEMBLY ASSY		
(INCLUDES PTFE FRONT THRUST RING, SiC BUSHING)		
IMP #	POLYPRO	PVDF
#1	PART #	PART #
6-POLE	105932-30	105932-84
8-POLE	105932-24	105932-78
10-POLE	105932-18	105932-72
#2		
6-POLE	105932-31	105932-85
8-POLE	105932-25	105932-79
10-POLE	105932-19	105932-73
#3		
6-POLE	105932-32	105932-86
8-POLE	105932-26	105932-80
10-POLE	105932-20	105932-74
#4		
6-POLE	105932-33	105932-87
8-POLE	105932-27	105932-81
10-POLE	105932-21	105932-75
#5		
6-POLE	105932-34	105932-88
8-POLE	105932-28	105932-82
10-POLE	105932-22	105932-76
#6		
6-POLE	105932-35	105932-89
8-POLE	105932-29	105932-83
10-POLE	105932-23	105932-77

3RD STAGE IMPELLER ASSEMBLY ASSY (INCLUDES PTFE FRONT THRUST RING, ALUMINA CERAMIC BUSHING)		
IMP #	POLYPRO	PVDF
#1	PART #	PART #
6-POLE	105932-120	105932-138
8-POLE	105932-114	105932-132
10-POLE	105932-108	105932-126
#2		
6-POLE	105932-121	105932-139
8-POLE	105932-115	105932-133
10-POLE	105932-109	105932-127
#3		
6-POLE	105932-122	105932-140
8-POLE	105932-116	105932-134
10-POLE	105932-110	105932-128
#4		
6-POLE	105932-123	105932-141
8-POLE	105932-117	105932-135
10-POLE	105932-111	105932-129
#5		
6-POLE	105932-124	105932-142
8-POLE	105932-118	105932-136
10-POLE	105932-112	105932-130
#6		
6-POLE	105932-125	105932-143
8-POLE	105932-119	105932-137
10-POLE	105932-113	105932-131

3RD STAGE IMPELLER ASSEMBLY ASSY		
(INCLUDES PTFE FRONT THRUST RING, PTFE BUSHING)		
IMP #	POLYPRO	PVDF
#1	PART #	PART #
6-POLE	105932-48	105932-102
8-POLE	105932-42	105936-96
10-POLE	105932-36	105932-90
#2		
6-POLE	105932-49	105932-103
8-POLE	105932-43	105932-97
10-POLE	105932-37	105932-91
#3		
6-POLE	105932-50	105932-104
8-POLE	105932-44	105932-98
10-POLE	105932-38	105932-92
#4		
6-POLE	105932-51	105932-105
8-POLE	105932-45	105932-99
10-POLE	105932-39	105932-93
#5		
6-POLE	105932-52	105932-106
8-POLE	105932-46	105932-100
10-POLE	105932-40	105932-94
#6		
6-POLE	105932-53	105932-107
8-POLE	105932-47	105932-101
10-POLE	105932-41	105932-95

3RD STAGE IMPELLER ASSEMBLY ASSY		
(INCLUDES SiC FRONT THRUST RING, SiC BUSHING)		
IMP #	POLYPRO	PVDF
#1	PART #	PART #
6-POLE	111309-12	111309-30
8-POLE	111309-6	111309-24
10-POLE	111309	111309-18
#2		
6-POLE	111309-13	111309-31
8-POLE	111309-7	111309-25
10-POLE	111309-1	111309-19
#3		
6-POLE	111309-14	111309-32
8-POLE	111309-8	111309-26
10-POLE	111309-2	111309-20
#4		
6-POLE	111309-15	111309-33
8-POLE	111309-9	111309-27
10-POLE	111309-3	111309-21
#5		
6-POLE	111309-16	111309-34
8-POLE	111309-10	111309-28
10-POLE	111309-4	111309-22
#6		
6-POLE	111309-17	111309-35
8-POLE	111309-11	111309-29
10-POLE	111309-5	111309-23

Section VII - Troubleshooting

General Notes:

- Do not pump liquids containing ferrous metal fines.
- If magnets decouple, stop pump immediately. Operating the pump with the magnets decoupled will eventually weaken the magnets.
- Power monitors are required and must be used with all ATEX certified pumps.
- Do not use mismatched drive magnet assemblies (different number of magnets on inner and outer drive magnet assemblies).
- Contact our Technical Service Department
Phone: 1-800-888-3743
- Email: techservice@finishthompson.com if you have any questions regarding product operation or repair.

No or Insufficient Discharge

- Air leaks in suction piping
- Pump not primed
- System head higher than anticipated
- Closed valve
- Viscosity or specific gravity too high
- Motor too large for magnet coupling rating (magnets uncoupled)
- Suction lift too high or insufficient NPSH
- Clogged suction line or impeller vanes
- Motor rotation incorrect (correct rotation when viewed from the fan end is clockwise)

Insufficient Pressure

- Air or gas in liquid
- Impeller diameter too small
- System head lower than anticipated
- Motors speed insufficient (too low) or motor rotation incorrect (correct rotation when viewed from the fan end is clockwise)

Loss of Prime

- Leak in suction piping
- Foot valve or suction opening not submerged enough
- Foot valve too small or leaking
- Air or gas in liquid
- Foreign matter in impeller
- Leaking valve. Suction lift too high or insufficient NPSHa

Excessive Power Consumption

- Head lower than rating
- Excessive flow
- Specific gravity or viscosity too high.

Vibration/Noise

- Loose magnet
- Drive magnet rubbing
- Pump cavitating from improper suction or feed
- Motor or piping not properly secured
- Foreign object in impeller

Section VIII - Warranty

Finish Thompson, Inc (manufacturer) warrants this pump product to be free of defects in materials and workmanship for a period of five years from date of purchase by original purchaser. If a warranted defect, which is determined by manufacturer's inspection, occurs within this period, it will be repaired or replaced at the manufacturer's option, provided (1) the product is submitted with proof of purchase date and (2) transportation charges are prepaid to the manufacturer. Liability under this warranty is expressly limited to repairing or replacing the product or parts thereof and is in lieu of any other warranties, either expressed or implied. This warranty does not apply to normal wear of the product or components. This warranty does not apply to products or parts broken due to, in whole or in part, accident, overload, abuse, chemical attack, tampering, or alteration. The warranty does not apply to any other equipment used or purchased in combination with this product. The manufacturer accepts no responsibility for product damage or personal injuries sustained when the product is modified in any way. If this warranty does not apply, the purchaser shall bear all cost for labor, material and transportation.

Manufacturer shall not be liable for incidental or consequential damages including, but not limited to, process down time, transportation costs, costs associated with replacement or substitution products, labor costs, product installation or removal costs, or loss of profit. In any and all events, manufacturer's liability shall not exceed the purchase price of the product and/or accessories.

Warranty Registration

Thank you for your purchase of this quality Finish Thompson product. Be sure to take a minute to register your pump at Finishthompson.com/warranty. Simply provide the model number, serial number and a few other pieces of information.

Ordering Spare Parts

Spare parts can be ordered from your local distributor. Always refer to the pump model to avoid error.



FINISH THOMPSON INC.

921 Greengarden Road • Erie, PA 16501-1591 U.S.A.
Ph 814-455-4478 • Fax 814-455-8518

Email fti@finishthompson.com • www.finishthompson.com

Part Number 110989 R1

2/15/2021

Order fax: 814-459-3460

Tech Service: 800-888-3743



Order Online: www.PumpCatalog.com